

MATCH LINE

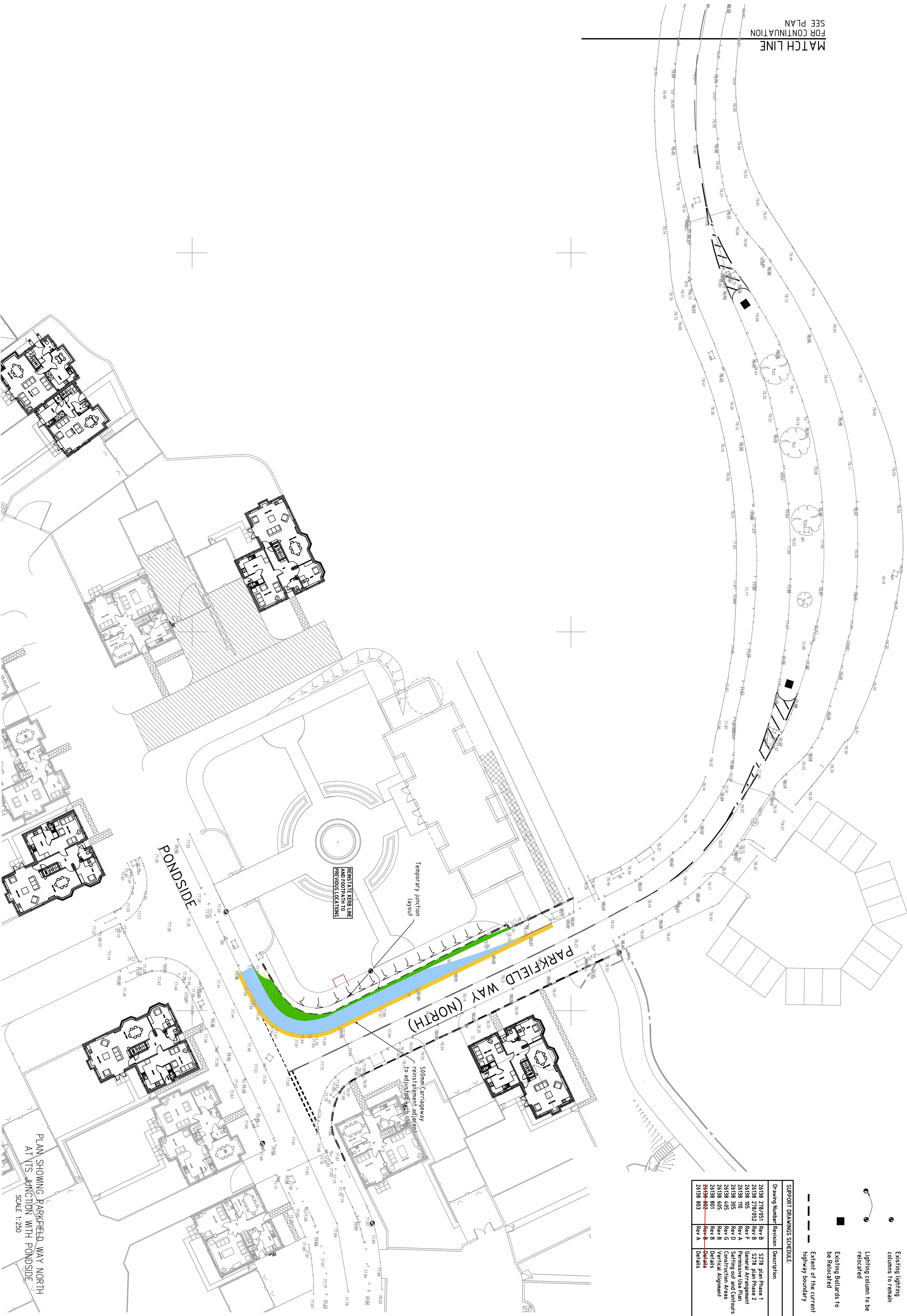

SUPPORT DRAWINGS SCHEDULE:		
Drawing Number	Revision	Description
2638 278/051	Rev B	S278 plan Phase 1
2638 278/052	Rev B	S278 plan Phase 2
2638 705	Rev F	General Arrangement
2638 110	Rev A	Permissive Use Plan
2638 305	Rev D	Settling out and Contours
2638 405	Rev G	Construction Areas
2638 605	Rev B	Vertical Alignment
2638 801	Rev B	Details
<del>2638 802</del>	<del>Rev B</del>	<del>Details</del>
2638 803	Rev A	Details

## NOTES

1. No works shall commence within the existing public highway until the Agreement is signed.
2. The proposed construction shall be designed and constructed so that the road surface and the subgrade below it is reinforced level with selected granular material as directed and to the satisfaction of the WSCC Highways Inspector.
3. All fill material up to foundation level of the proposed highways to be approved and compacted by layers as directed and to the satisfaction of the WSCC Highways Inspector.
4. Any drainage caused by the existing highway and/or the works to be repaired as directed and to the satisfaction of the WSCC Highways Inspector and/or Area Engineer.
5. Continuity of access to occupied areas to be maintained until satisfaction of the WSCC Highways Inspector. Area Office Engineer to be consulted.
6. Any abandoned/drainage pipes and chambers that fall within the proposed highway shall be grubbed up and the void backfilled in layers up to formation level of the carriageway with selected granular material or alternatively filled with concrete as directed.
7. Unpermitted construction in existing manholes/chambers that are affected by the works shall be sealed and the opening made good as directed and to the satisfaction of the Highways Inspector and/or utility company involved.
8. The existing signal at the Parkfield Way widening works shall have the signs applied and the connections to the main circuit drain replaced as directed and to the satisfaction of the WSCC Highways Inspector.
9. Any existing telephones, chambers, boxes, etc. that shall be located within the proposed carriageway shall be surveyed to ascertain their structural condition and special protection within the new carriageway (if deemed necessary), special protection shall be provided as required as directed and to the satisfaction of the WSCC Highways Inspector, Area Engineer and/or utility company involved.
10. Developer/Contractor to provide suitable and effective wheel washing facilities to prevent mud from being carried on the public highway and to provide the means to clean the highway to the satisfaction of the WSCC Highways Inspector. Area Engineer and/or local authority.
11. No concrete to be poured or laid in temperature below 24deg C (76deg F) on a falling main/m thermometer or before the temperature reaches 24deg C on a falling main/m thermometer to be provided by the Contractor and supplied in a permission agreed by the WSCC Highways Inspector.
12. All road signs and markings to comply with the Traffic Signs Manual except where otherwise agreed.
13. Additional temporary signing for the purposes of Construction Traffic Management shall be provided throughout the Balmore Village construction work as required by the WSCC Highways Inspector.
14. All road drain openings to be thermostatic.
15. Contractor to comply with Chapter 8 of the Traffic Signs Manual 2009.

B	COLOURED HATCHING APPLIED ON JUNCTION TO SUIT WSCC COMMENT	10.06.11
A	DRAWING 26138 278/055 SPLIT IN TO TWO DRAWINGS 26138 278/051 AND 26138 278/052	01.06.11
	Issue Description	Date

**PRELIMINARY**  
**NOT TO BE USED FOR CONSTRUCTION**

Scales	1:250 @ A1	Current Issue Signatures		
		Author	K.L.	
Original Size	A1	Checker	SD	
Height		Approver		
Datum		B/G		
Grid				© Copyright reserved

FILED 08-051 AND 052 REV B PARKFIELD WAY 278 AGREEMENT PLAN.DWG

Client



# Crest

**Crest Nicholson (South) Ltd**  
Crest House Pycroft Road Chertsey  
Surrey KT16 9GN  
Tel: 01932 580444 Fax: 0870 336 3991

Tel: 01932 580444 Fax: 0870 336 3991

Tel: 01932 580444 Fax: 0870 336 3991

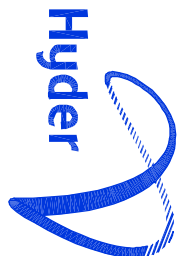

HYDER CONSULTING (UK) LTD  
29 Bressenden Place  
London

London

Tel: +44

Fax: +44 (0)870 000 3906

Fax: +44 (0)870 000 3906

# HAYWARDS HEATH OFF SITE WORKS

PARKFIELD WAY  
S278 LICENCE AGREEMENT  
PLAN - PHASE 2

Drawing No.	Project No.	Issue
278/052	—	26138
		— B