

Blackhorse Road

Axonometric

If any alterations or additions are needed to these layouts please



Not for construction purposes

Produced on behalf of the Fire Compliance Manager	
Total of 07 Drawings	Drawing number: V023 - 02s
Issue: 18/2009/10	Revision:
Survey Date: 14:04:09	Date:
Drawn by: RCD	Drawn by:
Information current at date shown	

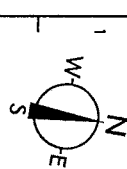

Plotted by : mikedovies1 LUL

MStnV8 (fsu)

PLATFORMS

TO WALTHAMSTOW CENTRAL

TO TOTTENHAM HALL

PLATFORM 2

PLATFORM 1

TICKET HALL

NOTE: The Axonometric should be used as a location guide.
For details of specific areas refer to the relevant sheets of the plan.

APPROXIMATE DEPTH BELOW STREET LEVEL

VICTORIA LINE PLATFORMS 16.8m

STATION LAYOUT

Produced on behalf of the
Fire Compliance Manager
b1

Total of 07 Drawings	Drawing number:
V059-01 to 07	V059 - 02S

Issue:	14 (2005/06)	Revision:
--------	--------------	-----------

Survey Date: 06:10:05	Date:
-----------------------	-------

Drawn by:	DMc	Drawn by:
-----------	-----	-----------

Information current at date shown.
F0

MStnV8 (fsu)

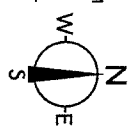

TICKET HALL

PLATFORMS 1 & 2
(WEST END)

PLATFORMS 1 & 2
(EAST END)

NOTE: The Axonometric should be used as a location guide.
For details of specific areas refer to the relevant sheets of the plan.

APPROXIMATE DEPTH BELOW STREET LEVEL

VICTORIA LINE PLATFORMS	17.6m
1	17.6m
2	17.6m
3	17.6m
4	17.6m
5	17.6m
6	17.6m
7	17.6m
8	17.6m
9	17.6m
10	17.6m
11	17.6m
12	17.6m
13	17.6m
14	17.6m
15	17.6m
16	17.6m
17	17.6m
18	17.6m
19	17.6m
20	17.6m
21	17.6m
22	17.6m
23	17.6m
24	17.6m
25	17.6m
26	17.6m
27	17.6m
28	17.6m
29	17.6m
30	17.6m
31	17.6m
32	17.6m
33	17.6m
34	17.6m
35	17.6m
36	17.6m
37	17.6m
38	17.6m
39	17.6m
40	17.6m
41	17.6m
42	17.6m
43	17.6m
44	17.6m
45	17.6m
46	17.6m
47	17.6m
48	17.6m
49	17.6m
50	17.6m
51	17.6m
52	17.6m
53	17.6m
54	17.6m
55	17.6m
56	17.6m
57	17.6m
58	17.6m
59	17.6m
60	17.6m
61	17.6m
62	17.6m
63	17.6m
64	17.6m
65	17.6m
66	17.6m
67	17.6m
68	17.6m
69	17.6m
70	17.6m
71	17.6m
72	17.6m
73	17.6m
74	17.6m
75	17.6m
76	17.6m
77	17.6m
78	17.6m
79	17.6m
80	17.6m
81	17.6m
82	17.6m
83	17.6m
84	17.6m
85	17.6m
86	17.6m
87	17.6m
88	17.6m
89	17.6m
90	17.6m
91	17.6m
92	17.6m
93	17.6m
94	17.6m
95	17.6m
96	17.6m
97	17.6m
98	17.6m
99	17.6m
100	17.6m

Produced by London Underground Limited. Enquiries should be directed to

STATION LAYOUT

If any alterations or additions are needed to these layout

Total of 12 Drawings	Drawing number:
N185-01 to 12	N185 - 02s

Drawn by:	RCD	Drawn by:
-----------	-----	-----------

Information current at date shown.

F

MStnV8 (fsu)

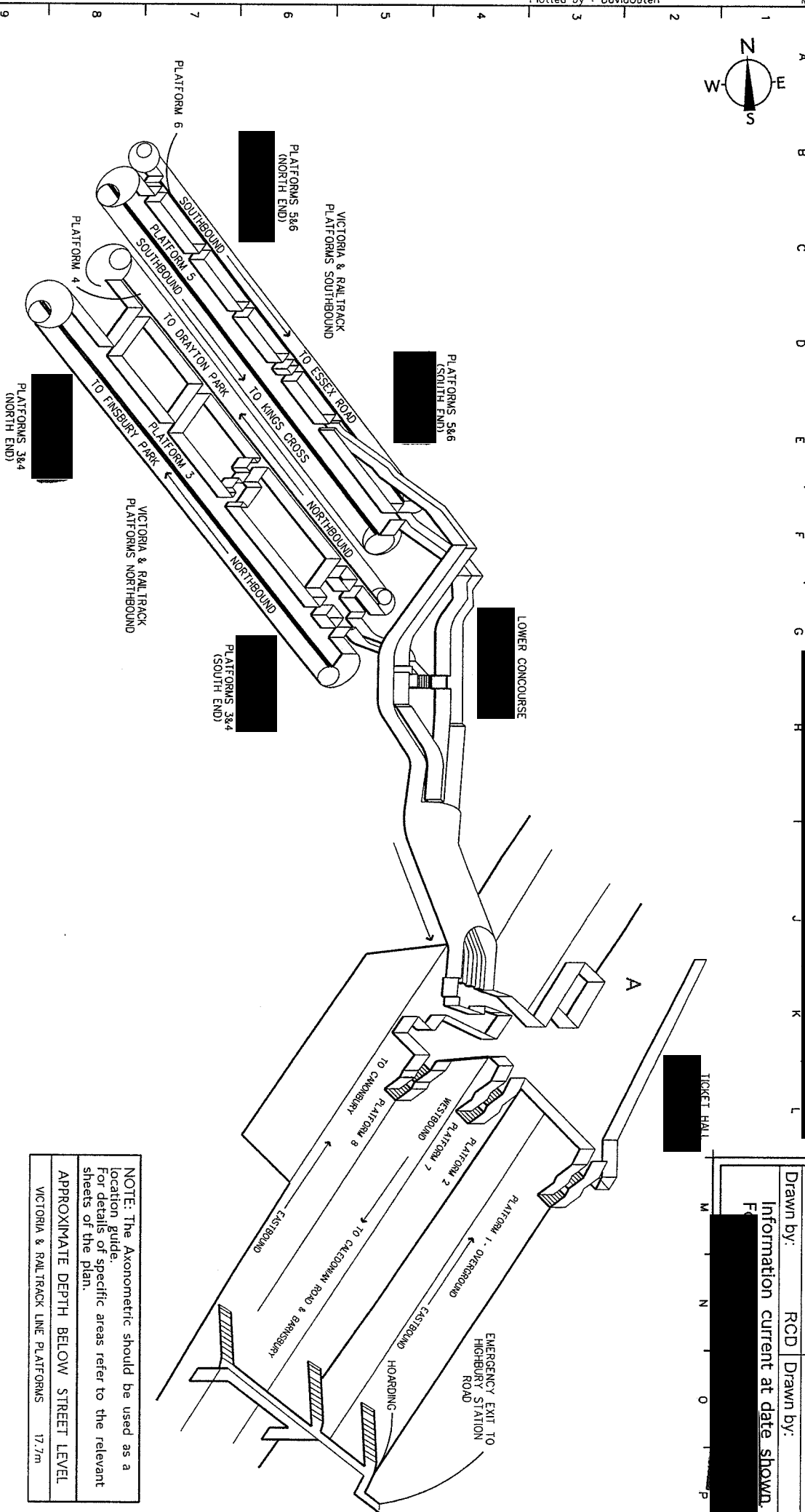

NOTE: the Axonometric should be used as a location guide.
For details of specific areas refer to the relevant sheets of the plan.

APPROXIMATE DEPTH BELOW STREET LEVEL

VICTORIA & RAILTRACK LINE PLATFORMS	17.7m
1	17.7m
2	17.7m
3	17.7m
4	17.7m
5	17.7m
6	17.7m
7	17.7m
8	17.7m
9	17.7m
10	17.7m
11	17.7m
12	17.7m
13	17.7m
14	17.7m
15	17.7m
16	17.7m
17	17.7m
18	17.7m
19	17.7m
20	17.7m
21	17.7m
22	17.7m
23	17.7m
24	17.7m
25	17.7m
26	17.7m
27	17.7m
28	17.7m
29	17.7m
30	17.7m
31	17.7m
32	17.7m
33	17.7m
34	17.7m
35	17.7m
36	17.7m
37	17.7m
38	17.7m
39	17.7m
40	17.7m
41	17.7m
42	17.7m
43	17.7m
44	17.7m
45	17.7m
46	17.7m
47	17.7m
48	17.7m
49	17.7m
50	17.7m
51	17.7m
52	17.7m
53	17.7m
54	17.7m
55	17.7m
56	17.7m
57	17.7m
58	17.7m
59	17.7m
60	17.7m
61	17.7m
62	17.7m
63	17.7m
64	17.7m
65	17.7m
66	17.7m
67	17.7m
68	17.7m
69	17.7m
70	17.7m
71	17.7m
72	17.7m
73	17.7m
74	17.7m
75	17.7m
76	17.7m
77	17.7m
78	17.7m
79	17.7m
80	17.7m
81	17.7m
82	17.7m
83	17.7m
84	17.7m
85	17.7m
86	17.7m
87	17.7m
88	17.7m
89	17.7m
90	17.7m
91	17.7m
92	17.7m
93	17.7m
94	17.7m
95	17.7m
96	17.7m
97	17.7m
98	17.7m
99	17.7m
100	17.7m

Pimlico
Axonometric

If any alterations or additions are needed to these layouts please contact [REDACTED]

UNDERGROUND
STATION LAYOUT

Not for construction purposes

Produced on behalf of the
Fire Compliance Manager
by [REDACTED]

Total of 07 Drawings
V053-01 to 07
Drawing number:
V053 - 02s

Issue: 14 (2004/05)
Survey Date: 31:08:05
Revision:
Date:

Drawn by: DMC
Drawn by:

Information current at date shown
For [REDACTED]

M N O P

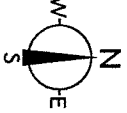

Plotted by : mikedavies1 LUL

MSnVB (fsu)

PLATFORMS 1 & 2
(WEST END)

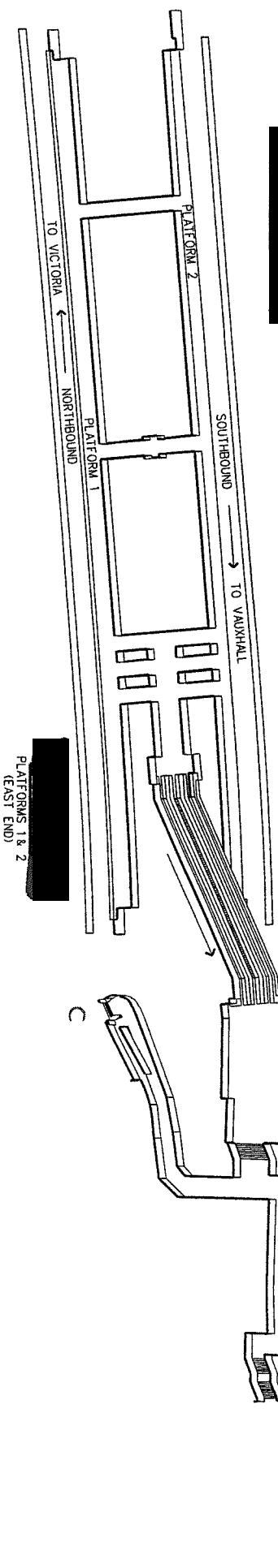

NOTE: The Axonometric should be used as a
location guide.
For details of specific areas refer to the relevant
sheets of the plan.
APPROXIMATE DEPTH BELOW STREET LEVEL
VICTORIA LINE PLATFORMS 22.5m

Seven Sisters Axonometric

If any alterations or additions are needed to these layouts please contact [redacted]

STATION LAYOUT

Not for construction purposes

Produced on behalf of the
Fire Compliance Manager
by [redacted]

Total of 09 Drawings
V027-01 to 09
Drawing number:
V027 - 02S

Issue: 14 (2004/05)
Survey Date: 23:08:05
Revision:
Date:

Drawn by: DMC
Drawn by:

Information current at date shown

[redacted]

NOTE: The Axonometric should be used as a location guide. For details of specific areas refer to the relevant sheets of the plan.
APPROXIMATE DEPTH BELOW STREET LEVEL
VICTORIA LINE PLATFORMS 18.6m

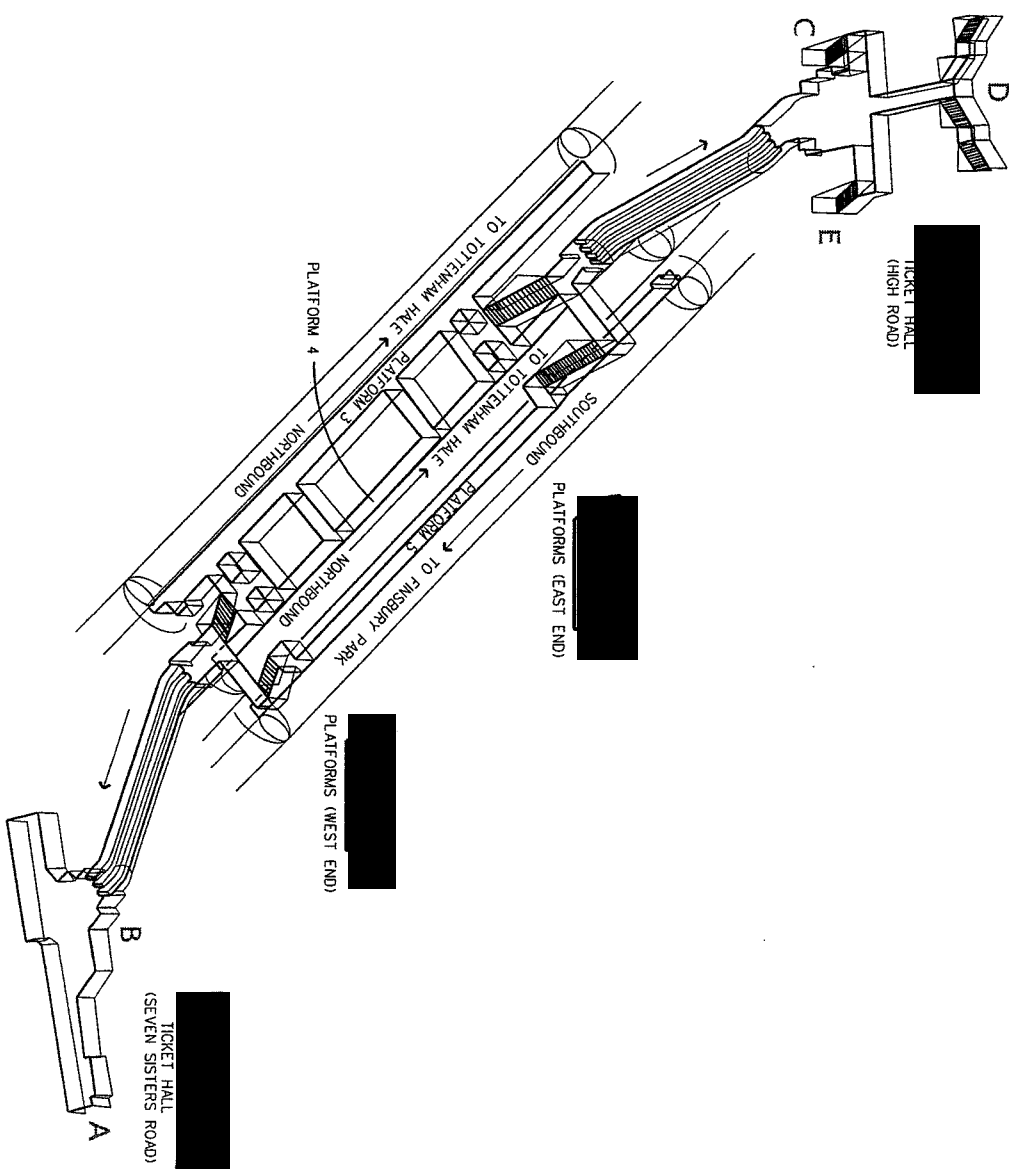
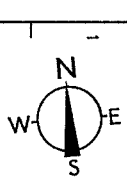

Tottenham Hale

Axonometric

If any alterations or additions are needed to these layouts please

STATION LAYOUT

Not for construction purposes



Produced on behalf of the
Fire Compliance Manager

Total of 07 Drawings	Drawing number:
V025 - 01 to 07	V025 - 02s
Issue: 14 (2005/06)	Revision:
Survey Date: 09:06:05	Date:
Drawn by: DMC	Drawn by:

Information current at date shown

For

NOTE: The Axonometric should be used as a
location guide.
For details of specific areas refer to the relevant
sheets of the plan.

APPROXIMATE DEPTH BELOW STREET LEVEL
VICTORIA LINE PLATFORMS 16.8m

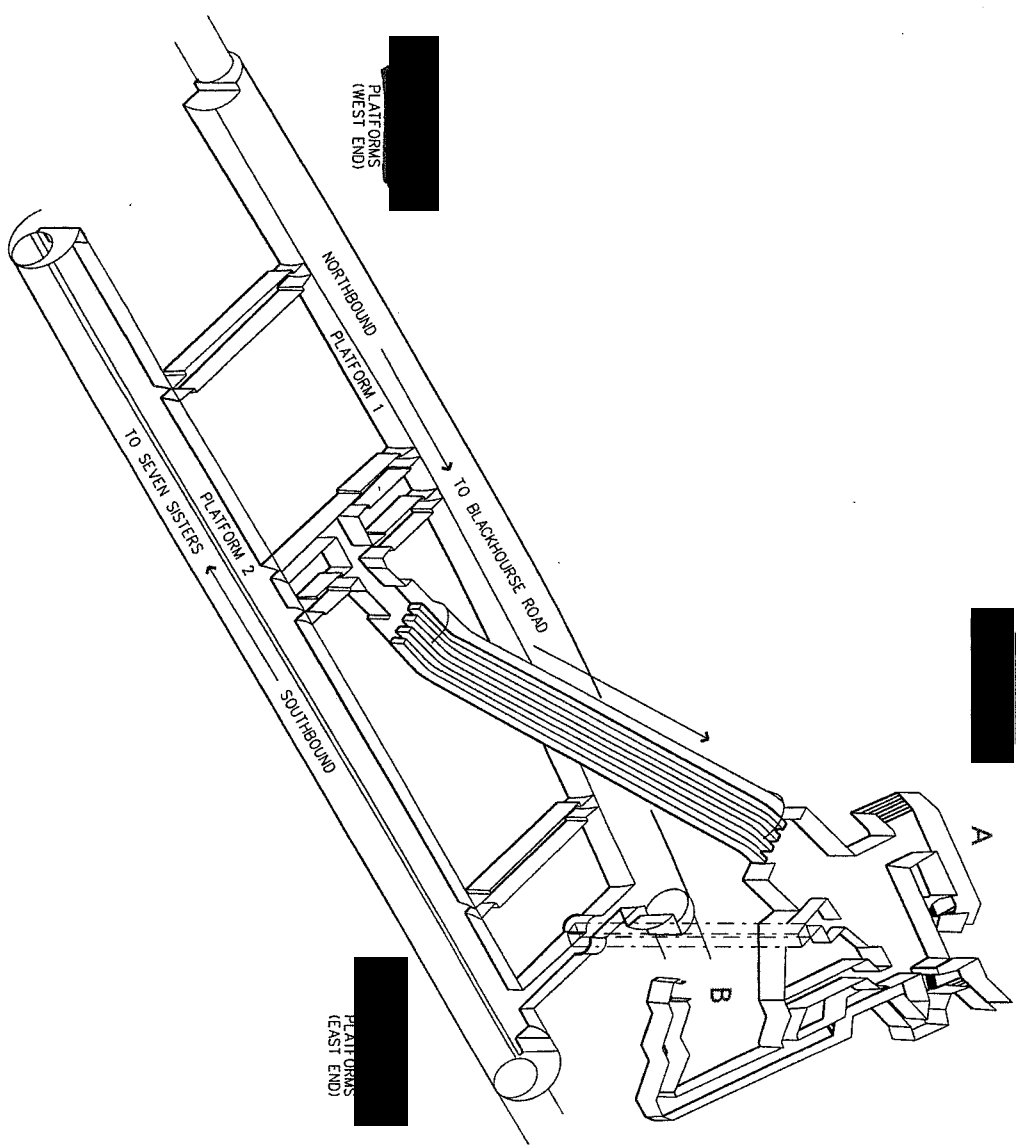

Vauxhall

Axonomic

If any alterations or additions are needed to these layouts please

STATION LAYOUT

Not for construction purposes

Produced on behalf of the Fire Compliance Manager	
Total of 09 Drawings	Drawing number: V055 - 02S
V055 - 01 to 09	
Issue: 14 (2005/06)	Revision: B
Survey Date: 24/06/05	Date: 04/04/13
Drawn by: DMC	Drawn by: AS
Information current at date shown.	

NOTE:
SUBWAY PASSAGES
BELONG TO
LOCAL AUTHORITY

NOTE: The Axonomic should be used as a location guide.
For details of specific areas refer to the relevant sheets of the plan.

APPROXIMATE DEPTH BELOW STREET LEVEL

VICTORIA LINE PLATFORMS 17.5m



Plotted by : RafaelaZamoranoCordo

MSInV8 (fsu)

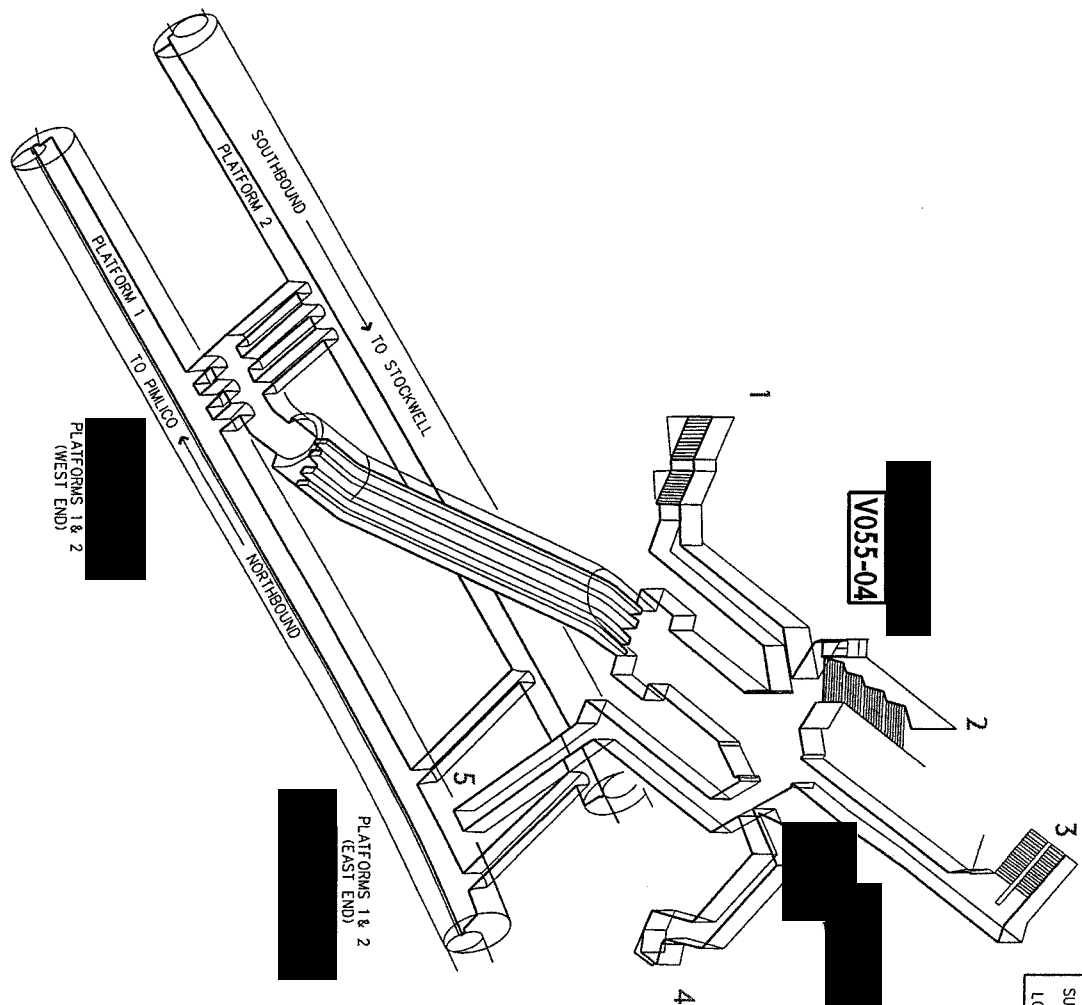

Malthamstow Central

Axonometric

If any alterations or additions are needed to these layouts please



Not for construction purposes

Produced on behalf of the Fire Compliance Manager	
by the Lo	
Total of 07 Drawings	Drawing number: V021-01 to 07
Issue: 14 (2005/06)	Revision: A
Survey Date: 17:08:05	Date: 15:08:08
Drawn by: DMc	Drawn by: RCD
Information current at date shown.	

NOTE: The Axonometric should be used as a location guide. For details of specific areas refer to the relevant sheets of the plan.	
APPROXIMATE DEPTH BELOW STREET LEVEL	16.5m
VICTORIA LINE PLATFORMS	

