

Basic Results Summary

## Basic Results Summary

### User and Project Details

Project:	Centre Point
Title:	St. Giles High Street – Existing
Location:	Central London
File name:	St Giles High Street - Existing.lsg3x
Author:	RZG
Company:	Steer Davies Gleave
Address:	28-32 Upper Ground, London, SE1 9PD
Notes:	N/A

Scenario 1: 'AM Peak' (FG1: 'AM Peak', Plan 1: 'Network Control Plan 1')

### Phase Diagram

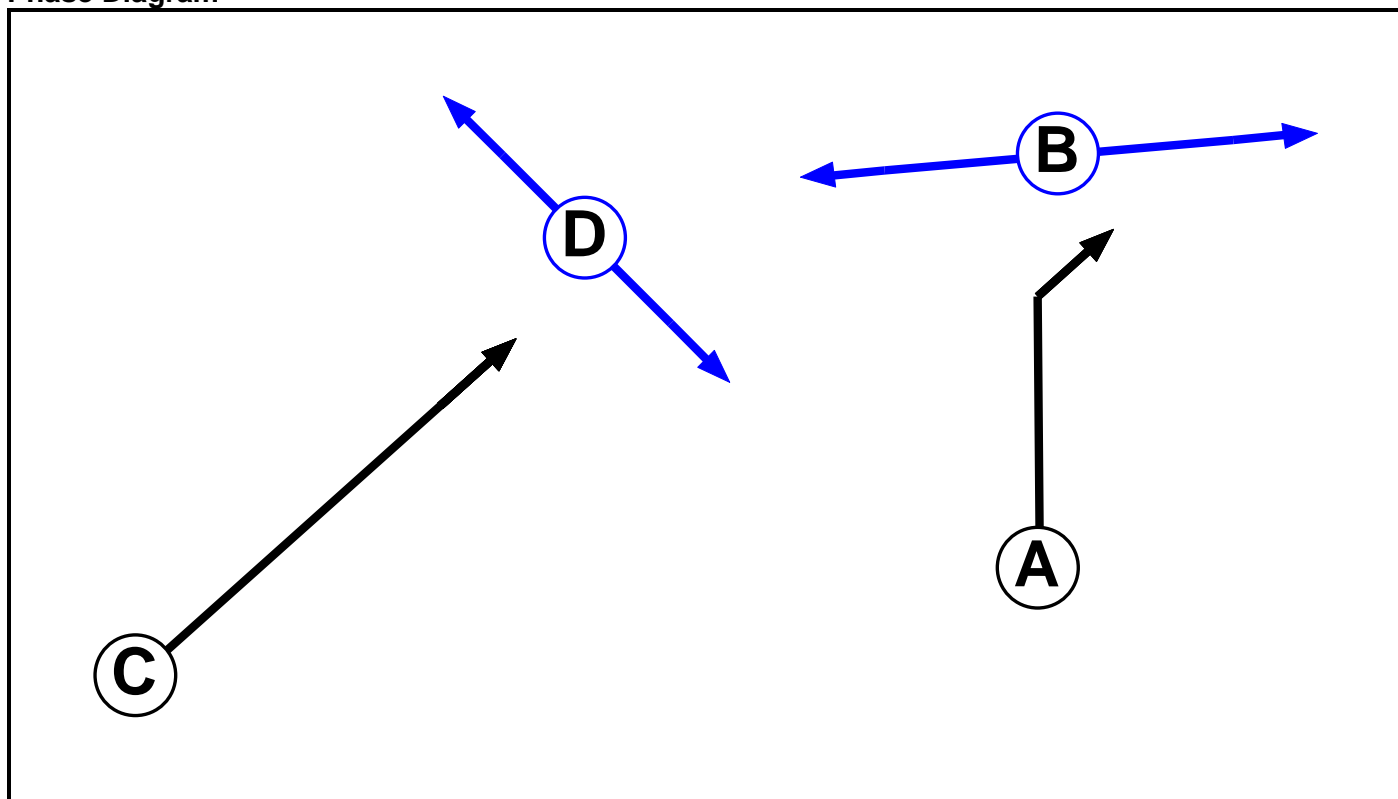

### Phase Input Data

Phase Name	Phase Type	Assoc. Phase	Street Min	Cont Min
A	Traffic		7	7
B	Pedestrian		5	5
C	Traffic		7	7
D	Pedestrian		5	5

Basic Results Summary

Phase Intergreens Matrix

Terminating Phase	Starting Phase				
		A	B	C	D
	A		8	7	-
	B	8		-	-
	C	7	-		12
	D	-	-	12	

Phase Delays

Term. Stage	Start Stage	Phase	Type	Value	Cont value
There are no Phase Delays defined					

Stage Diagram

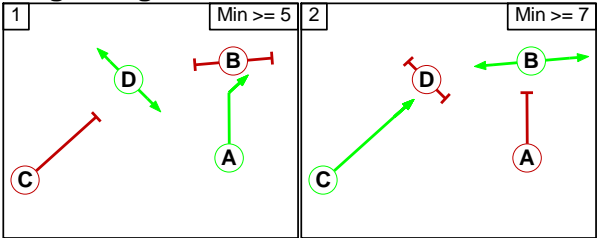

Stage Minimums

Stage 1 Minimums for all possible Stage Changes

via Stage 1	To	
From		Stage 2
	Stage 2	5

Stage 2 Minimums for all possible Stage Changes

via Stage 2	To	
From		Stage 1
	Stage 1	7

Overall Minimums

	Stage 1	Stage 2
Minimum	5	7

Lane Saturation Flows

Junction: St. Giles High Street Junction								
Lane	Lane Width (m)	Gradient	Nearside Lane	Allowed Turns	Turning Radius (m)	Turning Prop.	Sat Flow (PCU/Hr)	Flared Sat Flow (PCU/Hr)
1/1 (Charing Cross Road Diversion)	3.00	0.00	Y	Arm 3 Ahead	Inf	100.0 %	1915	1915
1/2 (Charing Cross Road Diversion)	3.00	0.00	N	Arm 3 Ahead	Inf	100.0 %	2055	2055
2/1 (St. Giles High Street)	4.00	0.00	Y	Arm 3 Right	10.00	100.0 %	1752	1752
3/1 (St. Giles High Street North Lane 1)	Infinite Saturation Flow						Inf	Inf
3/2 (St. Giles High Street North Lane 2)	Infinite Saturation Flow						Inf	Inf
3/3 (St. Giles High Street North Lane 3)	Infinite Saturation Flow						Inf	Inf

Traffic Flow Groups

Flow Group	Start Time	End Time	Duration	Formula
1: 'AM Peak'	08:00	09:00	01:00	

Stage Timings

Stage	1	2
Duration	17	39
Change Point	0	29

Stage Sequence Diagram

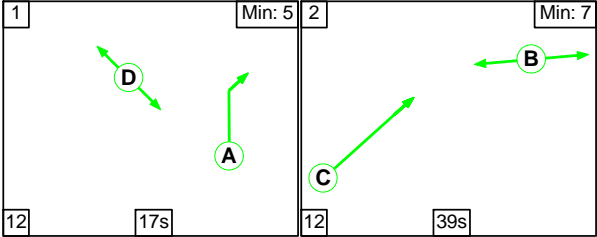

Network Layout Diagram

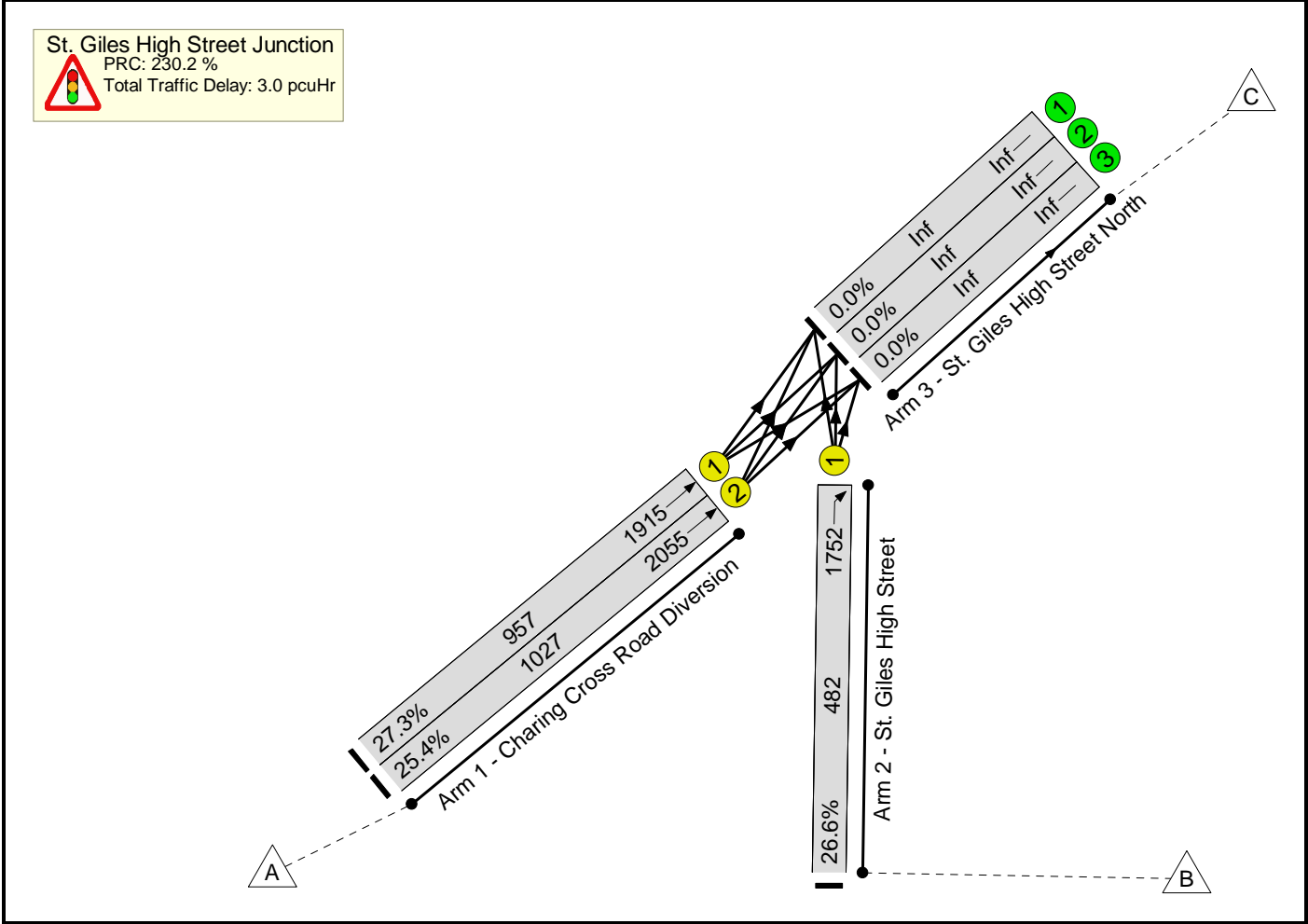

## Network Results

Basic Results Summary  
**Flow Profiles Diagram**

No Flow Profiles were specified in the Cyclic Flow Profiles View

**Scenario 2: 'PM Peak'** (FG2: 'PM Peak', Plan 1: 'Network Control Plan 1')

**Phase Diagram**

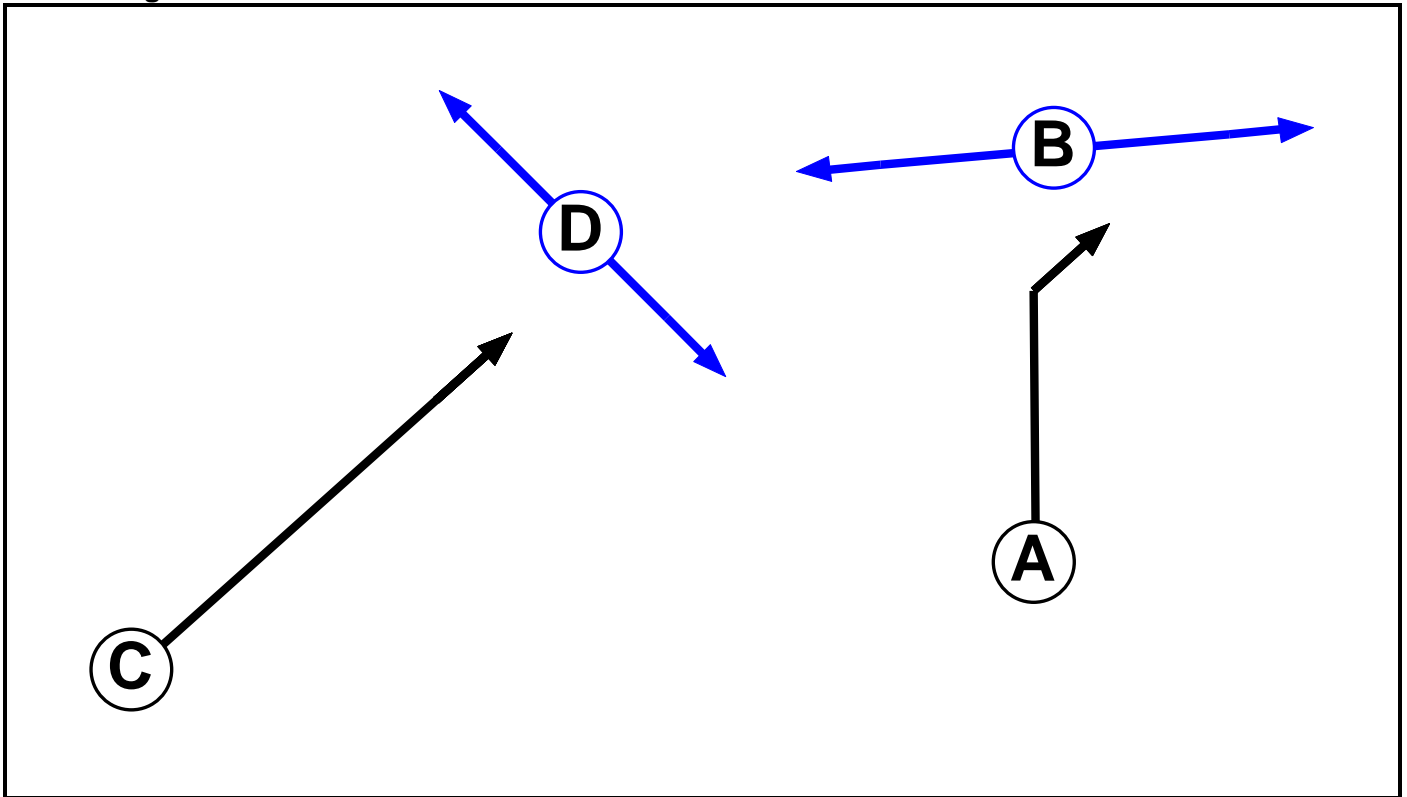

**Phase Input Data**

Phase Name	Phase Type	Assoc. Phase	Street Min	Cont Min
A	Traffic		7	7
B	Pedestrian		5	5
C	Traffic		7	7
D	Pedestrian		5	5

**Phase Intergreens Matrix**

	Starting Phase				
Terminating Phase		A	B	C	D
	A		8	7	-
	B	8		-	-
	C	7	-		12
	D	-	-	12	

**Phase Delays**

Term. Stage	Start Stage	Phase	Type	Value	Cont value
There are no Phase Delays defined					

## Basic Results Summary

### Stage Diagram

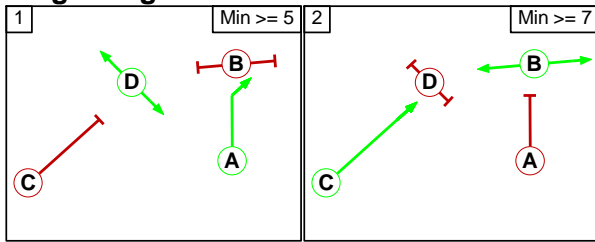

### Stage Minimums

#### Stage 1 Minimums for all possible Stage Changes

via Stage 1	To	
From		Stage 2
	Stage 2	5

#### Stage 2 Minimums for all possible Stage Changes

via Stage 2	To	
From		Stage 1
	Stage 1	7

#### Overall Minimums

	Stage 1	Stage 2
Minimum	5	7

### Lane Saturation Flows

Junction: St. Giles High Street Junction								
Lane	Lane Width (m)	Gradient	Nearside Lane	Allowed Turns	Turning Radius (m)	Turning Prop.	Sat Flow (PCU/Hr)	Flared Sat Flow (PCU/Hr)
1/1 (Charing Cross Road Diversion)	3.00	0.00	Y	Arm 3 Ahead	Inf	100.0 %	1915	1915
1/2 (Charing Cross Road Diversion)	3.00	0.00	N	Arm 3 Ahead	Inf	100.0 %	2055	2055
2/1 (St. Giles High Street)	4.00	0.00	Y	Arm 3 Right	10.00	100.0 %	1752	1752
3/1 (St. Giles High Street North Lane 1)	Infinite Saturation Flow						Inf	Inf
3/2 (St. Giles High Street North Lane 2)	Infinite Saturation Flow						Inf	Inf
3/3 (St. Giles High Street North Lane 3)	Infinite Saturation Flow						Inf	Inf

### Traffic Flow Groups

Flow Group	Start Time	End Time	Duration	Formula
2: 'PM Peak'	18:00	19:00	01:00	

Basic Results Summary

Stage Timings

Stage	1	2
Duration	15	41
Change Point	0	27

Stage Sequence Diagram

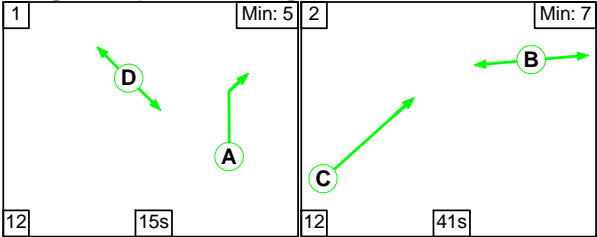

Network Layout Diagram

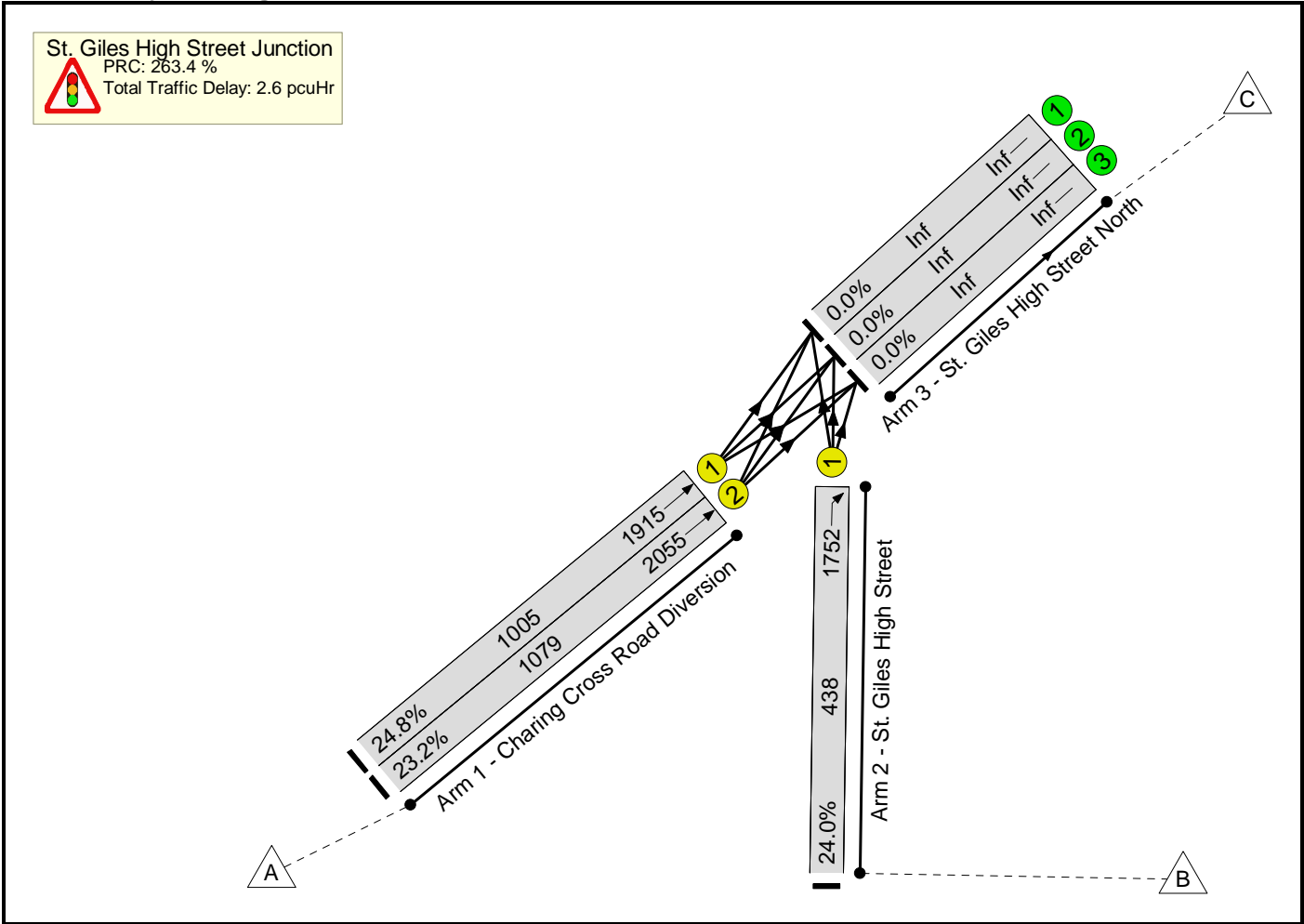



## Network Results

Basic Results Summary

## **Flow Profiles Diagram**

No Flow Profiles were specified in the Cyclic Flow Profiles View