



TRANSPORT PLANNING

11 Kingsmead Square

Bath BA1 2AB

t: 01225 444011

f: 01225 444550

www.ima-tp.com

PROPOSED RESIDENTIAL DEVELOPMENT,
UPPER MARSH ROAD, WARMINSTER

Transport Statement
Volume 2 - Figures & Appendices

December 2017

IMA-17-167

Figures TS-1 to TS-4

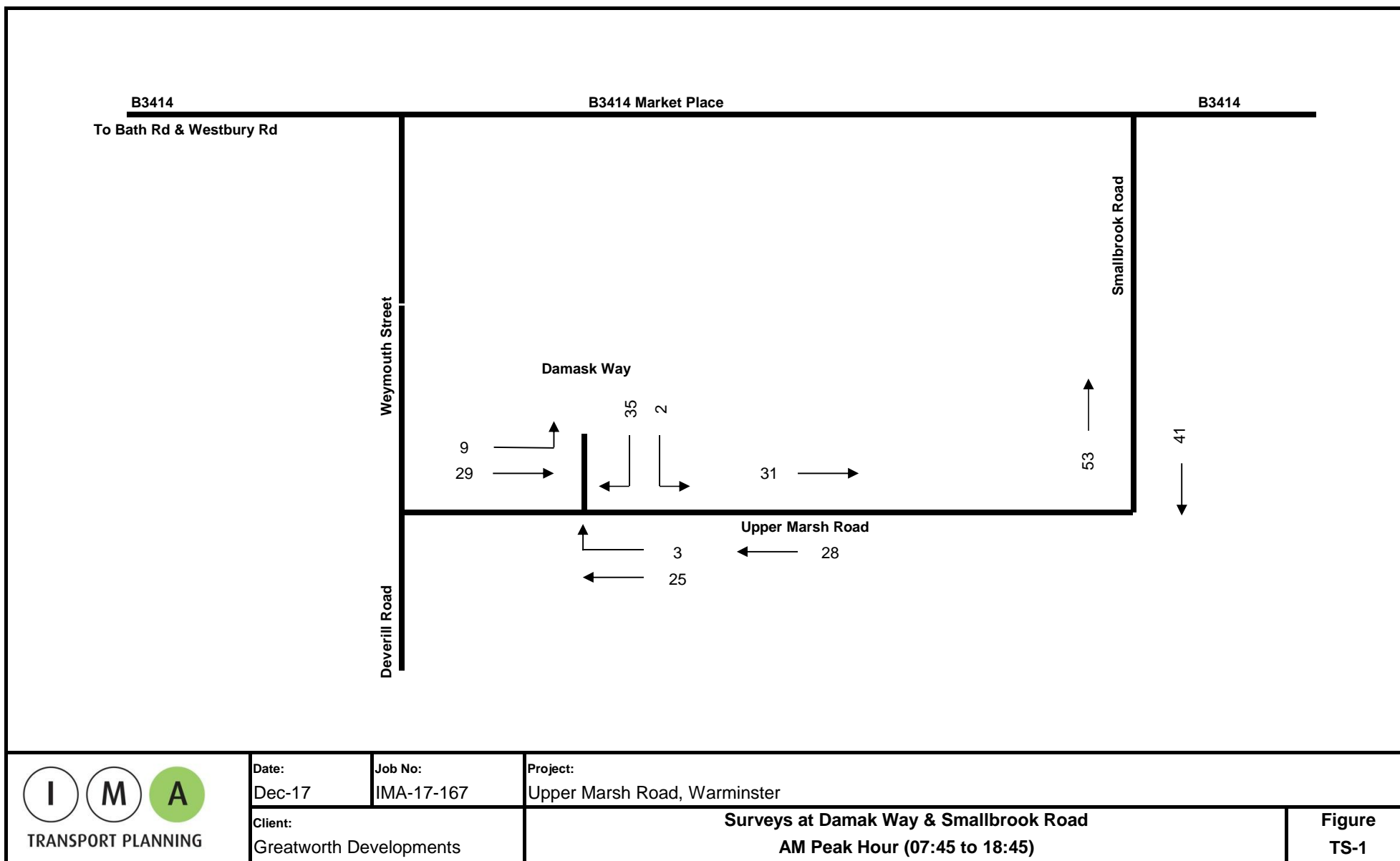

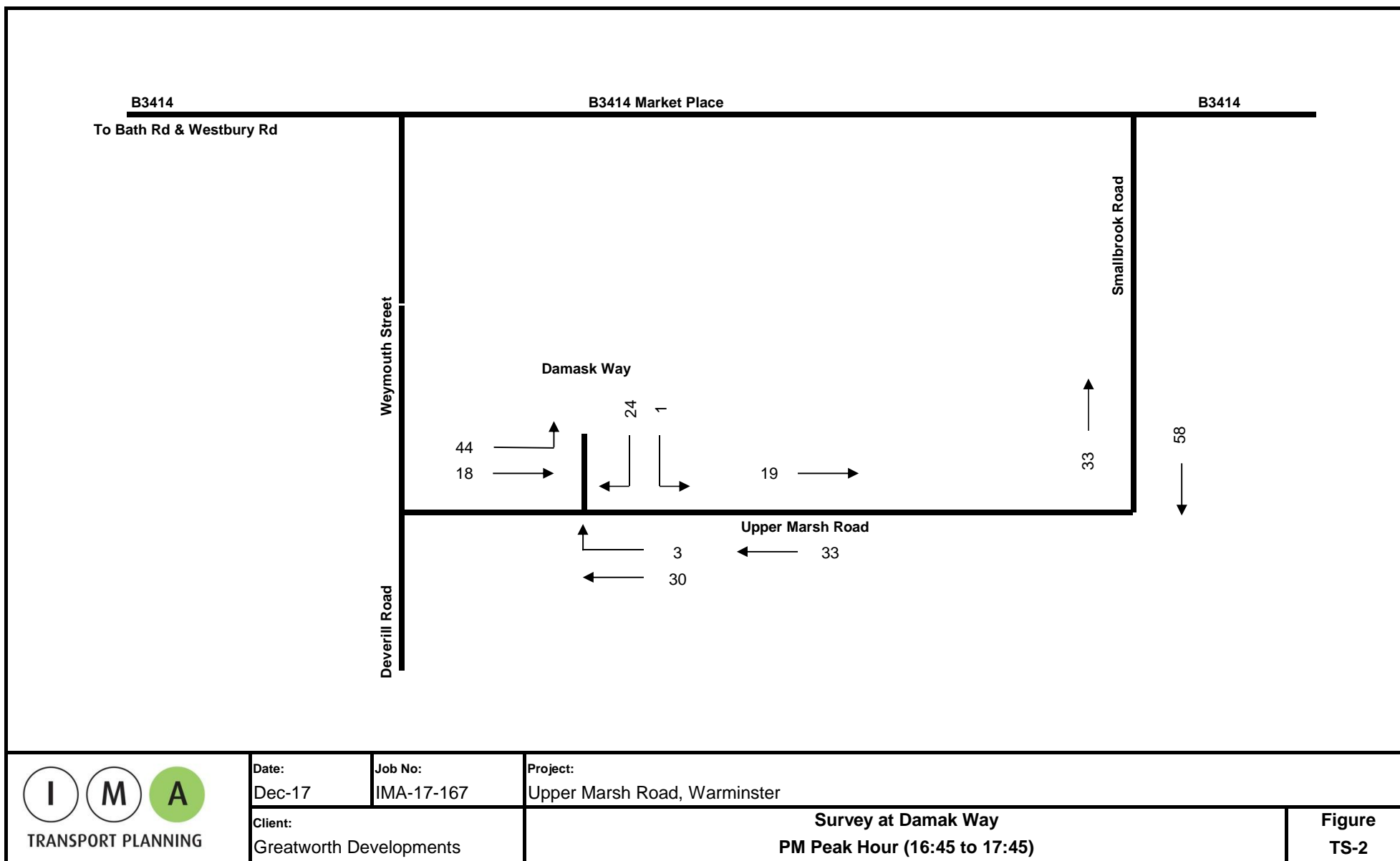

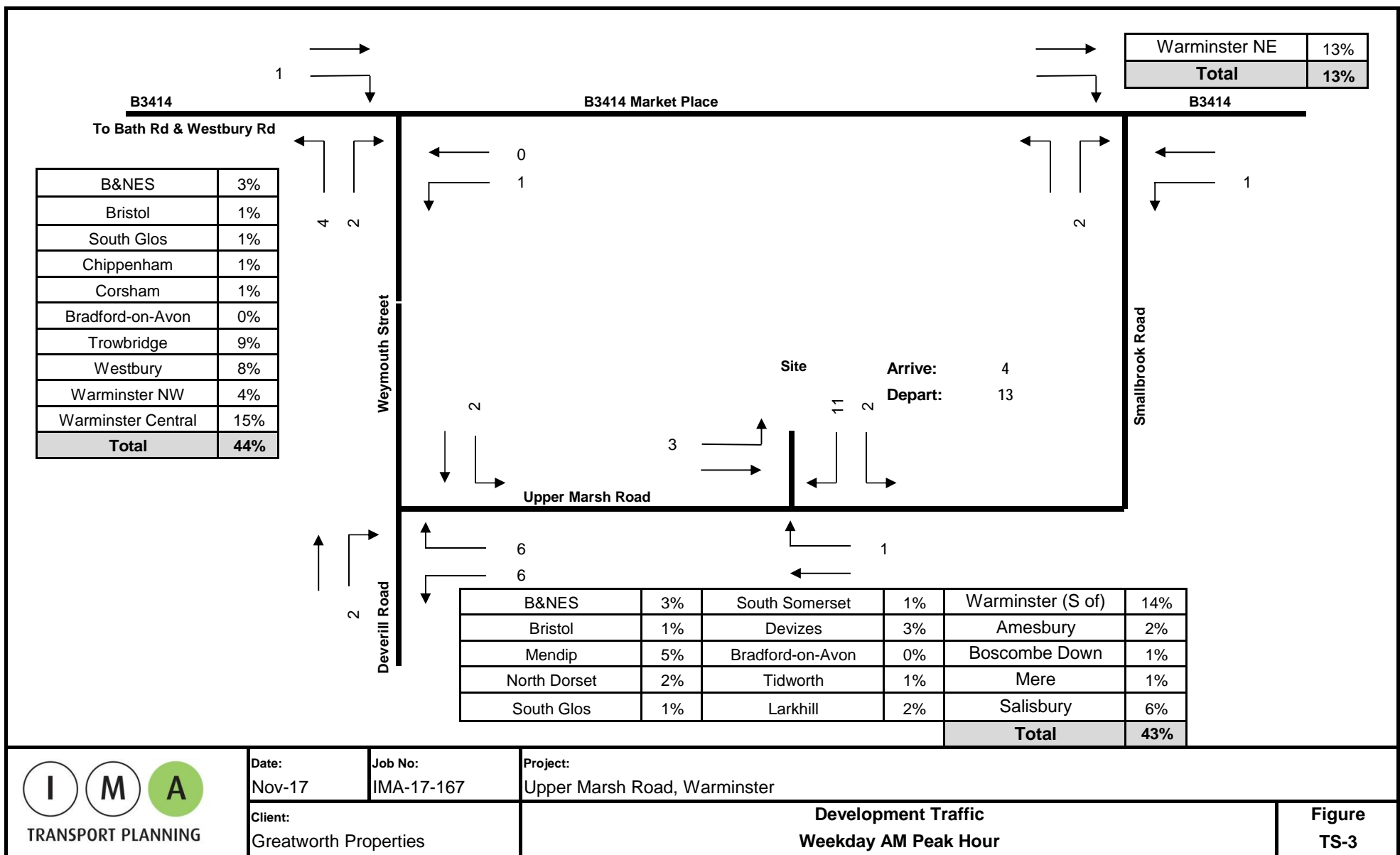

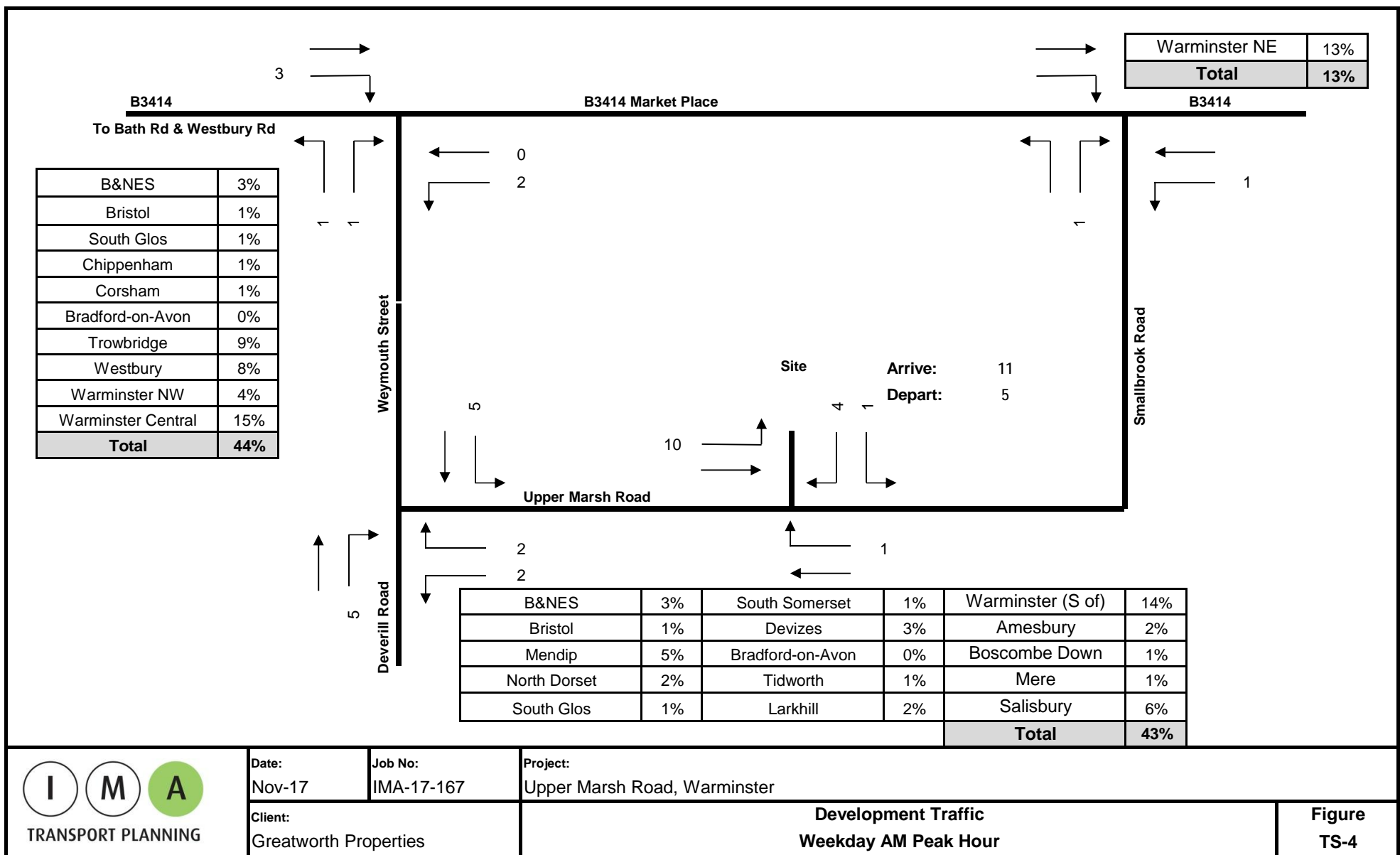



Appendix TS-1

(LHA Pre-Application Response)

From: Manns, Christopher <Chris.Manns@wiltshire.gov.uk>
Sent: 18 October 2017 15:31
To: Sims, Steven
Cc: Eattell, Marianne; Blake, Heather
Subject: 17/08219/PREAPP - Land East of Damask Way, Smallbrook Lane, Warminster (GI_17_485)

Hi Steve,

I refer to the above mentioned pre-application and I apologise for the delay in responding. I make the following Highway comments;

Firstly, I believe that the principle of residential development in this location is accepted and I note previous development that has taken place in recent history that abuts this site. The submitted documentation does not specify the likely number of dwellings proposed, which makes guidance on the required highway infrastructure more difficult.

Access is proposed from Upper Marsh Road, which will involve the upgrade of the existing emergency link provided by previous development. Upper Marsh Road is narrow in this location and does not benefit from any pedestrian facilities, however, I do note that the proposals seek to widen Upper Marsh Road to the west, which will improve the situation. Despite this, an adequate means of access to the site is essential, including appropriate visibility splays in both directions.

The proposed alignment of the access is far too acute and would create additional manoeuvres on the highway, which would be unacceptable. I note that the submission states that the acute angle of the access would self-enforce and prevent vehicles from turning left out/ right in to the site, however, this is not an acceptable arrangement. Furthermore, consideration must be given to service/ delivery vehicles and more importantly, refuse and emergency service vehicles, all of whom may approach/exit from/to the east. I have also spoken to my waste collection colleagues, who also have objections to this junction alignment and I would recommend that they are consulted as part of this application. Due to the site level differences, long-sections will be required to demonstrate that a maximum gradient of 1 in 30 can be achieved over the first 9m of the access and 1 in 12.5 over of the rest of the site.

Assuming an adequate junction alignment and gradient can be achieved, the proposed widening of Upper Marsh Road would be welcomed subject to details. It is also essential that adequate visibility is provided at this junction in both directions and Automated Traffic Count (ATC) data demonstrating that vehicle speeds are lower than 30mph in this location is essential if lesser visibility splays are proposed. Normally, a 30mph road would require visibility splays of 2.4m x 43m in both directions.

I note the submitted documentation states that previous Highway advice suggests that the internal site roads would be accepted as long as they formed at least a 4.5m wide carriageway, with a 1.5m wide footway and 0.5m rubbing strip, or; a 5.5m shared surface road, with 1m verge. These comments were made on application 14/01661/OUT and therefore refer to a development of only 5 dwellings served by a shared private drive. These road dimensions would therefore only be acceptable for a development serving up to a maximum of 25 dwellings in a loop or 12 dwellings in a cul de sac.

For clarity, a development of more than 25 dwellings would need to be served by either a 5.5m road, with two 2m wide footways, or; a 5.5m shared surface road, with a 2m service strip and 0.5m rubbing strip.

I am satisfied with the proposed approach for the Transport Statement, including the use of ATC, turning counts, census data and TRICs.

Wiltshire, BA14 8JN
Email: Christopher.Manns@wiltshire.gov.uk
Web: www.wiltshire.gov.uk

Follow Wiltshire Council



www.connectingwiltshire.co.uk



Appendix TS-2

(Out-Commuting Distribution Derivation)

WF01BEW - Location of usual residence and place of work (OA level)

ONS Crown Copyright Reserved [from Nomis on 16 November 2017]

population

All usual residents ages 16 and over in employment the week before the census

units

Persons

date

2011

Place of Work	Currently Residing In	
	E02006694 : Wiltshire 044	
	Commuters	%age
Bath and North East Somerset	122	6%
Bristol, City of	32	2%
Mendip	82	4%
North Dorset	30	1%
South Gloucestershire	29	1%
South Somerset	13	1%
Wiltshire	1,795	85%
Totals	2,103	100%

Place of Work	Commuters	%age	Location
E02006638 : Wiltshire 026	14	1%	Devizes
E02006654 : Wiltshire 011	13	1%	Chippenham
E02006660 : Wiltshire 018	13	1%	Corsham
E02006661 : Wiltshire 045	43	2%	Netheravon
E02006663 : Wiltshire 048	28	1%	Amesbury
E02006664 : Wiltshire 049	20	1%	Boscombe Down
E02006665 : Wiltshire 050	19	1%	Mere
E02006670 : Wiltshire 055	30	1%	Salisbury
E02006671 : Wiltshire 056	22	1%	Salisbury
E02006672 : Wiltshire 057	22	1%	Salisbury
E02006673 : Wiltshire 058	14	1%	Salisbury
E02006682 : Wiltshire 027	12	1%	Bradford-on-Avon
E02006684 : Wiltshire 031	86	4%	Trowbridge
E02006685 : Wiltshire 032	12	1%	Trowbridge
E02006687 : Wiltshire 035	18	1%	Trowbridge
E02006688 : Wiltshire 036	14	1%	Trowbridge
E02006689 : Wiltshire 037	40	2%	Trowbridge
E02006690 : Wiltshire 039	59	3%	Westbury
E02006691 : Wiltshire 040	67	3%	Westbury
E02006692 : Wiltshire 042	293	14%	Warminster NE
E02006693 : Wiltshire 043	99	5%	Warminster W
E02006694 : Wiltshire 044	590	28%	Warminster S/C
E02006695 : Wiltshire 047	267	13%	Warminster S of
Totals	1,795	85%	

Place of Work	Commuters	%age	Entry/Exit Route				
			North West (Bath Road)	North (Weymouth Street)	North (Westbury Road)	North East (Smallbrook Road)	South (Deverill Road)
Warminster (South & Central)	590	28%					
Warminster (North East)	293	19%				19%	
Warminster (South of)	267	18%					18%
Trowbridge	170	11%	11%				
Westbury	126	8%			8%		
Bath and North East Somerset	122	8%	8%				
Warminster (West/North West)	99	7%	7%				
Salisbury	88	6%					6%
Mendip	82	5%					5%
Netheravon	43	3%					3%
Bristol, City of	32	2%					2%
North Dorset	30	2%					2%
South Gloucestershire	29	2%					2%
Amesbury	28	2%					2%
Boscombe Down	20	1%					1%
Mere	19	1%					1%
Devizes	14	1%					1%
South Somerset	13	1%					1%
Chippenham	13	1%			1%		
Corsham	13	1%			1%		
Bradford-on-Avon	12	1%	1%				
Totals	1,513	100%	27%	0%	10%	19%	44%

Note: Warminster South & Central MSOA is excluded from vehicular distribution as it is in walking distance

Appendix TS-3

(Damask Way Survey)

Appendix TS-4

(Smallbrook Road ATC)

22160	WARMINSTER			Site No: 22160001 Channel: Eastbound		Location	Smallbrook Road, Warminster (30/60mph Sign)			
	Sat	Sun	Mon	Tue	Wed	Thu	Fri	5-Day	7-Day	
TIME PERIOD	18/11/17	19/11/17	20/11/17	21/11/17	22/11/17	23/11/17	24/11/17	Av	Av	
Week Begin: 18-Nov-17										
00:00	0	2	0	1	1	1	2	1	1	
01:00	2	0	0	0	0	0	0	0	0	
02:00	0	1	0	0	1	0	0	0	0	
03:00	1	1	0	0	0	0	0	0	0	
04:00	0	0	0	0	0	0	0	0	0	
05:00	0	0	1	0	0	2	1	1	1	
06:00	2	1	2	7	6	7	5	5	4	
07:00	11	5	27	31	24	25	18	25	20	
08:00	19	7	55	55	51	52	54	53	42	
09:00	24	12	18	26	25	24	34	25	23	
10:00	20	19	19	27	17	13	20	19	19	
11:00	33	24	24	26	21	20	24	23	25	
12:00	15	22	20	15	19	21	22	19	19	
13:00	39	21	17	28	21	27	24	23	25	
14:00	30	12	30	31	24	39	49	35	31	
15:00	20	15	33	22	44	39	39	35	30	
16:00	19	16	32	33	33	26	40	33	28	
17:00	4	9	19	26	21	26	38	26	20	
18:00	13	8	21	17	15	17	17	17	15	
19:00	10	11	10	11	10	17	20	14	13	
20:00	7	3	8	11	7	7	13	9	8	
21:00	2	5	14	6	6	4	5	7	6	
22:00	3	2	6	9	5	11	10	8	7	
23:00	5	0	1	0	1	1	5	2	2	
12H,7-19	247	170	315	337	315	329	379	335	299	
16H,6-22	268	190	349	372	344	364	422	370	330	
18H,6-24	276	192	356	381	350	376	437	380	338	
24H,0-24	279	196	357	382	352	379	440	382	341	
Am	11:00	11:00	08:00	08:00	08:00	08:00	08:00	-	-	
Peak	33	24	55	55	51	52	54	53	46	
Pm	13:00	12:00	15:00	16:00	15:00	15:00	14:00	-	-	
Peak	39	22	33	33	44	39	49	40	37	

22160	WARMINSTER			Site No: 22160001 Channel: Westbound		Location	Smallbrook Road, Warminster (30/60mph Sign)			
	Sat	Sun	Mon	Tue	Wed	Thu	Fri	5-Day	7-Day	
TIME PERIOD	18/11/17	19/11/17	20/11/17	21/11/17	22/11/17	23/11/17	24/11/17	Av	Av	
Week Begin: 18-Nov-17										
00:00	1	0	0	0	0	0	0	0	0	
01:00	0	0	0	0	0	1	0	0	0	
02:00	0	0	0	0	0	0	0	0	0	
03:00	1	2	0	0	1	0	0	0	1	
04:00	0	0	0	0	0	0	1	0	0	
05:00	0	1	3	0	0	0	1	1	1	
06:00	1	0	1	6	4	1	4	3	2	
07:00	10	4	10	8	9	6	11	9	8	
08:00	12	9	39	36	39	40	50	41	32	
09:00	13	9	28	23	23	26	20	24	20	
10:00	26	21	20	19	14	16	22	18	20	
11:00	36	32	21	21	20	25	24	22	26	
12:00	39	22	22	34	27	30	25	28	28	
13:00	28	26	31	22	29	31	27	28	28	
14:00	25	19	29	22	23	22	43	28	26	
15:00	16	18	57	42	54	50	103	61	49	
16:00	24	16	36	67	62	52	75	58	47	
17:00	6	5	28	27	42	31	63	38	29	
18:00	13	5	23	12	15	17	21	18	15	
19:00	11	5	12	12	12	17	17	14	12	
20:00	1	5	10	14	7	10	7	10	8	
21:00	6	3	5	9	7	8	6	7	6	
22:00	5	4	3	5	4	7	6	5	5	
23:00	5	0	2	1	0	1	4	2	2	
12H,7-19	248	186	344	333	357	346	484	373	328	
16H,6-22	267	199	372	374	387	382	518	407	357	
18H,6-24	277	203	377	380	391	390	528	413	364	
24H,0-24	279	206	380	380	392	391	530	415	365	
Am	11:00	11:00	08:00	08:00	08:00	08:00	08:00	-	-	
Peak	36	32	39	36	39	40	50	41	39	
Pm	12:00	13:00	15:00	16:00	16:00	16:00	15:00	-	-	
Peak	39	26	57	67	62	52	103	68	58	

22160	WARMINSTER			Site No: 22160001 Two-Way		Location	Smallbrook Road, Warminster (30/60mph Sign)			
	Sat	Sun	Mon	Tue	Wed	Thu	Fri	5-Day	7-Day	
TIME PERIOD	18/11/17	19/11/17	20/11/17	21/11/17	22/11/17	23/11/17	24/11/17	Av	Av	
Week Begin: 18-Nov-17										
00:00	1	2	0	1	1	1	2	1	1	
01:00	2	0	0	0	0	1	0	0	0	
02:00	0	1	0	0	1	0	0	0	0	
03:00	2	3	0	0	1	0	0	0	1	
04:00	0	0	0	0	0	0	1	0	0	
05:00	0	1	4	0	0	2	2	2	2	
06:00	3	1	3	13	10	8	9	8	6	
07:00	21	9	37	39	33	31	29	34	28	
08:00	31	16	94	91	90	92	104	94	74	
09:00	37	21	46	49	48	50	54	49	43	
10:00	46	40	39	46	31	29	42	37	39	
11:00	69	56	45	47	41	45	48	45	51	
12:00	54	44	42	49	46	51	47	47	47	
13:00	67	47	48	50	50	58	51	51	53	
14:00	55	31	59	53	47	61	92	63	57	
15:00	36	33	90	64	98	89	142	96	79	
16:00	43	32	68	100	95	78	115	91	75	
17:00	10	14	47	53	63	57	101	64	49	
18:00	26	13	44	29	30	34	38	35	30	
19:00	21	16	22	23	22	34	37	28	25	
20:00	8	8	18	25	14	17	20	19	16	
21:00	8	8	19	15	13	12	11	14	12	
22:00	8	6	9	14	9	18	16	13	12	
23:00	10	0	3	1	1	2	9	4	4	
12H,7-19	495	356	659	670	672	675	863	708	627	
16H,6-22	535	389	721	746	731	746	940	777	687	
18H,6-24	553	395	733	761	741	766	965	793	702	
24H,0-24	558	402	737	762	744	770	970	797	706	
Am	11:00	11:00	08:00	08:00	08:00	08:00	08:00	08:00	08:00	
Peak	69	56	94	91	90	92	104	94	74	
Pm	13:00	13:00	15:00	16:00	15:00	15:00	15:00	15:00	15:00	
Peak	67	47	90	100	98	89	142	96	79	

Appendix TS-5

(Masterplan)

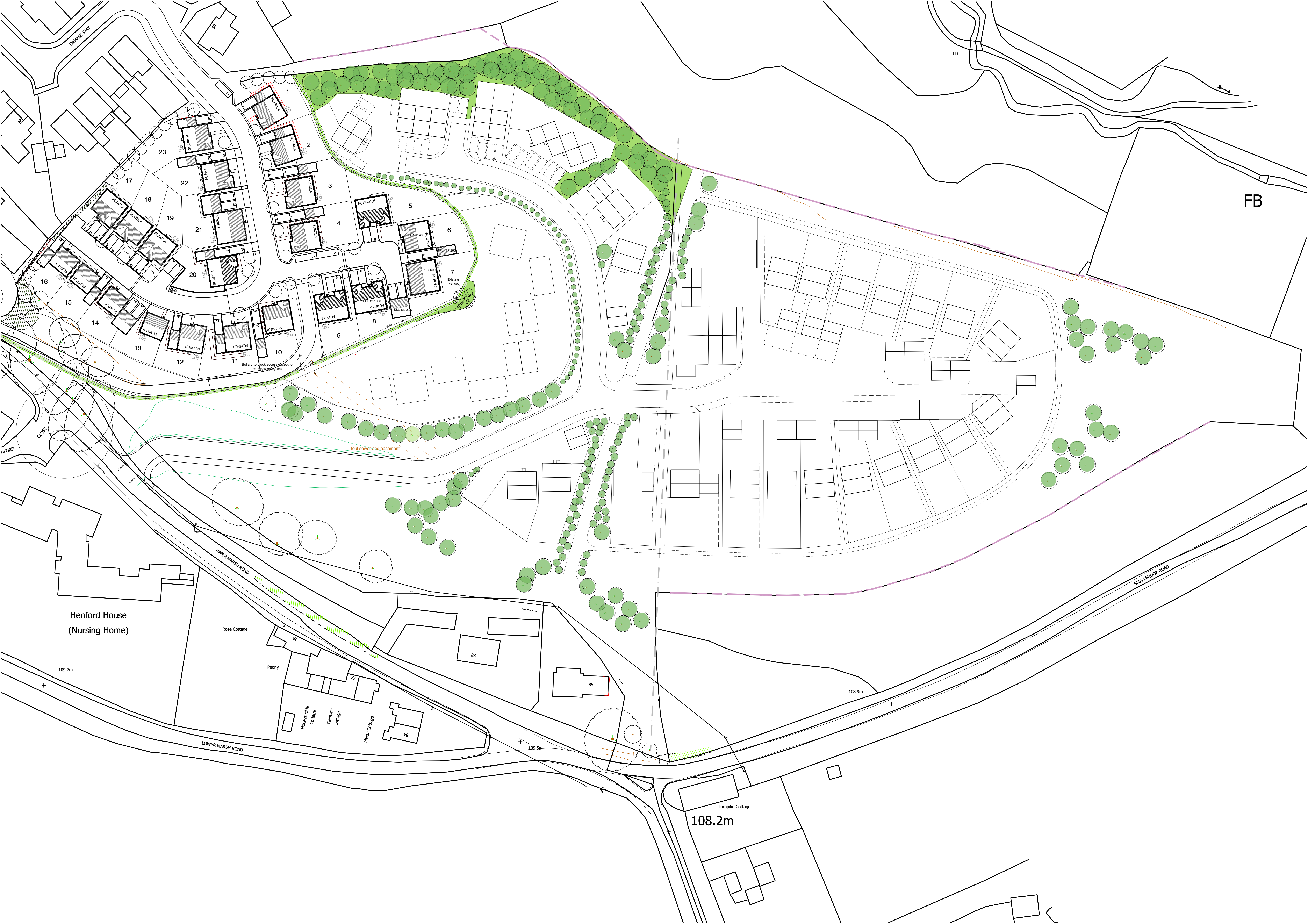

Henford House
(Nursing Home)

Rose Cottage

Peony

Honeysuckle
Cottage

Clematis
Cottage

Marsh Cottage

Turnpike Cottage

108.2m

FB

SMALLBROOK ROAD

LOWER MARSH ROAD

UPPER MARSH ROAD

CLOSE

DAMASK WAY

foul sewer and easement

Existing Fence

Bollard to block access except for emergency access

Appendix TS-6

(TRICS Output)

Calculation Reference: AUDIT-527501-171117-1106

TRIP RATE CALCULATION SELECTION PARAMETERS:

Land Use : 03 - RESIDENTIAL
 Category : A - HOUSES PRIVATELY OWNED
 VEHICLES

Selected regions and areas:

02	SOUTH EAST	
	ES EAST SUSSEX	1 days
	HC HAMPSHIRE	1 days
	SC SURREY	1 days
	WS WEST SUSSEX	3 days
03	SOUTH WEST	
	DC DORSET	1 days
	DV DEVON	3 days
	SM SOMERSET	1 days
04	EAST ANGLIA	
	CA CAMBRIDGESHIRE	1 days
	NF NORFOLK	3 days
	SF SUFFOLK	2 days
05	EAST MIDLANDS	
	LN LINCOLNSHIRE	1 days
06	WEST MIDLANDS	
	SH SHROPSHIRE	4 days
	WK WARWICKSHIRE	2 days
07	YORKSHIRE & NORTH LINCOLNSHIRE	
	NE NORTH EAST LINCOLNSHIRE	1 days
	NY NORTH YORKSHIRE	6 days
	SY SOUTH YORKSHIRE	1 days
	WY WEST YORKSHIRE	1 days
08	NORTH WEST	
	CH CHESHIRE	2 days
	GM GREATER MANCHESTER	1 days
	MS MERSEYSIDE	1 days
09	NORTH	
	CB CUMBRIA	1 days
	DH DURHAM	2 days
	TW TYNE & WEAR	2 days

This section displays the number of survey days per TRICS® sub-region in the selected set

Secondary Filtering selection:

This data displays the chosen trip rate parameter and its selected range. Only sites that fall within the parameter range are included in the trip rate calculation.

Parameter: Number of dwellings
 Actual Range: 6 to 805 (units:)
 Range Selected by User: 6 to 4334 (units:)

Public Transport Provision:

Selection by: Include all surveys

Date Range: 01/01/09 to 28/03/17

This data displays the range of survey dates selected. Only surveys that were conducted within this date range are included in the trip rate calculation.

Selected survey days:

Monday	9 days
Tuesday	9 days
Wednesday	8 days
Thursday	8 days
Friday	8 days

This data displays the number of selected surveys by day of the week.

Selected survey types:

Manual count	42 days
Directional ATC Count	0 days

This data displays the number of manual classified surveys and the number of unclassified ATC surveys, the total adding up to the overall number of surveys in the selected set. Manual surveys are undertaken using staff, whilst ATC surveys are undertaken using machines.

Selected Locations:

Suburban Area (PPS6 Out of Centre)	20
Edge of Town	19
Neighbourhood Centre (PPS6 Local Centre)	3

This data displays the number of surveys per main location category within the selected set. The main location categories consist of Free Standing, Edge of Town, Suburban Area, Neighbourhood Centre, Edge of Town Centre, Town Centre and Not Known.

Selected Location Sub Categories:

Residential Zone	35
Village	1
No Sub Category	6

This data displays the number of surveys per location sub-category within the selected set. The location sub-categories consist of Commercial Zone, Industrial Zone, Development Zone, Residential Zone, Retail Zone, Built-Up Zone, Village, Out of Town, High Street and No Sub Category.

Secondary Filtering selection:

Use Class:

C1	1 days
C3	40 days

This data displays the number of surveys per Use Class classification within the selected set. The Use Classes Order 2005 has been used for this purpose, which can be found within the Library module of TRICS®.

Secondary Filtering selection (Cont.):

Population within 1 mile:

1,001 to 5,000	7 days
5,001 to 10,000	12 days
10,001 to 15,000	11 days
15,001 to 20,000	3 days
20,001 to 25,000	4 days
25,001 to 50,000	5 days

This data displays the number of selected surveys within stated 1-mile radii of population.

Population within 5 miles:

5,001 to 25,000	6 days
25,001 to 50,000	5 days
50,001 to 75,000	4 days
75,001 to 100,000	12 days
100,001 to 125,000	2 days
125,001 to 250,000	7 days
250,001 to 500,000	5 days
500,001 or More	1 days

This data displays the number of selected surveys within stated 5-mile radii of population.

Car ownership within 5 miles:

0.6 to 1.0	15 days
1.1 to 1.5	27 days

This data displays the number of selected surveys within stated ranges of average cars owned per residential dwelling, within a radius of 5-miles of selected survey sites.

Travel Plan:

Yes	5 days
No	37 days

This data displays the number of surveys within the selected set that were undertaken at sites with Travel Plans in place, and the number of surveys that were undertaken at sites without Travel Plans.

PTAL Rating:

No PTAL Present	42 days
-----------------	---------

This data displays the number of selected surveys with PTAL Ratings.

LIST OF SITES relevant to selection parameters

1	CA-03-A-04	DETACHED		CAMBRIDGESHIRE
	THORPE PARK ROAD			
	PETERBOROUGH			
	Suburban Area (PPS6 Out of Centre)			
	Residential Zone			
	Total Number of dwellings:	9		
	Survey date: TUESDAY	18/10/11		Survey Type: MANUAL
2	CB-03-A-04	SEMI DETACHED		CUMBRIA
	MOORCLOSE ROAD			
	SALTERBACK			
	WORKINGTON			
	Edge of Town			
	No Sub Category			
	Total Number of dwellings:	82		
	Survey date: FRIDAY	24/04/09		Survey Type: MANUAL
3	CH-03-A-08	DETACHED		CHESHIRE
	WHITCHURCH ROAD			
	BOUGHTON HEATH			
	CHESTER			
	Suburban Area (PPS6 Out of Centre)			
	Residential Zone			
	Total Number of dwellings:	11		
	Survey date: TUESDAY	22/05/12		Survey Type: MANUAL
4	CH-03-A-09	TERRACED HOUSES		CHESHIRE
	GREYSTOKE ROAD			
	HURDSFIELD			
	MACCLESFIELD			
	Edge of Town			
	Residential Zone			
	Total Number of dwellings:	24		
	Survey date: MONDAY	24/11/14		Survey Type: MANUAL
5	DC-03-A-08	BUNGALOWS		DORSET
	HURSTDENE ROAD			
	CASTLE LANE WEST			
	BOURNEMOUTH			
	Edge of Town			
	Residential Zone			
	Total Number of dwellings:	28		
	Survey date: MONDAY	24/03/14		Survey Type: MANUAL
6	DH-03-A-01	SEMI DETACHED		DURHAM
	GREENFIELDS ROAD			
	BISHOP AUCKLAND			
	Suburban Area (PPS6 Out of Centre)			
	Residential Zone			
	Total Number of dwellings:	50		
	Survey date: TUESDAY	28/03/17		Survey Type: MANUAL
7	DH-03-A-02	MIXED HOUSES		DURHAM
	LEAZES LANE			
	ST HELEN AUCKLAND			
	BISHOP AUCKLAND			
	Neighbourhood Centre (PPS6 Local Centre)			
	Residential Zone			
	Total Number of dwellings:	125		
	Survey date: MONDAY	27/03/17		Survey Type: MANUAL

LIST OF SITES relevant to selection parameters (Cont.)

8	DV-03-A-01	TERRACED HOUSES	DEVON
	BRONSHILL ROAD		
	TORQUAY		
	Suburban Area (PPS6 Out of Centre)		
	Residential Zone		
	Total Number of dwellings:	37	
	Survey date: WEDNESDAY	30/09/15	Survey Type: MANUAL
9	DV-03-A-02	HOUSES & BUNGALOWS	DEVON
	MILLHEAD ROAD		
	HONITON		
	Suburban Area (PPS6 Out of Centre)		
	Residential Zone		
	Total Number of dwellings:	116	
	Survey date: FRIDAY	25/09/15	Survey Type: MANUAL
10	DV-03-A-03	TERRACED & SEMI DETACHED	DEVON
	LOWER BRAND LANE		
	HONITON		
	Suburban Area (PPS6 Out of Centre)		
	Residential Zone		
	Total Number of dwellings:	70	
	Survey date: MONDAY	28/09/15	Survey Type: MANUAL
11	ES-03-A-02	PRIVATE HOUSING	EAST SUSSEX
	SOUTH COAST ROAD		
	PEACEHAVEN		
	Edge of Town		
	Residential Zone		
	Total Number of dwellings:	37	
	Survey date: FRIDAY	18/11/11	Survey Type: MANUAL
12	GM-03-A-10	DETACHED/SEMI	GREATER MANCHESTER
	BUTT HILL DRIVE		
	PRESTWICH		
	MANCHESTER		
	Edge of Town		
	Residential Zone		
	Total Number of dwellings:	29	
	Survey date: WEDNESDAY	12/10/11	Survey Type: MANUAL
13	HC-03-A-18	HOUSES & FLATS	HAMPSHIRE
	CANADA WAY		
	LIPHOOK		
	Suburban Area (PPS6 Out of Centre)		
	Residential Zone		
	Total Number of dwellings:	62	
	Survey date: TUESDAY	29/11/16	Survey Type: MANUAL
14	LN-03-A-03	SEMI DETACHED	LINCOLNSHIRE
	ROOKERY LANE		
	BOULTHAM		
	LINCOLN		
	Suburban Area (PPS6 Out of Centre)		
	Residential Zone		
	Total Number of dwellings:	22	
	Survey date: TUESDAY	18/09/12	Survey Type: MANUAL

LIST OF SITES relevant to selection parameters (Cont.)

15	MS-03-A-03 BEMPTON ROAD OTTERSPOOL LIVERPOOL Suburban Area (PPS6 Out of Centre) Residential Zone Total Number of dwellings: 15 Survey date: FRIDAY 21/06/13	DETACHED	MERSEYSIDE	Survey Type: MANUAL
16	NE-03-A-02 HANOVER WALK SCUNTHORPE Edge of Town No Sub Category Total Number of dwellings: 432 Survey date: MONDAY 12/05/14	SEMI DETACHED & DETACHED	NORTH EAST LINCOLNSHIRE	Survey Type: MANUAL
17	NF-03-A-01 YARMOUTH ROAD CAISTER-ON-SEA Suburban Area (PPS6 Out of Centre) Residential Zone Total Number of dwellings: 27 Survey date: TUESDAY 16/10/12	SEMI DET. & BUNGALOWS	NORFOLK	Survey Type: MANUAL
18	NF-03-A-02 DEREHAM ROAD NORWICH Suburban Area (PPS6 Out of Centre) Residential Zone Total Number of dwellings: 98 Survey date: MONDAY 22/10/12	HOUSES & FLATS	NORFOLK	Survey Type: MANUAL
19	NF-03-A-03 HALING WAY THETFORD Edge of Town Residential Zone Total Number of dwellings: 10 Survey date: WEDNESDAY 16/09/15	DETACHED HOUSES	NORFOLK	Survey Type: MANUAL
20	NY-03-A-06 HORSEFAIR BOROUGHBRIDGE Suburban Area (PPS6 Out of Centre) Residential Zone Total Number of dwellings: 115 Survey date: FRIDAY 14/10/11	BUNGALOWS & SEMI DET.	NORTH YORKSHIRE	Survey Type: MANUAL
21	NY-03-A-07 CRAVEN WAY BOROUGHBRIDGE Edge of Town No Sub Category Total Number of dwellings: 23 Survey date: TUESDAY 18/10/11	DETACHED & SEMI DET.	NORTH YORKSHIRE	Survey Type: MANUAL

LIST OF SITES relevant to selection parameters (Cont.)

22	NY-03-A-08	TERRACED HOUSES		NORTH YORKSHIRE
	NICHOLAS STREET			
	YORK			
	Suburban Area (PPS6 Out of Centre)			
	Residential Zone			
	Total Number of dwellings:	21		
	Survey date: MONDAY	16/09/13		Survey Type: MANUAL
23	NY-03-A-09	MIXED HOUSING		NORTH YORKSHIRE
	GRAMMAR SCHOOL LANE			
	NORTHALLERTON			
	Suburban Area (PPS6 Out of Centre)			
	Residential Zone			
	Total Number of dwellings:	52		
	Survey date: MONDAY	16/09/13		Survey Type: MANUAL
24	NY-03-A-10	HOUSES AND FLATS		NORTH YORKSHIRE
	BOROUGHBRIDGE ROAD			
	RIPON			
	Edge of Town			
	No Sub Category			
	Total Number of dwellings:	71		
	Survey date: TUESDAY	17/09/13		Survey Type: MANUAL
25	NY-03-A-11	PRIVATE HOUSING		NORTH YORKSHIRE
	HORSEFAIR			
	BOROUGHBRIDGE			
	Edge of Town			
	Residential Zone			
	Total Number of dwellings:	23		
	Survey date: WEDNESDAY	18/09/13		Survey Type: MANUAL
26	SC-03-A-04	DETACHED & TERRACED		SURREY
	HIGH ROAD			
	BYFLEET			
	Edge of Town			
	Residential Zone			
	Total Number of dwellings:	71		
	Survey date: THURSDAY	23/01/14		Survey Type: MANUAL
27	SF-03-A-04	DETACHED & BUNGALOWS		SUFFOLK
	NORMANSTON DRIVE			
	LOWESTOFT			
	Suburban Area (PPS6 Out of Centre)			
	Residential Zone			
	Total Number of dwellings:	7		
	Survey date: TUESDAY	23/10/12		Survey Type: MANUAL
28	SF-03-A-05	DETACHED HOUSES		SUFFOLK
	VALE LANE			
	BURY ST EDMUNDS			
	Edge of Town			
	Residential Zone			
	Total Number of dwellings:	18		
	Survey date: WEDNESDAY	09/09/15		Survey Type: MANUAL

LIST OF SITES relevant to selection parameters (Cont.)

29	SH-03-A-03	DETACHED		SHROPSHIRE
	SOMERBY DRIVE			
	BICTON HEATH			
	SHREWSBURY			
	Edge of Town			
	No Sub Category			
	Total Number of dwellings:	10		
	Survey date: FRIDAY	26/06/09		Survey Type: MANUAL
30	SH-03-A-04	TERRACED		SHROPSHIRE
	ST MICHAEL'S STREET			
	SHREWSBURY			
	Suburban Area (PPS6 Out of Centre)			
	No Sub Category			
	Total Number of dwellings:	108		
	Survey date: THURSDAY	11/06/09		Survey Type: MANUAL
31	SH-03-A-05	SEMI-DETACHED/TERRACED		SHROPSHIRE
	SANDCROFT			
	SUTTON HILL			
	TELFORD			
	Edge of Town			
	Residential Zone			
	Total Number of dwellings:	54		
	Survey date: THURSDAY	24/10/13		Survey Type: MANUAL
32	SH-03-A-06	BUNGALOWS		SHROPSHIRE
	ELLESMERE ROAD			
	SHREWSBURY			
	Edge of Town			
	Residential Zone			
	Total Number of dwellings:	16		
	Survey date: THURSDAY	22/05/14		Survey Type: MANUAL
33	SM-03-A-01	DETACHED & SEMI		SOMERSET
	WEMBDON ROAD			
	NORTHFIELD			
	BRIDGWATER			
	Edge of Town			
	Residential Zone			
	Total Number of dwellings:	33		
	Survey date: THURSDAY	24/09/15		Survey Type: MANUAL
34	SY-03-A-01	SEMI DETACHED HOUSES		SOUTH YORKSHIRE
	A19 BENTLEY ROAD			
	BENTLEY RISE			
	DONCASTER			
	Suburban Area (PPS6 Out of Centre)			
	Residential Zone			
	Total Number of dwellings:	54		
	Survey date: WEDNESDAY	18/09/13		Survey Type: MANUAL
35	TW-03-A-02	SEMI-DETACHED		TYNE & WEAR
	WEST PARK ROAD			
	GATESHEAD			
	Suburban Area (PPS6 Out of Centre)			
	Residential Zone			
	Total Number of dwellings:	16		
	Survey date: MONDAY	07/10/13		Survey Type: MANUAL

LIST OF SITES relevant to selection parameters (Cont.)

36	TW-03-A-03	MIXED HOUSES		TYNE & WEAR
	STATION ROAD			
	BACKWORTH			
	NEAR NEWCASTLE			
	Neighbourhood Centre (PPS6 Local Centre)			
	Village			
	Total Number of dwellings:	33		
	Survey date: FRIDAY	13/11/15		Survey Type: MANUAL
37	WK-03-A-01	TERRACED/SEMI/DET.		WARWICKSHIRE
	ARLINGTON AVENUE			
	LEAMINGTON SPA			
	Suburban Area (PPS6 Out of Centre)			
	Residential Zone			
	Total Number of dwellings:	6		
	Survey date: FRIDAY	21/10/11		Survey Type: MANUAL
38	WK-03-A-02	BUNGALOWS		WARWICKSHIRE
	NARBERTH WAY			
	POTTERS GREEN			
	COVENTRY			
	Edge of Town			
	Residential Zone			
	Total Number of dwellings:	17		
	Survey date: THURSDAY	17/10/13		Survey Type: MANUAL
39	WS-03-A-04	MIXED HOUSES		WEST SUSSEX
	HILLS FARM LANE			
	BROADBRIDGE HEATH			
	HORSHAM			
	Edge of Town			
	Residential Zone			
	Total Number of dwellings:	151		
	Survey date: THURSDAY	11/12/14		Survey Type: MANUAL
40	WS-03-A-05	TERRACED & FLATS		WEST SUSSEX
	UPPER SHOREHAM ROAD			
	SHOREHAM BY SEA			
	Suburban Area (PPS6 Out of Centre)			
	Residential Zone			
	Total Number of dwellings:	48		
	Survey date: WEDNESDAY	18/04/12		Survey Type: MANUAL
41	WS-03-A-06	MIXED HOUSES		WEST SUSSEX
	ELLIS ROAD			
	S BROADBRIDGE HEATH			
	WEST HORSHAM			
	Edge of Town			
	Residential Zone			
	Total Number of dwellings:	805		
	Survey date: THURSDAY	02/03/17		Survey Type: MANUAL
42	WY-03-A-01	MIXED HOUSING		WEST YORKSHIRE
	SPRING VALLEY CRESCENT			
	BRAMLEY			
	LEEDS			
	Neighbourhood Centre (PPS6 Local Centre)			
	Residential Zone			
	Total Number of dwellings:	46		
	Survey date: WEDNESDAY	21/09/16		Survey Type: MANUAL

This section provides a list of all survey sites and days in the selected set. For each individual survey site, it displays a unique site reference code and site address, the selected trip rate calculation parameter and its value, the day of the week and date of each survey, and whether the survey was a manual classified count or an ATC count.

TRIP RATE for Land Use 03 - RESIDENTIAL/A - HOUSES PRIVATELY OWNED
VEHICLES

Calculation factor: 1 DWELLS

BOLD print indicates peak (busiest) period

Time Range	ARRIVALS			DEPARTURES			TOTALS		
	No. Days	Ave. DWELLS	Trip Rate	No. Days	Ave. DWELLS	Trip Rate	No. Days	Ave. DWELLS	Trip Rate
00:00 - 01:00									
01:00 - 02:00									
02:00 - 03:00									
03:00 - 04:00									
04:00 - 05:00									
05:00 - 06:00									
06:00 - 07:00									
07:00 - 08:00	42	73	0.072	42	73	0.281	42	73	0.353
08:00 - 09:00	42	73	0.132	42	73	0.376	42	73	0.508
09:00 - 10:00	42	73	0.145	42	73	0.164	42	73	0.309
10:00 - 11:00	42	73	0.132	42	73	0.153	42	73	0.285
11:00 - 12:00	42	73	0.142	42	73	0.154	42	73	0.296
12:00 - 13:00	42	73	0.150	42	73	0.150	42	73	0.300
13:00 - 14:00	42	73	0.152	42	73	0.152	42	73	0.304
14:00 - 15:00	42	73	0.144	42	73	0.172	42	73	0.316
15:00 - 16:00	42	73	0.244	42	73	0.172	42	73	0.416
16:00 - 17:00	42	73	0.261	42	73	0.159	42	73	0.420
17:00 - 18:00	42	73	0.318	42	73	0.154	42	73	0.472
18:00 - 19:00	42	73	0.260	42	73	0.159	42	73	0.419
19:00 - 20:00									
20:00 - 21:00									
21:00 - 22:00									
22:00 - 23:00									
23:00 - 24:00									
Total Rates:		2.152			2.246			4.398	

This section displays the trip rate results based on the selected set of surveys and the selected count type (shown just above the table). It is split by three main columns, representing arrivals trips, departures trips, and total trips (arrivals plus departures). Within each of these main columns are three sub-columns. These display the number of survey days where count data is included (per time period), the average value of the selected trip rate calculation parameter (per time period), and the trip rate result (per time period). Total trip rates (the sum of the column) are also displayed at the foot of the table.

To obtain a trip rate, the average (mean) trip rate parameter value (TRP) is first calculated for all selected survey days that have count data available for the stated time period. The average (mean) number of arrivals, departures or totals (whichever applies) is also calculated (COUNT) for all selected survey days that have count data available for the stated time period. Then, the average count is divided by the average trip rate parameter value, and multiplied by the stated calculation factor (shown just above the table and abbreviated here as FACT). So, the method is: $COUNT/TRP*FACT$. Trip rates are then rounded to 3 decimal places.

Parameter summary

Trip rate parameter range selected: 6 - 805 (units:)
 Survey date date range: 01/01/09 - 28/03/17
 Number of weekdays (Monday-Friday): 42
 Number of Saturdays: 0
 Number of Sundays: 0
 Surveys automatically removed from selection: 1
 Surveys manually removed from selection: 0

This section displays a quick summary of some of the data filtering selections made by the TRICS® user. The trip rate calculation parameter range of all selected surveys is displayed first, followed by the range of minimum and maximum survey dates selected by the user. Then, the total number of selected weekdays and weekend days in the selected set of surveys are shown. Finally, the number of survey days that have been manually removed from the selected set outside of the standard filtering procedure are displayed.