

## Lincoln & Northants, Customer Enquiries

---

**Subject:** FW: Egdon - Pre-App Information  
**Attachments:** Pre-Application Basic - Request Form.pdf; ZG-ER-NK-EPR-01 Permit Boundary Plan 500 Scale.pdf

**From:** [REDACTED]  
**Sent:** 29 October 2019 14:37  
**To:** [REDACTED]  
**Subject:** RE: Egdon - Pre-App Information

Hi [REDACTED]

As discussed. We believe we can drill the well under standard rules. The only issue is the water course. But the permit boundary as indicated on the plan falls outside of the 10m. The Planning boundary however does not.

Just need EA confirmation that standard rules can be used as it meets the site criteria.

Kind Regards

[REDACTED]

[REDACTED]

[REDACTED]

**ZETLAND**  
GROUP

Tel: +44 (0)1642 777726

Web: [www.zetlandgroup.com](http://www.zetlandgroup.com)

Registered in England No. 05964499

Zetland Group Limited, The Innovation Centre, Vienna Court, Kirkleatham Business Park, Redcar, TS10 5SH

PRIVATE & CONFIDENTIAL - This e-mail is intended for the addressee only and may contain information which is confidential or privileged. If you receive this e-mail in error please delete it immediately or notify the sender by using any of the following contact details. Thank you.

**From:** [REDACTED]  
**Sent:** 29 October 2019 14:00  
**To:** [REDACTED]  
**Subject:** RE: Egdon - Pre-App Information

[REDACTED]

Setting up pre-app meetings shouldn't take too long.

Which site is it for and I'll look into it?

Cheers

[REDACTED]

[REDACTED]

**E&B Radioactive Substances and Installations Regulation – Energy Sectors**

Sentinel House, 9 Wellington Crescent, Fradley Park, Lichfield. WS13 8RR

[REDACTED]

---

**From:** [REDACTED]  
**Sent:** 29 October 2019 13:59  
**To:** [REDACTED]  
**Subject:** Egdon - Pre-App Information

Hi [REDACTED]

Hope you are well.

I submitted a Basic Pre-App request to the EA for Egdon on 11<sup>th</sup> October. Do we know how long it is currently within the EA for these pre-app requests to be turned around. I recall you and I having a discussion on permitting determination times, but wondered if there was any timelines on the Pre-App?

Kind Regards

[REDACTED]

[REDACTED]

[REDACTED]

**ZETLAND**  
GROUP

Tel: +44 (0)1642 777726

Web: [www.zetlandgroup.com](http://www.zetlandgroup.com)

Registered in England No. 05964499

Zetland Group Limited, The Innovation Centre, Vienna Court, Kirkleatham Business Park, Redcar, TS10 5SH

PRIVATE & CONFIDENTIAL - This e-mail is intended for the addressee only and may contain information which is confidential or privileged. If you receive this e-mail in error please delete it immediately or notify the sender by using any of the following contact details. Thank you.

Information in this message may be confidential and may be legally privileged. If you have received this message by mistake, please notify the sender immediately, delete it and do not copy it to anyone else. We have checked this email and its attachments for viruses. But you should still check any attachment before opening it. We may have to make this message and any reply to it public if asked to under the Freedom of

Information Act, Data Protection Act or for litigation. Email messages and attachments sent to or from any Environment Agency address may also be accessed by someone other than the sender or recipient, for business purposes.



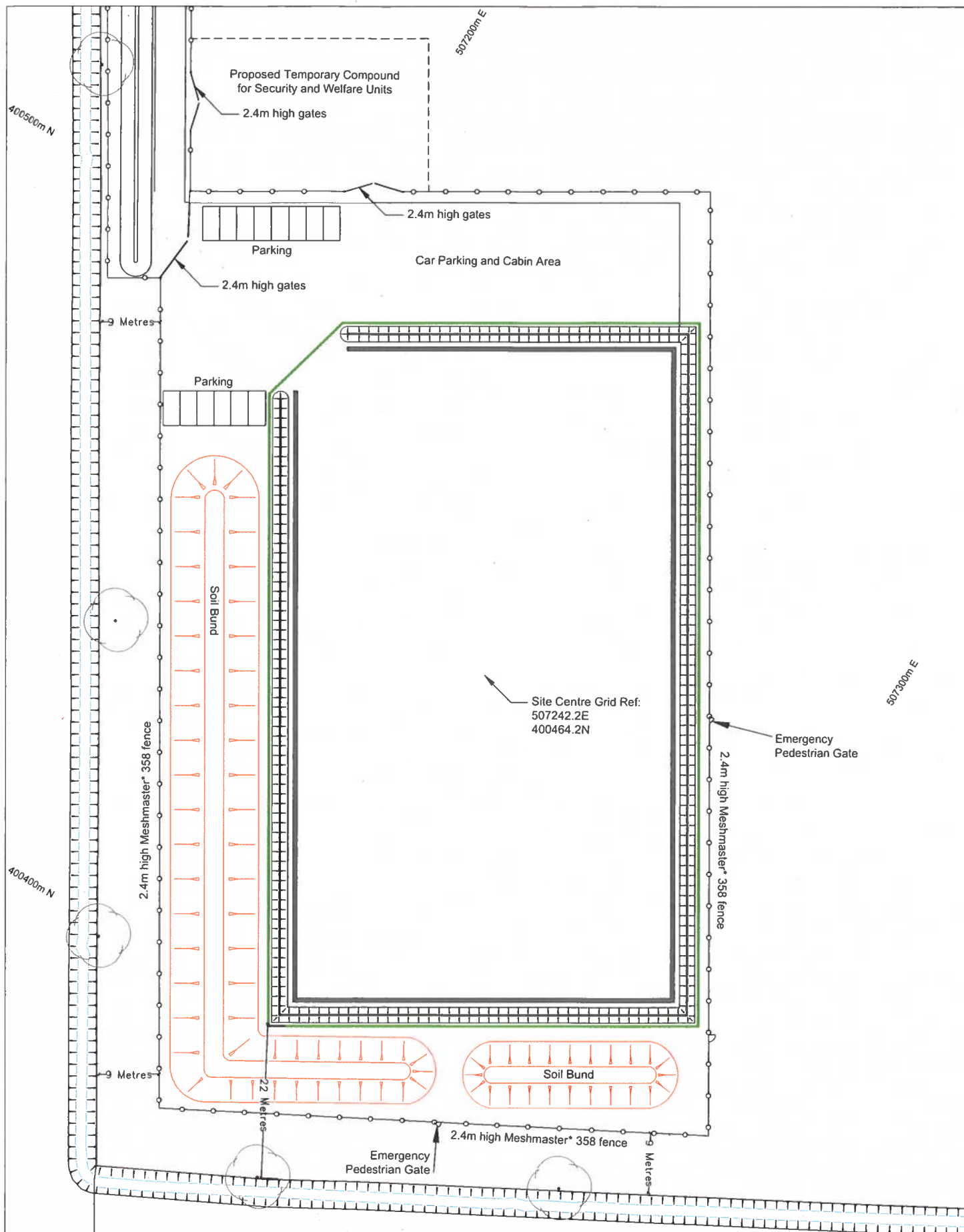

KEY

PERMIT BOUNDARY

WATER FEATURES (PONDS, DRAINS)

SECURITY FENCING (2.4M MESHMASTER)

TREE

THE ORIGINATOR'S SURVEY DATA ON THIS PLAN HAS BEEN REPRODUCED FROM ORIGINATOR'S DATA BY PERMISSION OF ORIGINATOR'S SURVEY & DESIGN OF THE CONTROLLER OF HER MAJESTY'S STATIONARY OFFICE. © ORIGINATOR'S RIGHT 2019. ALL RIGHTS RESERVED. LICENSE N° 100004102

KEY:

EMERGENCY PEDESTRIAN GATE POSITIONS ARE INDICATIVE. EACH GATE WILL BE POSITIONED AT A SUITABLE LOCATION ALONG THE PERIMETER OF THE CORRESPONDING FENCE



REVISION HISTORY			
REV	DATE	BY	DETAILS
0	OCT19	JF	FIRST ISSUE
			DETAILS
			APR
<b>ZETLAND GROUP</b> FROM CONCEPTION TO COMPLETION THE ONLY FULFILLING A SINGLE SOURCE FOR ALL YOUR PROJECTS 100% SATISFACTION GUARANTEE 100% ON TIME DELIVERY 100% BUDGET ADHERENCE 100% CLIENT SATISFACTION			
THIS DOCUMENT IS THE PROPERTY OF ZETLAND GROUP LIMITED. IT CONTAINS PROPRIETARY AND CONFIDENTIAL INFORMATION WHICH MUST NOT BE DUPLICATED, USED OR DISCLOSED OTHER THAN AS EXPRESSLY AUTHORISED BY ZETLAND GROUP LIMITED OR ITS REPRESENTATIVE. © 2019			

SITE:	NORTH KELSEY, LINCOLNSHIRE
PROJECT:	ENVIRONMENTAL PERMIT APPLICATION
TITLE:	PERMIT BOUNDARY PLAN
CLIENT:	EGDON RESOURCES U.K. LIMITED
Scale:	1:500
Size:	A3
Sheet:	1 of 1
DWG. No:	ZG-ER-NK-EPR-01



# Pre-application request, including nature and heritage conservation screening

## Your details

Are you the

Consultant or Agent

Your contact details: We will send all correspondence to the email address you give us below. This will ensure we both have a record of your requirements and our decisions.

Title (Mr., Mrs., Dr. etc) ☒

Full Name XXXXXXXX

Email XXXXXXXXXXXXXXXXXXXX

Day time phone number XXXXXXXXXXXX

If you are a customer who has had basic pre-application advice for this proposal, and now wants enhanced advice, please click the first option. Otherwise, please click on the 'continue with form' button to continue.

## Nature and heritage conservation

Do you only want a nature and heritage conservation screening? This is not required if you want an intensive farming ammonia screening assessment

## Permit type

Please complete the following details:

Applicant/Business Name: Egdon Resources U.K. Limited

Company No. (if applicable): 03424561

Building name or number The Wheat House

Road Name 98 High Street

Town Odiham

County Hampshire

Postcode RG29 1LP

Does your proposal relate to one of the following:

OTHER - Regulatory Industry Activity/Activities - waste, installation or water quality

## Installation - your proposal

Does your proposal relate to 'Installation' activities?

No

## Waste - your proposal

Does your proposal relate to 'waste' activities?

No

## Water quality - your proposal

Does your proposal include 'water quality' activities?

No

## Permit or pre-application reference

Permit or pre-application reference number. For example, EPR/AB1234CD/A001.If you don't have a number, enter 'Do not have'.

Do Not Have

What is this reference for?

I do not have a reference

## About your site or discharge points

Do you have a site or discharge location?

Yes, it's a waste or installation site

## Grid reference for centre of the site



National Grid reference for the centre of the site For example ST 12345 67890

TA 07242 00464

Maximum distance in metres from the centre of the site to boundary

30

## Site details

Site name and address (England only)

**Site name** North Kelsey Wellsite

**Site address 1** Land off Smithfield Road

**Site address 2** North Kelsey

**Site address 3** Brigg

**Site address 4** Lincolnshire

**Postcode** LN7 6HG

## Upload or send a plan of the site

Upload a plan of the site and/or discharge points You can upload up to 3 files (10MB maximum per file, PDF, JPG or PNG)

- File: ZG-ER-NK-EPR-01 Permit Boundary Plan 500 Scale.pdf - [Download](#)

## Pre-application advice

What type of pre-application advice do you require?

Basic (free of charge)

## Basic pre-application advice

What do you want basic pre-application advice about? Basic pre-application advice can include the items below. If you need other advice, you may have to pay for our enhanced service. If you only need an intensive farm ammonia screening assessment, please state that. Please include any issues or questions you have.

The site is currently undeveloped with no environmental permit attached to the site. Egdon Resources is seeking to drill a well only, no testing operations are required at this stage and as such no other permits are being considered.

Confirmation is requested that the proposed wellpad (within the site) can be considered for SR 2015 No1. A water course is near the site, although the mining waste activity will take place on the well pad only.

## Intensive farming applications

Installations only: Does your proposal relate to the intensive farming sector?

No