

**LONDON BOROUGH OF NEWHAM
TOWN AND COUNTRY PLANNING ACT 1990
VICARAGE LANE, STRATFORD, LONDON, E15
LANDSEER AVENUE, MANOR PARK, LONDON E12**

THE LONDON BOROUGH OF NEWHAM hereby gives notice that it proposes to make Orders under section 247 of the above Act to authorise the stopping up of highways in the vicinity of Vicarage Lane, Stratford, London E15 and Landseer Avenue, Manor Park, London E12.

IF THE ORDERS ARE MADE, the stopping up will be authorised in order to enable the developments described in the schedule to this notice to be carried out in accordance with planning permissions 20/00980/LA3 and 19/03282/LA3 granted by the London Borough of Newham on 29 July 2020 and 4 February, 2020 respectively under Part III of the Act.

A COPY OF THE DRAFT ORDER AND RELEVANT DRAWING MAY BE INSPECTED at all reasonable hours during 28 days commencing on 25 November, 2020 at Newham Town Hall, Barking Road, East Ham, London, E6 2RP and Stratford Library, The Grove, London, E15 1EL and may be obtained free of charge by email to olusola.olukoshi@onesource.co.uk

ANY PERSON MAY OBJECT to the making of the proposed order within the period of 28 days commencing on 25 November, 2020 by notice to the Director of Legal and Governance, OneSource, 1000 Dockside Road, London, E16 2QU quoting reference **LE/02/OSO/NEW024304** and marking communications “**for the attention of Olusola Olukoshi**”

In preparing an objection it should be borne in mind that the substance of it may be imparted to other persons who may be affected by it and they may wish to communicate with the objector about it.

Dated: 25 November, 2020

Daniel Fenwick, Director of Legal and Governance

THE SCHEDULE

ST MATTHEWS COURT, VICARAGE LANE

Construction of perimeter railings to sides of block and its surrounding area, including the parking area, construction of pedestrian entrance gates and vehicle access gates. Proposed infill between columns to the undercroft to front façade only with painted render finish. Repainting of the existing railings to the front of block.

LANDSEER AVENUE, MANOR PARK

Erection of four buildings comprising 11 affordable residential units (use class c3) consisting of a tenure of a three-storey building to provide two 1-bed units and four 2-bed units, a two/three storey building to provide a 4-bed wheelchair accessible house; and two no. three storey semi-detached buildings to provide two 3-bed units and two 4-bed units; all to be provided at 'London affordable rent', with associated landscaping, boundary treatments and cycle parking

Dated

2020

**London Borough of Newham
Town and Country Planning Act 1990, Section 247**

**NEWHAM STOPPING UP OF HIGHWAYS (VICARAGE LANE, STRATFORD, LONDON, E15)
ORDER 2020**

A stopping-up order in respect of highway in the vicinity of Vicarage Lane, Stratford, London,
E15

Dated this

day of

2020.

THE COMMON SEAL OF THE MAYOR AND BURGESSES OF THE LONDON BOROUGH OF NEWHAM was hereunto affixed in the presence of:-

Authorised Signatory

SCHEDULE

Description of highways to be stopped up

The lengths of highway to be stopped up are in the London Borough of Newham. They are hatched black on the Deposit Drawing and described as follows:-

A rectangular shaped land with a leg on the eastside on Vicarage Lane, E15 (within St Martins Court) measuring 525m².

HIGHWAYS WITHIN THE LONDON BOROUGH OF NEWHAM

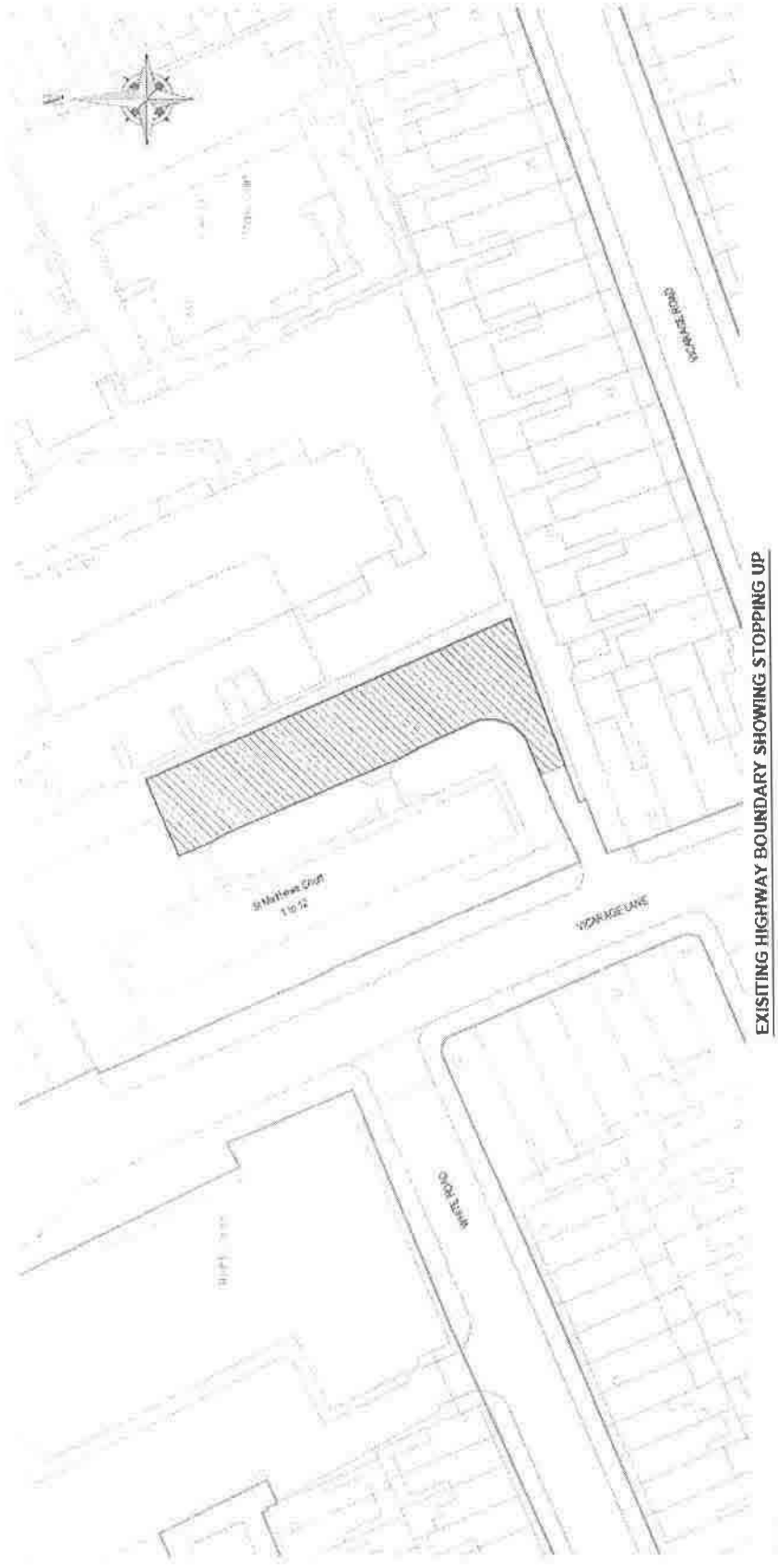

KEY:
EXISTING HIGHWAY BOUNDARY
AREA TO BE STOPPED UP (525m²)

EXISTING HIGHWAY BOUNDARY SHOWING STOPPING UP

DRAWING REFERRED TO IN THE
NEWHAM STOPPING UP OF HIGHWAYS (VICARAGE LANE, STRATFORD, LONDON, E15) ORDER 2020

DEPOSIT DRAWING

Dated

2020

**London Borough of Newham
Town and Country Planning Act 1990, Section 247**

**NEWHAM STOPPING UP OF HIGHWAYS (LANDSEER AVENUE, MANOR PARK, LONDON,
E12) ORDER 2020**

A stopping-up order in respect of highway in the vicinity of Landseer Avenue, Manor Park,
London, E12

Dated this

day of

2020.

THE COMMON SEAL OF THE MAYOR AND BURGESSES OF THE LONDON BOROUGH OF NEWHAM was hereunto affixed in the presence of:-

Authorised Signatory

SCHEDULE

Description of highways to be stopped up

The lengths of highway to be stopped up are in the London Borough of Newham. They are hatched black on the Deposit Drawing and described as follows:-

- (a) an irregular shaped piece of land on the west side of Landseer Avenue, E12 measuring 15m²;
- (b) an irregular shaped piece of land on the east side of Landseer Avenue, E12 measuring 178m²;
- (c) a rectangular piece of land on the west side of Gainsborough Avenue, E12 adjacent to the existing pedestrian footpath measuring 7m²;
- (d) a rectangular shaped piece of land on the west side of Gainsborough Avenue, E12 measuring 120m².; and
- (e) an irregular shaped piece of land on the west side of Gainsborough Avenue, E12 measuring 177m².

HIGHWAYS WITHIN THE LONDON BOROUGH OF NEWHAM

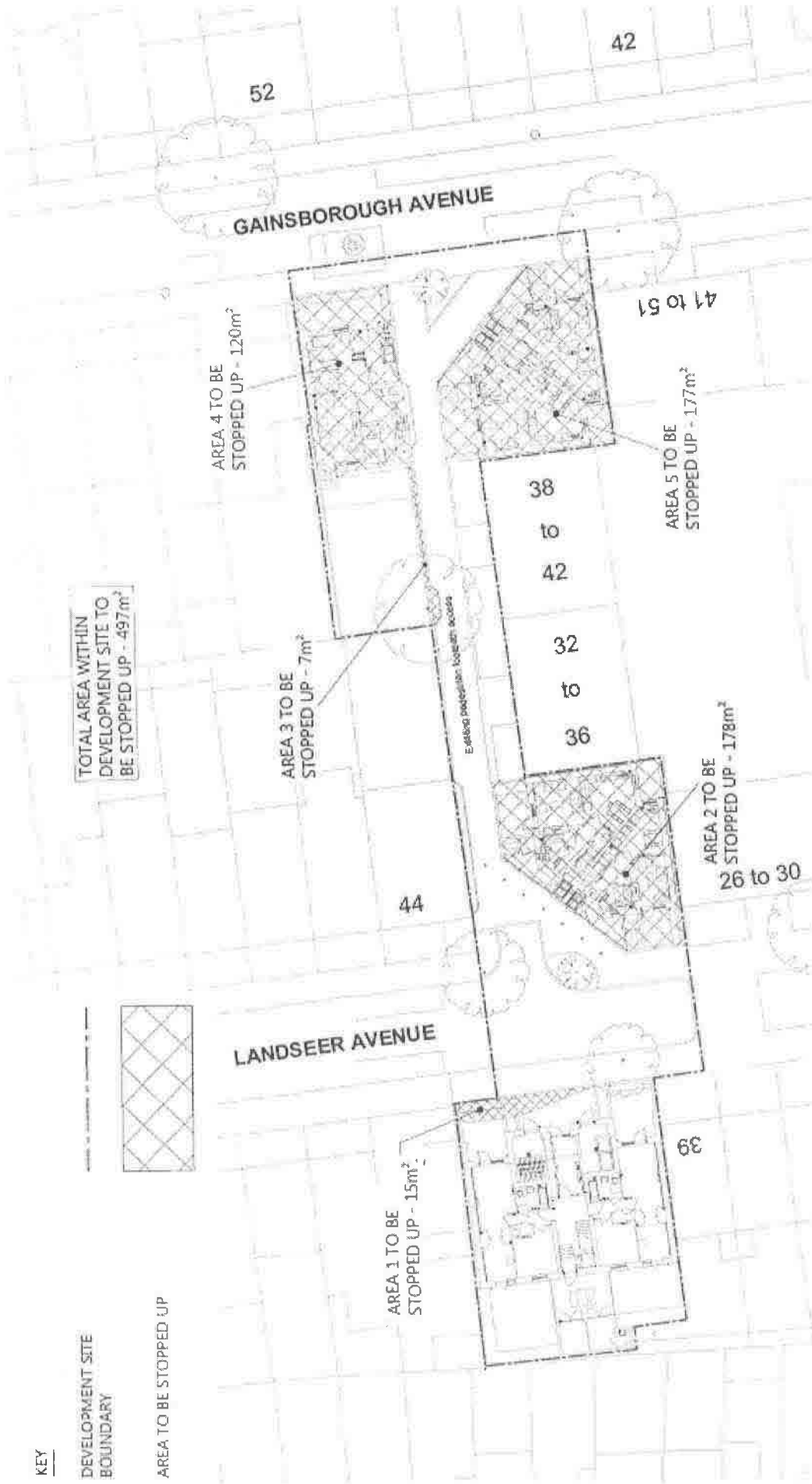

DRAWING REFERRED TO IN THE
NEWHAM STOPPING UP OF HIGHWAYS (LANDSEER AVENUE, MANOR PARK, LONDON, E12) ORDER 2020

DEPOSIT DRAWING