

Wignall, Peter

From: John Young [john.young@lloydbore.co.uk]
Sent: 07 December 2016 09:51
To: Luke@jcwhite.co.uk; laura.pinkham@shepway.gov.uk
Cc: Samuel Durham
Subject: Princes Parade Vegetation Clearance

REFERENCE EML-OUT/3609/20161207-94613-306

Luke, Laura,

Thanks for the photos and e-mail. I think if the pathways cut through the blackthorn are the same width as those in the western section and the cut is kept to a minimum height of 300mm then the risks to reptiles are minimised. If the works can be conducted by the same team then they are covered by the toolbox talk and information I left with the team.

If at all possible please avoid cutting the tussocky grass verge area.

If it is possible to provide me with photos after the cutting that would be great.

Kind regards,
John

John Young

Consultant Ecologist



Lloyd Bore Ltd.

33 St. George's Place, Canterbury, Kent CT1 1UT | T: 01227 464 340

59 Lambeth Walk, London, SE11 6DX | T: 02075 822 363

www.lloydbore.co.uk | E: mail@lloydbore.co.uk | M: 07471 036 662

We are fully committed to improving the quality of the work and services we provide. We welcome your feedback, and would be grateful if you could complete our [Customer Feedback Questionnaire](#).

[Follow Us on Twitter!](#)



From: Luke@jcwhite.co.uk
Sent: 07/12/2016 07:49:49
To: john.young@lloydbore.co.uk; laura.pinkham@shepway.gov.uk
Cc:
Subject: RE: Princes Parade Vegetation Clearance

Good morning John/Laura,

We've now managed to get some more survey work done in the majority of areas of willow etc. towards the rear of the ARC end of the site with minimal extra clearance, only the odd branch here or there.

I've attached some photos of the start of the ditch at the front of the ARC area which I believe show dense areas of blackthorn is it? Is it possible from an ecological point of view to get more clearance done in these areas? In particular the start of the ditch as shown in the photos with our instrument and the no public access sign as we believe it changes a little direction here.

We wouldn't need the whole areas cleared just a few lines in here or there if possible. I will next be on site at Princes Parade on Friday (8am start) due to other prior site commitments and would be available to show you/Laura what we would be looking for clearance wise.

Kind Regards

Luke Hogben
Surveyor

J C White Geomatics Limited
Shrine Barn, Sandling Road, Postling, Nr. Hythe, Kent CT21 4HE

Tel: (01303) 261212 | Fax: (01303) 264040 | email: luke@jcwhite.co.uk | web: www.jcwhite.co.uk

From: John Young [mailto:john.young@lloydbore.co.uk]
Sent: 02 December 2016 10:00
To: Dave.Shore@shepway.gov.uk; Laura.Pinkham@shepway.gov.uk
Cc: Luke Hogben - J C White <Luke@jcwhite.co.uk>; Mike Guntripp - J C White <Mike@jcwhite.co.uk>; Samuel Durham <samuel.durham@lloydbore.co.uk>
Subject: Princes Parade Vegetation Clearance

REFERENCE EML-OUT/3609/20161202-94556-886

Laura, Dave,

Good to see you this morning.

Luke and I walked the cleared area at the east of the site and occasional cutting of willow branches may be required in order to provide access for Lukes team to conduct the survey within this area. Cutting of occasional branches will not present an ecological risk to those species present on-site and the arisings can be left in situ.

There are a couple of dense areas of willow scrub within the cleared area that may require a greater degree of clearance in order to allow Lukes team to conduct a more detailed survey should this be required. If these areas do require clearance then consideration will need to be given with regard to the clearance/storage of any arisings to avoid creating additional suitable habitat for reptiles.

Kind regards,
John

--

John Young
Consultant Ecologist



Lloyd Bore Ltd.
33 St. George's Place, Canterbury, Kent CT1 1UT | T: 01227 464 340
59 Lambeth Walk, London, SE11 6DX | T: 02075 822 363
www.lloydbore.co.uk | E: mail@lloydbore.co.uk | M: 07471 036 662

We are fully committed to improving the quality of the work and services we provide. We welcome your feedback, and would be grateful if you could complete our [Customer Feedback Questionnaire](#).

[Follow Us on Twitter!](#)



From: Mike@jcwhite.co.uk
Sent: 01/12/2016 11:41:37
To: Dave.Shore@shepway.gov.uk; Laura.Pinkham@shepway.gov.uk; john.young@lloydbore.co.uk
Cc: Luke@jcwhite.co.uk
Subject: 2016-12-01 - MJG-DS/LP/JY - 1600128 - Princes Parade Vegetation Clearance

Morning All,

Just to confirm and update everyone.

Luke and a colleague will be on site from around 8am tomorrow morning to start the survey.

Laura, who is on leave today, will meet at 8:15, John will be on site between 8:30 – 9:00 and Dave will no doubt fit in with the above timings.

If Shepway have any availability to carry out some further clearance tomorrow this would be useful, otherwise early next week would be ok.

Kind Regards

Mike

Mike Guntripp
Survey Director

J C White Geomatics Limited
Shrine Barn, Sandling Road, Postling, Nr. Hythe, Kent CT21 4HE

Email: mike@jcwhite.co.uk
Tel: 01303 261212
Fax: 01303 264040

Visit our Website: www.jcwhite.co.uk

Land Surveys | GPS Surveys | Measured Building Surveys
3D Laser Scanning | Monitoring | Boundary Demarcation | Expert Witness

Registered Office: Wilkins Kennedy FKC, Stourside Place, Station Road, Ashford, Kent TN23 1PP
Registered In England & Wales: Company No. 4642192

This email and any attachments are copyright protected and are for the exclusive and confidential use of the intended or named recipient(s). Any other distribution, use or reproduction without the sender's prior consent is unauthorised and strictly prohibited. If you have received this email in error please notify the sender immediately and delete the message. Whilst all reasonable care has been taken to avoid the transmission of viruses, the recipient is responsible for ensuring that the onward

transmission, opening or use of this message and any attachments will not adversely affect its systems or data. J C White Geomatics Limited does not accept any responsibility in this regard and the recipient should therefore carry out such checks as they consider appropriate.

Wignall, Peter

From: John Young [john.young@lloydbore.co.uk]
Sent: 07 December 2016 13:46
To: Luke@jcwhite.co.uk; laura.pinkham@shepway.gov.uk
Cc: Samuel Durham
Subject: Princes Parade Vegetation Clearance

REFERENCE EML-OUT/3609/20161207-134349-293

Additionally to my previous e-mail should you need to cut any of the tussocky grass then please ensure the cut is to a minimum height of 300mm.

I am on leave Thursday and Friday but I'll have my works phone on should you need to contact me.

Kind regards,
John

John Young

Consultant Ecologist



Lloyd Bore Ltd.

33 St. George's Place, Canterbury, Kent CT1 1UT | T: 01227 464 340

59 Lambeth Walk, London, SE11 6DX | T: 02075 822 363

www.lloydbore.co.uk | E: mail@lloydbore.co.uk | M: 07471 036 662

We are fully committed to improving the quality of the work and services we provide. We welcome your feedback, and would be grateful if you could complete our [Customer Feedback Questionnaire](#).

[Follow Us on Twitter](#)



From: john.young@lloydbore.co.uk
Sent: 07/12/2016 09:51
To: Luke@jcwhite.co.uk; laura.pinkham@shepway.gov.uk
Cc: samuel.durham@lloydbore.co.uk
Subject: Princes Parade Vegetation Clearance

REFERENCE EML-OUT/3609/20161207-94613-306

Luke, Laura,

Thanks for the photos and e-mail. I think if the pathways cut through the blackthorn are the same width as those in the western section and the cut is kept to a minimum height of 300mm then the risks to reptiles are

minimised. If the works can be conducted by the same team then they are covered by the toolbox talk and information I left with the team.

If at all possible please avoid cutting the tussocky grass verge area.

If it is possible to provide me with photos after the cutting that would be great.

Kind regards,
John

John Young
Consultant Ecologist



Lloyd Bore Ltd.
33 St. George's Place, Canterbury, Kent CT1 1UT | T: 01227 464 340
59 Lambeth Walk, London, SE11 6DX | T: 02075 822 363
www.lloydbore.co.uk | E: mail@lloydbore.co.uk | M: 07471 036 662

We are fully committed to improving the quality of the work and services we provide. We welcome your feedback, and would be grateful if you could complete our [Customer Feedback Questionnaire](#).

[Follow Us on Twitter!](#)



From: Luke@jcwhite.co.uk
Sent: 07/12/2016 07:49:49
To: john.young@lloydbore.co.uk; laura.pinkham@shepway.gov.uk
Cc:
Subject: RE: Princes Parade Vegetation Clearance

Good morning John/Laura,

We've now managed to get some more survey work done in the majority of areas of willow etc. towards the rear of the ARC end of the site with minimal extra clearance, only the odd branch here or there.

I've attached some photos of the start of the ditch at the front of the ARC area which I believe show dense areas of blackthorn is it? Is it possible from an ecological point of view to get more clearance done in these areas? In particular the start of the ditch as shown in the photos with our instrument and the no public access sign as we believe it changes a little direction here.

We wouldn't need the whole areas cleared just a few lines in here or there if possible. I will next be on site at Princes Parade on Friday (8am start) due to other prior site commitments and would be available to show you/Laura what we would be looking for clearance wise.

Kind Regards

Luke Hogben
Surveyor

J C White Geomatics Limited
Shrine Barn, Sandling Road, Postling, Nr. Hythe, Kent CT21 4HE

Tel: (01303) 261212 | Fax: (01303) 264040 | email: luke@jcwhite.co.uk | web: www.jcwhite.co.uk

From: John Young [mailto:john.young@lloydbore.co.uk]

Sent: 02 December 2016 10:00

To: Dave.Shore@shepway.gov.uk; Laura.Pinkham@shepway.gov.uk

Cc: Luke Hogben - J C White <Luke@jcwhite.co.uk>; Mike Guntripp - J C White <Mike@jcwhite.co.uk>; Samuel Durham <samuel.durham@lloydbore.co.uk>

Subject: Princes Parade Vegetation Clearance

REFERENCE EML-OUT/3609/20161202-94556-886

Laura, Dave,

Good to see you this morning.

Luke and I walked the cleared area at the east of the site and occasional cutting of willow branches may be required in order to provide access for Lukes team to conduct the survey within this area. Cutting of occasional branches will not present an ecological risk to those species present on-site and the arisings can be left in situ.

There are a couple of dense areas of willow scrub within the cleared area that may require a greater degree of clearance in order to allow Lukes team to conduct a more detailed survey should this be required. If these areas do require clearance then consideration will need to be given with regard to the clearance/storage of any arisings to avoid creating additional suitable habitat for reptiles.

Kind regards,
John

John Young

Consultant Ecologist



Lloyd Bore Ltd.

33 St. George's Place, Canterbury, Kent CT1 1UT | T: 01227 464 340

59 Lambeth Walk, London, SE11 6DX | T: 02075 822 383

www.lloydbore.co.uk | E: mail@lloydbore.co.uk | M: 07471 036 662

We are fully committed to improving the quality of the work and services we provide. We welcome your feedback, and would be grateful if you could complete our [Customer Feedback Questionnaire](#).

[Follow Us on Twitter!](#)



From: Mike@jcwhite.co.uk
Sent: 01/12/2016 11:41:37
To: Dave.Shore@shepway.gov.uk; Laura.Pinkham@shepway.gov.uk; john.young@lloydbore.co.uk
Cc: Luke@jcwhite.co.uk
Subject: 2016-12-01 - MJG-DS/LP/JY - 1600128 - Princes Parade Vegetation Clearance

Morning All,

Just to confirm and update everyone.

Luke and a colleague will be on site from around 8am tomorrow morning to start the survey.

Laura, who is on leave today, will meet at 8:15, John will be on site between 8:30 – 9:00 and Dave will no doubt fit in with the above timings.

If Shepway have any availability to carry out some further clearance tomorrow this would be useful, otherwise early next week would be ok.

Kind Regards

Mike

Mike Guntripp
Survey Director

J C White Geomatics Limited
Shrine Barn, Sandling Road, Postling, Nr. Hythe, Kent CT21 4HE

Email: mike@jcwhite.co.uk
Tel: 01303 261212
Fax: 01303 264040

Visit our Website: www.jcwhite.co.uk

Land Surveys | GPS Surveys | Measured Building Surveys
3D Laser Scanning | Monitoring | Boundary Demarcation | Expert Witness

Registered Office: Wilkins Kennedy FKC, Stourside Place, Station Road, Ashford, Kent TN23 1PP
Registered in England & Wales: Company No. 4842192

This email and any attachments are copyright protected and are for the exclusive and confidential use of the intended or named recipient(s). Any other distribution, use or reproduction without the sender's prior consent is unauthorised and strictly prohibited. If you have received this email in error please notify the sender immediately and delete the message. Whilst all reasonable care has been taken to avoid the transmission of viruses, the recipient is responsible for ensuring that the onward transmission, opening or use of this message and any attachments will not adversely affect its systems or data. J C White Geomatics Limited does not accept any responsibility in this regard and the recipient should therefore carry out such checks as they consider appropriate.

Wignall, Peter

From: Shore, Dave [Dave.Shore@shepway.gov.uk]
Sent: 09 December 2016 10:45
To: 'Paul Whatley'
Subject: RE: Princes Parade, Hythe: Views HE2 and HE4...

Paul

We missed each other. Are you around later today or on Monday afternoon?

Dave

David Shore

Strategic Development Projects Manager

t: 01303 853459

m: 07976 958486

f: 01303 853502

Shepway District Council, Civic Centre,

Castle Hill Avenue, Folkestone, Kent, CT20 2QY.

E: dave.shore@shepway.gov.uk

www.shepway.gov.uk

Follow us on [Twitter](#) and [Facebook](#)

"The contents and any attachments of this e-mail message are confidential and intended only for the named addressees. If you have received it in error, please advise the sender immediately by return email and then delete it from your system. Any unauthorised distribution, or copying of this transmission, or mis-use or wrongful disclosure of information contained in it, is strictly prohibited. Shepway District Council cannot accept liability for any statements made which are clearly the sender's own and not expressly made on behalf of the council."

From: Paul Whatley [mailto:paul.whatley@lloydbore.co.uk]
Sent: 06 December 2016 10:04
To: Shore, Dave
Subject: RE: Princes Parade, Hythe: Views HE2 and HE4...

REFERENCE EML-OUT/3609/20161206-100323-661

Yes, great thanks I will call you at 3pm.

Paul

--

Paul Whatley BA (Hons) CMLi
Associate Director / Landscape Architect



Lloyd Bore Ltd.
33 St. George's Place, Canterbury, Kent CT1 1UT | T: 01227 464 340
59 Lambeth Walk, London, SE11 6DX | T: 02075 822 363
www.lloydbore.co.uk | E: paul.whatley@lloydbore.co.uk | M: 07471 036 660

We are fully committed to improving the quality of the work and services we provide. We welcome your feedback, and would be grateful if you could complete our [Customer Feedback Questionnaire](#).

[Follow Us on Twitter](#)



From: Dave.Shore@shepway.gov.uk [<mailto:Dave.Shore@shepway.gov.uk>]
Sent: 06 December 2016 10:02
To: Paul Whatley <paul.whatley@lloydbore.co.uk>
Subject: RE: Princes Parade, Hythe: Views HE2 and HE4...

Paul

I am around this afternoon. Is 3pm OK?

Dave

David Shore

Strategic Development Projects Manager

t: 01303 853459

m: 07976 958486

f: 01303 853502

Shepway District Council, Civic Centre,

Castle Hill Avenue, Folkestone, Kent, CT20 2QY.

E: dave.shore@shepway.gov.uk

www.shepway.gov.uk

Follow us on [Twitter](#) and [Facebook](#)

"The contents and any attachments of this e-mail message are confidential and intended only for the named addressees. If you have received it in error, please advise the sender immediately by return email and then delete it from your system. Any unauthorised distribution, or copying of this

transmission, or mis-use or wrongful disclosure of information contained in it, is strictly prohibited. Shepway District Council cannot accept liability for any statements made which are clearly the sender's own and not expressly made on behalf of the council."

From: Paul Whatley [<mailto:paul.whatley@lloydbore.co.uk>]
Sent: 06 December 2016 09:25
To: martin
Cc: Shore, Dave; matt.shillito@tibbonalds.co.uk
Subject: Princes Parade, Hythe: Views HE2 and HE4...

REFERENCE EML-OUT/3609/Con/20161206-85958-957

Hi Martin,

The photography went well yesterday, thank you.

I think we have now picked up all of the photos, except that from Martello Tower No. 8 (resi) and I have a phone message to follow up on later today on this from David Shore.

The photos will be available to you in due course, once we have downloaded them and logged them on our system.

I turn specifically to the following views:

HE2, Shorncliffe Battery:

Whilst there may be a view of the upper parts of development in the eastern part of the site from the western end of the battery, that part of the battery is currently inaccessible.

I was able to access the eastern end of the battery (as per my photos), but from that part of the battery views are prevented by landform.

A section of steep ground in the central part of the battery, combined with very dense vegetation and unsafe ground prevent access to the western part of the battery from the east.

The western part of the battery is not open to access and is fenced off. There is a locked gate at the western end of the residential development which you could explore further if the view is absolutely essential.

My photos (to be uploaded to the project box.com) following this email. They also show a view north-east back towards the battery which in part demonstrates the lack of access to the western end.

HE4, Martello Tower No. 9:

My set of photos include several from the vicinity of Martello Tower No. 9.

Typically views towards the site and RMC are filtered by intervening vegetation and are not clear.

There is a single location where the eastern end is more clearly visible.

I have a series of single frame shots which can be pieced together as a panoramic photo if you wish.

I appreciate that the management of this vegetation may change in the future, but at present, this is as far as we can go with views from this particular location.

I will upload the photos as two separate zip files to the project box.com shortly.

Please feel free to contact me if you have any queries.

Best wishes,

Paul

--

Paul Whatley BA (Hons) CMLI

Associate Director / Landscape Architect



Lloyd Bore Ltd.

33 St. George's Place, Canterbury, Kent CT1 1UT | T: 01227 464 340

59 Lambeth Walk, London, SE11 6DX | T: 02075 822 363

www.lloydbore.co.uk | E: paul.whatley@lloydbore.co.uk | M: 07471 036 660

We are fully committed to improving the quality of the work and services we provide. We welcome your feedback, and would be grateful if you could complete our [Customer Feedback Questionnaire](#).

[Follow Us on Twitter](#)



From: martin [<mailto:martin@mimckay.wanadoo.co.uk>]

Sent: 06 December 2016 08:07

To: Paul Whatley <paul.whatley@lloydbore.co.uk>

Subject: RE: Princes Parade, Hythe: Final LVIA & HE Views for Comment...

Paul- I hope the photography went ok yesterday and that it was not too cold. Not such a nice day for finishing off today.

I left a message with you yesterday following a telephone conversation with Peter Kendal of Historic England. As I suspected he is very keen to have a CGI from HE4 or close by it. This view will be more open in the future and it illustrates a functional relationship between the Martello Tower and the canal. I think it should be done.

With regard to HE2- a CGI from a lower level is understandable. However, it partly depends on the evidence that will be provided by an ordinary photo from the upper levels as to whether the site or buildings upon will be seen to any significant extent through intervening development.

I am sure that HE will be disappointed by the lack of a CGI from HE3 – Resi Martello Tower. However this is understandable in practical terms and the LVIA 7, provided the viewpoint is chosen to maximise the view of the site, strikes me as a good substitute.

If there are any doubts then please phone me.

Regards

Martin

07855 375026

From: Paul Whatley [<mailto:paul.whatley@lloydbore.co.uk>]

Sent: 01 December 2016 12:08

To: martin@mimckay.wanadoo.co.uk

Cc: Dave.Shore@shepway.gov.uk; matt.shillito@tibbonalds.co.uk; ctsiasioti@gt3architects.com; firbank@callnetuk.com; claire.perrott@tibbonalds.co.uk; Chris Beech <chris.beech@lloydbore.co.uk>

Subject: Princes Parade, Hythe: Final LVIA & HE Views for Comment...

REFERENCE EML-OUT/3609/DI/20161201-114135-946

Dear Martin,

Thank you for the input regarding the Heritage Views.

I enclose a PDF of our revised diagrams indicating viewpoint origins for LVIA and HE Views.

The table below indicates our intention in terms of the type of photo and whether or not a CGI (wireline) is proposed.

For three of the views (HE2-4 inclusive), we think a normal photo and no CGI will suffice (tbc), for the reasons described below the table.

View Ref.	Brief Description.	Photo Type / CGI.
LVIA 1	E from Imperial Hotel	Tripod Photo + CGI
LVIA 2	NE from Princes Parade	Tripod Photo + CGI
LVIA 3	W from Sandgate Esplanade/PP	Tripod Photo + CGI
LVIA 4 + HE6	W from RMC Wharf	Tripod Photo + CGI
LVIA 5	South from RMC (Seaview Footbridge)	Tripod Photo + CGI
LVIA 6	S from Naildown Road	Tripod Photo + CGI
LVIA 7	SW from Hospital Hill	Tripod Photo + CGI
HE1	S from RMC Redoubt	Tripod Photo + CGI
HE2	W from Shorncliffe Battery	No CGI – tbc
HE3	W from Martello Tower No. 8 (resi)	No CGI – tbc
HE4	SW from Martello Tower No. 9 (woodland)	No CGI – tbc
HE5	E from RMC / Golf Course	Tripod Photo + CGI

- HE2. A CGI will be produced for LVIA View 3 (albeit at the lower level). We think this, combined with the limited visibility, potential limited access and lack of survey points for camera matching will negate a CGI from this location at present.
- HE3. We think there will be a lack of fixed survey points in the view for the purposes of camera matching. It will also cause far less disruption to the resident to go in quickly and take a quick set of photos with no survey and tripod equipment needed. Also – a similar viewpoint (with CGI) is likely to be gained from LVIA View 7.
- HE4. Lack of survey points for camera matching in the dense woodland. Glimpsed view, also similar in nature generally to view and CGI in LVIA View 7 (as above).

I would be grateful if you could provide us with your final comments on the above please.

Weather permitting we have Monday 5th and Tuesday 6th December (next week) to undertake the majority of the photography and survey work.

The photo that is likely to have to follow in due course is the one from Martello Tower No. 8, as we still require the client's view on how they would like us to pursue gaining access to this residential property.

I look forward to your comments,

Best wishes,

Paul

Paul Whatley BA (Hons) CMLI

Associate Director / Landscape Architect



Lloyd Bore Ltd.

33 St. George's Place, Canterbury, Kent CT1 1UT | T: 01227 464 340

59 Lambeth Walk, London, SE11 6DX | T: 02075 822 363

www.lloydbore.co.uk | E: paul.whatley@lloydbore.co.uk | M: 07471 036 660

We are fully committed to improving the quality of the work and services we provide. We welcome your feedback, and would be grateful if you could complete our [Customer Feedback Questionnaire](#).

[Follow Us on Twitter!](#)



From: martin@mjmckay.wanadoo.co.uk

Sent: 01/12/2016 08:12:43

To: paul.whatley@lloydbore.co.uk

Cc:

Subject: RE: Princes Parade, Hythe: Heritage Views...

Paul – please see attached a marked up plan. Sorry its not the best scan but hope its clear. If not then phone me on 07855 375026. It marks the additional HE views. For the avoidance of doubt the redoubt is the stone structure opposite the carpark which overlooks the canal towards the sea. Its rather overgrown at present. The wharf is the stone structure at the end of the canal that looks west up it. The viewpoint in close proximity to the Martello tower will have to be hunted out- there is a small side path to it.

HE are very keen that the 3a is from the specific feature of the redoubt. I think you'd need to satisfy them that the alternative view is almost identical – in which case an illustrative view from it would do. Otherwise it would need to be an assessment viewpoint.

Hope this helps

Regards

Martin

From: Paul Whatley [<mailto:paul.whatley@lloydbore.co.uk>]

Sent: 29 November 2016 08:26

To: martin <martin@mjmckay.wanadoo.co.uk>

Cc: matt.shillito@tibbalds.co.uk; ctsiasioti@gt3architects.com; Dave.Shore@shepway.gov.uk

Subject: Princes Parade, Hythe: Heritage Views...

REFERENCE EML-OUT/3609/Con/20161129-82003-494

Martin,

Thanks for this. I have no problem with the additional views.

Yes – just for the avoidance of doubt, could you mark up the attached plan please with the additional views required by HE?

I also attach our map of LVIA Views. Would our View #4 be suitable for HE View 3a?

Many thanks,

Paul

--

Paul Whatley BA (Hons) CMLI

Associate Director / Landscape Architect



Lloyd Bore Ltd.

33 St. George's Place, Canterbury, Kent CT1 1UT | T: 01227 464 340

59 Lambeth Walk, London, SE11 6DX | T: 02075 822 363

www.lloydbore.co.uk | E: paul.whatley@lloydbore.co.uk | M: 07471 036 860

We are fully committed to improving the quality of the work and services we provide. We welcome your feedback, and would be grateful if you could complete our [Customer Feedback Questionnaire](#).

[Follow Us on Twitter](#)



From: martin [<mailto:martin@mjmckay.wanadoo.co.uk>]

Sent: 28 November 2016 20:23

To: Paul Whatley <paul.whatley@lloydbore.co.uk>

Cc: matt.shillito@tibbalds.co.uk; ctsiastoti@gt3architects.com; Dave.Shore@shepway.gov.uk

Subject: RE: Princes Parade, Hythe: Heritage Views...

Paul- as promised, myself, Matt and Dave, amongst others, had a meeting with Peter Kendal of Historic England today.

With regard to assessment viewpoints we agreed the following:

- 1) HE viewpoints 1-3 (figure 10.18)- as per comments in emails string below including assessment viewpoint from top of the redoubt looking out to sea (should now be accessible given that vegetation has died back). With regard to Shorncliffe battery- houses are built on top of the battery and there is communal open space there which should be accessible (although Peter Kendal thinks that some of it may have been 'appropriated' for private gardens). Both myself and Peter think that it is unlikely that there will be views from it in which the site will be prominent- although we may be wrong. You will have to be assiduous in checking this. Illustrative view will be fine, unless you find that there is a good view to the site, in which case an assessment view will be required.

- 2) Assessment viewpoints (figure 10.17) - fine – but note comments re view 6 and 7 below
- 3) Further assessment viewpoints required by HE:
- a) From stone wharf at eastern terminus of the canal looking west straight up the canal
 - b) As discussed in the email string below, viewpoint from south bank of the canal to the west of the site looking east along the canal. Peter Kendal suggested that just north of the 'blue flag' on the OS map (or your diagrams) would be ideal.
 - c) From the vicinity of Martello Tower No. 9 - within the woodland of Hospital Hill. Due to the wooded nature of the surroundings of the tower, the view over the site has to be hunted out. It is slightly to the west and south of the tower and best found by following paths to the south of the tower. View C2 in my report dated November 2015/ July 2016 illustrates the view.

I can mark these on your diagram if this would be helpful.

Regards

Martin

From: Paul Whatley [<mailto:paul.whatley@lloydbore.co.uk>]

Sent: 14 November 2016 12:05

To: martin <martin@mjmckay.wanadoo.co.uk>

Cc: matt.shillito@tlibbalds.co.uk; ctsiasioti@gt3architects.com; Dave.Shore@shepway.gov.uk

Subject: Princes Parade, Hythe: Heritage Views...

REFERENCE EML-OUT/3609/Con/20161114-114334-197

Hi Martin,

Thanks for responding, please see below my comments in RED.

Best wishes,

Paul

Paul Whatley BA (Hons) CMLI
Associate Director / Landscape Architect



Lloyd Bore Ltd.

33 St. George's Place, Canterbury, Kent CT1 1UT | T: 01227 464 340

59 Lambeth Walk, London, SE11 6DX | T: 02075 822 363

www.lloydbore.co.uk | E: paul.whatley@lloydbore.co.uk | M: 07471 036 660

We are fully committed to improving the quality of the work and services we provide. We welcome your feedback, and would be grateful if you could complete our [Customer Feedback Questionnaire](#).

[Follow Us on Twitter!](#)



From: martin [<mailto:martin@mimckay.wanadoo.co.uk>]
Sent: 12 November 2016 13:09
To: Paul Whatley <paul.whatley@lloydbore.co.uk>
Subject: RE: Princes Parade, Hythe: Heritage Views Confirmation...

Thanks Paul. Sorry to get back to you earlier in the week.

I've had a look at this and the mail you sent yesterday to Dave Shore.

Comments as follows:

HE viewpoints:

- 1) Top of redoubt- if this can be accessed then looking out to sea- otherwise as close by as possible. It strikes me that this viewpoint could replace your proposed Assessment Viewpoint 4. Noted, thank you. We will take two separate photos, as one is specific to the LVIA and the other to Heritage Assets.
- 2) With regard to the Shorncliffe battery, HE have said '*There is a question as to what is visible between the RMC and the Shorncliffe battery. Historically these were designed to be inter-visible for gun fire but today I am not sure how far development has closed off the views. I suggest that the top of the battery will need to be visited and an assessment made.* From this there is obviously a degree of judgement to be used as to the precise location of the viewpoint. If the view is somewhat obscured then only an illustrative photo or photos need be taken. Thank you. We are happy to investigate this on site on your behalf, as part of our LVIA Photography work.
- 3) I believe that there may be an accessible balcony on the roof. Otherwise, from the highest viewpoint towards the site is fine. Thank you. I am awaiting final confirming from David Shore as to how he would like access to be arranged to this private property.

HE also mentioned approach experiences from the east thus: *The Royal Military Canal is approached along the coast road from Sandgate, past the huge Shorncliffe battery, and the basin comes into sight and a long view down the canal opens up. How will this experience change?* This will be covered in our LVIA within the context of landscape and views, using the illustrative photos and assessment views provided.

I believe that your views show that not much of this experience remains- but it would be useful to check this out on site. Please see above.

Other illustrative views suggested by HE

- 1) From the eastern most 'kink in the canal on north bank, looking west along the canal and across to the site. Please see attached illustrative photo for your use (DSCN0345).
- 2) From the canal bank (north or south) by the golf course looking east along the canal towards the site. Distance of the viewpoint to the west of the site was not specified by HE, but I would suggest a reasonable distance so that the site and the canal can be seen in context- i.e. a200m or so to the west of the site. We have not taken a view from this precise location and do not intend to as part of our LVIA work, because there are other representative views which illustrate what can be seen from this location. Please could you

confirm if this is a location that you require taken with a camera and tripod and a CGI? If this is not required it may need to be an illustrative photo taken by yourself for the purposes of the Heritage Assessment commentary. We have taken the attached from the footpath leading north / south across the golf course to the west of the site (DSCN0562), if it is any use?

Other points:

By just moving around a little bit views to the site from illustrative viewpoints 20, 24, and Assessment Viewpoints 6 and 7 could be improved (i.e more of the site could be seen). Noted, thanks. We will adjust this as required for the final LVIA Photos and HE1-HE3.

I agree with the selection Assessment Viewpoints (as compared to illustrative) but have not run this past HE. I am happy to send them off now (i.e ASAP) and will discuss this further with HE when I meet them on the 28th November. Thank you. We would emphasise again the use of Representative Views in our LVIA. These need to be clearly distinguished from the Specific Views that are required by HE.

Regards

Martin

From: Paul Whatley [<mailto:paul.whatley@llovdbore.co.uk>]
Sent: 08 November 2016 16:56
To: [martin@mjmckay.wanadoo.co.uk](mailto:mjmckay.wanadoo.co.uk)
Cc: Dave.Shore@shepway.gov.uk; firbank@callnetuk.com
Subject: Princes Parade, Hythe: Heritage Views Confirmation...

REFERENCE EML-OUT/3609/20161108-162310-437

Dear Martin,

Further to recent correspondence on Heritage Views, I enclose a copy of the document table at the DTM last week.

I am now in the process of finalising some text to support this, with the primary aim of:

1. Agreeing LVIA Viewpoints with Shepway D.C and;
2. Agreeing precise location and details of Views which are required by Heritage England.

I intend to add to the View Location Plan the locations of the following views, as indicated on your plan which I also attach for reference:

HE1: From on top of the redoubt (stone wall) at the basin looking south, directly out to sea.

HE2: From on top of Shorncliffe battery (which appears as a stone retaining wall alongside the sea road) towards the site. We understand that Heritage England have requested that the viewpoint be chosen that affords a view of the site beyond the recent buildings to its east (if one is available).

HE3: From the uppermost floor of Martello Tower No8. We understand that Heritage England previously requested a view from the roof, but we cannot do this due to Health and Safety Risks.

Firstly; I would be grateful if you could comment on the above please and confirm that I have the precise location, viewing direction and context correct?

Once we have this confirmed, I will approach David Shore in order to request his preferred method of our Photographer and Surveyor gaining authorised access to these locations to take photographs.

Secondly; Please could you confirm if these are the only Assessment Viewpoints that are required by Heritage England? You mentioned in a past telephone conversation that there may be others that have emerged in your correspondence with them.

Finally, I would like to confirm that it is our current intention to take Camera+Tripod+Surveyor views from all of the 7no. specified LVIA Assessment Viewpoint Origins and produce a wireline CGI for each of these.

We are also intending to take this kind of Photo and CGI from the 3no. Heritage Viewpoint Origins.

Please could you confirm if you require any additional Photos/CGIs for the purposes of your discussions with Heritage England or your assessment?

At this stage for example, we do not intend (and do not have fees agreed with Shepway) to take photos / produce CGIs from all of the positions marked with a red spot on your plan (A1-C3). That said, we do have a bank of photos from most of these locations taken with a standard 'point and shoot' camera, which we would be more than happy to share with you in due course via file download transfer (due to file size).

I hope this above is clear and helpful and I would be more than happy to discuss with you tomorrow.

If you are able to get back to me asap I would very much appreciate it, as I need to circulate this information to SBC and HE without delay.

I also attach a more detailed OS Plan, which may be useful for marking up in relation to the required views.

Many thanks,

Paul

Paul Whitley BA (Hons) CMLI
Associate Director / Landscape Architect



Lloyd Bore Ltd.

33 St. George's Place, Canterbury, Kent CT1 1UT | T: 01227 464 340

59 Lambeth Walk, London, SE11 6DX | T: 02075 822 363

www.lloydbore.co.uk | E: paul.whitley@lloydbore.co.uk | M: 07471 036 660

We are fully committed to improving the quality of the work and services we provide. We welcome your feedback, and would be grateful if you could complete our [Customer Feedback Questionnaire](#).

[Follow Us on Twitter](#)





The contents and any attachments of this e-mail message are confidential and intended only for the named addressees. If you have received it in error, please advise the sender immediately by return email and then delete it from your system. Any unauthorised distribution or copying of this transmission, or misuse or wrongful disclosure of information contained in it, is strictly prohibited. Shepway District Council cannot accept liability for any statements made which are clearly the sender's own and not expressly made on behalf of the council. All email to and from the council may be monitored in accordance with the council's policies.

Wignall, Peter

From: Paul Whatley [paul.whatley@lloydbore.co.uk]
Sent: 09 December 2016 12:10
To: Dave.Shore@shepway.gov.uk
Subject: RE: Princes Parade, Hythe: Views HE2 and HE4...

Hi David,

Sorry not to call you. I am in the office all day on Tel. 01227 464340.

Paul

--

Paul Whatley BA (Hons) CMLI
Associate Director / Landscape Architect



Lloyd Bore Ltd.
33 St. George's Place, Canterbury, Kent CT1 1UT | T: 01227 464 340
59 Lambeth Walk, London, SE11 6DX | T: 02075 822 383
www.lloydbore.co.uk | E: paul.whatley@lloydbore.co.uk | M: 07471 036 660

We are fully committed to improving the quality of the work and services we provide. We welcome your feedback, and would be grateful if you could complete our [Customer Feedback Questionnaire](#).

[Follow Us on Twitter](#)



From: Dave.Shore@shepway.gov.uk [mailto:Dave.Shore@shepway.gov.uk]
Sent: 09 December 2016 10:45
To: Paul Whatley <paul.whatley@lloydbore.co.uk>
Subject: RE: Princes Parade, Hythe: Views HE2 and HE4...

Paul

We missed each other. Are you around later today or on Monday afternoon?

Dave

David Shore

Strategic Development Projects Manager

t: 01303 853459

m: 07976 958486

f: 01303 853502

Shepway District Council, Civic Centre,
Castle Hill Avenue, Folkestone, Kent, CT20 2QY.

E: dave.shore@shepway.gov.uk

www.shepway.gov.uk

Follow us on [Twitter](#) and [Facebook](#)

"The contents and any attachments of this e-mail message are confidential and intended only for the named addressees. If you have received it in error, please advise the sender immediately by return email and then delete it from your system. Any unauthorised distribution, or copying of this transmission, or mis-use or wrongful disclosure of information contained in it, is strictly prohibited. Shepway District Council cannot accept liability for any statements made which are clearly the sender's own and not expressly made on behalf of the council."

From: Paul Whatley [<mailto:paul.whatley@lloydbore.co.uk>]
Sent: 06 December 2016 10:04
To: Shore, Dave
Subject: RE: Princes Parade, Hythe: Views HE2 and HE4...

REFERENCE EML-OUT/3609/20161206-100323-661

Yes, great thanks I will call you at 3pm.

Paul

Paul Whatley BA (Hons) CMLI
Associate Director / Landscape Architect



Lloyd Bore Ltd.
33 St. George's Place, Canterbury, Kent CT1 1UT | T: 01227 464 340
59 Lambeth Walk, London, SE11 6DX | T: 02075 822 363
www.lloydbore.co.uk | E: paul.whatley@lloydbore.co.uk | M: 07471 036 660

We are fully committed to improving the quality of the work and services we provide. We welcome your feedback, and would be grateful if you could complete our [Customer Feedback Questionnaire](#).

[Follow Us on Twitter](#)



From: Dave.Shore@shepway.gov.uk [<mailto:Dave.Shore@shepway.gov.uk>]
Sent: 06 December 2016 10:02
To: Paul Whatley <paul.whatley@lloydbore.co.uk>
Subject: RE: Princes Parade, Hythe: Views HE2 and HE4...

Paul

I am around this afternoon. Is 3pm OK?

Dave

David Shore

Strategic Development Projects Manager

t: 01303 853459

m: 07976 958486

f: 01303 853502

Shepway District Council, Civic Centre,

Castle Hill Avenue, Folkestone, Kent, CT20 2QY.

E: dave.shore@shepway.gov.uk

www.shepway.gov.uk

Follow us on [Twitter](#) and [Facebook](#)

"The contents and any attachments of this e-mail message are confidential and intended only for the named addressees. If you have received it in error, please advise the sender immediately by return email and then delete it from your system. Any unauthorised distribution, or copying of this transmission, or mis-use or wrongful disclosure of information contained in it, is strictly prohibited. Shepway District Council cannot accept liability for any statements made which are clearly the sender's own and not expressly made on behalf of the council."

From: Paul Whatley [<mailto:paul.whatley@lloydbore.co.uk>]

Sent: 06 December 2016 09:25

To: martin

Cc: Shore, Dave; matt.shillito@tibbonalds.co.uk

Subject: Princes Parade, Hythe: Views HE2 and HE4...

REFERENCE EML-OUT/3609/Con/20161206-85958-957

Hi Martin,

The photography went well yesterday, thank you.

I think we have now picked up all of the photos, except that from Martello Tower No. 8 (resi) and I have a phone message to follow up on later today on this from David Shore.

The photos will be available to you in due course, once we have downloaded them and logged them on our system.

I turn specifically to the following views:

HE2, Shorncliffe Battery:

Whilst there may be a view of the upper parts of development in the eastern part of the site from the western end of the battery, that part of the battery is currently inaccessible.

I was able to access the eastern end of the battery (as per my photos), but from that part of the battery views are prevented by landform.

A section of steep ground in the central part of the battery, combined with very dense vegetation and unsafe ground prevent access to the western part of the battery from the east.

The western part of the battery is not open to access and is fenced off. There is a locked gate at the western end of the residential development which you could explore further if the view is absolutely essential.

My photos (to be uploaded to the project box.com) following this email. They also show a view north-east back towards the battery which in part demonstrates the lack of access to the western end.

HE4, Martello Tower No. 9:

My set of photos include several from the vicinity of Martello Tower No. 9.

Typically views towards the site and RMC are filtered by intervening vegetation and are not clear.

There is a single location where the eastern end is more clearly visible.

I have a series of single frame shots which can be pieced together as a panoramic photo if you wish.

I appreciate that the management of this vegetation may change in the future, but at present, this is as far as we can go with views from this particular location.

I will upload the photos as two separate zip files to the project box.com shortly.

Please feel free to contact me if you have any queries.

Best wishes,

Paul

Paul Whatley BA (Hons) CMLI

Associate Director / Landscape Architect



Lloyd Bore Ltd.

33 St. George's Place, Canterbury, Kent CT1 1UT | T: 01227 464 340

59 Lambeth Walk, London, SE11 6DX | T: 02075 822 363

www.lloydbore.co.uk | E: paul.whatley@lloydbore.co.uk | M: 07471 036 660

We are fully committed to improving the quality of the work and services we provide. We welcome your feedback, and would be grateful if you could complete our [Customer Feedback Questionnaire](#).

[Follow Us on Twitter!](#)



From: martin [<mailto:martin@mjmckay.wanadoo.co.uk>]

Sent: 06 December 2016 08:07

To: Paul Whatley <paul.whatley@lloydbore.co.uk>

Subject: RE: Princes Parade, Hythe: Final LVIA & HE Views for Comment...

Paul- I hope the photography went ok yesterday and that it was not too cold. Not such a nice day for finishing off today.

I left a message with you yesterday following a telephone conversation with Peter Kendal of Historic England. As I suspected he is very keen to have a CGI from HE4 or close by it. This view will be more open in the future and it illustrates a functional relationship between the Martello Tower and the canal. I think it should be done.

With regard to HE2- a CGI from a lower level is understandable. However, It partly depends on the evidence that will be provided by an ordinary photo from the upper levels as to whether the site or buildings upon will be seen to any significant extent through intervening development.

I am sure that HE will be disappointed by the lack of a CGI from HE3 – Resi Martello Tower. However this is understandable in practical terms and the LVIA 7, provided the viewpoint is chosen to maximise the view of the site, strikes me as a good substitute.

If there are any doubts then please phone me.

Regards

Martin

07855 375026

From: Paul Whatley [<mailto:paul.whatley@lloydbore.co.uk>]

Sent: 01 December 2016 12:08

To: martin@mimckay.wanadoo.co.uk

Cc: Dave.Shore@shepway.gov.uk; matt.shillito@tibbalds.co.uk; ctsiasioti@gt3architects.com; firbank@callnetuk.com; claire.perrott@tibbalds.co.uk; Chris Beech <chris.beech@lloydbore.co.uk>

Subject: Princes Parade, Hythe: Final LVIA & HE Views for Comment...

REFERENCE EML-OUT/3609/DI/20161201-114135-946

Dear Martin,

Thank you for the input regarding the Heritage Views.

I enclose a PDF of our revised diagrams indicating viewpoint origins for LVIA and HE Views.

The table below indicates our intention in terms of the type of photo and whether or not a CGI (wireline) is proposed.

For three of the views (HE2-4 inclusive), we think a normal photo and no CGI will suffice (tbc), for the reasons described below the table.

View Ref.	Brief Description.	Photo Type / CGI.
LVIA 1	E from Imperial Hotel	Tripod Photo + CGI
LVIA 2	NE from Princes Parade	Tripod Photo + CGI
LVIA 3	W from Sandgate Esplanade/PP	Tripod Photo + CGI
LVIA 4 + HE6	W from RMC Wharf	Tripod Photo + CGI
LVIA 5	South from RMC (Seaview Footbridge)	Tripod Photo + CGI
LVIA 6	S from Naildown Road	Tripod Photo + CGI
LVIA 7	SW from Hospital Hill	Tripod Photo + CGI

HE1	S from RMC Redoubt	Tripod Photo + CGI
HE2	W from Shorncliffe Battery	No CGI – tbc
HE3	W from Martello Tower No. 8 (resi)	No CGI – tbc
HE4	SW from Martello Tower No. 9 (woodland)	No CGI – tbc
HE5	E from RMC / Golf Course	Tripod Photo + CGI

- HE2. A CGI will be produced for LVIA View 3 (albeit at the lower level). We think this, combined with the limited visibility, potential limited access and lack of survey points for camera matching will negate a CGI from this location at present.
- HE3. We think there will be a lack of fixed survey points in the view for the purposes of camera matching. It will also cause far less disruption to the resident to go in quickly and take a quick set of photos with no survey and tripod equipment needed. Also – a similar viewpoint (with CGI) is likely to be gained from LVIA View 7.
- HE4. Lack of survey points for camera matching in the dense woodland. Glimpsed view, also similar in nature generally to view and CGI in LVIA View 7 (as above).

I would be grateful if you could provide us with your final comments on the above please.

Weather permitting we have Monday 5th and Tuesday 6th December (next week) to undertake the majority of the photography and survey work.

The photo that is likely to have to follow in due course is the one from Martello Tower No. 8, as we still require the client's view on how they would like us to pursue gaining access to this residential property.

I look forward to your comments,

Best wishes,

Paul

--

Paul Whatley BA (Hons) CMLI

Associate Director / Landscape Architect



Lloyd Bore Ltd.

33 St. George's Place, Canterbury, Kent CT1 1UT | T: 01227 484 340

59 Lambeth Walk, London, SE11 6DX | T: 02075 822 363

www.lloydbore.co.uk | E: paul.whatley@lloydbore.co.uk | M: 07471 036 660

We are fully committed to improving the quality of the work and services we provide. We welcome your feedback, and would be grateful if you could complete our [Customer Feedback Questionnaire](#).

[Follow Us on Twitter](#)



From: martin@mjmckay.wanadoo.co.uk
Sent: 01/12/2016 08:12:43
To: paul.whatley@lloydbore.co.uk
Cc:
Subject: RE: Princes Parade, Hythe: Heritage Views...

Paul – please see attached a marked up plan. Sorry its not the best scan but hope its clear. If not then phone me on 07855 375026. It marks the additional HE views. For the avoidance of doubt the redoubt is the stone structure opposite the carpark which overlooks the canal towards the sea. Its rather overgrown at present. The wharf is the stone structure at the end of the canal that looks west up it. The viewpoint in close proximity to the Martello tower will have to be hunted out- there is a small side path to it.

HE are very keen that the 3a is from the specific feature of the redoubt. I think you'd need to satisfy them that the alternative view is almost identical – in which case an illustrative view from it would do. Otherwise it would need to be an assessment viewpoint.

Hope this helps

Regards

Martin

From: Paul Whatley [<mailto:paul.whatley@lloydbore.co.uk>]
Sent: 29 November 2016 08:26
To: martin <martin@mjmckay.wanadoo.co.uk>
Cc: matt.shillito@tibbonalds.co.uk; ctslasioti@gt3architects.com; Dave.Shore@shepway.gov.uk
Subject: Princes Parade, Hythe: Heritage Views...

REFERENCE EML-OUT/3609/Con/20161129-82003-494

Martin,

Thanks for this. I have no problem with the additional views.

Yes – just for the avoidance of doubt, could you mark up the attached plan please with the additional views required by HE?

I also attach our map of LVIA Views. Would our View #4 be suitable for HE View 3a?

Many thanks,

Paul

Paul Whatley BA (Hons) CMLI
Associate Director / Landscape Architect



Lloyd Bore Ltd.

33 St. George's Place, Canterbury, Kent CT1 1UT | T: 01227 464 340

59 Lambeth Walk, London, SE11 6DX | T: 02075 822 363

www.lloydbore.co.uk | E: paul.whatley@lloydbore.co.uk | M: 07471 036 660

We are fully committed to improving the quality of the work and services we provide. We welcome your feedback, and would be grateful if you could complete our [Customer Feedback Questionnaire](#).

[Follow Us on Twitter](#)



From: martin [<mailto:martin@mjmckay.wanadoo.co.uk>]

Sent: 28 November 2016 20:23

To: Paul Whatley <paul.whatley@lloydbore.co.uk>

Cc: matt.shillito@tibbonalds.co.uk; ctsiasioti@gt3architects.com; Dave.Shore@shepway.gov.uk

Subject: RE: Princes Parade, Hythe: Heritage Views...

Paul- as promised, myself, Matt and Dave, amongst others, had a meeting with Peter Kendal of Historic England today.

With regard to assessment viewpoints we agreed the following:

- 1) HE viewpoints 1-3 (figure 10.18)- as per comments in emails string below including assessment viewpoint from top of the redoubt looking out to sea (should now be accessible given that vegetation has died back). With regard to Shorncliffe battery- houses are built on top of the battery and there is communal open space there which should be accessible (although Peter Kendal thinks that some of it may have been 'appropriated' for private gardens). Both myself and Peter think that it is unlikely that there will be views from it in which the site will be prominent- although we may be wrong. You will have to be assiduous in checking this. Illustrative view will be fine, unless you find that there is a good view to the site, in which case an assessment view will be required.
- 2) Assessment viewpoints (figure 10.17) - fine – but note comments re view 6 and 7 below
- 3) Further assessment viewpoints required by HE:
 - a) From stone wharf at eastern terminus of the canal looking west straight up the canal
 - b) As discussed in the email string below, viewpoint from south bank of the canal to the west of the site looking east along the canal. Peter Kendal suggested that just north of the 'blue flag' on the OS map (or your diagrams) would be ideal.
 - c) From the vicinity of Martello Tower No. 9 - within the woodland of Hospital Hill. Due to the wooded nature of the surroundings of the tower, the view over the site has to be hunted out. It is slightly to the west and south of the tower and best found by following paths to the south of the tower. View C2 in my report dated November 2015/ July 2016 illustrates the view.

I can mark these on your diagram if this would be helpful.

Regards

Martin

From: Paul Whatley [<mailto:paul.whatley@lloydbore.co.uk>]
Sent: 14 November 2016 12:05
To: martin <martin@mjmckay.wanadoo.co.uk>
Cc: matt.shillito@tibbonalds.co.uk; ctsiastoti@gt3architects.com; Dave.Shore@shepway.gov.uk
Subject: Princes Parade, Hythe: Heritage Views...

REFERENCE EML-OUT/3609/Con/20161114-114334-197

Hi Martin,

Thanks for responding, please see below my comments in RED.

Best wishes,

Paul

--

Paul Whatley BA (Hons) CMLI
Associate Director / Landscape Architect



Lloyd Bore Ltd.
33 St. George's Place, Canterbury, Kent CT1 1UT | T: 01227 464 340
59 Lambeth Walk, London, SE11 6DX | T: 02075 822 363
www.lloydbore.co.uk | E: paul.whatley@lloydbore.co.uk | M: 07471 036 660

We are fully committed to improving the quality of the work and services we provide. We welcome your feedback, and would be grateful if you could complete our [Customer Feedback Questionnaire](#).

[Follow Us on Twitter!](#)



From: martin [<mailto:martin@mjmckay.wanadoo.co.uk>]
Sent: 12 November 2016 13:09
To: Paul Whatley <paul.whatley@lloydbore.co.uk>
Subject: RE: Princes Parade, Hythe: Heritage Views Confirmation...

Thanks Paul. Sorry to get back to you earlier in the week.

I've had a look at this and the mail you sent yesterday to Dave Shore.

Comments as follows:

HE viewpoints:

- 1) Top of redoubt- if this can be accessed then looking out to sea- otherwise as close by as possible. It strikes me that this viewpoint could replace your proposed Assessment Viewpoint 4. Noted, thank you. We will take two separate photos, as one is specific to the LVIA and the other to Heritage Assets.

- 2) With regard to the Shorncliffe battery, HE have said *'There is a question as to what is visible between the RMC and the Shorncliffe battery. Historically these were designed to be inter-visible for gun fire but today I am not sure how far development has closed off the views. I suggest that the top of the battery will need to be visited and an assessment made.* From this there is obviously a degree of judgement to be used as to the precise location of the viewpoint. If the view is somewhat obscured then only an illustrative photo or photos need be taken. Thank you. We are happy to investigate this on site on your behalf, as part of our LVIA Photography work.
- 3) I believe that there may be an accessible balcony on the roof. Otherwise, from the highest viewpoint towards the site is fine. Thank you. I am awaiting final confirming from David Shore as to how he would like access to be arranged to this private property.

HE also mentioned approach experiences from the east thus: *The Royal Military Canal is approached along the coast road from Sandgate, past the huge Shorncliffe battery, and the basin comes into sight and a long view down the canal opens up. How will this experience change?* This will be covered in our LVIA within the context of landscape and views, using the illustrative photos and assessment views provided.

I believe that your views show that not much of this experience remains- but it would be useful to check this out on site. Please see above.

Other illustrative views suggested by HE

- 1) From the eastern most 'kink in the canal on north bank, looking west along the canal and across to the site. Please see attached illustrative photo for your use (DSCN0345).
- 2) From the canal bank (north or south) by the golf course looking east along the canal towards the site. Distance of the viewpoint to the west of the site was not specified by HE, but I would suggest a reasonable distance so that the site and the canal can be seen in context- i.e. a200m or so to the west of the site. We have not taken a view from this precise location and do not intend to as part of our LVIA work, because there are other representative views which illustrate what can be seen from this location. Please could you confirm if this is a location that you require taken with a camera and tripod and a CGI? If this is not required it may need to be an illustrative photo taken by yourself for the purposes of the Heritage Assessment commentary. We have taken the attached from the footpath leading north / south across the golf course to the west of the site (DSCN0562), if it is any use?

Other points:

By just moving around a little bit views to the site from illustrative viewpoints 20, 24, and Assessment Viewpoints 6 and 7 could be improved (i.e. more of the site could be seen). Noted, thanks. We will adjust this as required for the final LVIA Photos and HE1-HE3.

I agree with the selection Assessment Viewpoints (as compared to illustrative) but have not run this past HE. I am happy to send them off now (i.e. ASAP) and will discuss this further with HE when I meet them on the 28th November. Thank you. We would emphasise again the use of Representative Views in our LVIA. These need to be clearly distinguished from the Specific Views that are required by HE.

Regards

Martin

From: Paul Whatley [<mailto:paul.whatley@lloydbore.co.uk>]
Sent: 08 November 2016 16:56
To: martin@mimckay.wanadoo.co.uk
Cc: Dave.Shore@shepway.gov.uk; firbank@callnetuk.com
Subject: Princes Parade, Hythe: Heritage Views Confirmation...

REFERENCE EML-OUT/3609/20161108-162310-437

Dear Martin,

Further to recent correspondence on Heritage Views, I enclose a copy of the document table at the DTM last week.

I am now in the process of finalising some text to support this, with the primary aim of:

1. Agreeing LVIA Viewpoints with Shepway D.C and;
2. Agreeing precise location and details of Views which are required by Heritage England.

I intend to add to the View Location Plan the locations of the following views, as indicated on your plan which I also attach for reference:

HE1: From on top of the redoubt (stone wall) at the basin looking south, directly out to sea.

HE2: From on top of Shorncliffe battery (which appears as a stone retaining wall alongside the sea road) towards the site. We understand that Heritage England have requested that the viewpoint be chosen that affords a view of the site beyond the recent buildings to its east (if one is available).

HE3: From the uppermost floor of Martello Tower No8. We understand that Heritage England previously requested a view from the roof, but we cannot do this due to Health and Safety Risks.

Firstly; I would be grateful if you could comment on the above please and confirm that I have the precise location, viewing direction and context correct?

Once we have this confirmed, I will approach David Shore in order to request his preferred method of our Photographer and Surveyor gaining authorised access to these locations to take photographs.

Secondly; Please could you confirm if these are the only Assessment Viewpoints that are required by Heritage England? You mentioned in a past telephone conversation that there may be others that have emerged in your correspondence with them.

Finally, I would like to confirm that it is our current intention to take Camera+Tripod+Surveyor views from all of the 7no. specified LVIA Assessment Viewpoint Origins and produce a wireline CGI for each of these.

We are also intending to take this kind of Photo and CGI from the 3no. Heritage Viewpoint Origins.

Please could you confirm if you require any additional Photos/CGIs for the purposes of your discussions with Heritage England or your assessment?

At this stage for example, we do not intend (and do not have fees agreed with Shepway) to take photos / produce CGIs from all of the positions marked with a red spot on your plan (A1-C3). That said, we do have a bank of photos from most of these locations taken with a standard 'point and shoot' camera, which we would be more than happy to share with you in due course via file download transfer (due to file size).

I hope this above is clear and helpful and I would be more than happy to discuss with you tomorrow.

If you are able to get back to me asap I would very much appreciate it, as I need to circulate this information to SBC and HE without delay.

I also attach a more detailed OS Plan, which may be useful for marking up in relation to the required views.

Many thanks,

Paul

--

Paul Whatley BA (Hons) CMLI
Associate Director / Landscape Architect



Lloyd Bore Ltd.
33 St. George's Place, Canterbury, Kent CT1 1UT | T: 01227 464 340
59 Lambeth Walk, London, SE11 6DX | T: 02075 822 363
www.lloydbore.co.uk | E: paul.whatley@lloydbore.co.uk | M: 07471 036 660

We are fully committed to improving the quality of the work and services we provide. We welcome your feedback, and would be grateful if you could complete our [Customer Feedback Questionnaire](#).

[Follow Us on Twitter](#)



The contents and any attachments of this e-mail message are confidential and intended only for the named addressees. If you have received it in error, please advise the sender immediately by return email and then delete it from your system. Any unauthorised distribution or copying of this transmission, or misuse or wrongful disclosure of information contained in it, is strictly prohibited. Shepway District Council cannot accept liability for any statements made which are clearly the sender's own and not expressly made on behalf of the council. All email to and from the council may be monitored in accordance with the council's policies.



The contents and any attachments of this e-mail message are confidential and intended only for the named addressees. If you have received it in error, please advise the sender immediately by return email and then delete it from your system. Any unauthorised distribution or copying of this transmission, or misuse or wrongful disclosure of information contained in it, is strictly prohibited. Shepway District Council cannot accept liability for any statements made which are clearly the sender's own and not expressly made on behalf of the council. All email to and from the council may be monitored in accordance with the council's policies.

Wignall, Peter

From: Paul Whatley [paul.whatley@lloydbore.co.uk]
Sent: 12 December 2016 11:18
To: Dave.Shore@shepway.gov.uk
Subject: FW: Princes Parade, Hythe: PRow Refs...

REFERENCE EML-OUT/3609/20161212-111720-666

Hi David,

When you get a chance, if you could respond to my query below I would be very grateful.

I think it was sent over during the Public Consultations.

Best wishes,

Paul

Paul Whatley BA (Hons) CMLI
Associate Director / Landscape Architect



Lloyd Bore Ltd. 20 YEARS 1996 – 2016.
33 St. George's Place, Canterbury, Kent CT1 1UT | T: 01227 464 340
59 Lambeth Walk, London, SE11 8DX | T: 02075 822 363
www.lloydbore.co.uk | E: paul.whatley@lloydbore.co.uk | M: 07471 036 660

We are fully committed to improving the quality of the work and services we provide. We welcome your feedback, and would be grateful if you could complete our [Customer Feedback Questionnaire](#).

[Follow Us on Twitter](#)



From: paul.whatley@lloydbore.co.uk
Sent: 28/11/2016 14:57:19
To: Dave.Shore@shepway.gov.uk
Cc:
Subject: Princes Parade, Hythe: PRow Refs...

REFERENCE EML-OUT/3609/20161128-145437-372

Hi Dave,

Could you advise if there is a local record of the Public Right of Way references for the site and surroundings please?

We normally use the Kent Interactive Map to obtain these (KCC), but it seems to be playing up at the moment and need to check a few references as part of our LVIA work.

Perhaps there is a local library where this info is held, or even a resource that your colleagues may have access to?

Many thanks,

Paul

Paul Whatley BA (Hons) CMLI

Associate Director / Landscape Architect



Lloyd Bore Ltd.

33 St. George's Place, Canterbury, Kent CT1 1UT | T: 01227 484 340

59 Lambeth Walk, London, SE11 6DX | T: 02075 822 363

www.lloydbore.co.uk | E: paul.whatley@lloydbore.co.uk | M: 07471 036 660

We are fully committed to improving the quality of the work and services we provide. We welcome your feedback, and would be grateful if you could complete our [Customer Feedback Questionnaire](#).

[Follow Us on Twitter!](#)



Wignall, Peter

From: Shore, Dave [Dave.Shore@shepway.gov.uk]
Sent: 13 December 2016 10:47
To: 'Paul Whatley'
Cc: Jarrett, Andy
Subject: FW: Princes Parade
Attachments: Image003.jpg; Martello 8 letter.docx

Paul

Further to your e-mail yesterday see below an e-mail I sent to our transport consultants MLM regarding the local footpath/bridleway network. Is this sufficient or would you like me to do some further investigation?

I also attach a draft letter for Martello No.8. Grateful for your thoughts.

Dave

David Shore

Strategic Development Projects Manager

t: 01303 853459

m: 07976 958486

f: 01303 853502

Shepway District Council, Civic Centre,

Castle Hill Avenue, Folkestone, Kent, CT20 2QY.

E: dave.shore@shepway.gov.uk

www.shepway.gov.uk

Follow us on [Twitter](#) and [Facebook](#)

"The contents and any attachments of this e-mail message are confidential and intended only for the named addressees. If you have received it in error, please advise the sender immediately by return email and then delete it from your system. Any unauthorised distribution, or copying of this transmission, or mis-use or wrongful disclosure of information contained in it, is strictly prohibited. Shepway District Council cannot accept liability for any statements made which are clearly the sender's own and not expressly made on behalf of the council."

From: Shore, Dave [<mailto:Dave.Shore@shepway.gov.uk>]
Sent: 04 August 2016 15:42
To: Jonathan Rodger
Cc: les.brown@mlm.uk.com; Jarrett, Andy; McGowan, Brendan; sue.rowlands@tibbalds.co.uk; claire.perrott@tibbalds.co.uk; adriana.bonilla@tibbalds.co.uk
Subject: Princes Parade

Jonathan

At the recent design team meeting it was said that you were trying to track down the definitive footpath map from KCC. Have you managed to get hold of this? The extract below I have taken from our own GIS which might be of use. The route shown in blue to the north of the Canal is denoted as public footpath HB56. The green route to the north of the canal is public bridleway HB65. The green route to the south of the canal is public bridleway HB83. The bridges crossing the canal/site are shown as part of the road network. The western one is College Bridge (U15302) and the eastern one (U15303).

Dave

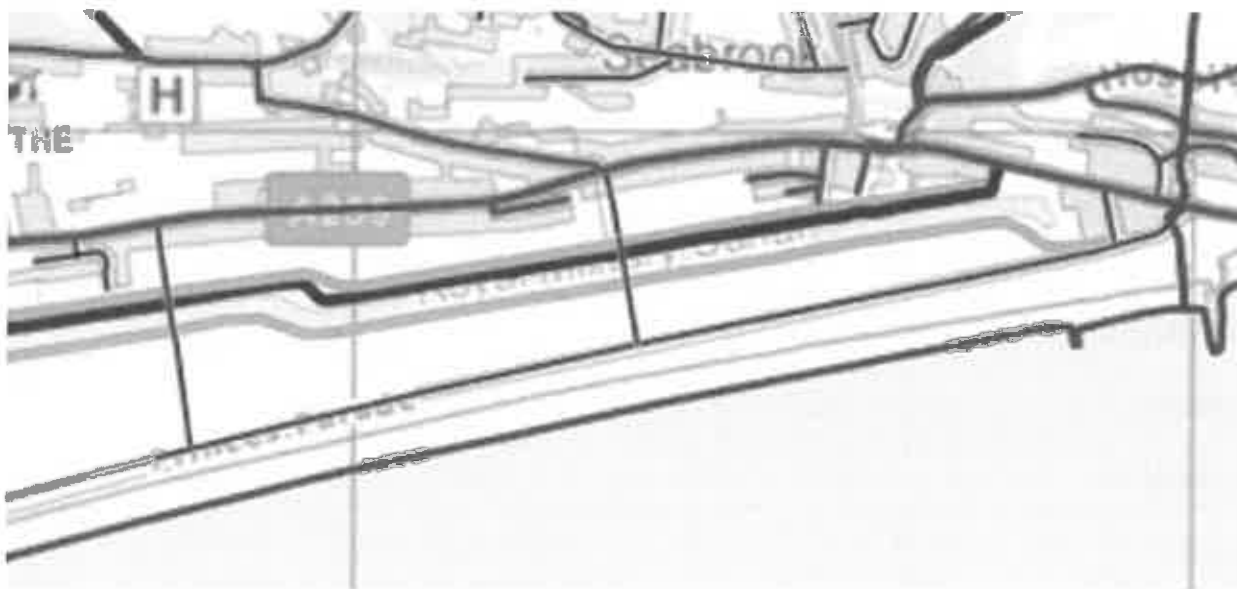

David Shore

Strategic Development Projects Manager

t: 01303 853459

m: 07976 958486

f: 01303 853502

Shepway District Council, Civic Centre,

Castle Hill Avenue, Folkestone, Kent, CT20 2QY.

E: dave.shore@shepway.gov.uk

www.shepway.gov.uk

Follow us on [Twitter](#) and [Facebook](#)

"The contents and any attachments of this e-mail message are confidential and intended only for the named addressees. If you have received it in error, please advise the sender immediately by return email and then delete it from your system. Any unauthorised distribution, or copying of this transmission, or mis-use or wrongful disclosure of information contained in it, is strictly prohibited. Shepway District Council cannot accept liability for any statements made which are clearly the sender's own and not expressly made on behalf of the council."

Wignall, Peter

From: Paul Whatley [paul.whatley@lloydbore.co.uk]
Sent: 13 December 2016 13:15
To: Dave.Shore@shepway.gov.uk
Subject: Princes Parade: PRow Refs...
Attachments: image002.jpg

REFERENCE EML-OUT/3609/20161213-131149-501

Hi David,

We need the footpath references for a much wider area please, as per the preliminary baseline map in our Landscape Appendix 1 (uploaded on Box.com).

Kent Interactive Website provides some of these, but there are problems with the website where you cannot easily identify some of the Ref No.s which are in close proximity to one another.

Does Shepway keep these on file somewhere, perhaps at a local library?

Or alternatively could we supply a map to one of your colleagues to mark up for us?

The details would be helpful as soon as possible as we move into the stage of typing everything up and try to avoid any stray or incorrect references as we move through the document to completion.

I will review the letter asap and get back to you.

Paul

Paul Whatley BA (Hons) CMLI
Associate Director / Landscape Architect



Lloyd Bore Ltd. 20 YEARS 1996 – 2016.
33 St. George's Place, Canterbury, Kent CT1 1UT | T: 01227 464 340
59 Lambeth Walk, London, SE11 6DX | T: 02075 822 363
www.lloydbore.co.uk | E: paul.whatley@lloydbore.co.uk | M: 07471 036 660

We are fully committed to improving the quality of the work and services we provide. We welcome your feedback, and would be grateful if you could complete our [Customer Feedback Questionnaire](#).

[Follow Us on Twitter!](#)



From: Dave.Shore@shepway.gov.uk [mailto:Dave.Shore@shepway.gov.uk]
Sent: 13 December 2016 10:47
To: Paul Whatley <paul.whatley@lloydbore.co.uk>
Cc: Andy.Jarrett@shepway.gov.uk
Subject: FW: Princes Parade

Paul

Further to your e-mail yesterday see below an e-mail I sent to our transport consultants MLM regarding the local footpath/bridleway network. Is this sufficient or would you like me to do some further investigation?

I also attach a draft letter for Martello No.8. Grateful for your thoughts.

Dave

David Shore

Strategic Development Projects Manager

t: 01303 853459

m: 07976 958486

f: 01303 853502

Shepway District Council, Civic Centre,

Castle Hill Avenue, Folkestone, Kent, CT20 2QY.

E: dave.shore@shepway.gov.uk

www.shepway.gov.uk

Follow us on [Twitter](#) and [Facebook](#)

"The contents and any attachments of this e-mail message are confidential and intended only for the named addressees. If you have received it in error, please advise the sender immediately by return email and then delete it from your system. Any unauthorised distribution, or copying of this transmission, or mis-use or wrongful disclosure of information contained in it, is strictly prohibited. Shepway District Council cannot accept liability for any statements made which are clearly the sender's own and not expressly made on behalf of the council."

From: Shore, Dave [<mailto:Dave.Shore@shepway.gov.uk>]

Sent: 04 August 2016 15:42

To: Jonathan Rodger

Cc: les.brown@mlm.uk.com; Jarrett, Andy; McGowan, Brendan; sue.rowlands@tbbalds.co.uk;

claire.perrott@tbbalds.co.uk; adriana.bonilla@tbbalds.co.uk

Subject: Princes Parade

Jonathan

At the recent design team meeting it was said that you were trying to track down the definitive footpath map from KCC. Have you managed to get hold of this? The extract below I have taken from our own GIS which might be of use. The route shown in blue to the north of the Canal is denoted as public footpath HB56. The green route to the north of the canal is public bridleway HB65. The green route to the south of the canal is public bridleway HB83. The bridges crossing

the canal/site are shown as part of the road network. The western one is College Bridge (U15302) and the eastern one (U15303).

Dave

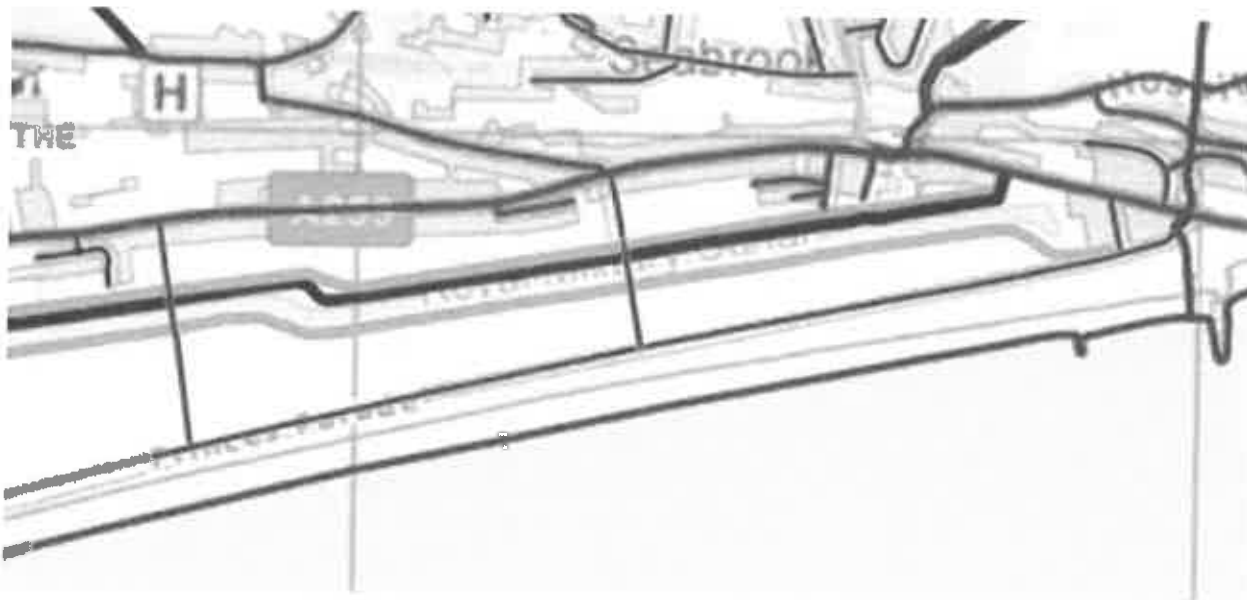

David Shore

Strategic Development Projects Manager

t: 01303 853459

m: 07976 958486

f: 01303 853502

Shepway District Council, Civic Centre,

Castle Hill Avenue, Folkestone, Kent, CT20 2QY.

E: dave.shore@shepway.gov.uk

www.shepway.gov.uk

Follow us on [Twitter](#) and [Facebook](#)

"The contents and any attachments of this e-mail message are confidential and intended only for the named addressees. If you have received it in error, please advise the sender immediately by return email and then delete it from your system. Any unauthorised distribution, or copying of this transmission, or mis-use or wrongful disclosure of information contained in it, is strictly prohibited. Shepway District Council cannot accept liability for any statements made which are clearly the sender's own and not expressly made on behalf of the council."

CUSTOMER
SERVICE
EXCELLENCE



The contents and any attachments of this e-mail message are confidential and intended only for the named addressees. If you have received it in error, please advise the sender immediately by return email and then delete it from your system. Any unauthorised distribution or copying of this transmission, or misuse or wrongful disclosure of information contained in it, is strictly prohibited. Shepway District Council cannot accept liability for any statements made which are clearly the sender's own and not expressly made on behalf of the council. All email to and from the council may be monitored in accordance with the council's policies.

Wignall, Peter

From: Shore, Dave [Dave.Shore@shepway.gov.uk]
Sent: 13 December 2016 14:20
To: 'Paul Whatley'
Subject: RE: Princes Parade: PRoW Refs...
Attachments: image002.jpg

Paul

The link below suggests that the definitive map is available to view at Invicta House. Copies also at a number of local libraries but these may not be as up to date.

<http://www.kent.gov.uk/waste-planning-and-land/public-rights-of-way/rights-of-way-map#tab-1>

Alternatively we do have PROW information (including reference numbers) on our own internal mapping system. We could get the information off of there but again perhaps not as accurate as that held by KCC. Does this help?

Dave

David Shore

Strategic Development Projects Manager

t: 01303 853459

m: 07976 958486

f: 01303 853502

Shepway District Council, Civic Centre,

Castle Hill Avenue, Folkestone, Kent, CT20 2QY.

E: dave.shore@shepway.gov.uk

www.shepway.gov.uk

Follow us on [Twitter](#) and [Facebook](#)

"The contents and any attachments of this e-mail message are confidential and intended only for the named addressees. If you have received it in error, please advise the sender immediately by return email and then delete it from your system. Any unauthorised distribution, or copying of this transmission, or mis-use or wrongful disclosure of information contained in it, is strictly prohibited. Shepway District Council cannot accept liability for any statements made which are clearly the sender's own and not expressly made on behalf of the council."

From: Paul Whatley [mailto:paul.whatley@lloydbore.co.uk]
Sent: 13 December 2016 13:15
To: Shore, Dave
Subject: Princes Parade: PRoW Refs...

REFERENCE EML-OUT/3609/20161213-131149-501

Hi David,

We need the footpath references for a much wider area please, as per the preliminary baseline map in our Landscape Appendix 1 (uploaded on Box.com).

Kent Interactive Website provides some of these, but there are problems with the website where you cannot easily identify some of the Ref No.s which are in close proximity to one another.

Does Shepway keep these on file somewhere, perhaps at a local library?

Or alternatively could we supply a map to one of your colleagues to mark up for us?

The details would be helpful as soon as possible as we move into the stage of typing everything up and try to avoid any stray or incorrect references as we move through the document to completion.

I will review the letter asap and get back to you.

Paul

--

Paul Whatley BA (Hons) CMLI
Associate Director / Landscape Architect



Lloyd Bore Ltd. 20 YEARS 1996 – 2016.
33 St. George's Place, Canterbury, Kent CT1 1UT | T: 01227 464 340
59 Lambeth Walk, London, SE11 6DX | T: 02075 822 363
www.lloydbore.co.uk | E: paul.whatley@lloydbore.co.uk | M: 07471 036 660

We are fully committed to improving the quality of the work and services we provide. We welcome your feedback, and would be grateful if you could complete our [Customer Feedback Questionnaire](#).

[Follow Us on Twitter!](#)



From: Dave.Shore@shepway.gov.uk [<mailto:Dave.Shore@shepway.gov.uk>]
Sent: 13 December 2016 10:47
To: Paul Whatley <paul.whatley@lloydbore.co.uk>
Cc: Andy.Jarrett@shepway.gov.uk
Subject: FW: Princes Parade

Paul

Further to your e-mail yesterday see below an e-mail I sent to our transport consultants MLM regarding the local footpath/bridleway network. Is this sufficient or would you like me to do some further investigation?

I also attach a draft letter for Martello No.8. Grateful for your thoughts.

Dave

David Shore

Strategic Development Projects Manager

t: 01303 853459

m: 07976 958486

f: 01303 853502

Shepway District Council, Civic Centre,

Castle Hill Avenue, Folkestone, Kent, CT20 2QY.

E: dave.shore@shepway.gov.uk

www.shepway.gov.uk

Follow us on [Twitter](#) and [Facebook](#)

"The contents and any attachments of this e-mail message are confidential and intended only for the named addressees. If you have received it in error, please advise the sender immediately by return email and then delete it from your system. Any unauthorised distribution, or copying of this transmission, or mis-use or wrongful disclosure of information contained in it, is strictly prohibited. Shepway District Council cannot accept liability for any statements made which are clearly the sender's own and not expressly made on behalf of the council."

From: Shore, Dave [<mailto:Dave.Shore@shepway.gov.uk>]

Sent: 04 August 2016 15:42

To: Jonathan Rodger

Cc: les.brown@mlm.uk.com; Jarrett, Andy; McGowan, Brendan; sue.rowlands@tibbon.co.uk;

claire.perrott@tibbon.co.uk; adriana.bonilla@tibbon.co.uk

Subject: Princes Parade

Jonathan

At the recent design team meeting it was said that you were trying to track down the definitive footpath map from KCC. Have you managed to get hold of this? The extract below I have taken from our own GIS which might be of use. The route shown in blue to the north of the Canal is denoted as public footpath HB56. The green route to the north of the canal is public bridleway HB65. The green route to the south of the canal is public bridleway HB83. The bridges crossing the canal/site are shown as part of the road network. The western one is College Bridge (U15302) and the eastern one (U15303).

Dave

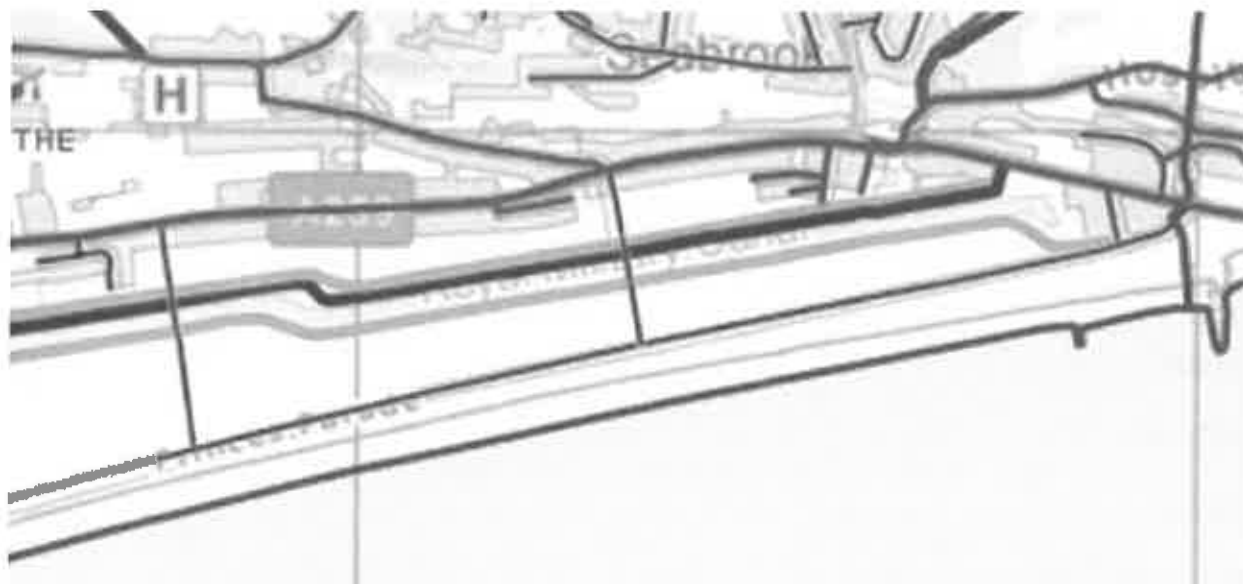

David Shore

Strategic Development Projects Manager

t: 01303 853459

m: 07976 958486

f: 01303 853502

Shepway District Council, Civic Centre,

Castle Hill Avenue, Folkestone, Kent, CT20 2QY.

E: dave.shore@shepway.gov.uk

www.shepway.gov.uk

Follow us on Twitter and Facebook

"The contents and any attachments of this e-mail message are confidential and intended only for the named addressees. If you have received it in error, please advise the sender immediately by return email and then delete it from your system. Any unauthorised distribution, or copying of this transmission, or mis-use or wrongful disclosure of information contained in it, is strictly prohibited. Shepway District Council cannot accept liability for any statements made which are clearly the sender's own and not expressly made on behalf of the council."



The contents and any attachments of this e-mail message are confidential and intended only for the named addressees. If you have received it in error, please advise the sender immediately by return email and then delete it from your system. Any unauthorised distribution or copying of this transmission, or misuse or wrongful disclosure of information contained in it, is strictly prohibited. Shepway District Council cannot accept liability for any statements made which are clearly the sender's own and not expressly made on behalf of the council. All email to and from the council may be monitored in accordance with the council's policies.

Wignall, Peter

From: Paul Whatley [paul.whatley@lloydbore.co.uk]
Sent: 13 December 2016 14:50
To: Dave.Shore@shepway.gov.uk
Cc: Andy.Jarrett@shepway.gov.uk; Chris Beech
Subject: Princes Parade: Martello Tower No.8 Photo...
Attachments: image002.jpg

REFERENCE EML-OUT/3609/20161213-144023-064

David,

Thank you drafting this letter to try to gain access to Martello Tower No. 8.

My colleague Chris Beech has confirmed his availability to take a photo (weather permitting), on the following days:

- Monday 19th Dec.
- Tuesday 20th Dec
- Monday 9th Jan
- Tuesday 10th Jan
- Friday 13th Jan.

Due to the aspect of the view, generally facing west, the best time to take the photo would probably be during the morning – although this is completely dependent on weather and lighting on the day.

We would offer the residents to provide their preferred time for us to come on the chosen day between 9am-1pm (as a starting point). However, it would be our intention to come at the earliest possible time so they are not waiting around for us.

Our aim is for Chris to access the top floor of the tower in order to take a photos as quickly as possible. I think he would only need 5-10mins (max).

Could the above be added to the letter if possible please and posted to them on Shepway Head Note Paper?

I wonder if the best way is to offer them the opportunity to phone or email you to confirm their preferred date/time.

All being well they would reply soon and we can get the photo taken at one of the earlier dates above.

Many thanks,

Paul

Paul Whatley BA (Hons) CMLI
Associate Director / Landscape Architect



Lloyd Bore Ltd. 20 YEARS 1996 – 2016.
33 St. George's Place, Canterbury, Kent CT1 1UT | T: 01227 464 340
59 Lambeth Walk, London, SE11 6DX | T: 02075 822 363
www.lloydbore.co.uk | E: paul.whatley@lloydbore.co.uk | M: 07471 036 680

We are fully committed to improving the quality of the work and services we provide. We welcome your feedback, and would be grateful if you could complete our [Customer Feedback Questionnaire](#).

[Follow Us on Twitter](#)



From: Dave.Shore@shepway.gov.uk [mailto:Dave.Shore@shepway.gov.uk]
Sent: 13 December 2016 10:47
To: Paul Whatley <paul.whatley@lloydbore.co.uk>
Cc: Andy.Jarrett@shepway.gov.uk
Subject: FW: Princes Parade

Paul

Further to your e-mail yesterday see below an e-mail I sent to our transport consultants MLM regarding the local footpath/bridleway network. Is this sufficient or would you like me to do some further investigation?

I also attach a draft letter for Martello No.8. Grateful for your thoughts.

Dave

David Shore

Strategic Development Projects Manager

t: 01303 853459

m: 07976 958486

f: 01303 853502

Shepway District Council, Civic Centre,

Castle Hill Avenue, Folkestone, Kent, CT20 2QY.

E: dave.shore@shepway.gov.uk

www.shepway.gov.uk

Follow us on [Twitter](#) and [Facebook](#)

"The contents and any attachments of this e-mail message are confidential and intended only for the named addressees. If you have received it in error, please advise the sender immediately by return email and then delete it from your system. Any unauthorised distribution, or copying of this transmission, or mis-use or wrongful disclosure of information contained in it, is strictly prohibited. Shepway District Council cannot accept liability for any statements made which are clearly the sender's own and not expressly made on behalf of the council."

From: Shore, Dave [mailto:Dave.Shore@shepway.gov.uk]
Sent: 04 August 2016 15:42

To: Jonathan Rodger

Cc: les.brown@mlm.uk.com; Jarrett, Andy; McGowan, Brendan; sue.rowlands@tibbonalds.co.uk;

claire.perrott@tibbonalds.co.uk; adriana.bonilla@tibbonalds.co.uk

Subject: Princes Parade

Jonathan

At the recent design team meeting it was said that you were trying to track down the definitive footpath map from KCC. Have you managed to get hold of this? The extract below I have taken from our own GIS which might be of use. The route shown in blue to the north of the Canal is denoted as public footpath HB56. The green route to the north of the canal is public bridleway HB65. The green route to the south of the canal is public bridleway HB83. The bridges crossing the canal/site are shown as part of the road network. The western one is College Bridge (U15302) and the eastern one (U15303).

Dave

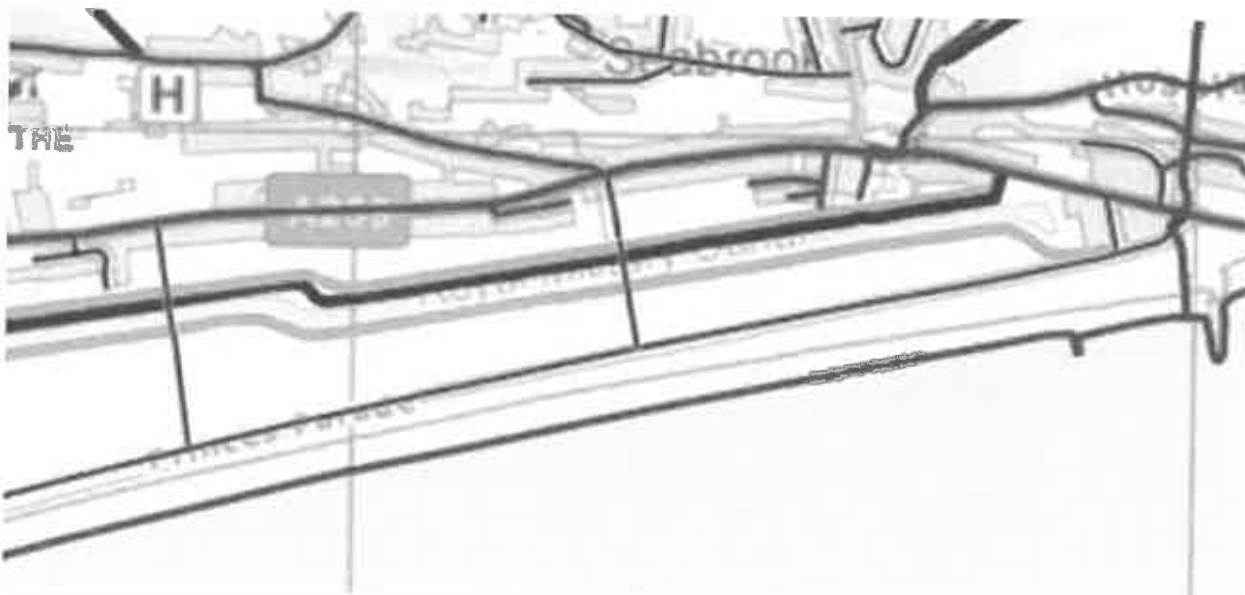

David Shore

Strategic Development Projects Manager

t: 01303 853459

m: 07976 958486

f: 01303 853502

Shepway District Council, Civic Centre,

Castle Hill Avenue, Folkestone, Kent, CT20 2QY.

E: dave.shore@shepway.gov.uk

www.shepway.gov.uk

Follow us on [Twitter](#) and [Facebook](#)

"The contents and any attachments of this e-mail message are confidential and intended only for the named addressees. If you have received it in error, please advise the sender immediately by return email and then delete it from your system. Any unauthorised distribution, or copying of this transmission, or mis-use or wrongful disclosure of information contained in it, is strictly prohibited. Shepway District Council cannot accept liability for any statements made which are clearly the sender's own and not expressly made on behalf of the council."



The contents and any attachments of this e-mail message are confidential and intended only for the named addressees. If you have received it in error, please advise the sender immediately by return email and then delete it from your system. Any unauthorised distribution or copying of this transmission, or misuse or wrongful disclosure of information contained in it, is strictly prohibited. Shepway District Council cannot accept liability for any statements made which are clearly the sender's own and not expressly made on behalf of the council. All email to and from the council may be monitored in accordance with the council's policies.

Wignall, Peter

From: Paul Whatley [paul.whatley@lloydbore.co.uk]
Sent: 13 December 2016 14:58
To: Dave.Shore@shepway.gov.uk
Subject: RE: Princes Parade: PRoW Refs...
Attachments: image002.jpg

REFERENCE EML-OUT/3609/20161213-145634-725

Thank you David,

I will have a look again at what we have/haven't got in terms of PRoW Ref.Nos.

It might be possible for me to highlight a few queries on a plan and send it over to check on your internal mapping system. Would that be ok?

Paul

Paul Whatley BA (Hons) CMLI

Associate Director / Landscape Architect



Lloyd Bore Ltd. 20 YEARS 1996 – 2016.

33 St. George's Place, Canterbury, Kent CT1 1UT | T: 01227 464 340

59 Lambeth Walk, London, SE11 6DX | T: 02075 822 363

www.lloydbore.co.uk | E: paul.whatley@lloydbore.co.uk | M: 07471 036 660

We are fully committed to improving the quality of the work and services we provide. We welcome your feedback, and would be grateful if you could complete our [Customer Feedback Questionnaire](#).

[Follow Us on Twitter](#)



From: Dave.Shore@shepway.gov.uk [mailto:Dave.Shore@shepway.gov.uk]
Sent: 13 December 2016 14:20
To: Paul Whatley <paul.whatley@lloydbore.co.uk>
Subject: RE: Princes Parade: PRoW Refs...

Paul

The link below suggests that the definitive map is available to view at Invicta House. Copies also at a number of local libraries but these may not be as up to date.

<http://www.kent.gov.uk/waste-planning-and-land/public-rights-of-way/rights-of-way-map#tab-1>

Alternatively we do have PROW information (including reference numbers) on our own internal mapping system. We could get the information off of there but again perhaps not as accurate as that held by KCC. Does this help?

Dave

David Shore

Strategic Development Projects Manager

t: 01303 853459

m: 07976 958486

f: 01303 853502

Shepway District Council, Civic Centre,

Castle Hill Avenue, Folkestone, Kent, CT20 2QY.

E: dave.shore@shepway.gov.uk

www.shepway.gov.uk

Follow us on [Twitter](#) and [Facebook](#)

"The contents and any attachments of this e-mail message are confidential and intended only for the named addressees. If you have received it in error, please advise the sender immediately by return email and then delete it from your system. Any unauthorised distribution, or copying of this transmission, or mis-use or wrongful disclosure of information contained in it, is strictly prohibited. Shepway District Council cannot accept liability for any statements made which are clearly the sender's own and not expressly made on behalf of the council."

From: Paul Whatley [<mailto:paul.whatley@lloydbore.co.uk>]

Sent: 13 December 2016 13:15

To: Shore, Dave

Subject: Princes Parade: PROW Refs...

REFERENCE EML-OUT/3609/20161213-131149-501

Hi David,

We need the footpath references for a much wider area please, as per the preliminary baseline map in our Landscape Appendix 1 (uploaded on Box.com).

Kent Interactive Website provides some of these, but there are problems with the website where you cannot easily identify some of the Ref No.s which are in close proximity to one another.

Does Shepway keep these on file somewhere, perhaps at a local library?

Or alternatively could we supply a map to one of your colleagues to mark up for us?

The details would be helpful as soon as possible as we move into the stage of typing everything up and try to avoid any stray or incorrect references as we move through the document to completion.

I will review the letter asap and get back to you.

Paul

Paul Whatley BA (Hons) CMLI
Associate Director / Landscape Architect



Lloyd Bore Ltd. 20 YEARS 1996 – 2016.
33 St. George's Place, Canterbury, Kent CT1 1UT | T: 01227 464 340
59 Lambeth Walk, London, SE11 6DX | T: 02075 822 363
www.lloydbore.co.uk | E: paul.whatley@lloydbore.co.uk | M: 07471 036 660

We are fully committed to improving the quality of the work and services we provide. We welcome your feedback, and would be grateful if you could complete our [Customer Feedback Questionnaire](#).

[Follow Us on Twitter!](#)



From: Dave.Shore@shepway.gov.uk [<mailto:Dave.Shore@shepway.gov.uk>]
Sent: 13 December 2016 10:47
To: Paul Whatley <paul.whatley@lloydbore.co.uk>
Cc: Andy.Jarrett@shepway.gov.uk
Subject: FW: Princes Parade

Paul

Further to your e-mail yesterday see below an e-mail I sent to our transport consultants MLM regarding the local footpath/bridleway network. Is this sufficient or would you like me to do some further investigation?

I also attach a draft letter for Martello No.8. Grateful for your thoughts.

Dave

David Shore

Strategic Development Projects Manager

t: 01303 853459

m: 07976 958486

f: 01303 853502

Shepway District Council, Civic Centre,

Castle Hill Avenue, Folkestone, Kent, CT20 2QY.

E: dave.shore@shepway.gov.uk

www.shepway.gov.uk

Follow us on [Twitter](#) and [Facebook](#)

"The contents and any attachments of this e-mail message are confidential and intended only for the named addressees. If you have received it in error, please advise the sender immediately by return email and then delete it from your system. Any unauthorised distribution, or copying of this transmission, or mis-use or wrongful disclosure of information contained in it, is strictly prohibited. Shepway District Council cannot accept liability for any statements made which are clearly the sender's own and not expressly made on behalf of the council."

From: Shore, Dave [<mailto:Dave.Shore@shepway.gov.uk>]
Sent: 04 August 2016 15:42
To: Jonathan Rodger
Cc: les.brown@mlm.uk.com; Jarrett, Andy; McGowan, Brendan; sue.rowlands@tibbalds.co.uk; claire.perrott@tibbalds.co.uk; adriana.bonilla@tibbalds.co.uk
Subject: Princes Parade

Jonathan

At the recent design team meeting it was said that you were trying to track down the definitive footpath map from KCC. Have you managed to get hold of this? The extract below I have taken from our own GIS which might be of use. The route shown in blue to the north of the Canal is denoted as public footpath HB56. The green route to the north of the canal is public bridleway HB65. The green route to the south of the canal is public bridleway HB83. The bridges crossing the canal/site are shown as part of the road network. The western one is College Bridge (U15302) and the eastern one (U15303).

Dave

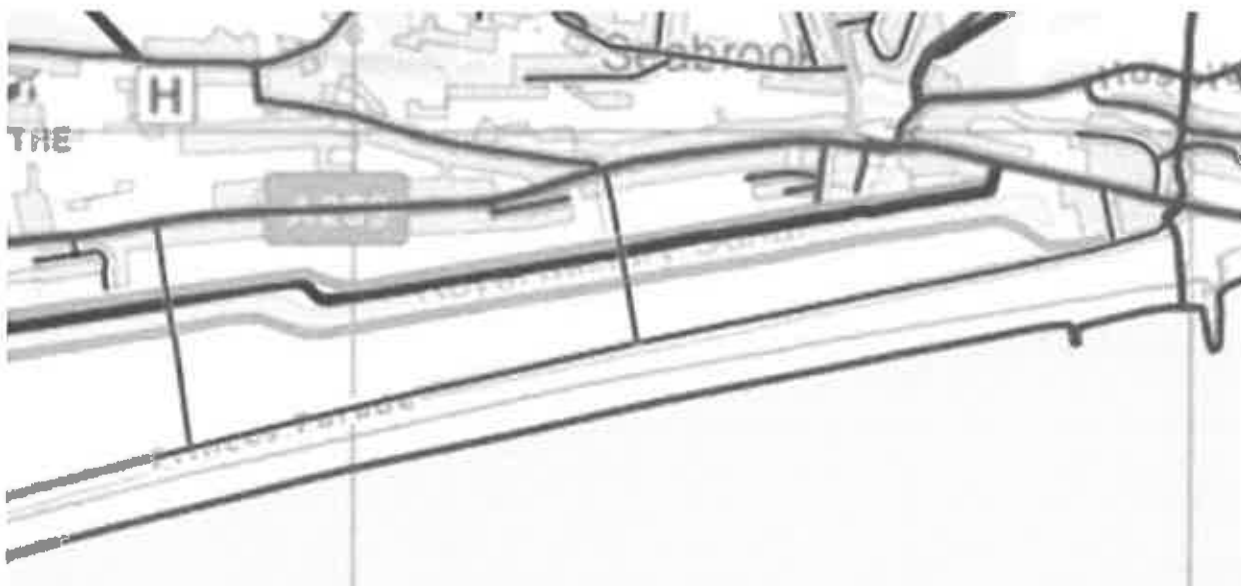

David Shore

Strategic Development Projects Manager

t: 01303 853459

m: 07976 958486

f: 01303 853502

Shepway District Council, Civic Centre,

Castle Hill Avenue, Folkestone, Kent, CT20 2QY.

E: dave.shore@shepway.gov.uk

www.shepway.gov.uk

Follow us on [Twitter](#) and [Facebook](#)

"The contents and any attachments of this e-mail message are confidential and intended only for the named addressees. If you have received it in error, please advise the sender immediately by return email and then delete it from your system. Any unauthorised distribution, or copying of this transmission, or mis-use or wrongful disclosure of information contained in it, is strictly prohibited. Shepway District Council cannot accept liability for any statements made which are clearly the sender's own and not expressly made on behalf of the council."



The contents and any attachments of this e-mail message are confidential and intended only for the named addressees. If you have received it in error, please advise the sender immediately by return email and then delete it from your system. Any unauthorised distribution or copying of this transmission, or misuse or wrongful disclosure of information contained in it, is strictly prohibited. Shepway District Council cannot accept liability for any statements made which are clearly the sender's own and not expressly made on behalf of the council. All email to and from the council may be monitored in accordance with the council's policies.



The contents and any attachments of this e-mail message are confidential and intended only for the named addressees. If you have received it in error, please advise the sender immediately by return email and then delete it from your system. Any unauthorised distribution or copying of this transmission, or misuse or wrongful disclosure of information contained in it, is strictly prohibited. Shepway District Council cannot accept liability for any statements made which are clearly the sender's own and not expressly made on behalf of the council. All email to and from the council may be monitored in accordance with the council's policies.

Wignall, Peter

From: Shore, Dave [Dave.Shore@shepway.gov.uk]
Sent: 13 December 2016 14:59
To: 'Paul Whatley'
Subject: RE: Princes Parade: PRow Refs...
Attachments: image001.jpg

Paul

Yes that's fine.

Dave

David Shore

Strategic Development Projects Manager

t: 01303 853459

m: 07976 958486

f: 01303 853502

Shepway District Council, Civic Centre,

Castle Hill Avenue, Folkestone, Kent, CT20 2QY.

E: dave.shore@shepway.gov.uk

www.shepway.gov.uk

Follow us on [Twitter](#) and [Facebook](#)

"The contents and any attachments of this e-mail message are confidential and intended only for the named addressees. If you have received it in error, please advise the sender immediately by return email and then delete it from your system. Any unauthorised distribution, or copying of this transmission, or mis-use or wrongful disclosure of information contained in it, is strictly prohibited. Shepway District Council cannot accept liability for any statements made which are clearly the sender's own and not expressly made on behalf of the council."

From: Paul Whatley [mailto:paul.whatley@lloydbore.co.uk]
Sent: 13 December 2016 14:58
To: Shore, Dave
Subject: RE: Princes Parade: PRow Refs...

REFERENCE EML-OUT/3609/20161213-145634-725

Thank you David,

I will have a look again at what we have/haven't got in terms of PRow Ref.Nos.

It might be possible for me to highlight a few queries on a plan and send it over to check on your internal mapping system. Would that be ok?

Paul

Paul Whatley BA (Hons) CMLi
Associate Director / Landscape Architect



Lloyd Bore Ltd. 20 YEARS 1996 – 2016.
33 St. George's Place, Canterbury, Kent CT1 1UT | T: 01227 464 340
59 Lambeth Walk, London, SE11 6DX | T: 02075 822 363
www.lloydbore.co.uk | E: paul.whatley@lloydbore.co.uk | M: 07471 036 660

We are fully committed to improving the quality of the work and services we provide. We welcome your feedback, and would be grateful if you could complete our [Customer Feedback Questionnaire](#).

[Follow Us on Twitter!](#)



From: Dave.Shore@shepway.gov.uk [<mailto:Dave.Shore@shepway.gov.uk>]
Sent: 13 December 2016 14:20
To: Paul Whatley <paul.whatley@lloydbore.co.uk>
Subject: RE: Princes Parade: PROW Refs...

Paul

The link below suggests that the definitive map is available to view at Invicta House. Copies also at a number of local libraries but these may not be as up to date.

<http://www.kent.gov.uk/waste-planning-and-land/public-rights-of-way/rights-of-way-map#tab-1>

Alternatively we do have PROW information (including reference numbers) on our own internal mapping system. We could get the information off of there but again perhaps not as accurate as that held by KCC. Does this help?

Dave

David Shore

Strategic Development Projects Manager

t: 01303 853459

m: 07976 958486

f: 01303 853502

Shepway District Council, Civic Centre,
Castle Hill Avenue, Folkestone, Kent, CT20 2QY.

E: dave.shore@shepway.gov.uk

www.shepway.gov.uk

Follow us on [Twitter](#) and [Facebook](#)

"The contents and any attachments of this e-mail message are confidential and intended only for the named addressees. If you have received it in error, please advise the sender immediately by return email and then delete it from your system. Any unauthorised distribution, or copying of this transmission, or mis-use or wrongful disclosure of information contained in it, is strictly prohibited. Shepway District Council cannot accept liability for any statements made which are clearly the sender's own and not expressly made on behalf of the council."

From: Paul Whatley [<mailto:paul.whatley@lloydbore.co.uk>]

Sent: 13 December 2016 13:15

To: Shore, Dave

Subject: Princes Parade: PRoW Refs...

REFERENCE EML-OUT/3609/20161213-131149-501

Hi David,

We need the footpath references for a much wider area please, as per the preliminary baseline map in our Landscape Appendix 1 (uploaded on Box.com).

Kent Interactive Website provides some of these, but there are problems with the website where you cannot easily identify some of the Ref No.s which are in close proximity to one another.

Does Shepway keep these on file somewhere, perhaps at a local library?

Or alternatively could we supply a map to one of your colleagues to mark up for us?

The details would be helpful as soon as possible as we move into the stage of typing everything up and try to avoid any stray or incorrect references as we move through the document to completion.

I will review the letter asap and get back to you.

Paul

Paul Whatley BA (Hons) CMLI

Associate Director / Landscape Architect



Lloyd Bore Ltd. 20 YEARS 1996 – 2016.

33 St. George's Place, Canterbury, Kent CT1 1UT | T: 01227 464 340

59 Lambeth Walk, London, SE11 6DX | T: 02075 822 363

We are fully committed to improving the quality of the work and services we provide. We welcome your feedback, and would be grateful if you could complete our [Customer Feedback Questionnaire](#).

[Follow Us on Twitter](#)



From: Dave.Shore@shepway.gov.uk [<mailto:Dave.Shore@shepway.gov.uk>]

Sent: 13 December 2016 10:47

To: Paul Whatley <paul.whatley@lloydbore.co.uk>

Cc: Andy.Jarrett@shepway.gov.uk

Subject: FW: Princes Parade

Paul

Further to your e-mail yesterday see below an e-mail I sent to our transport consultants MLM regarding the local footpath/bridleway network. Is this sufficient or would you like me to do some further investigation?

I also attach a draft letter for Martello No.8. Grateful for your thoughts.

Dave

David Shore

Strategic Development Projects Manager

t: 01303 853459

m: 07976 958486

f: 01303 853502

Shepway District Council, Civic Centre,

Castle Hill Avenue, Folkestone, Kent, CT20 2QY.

E: dave.shore@shepway.gov.uk

www.shepway.gov.uk

Follow us on [Twitter](#) and [Facebook](#)

"The contents and any attachments of this e-mail message are confidential and intended only for the named addressees. If you have received it in error, please advise the sender immediately by return email and then delete it from your system. Any unauthorised distribution, or copying of this transmission, or mis-use or wrongful disclosure of information contained in it, is strictly prohibited. Shepway District Council cannot accept liability for any statements made which are clearly the sender's own and not expressly made on behalf of the council."

From: Shore, Dave [<mailto:Dave.Shore@shepway.gov.uk>]
Sent: 04 August 2016 15:42
To: Jonathan Rodger
Cc: les.brown@mlm.uk.com; Jarrett, Andy; McGowan, Brendan; sue.rowlands@tbbalds.co.uk; claire.perrott@tbbalds.co.uk; adriana.bonilla@tbbalds.co.uk
Subject: Princes Parade

Jonathan

At the recent design team meeting it was said that you were trying to track down the definitive footpath map from KCC. Have you managed to get hold of this? The extract below I have taken from our own GIS which might be of use. The route shown in blue to the north of the Canal is denoted as public footpath HB56. The green route to the north of the canal is public bridleway HB65. The green route to the south of the canal is public bridleway HB83. The bridges crossing the canal/site are shown as part of the road network. The western one is College Bridge (U15302) and the eastern one (U15303).

Dave

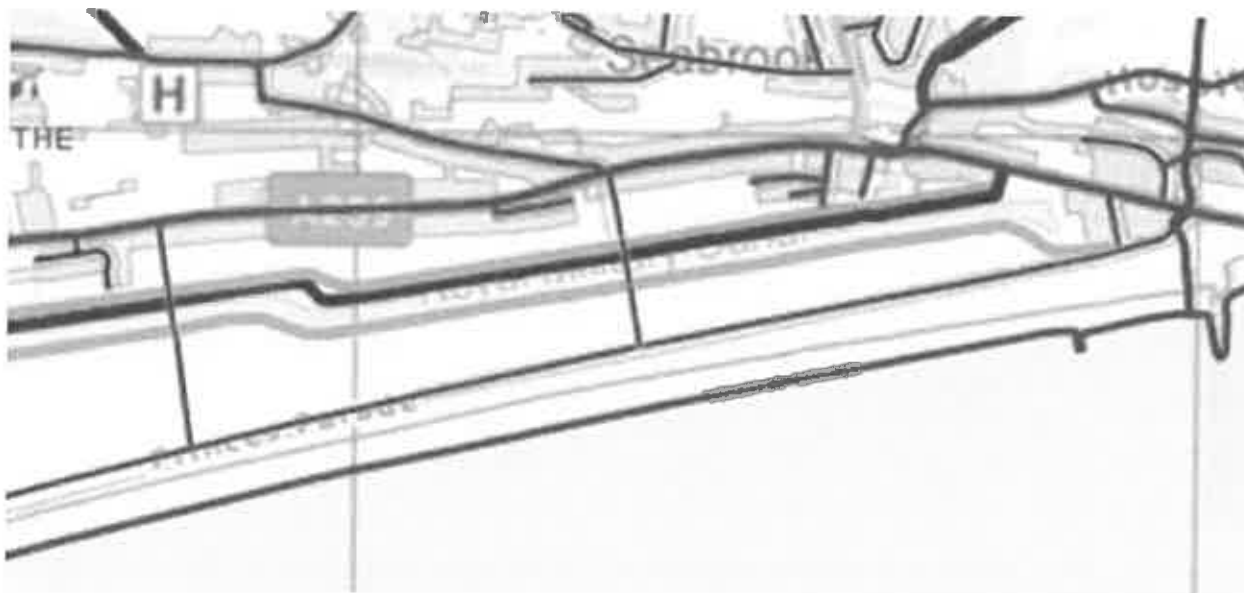

David Shore

Strategic Development Projects Manager

t: 01303 853459

m: 07976 958486

f: 01303 853502

Shepway District Council, Civic Centre,

Castle Hill Avenue, Folkestone, Kent, CT20 2QY.

E: dave.shore@shepway.gov.uk

www.shepway.gov.uk

Follow us on [Twitter](#) and [Facebook](#)

"The contents and any attachments of this e-mail message are confidential and intended only for the named addressees. If you have received it in error, please advise the sender immediately by return email and then delete it from your system. Any unauthorised distribution, or copying of this transmission, or mis-use or wrongful disclosure of information contained in it, is strictly prohibited. Shepway District Council cannot accept liability for any statements made which are clearly the sender's own and not expressly made on behalf of the council."



The contents and any attachments of this e-mail message are confidential and intended only for the named addressees. If you have received it in error, please advise the sender immediately by return email and then delete it from your system. Any unauthorised distribution or copying of this transmission, or misuse or wrongful disclosure of information contained in it, is strictly prohibited. Shepway District Council cannot accept liability for any statements made which are clearly the sender's own and not expressly made on behalf of the council. All email to and from the council may be monitored in accordance with the council's policies.



The contents and any attachments of this e-mail message are confidential and intended only for the named addressees. If you have received it in error, please advise the sender immediately by return email and then delete it from your system. Any unauthorised distribution or copying of this transmission, or misuse or wrongful disclosure of information contained in it, is strictly prohibited. Shepway District Council cannot accept liability for any statements made which are clearly the sender's own and not expressly made on behalf of the council. All email to and from the council may be monitored in accordance with the council's policies.

Our Ref: Princes Parade LVIA
Tel: 01303 853459
Fax: 01303 853502
E-mail: dave.shore@shepway.gov.uk
Date: 13th December 2016



The Occupiers
Martello Tower No.8
Upper Corniche
Sandgate
Folkestone
Kent
CT20 3TB

Dear Sir/Madam

Re – Proposed Development at Princes Parade, Seabrook, Hythe

Shepway District Council is in the process of preparing an application for planning permission for the redevelopment of land in its ownership at Princes Parade, Seabrook, Hythe.

The application will be supported by an Environmental Statement that will include a landscape and visual impact assessment (LVIA) that will assess the significant effects of the proposed development in terms of visual impact. As part of the process of preparing the LVIA it will be necessary to assess the effects of the scheme from a number of viewpoints, including the taking of number of photographs that will be included in the final documentation. The LVIA will be used by the District Council in the determination of the planning application, alongside a range of other material.

It has been agreed, following discussion with Shepway District Council's Planning Department and Historic England, that the LVIA would benefit from a visual assessment from the upper storey of Martello Tower No.8 and that this should therefore be one of the viewpoints. The District Council has appointed Lloyd Bore Ltd to undertake the LVIA and it would be much appreciated if you are able to grant them access to your property in order to allow this viewpoint to be included.

A representative of Lloyd Bore Ltd is available to take a photograph (weather permitting), on the following days:

- Monday 19th Dec.
- Tuesday 20th Dec
- Monday 9th Jan
- Tuesday 10th Jan
- Friday 13th Jan.

I would be grateful if you could indicate whether you are willing and able to offer access between 9am on 1pm on any of those dates by contacting me on either 01303 853459 or dave.shore@shepway.gov.uk.

Shepway District Council
Civic Centre, Castle Hill Avenue, Folkestone, Kent, CT20 2QY
Telephone: (Switchboard) 01303 853000
E-mail: sdc@shepway.gov.uk
DX 4912 Folkestone

Please do not hesitate to contact me if you require any further clarification.

Yours sincerely,

**David Shore
Strategic Development Projects Manager**

Wignall, Peter

From: Shore, Dave [Dave.Shore@shepway.gov.uk]
Sent: 15 December 2016 09:39
To: 'Paul Whatley'
Cc: Jarrett, Andy; Chris Beech
Subject: RE: Princes Parade: Martello Tower No.8 Photo...
Attachments: Martello 8 letter.docx

Paul

The attached has now been sent. I will let you know of any response.

Dave

David Shore

Strategic Development Projects Manager

t: 01303 853459

m: 07976 958486

f: 01303 853502

Shepway District Council, Civic Centre,

Castle Hill Avenue, Folkestone, Kent, CT20 2QY.

E: dave.shore@shepway.gov.uk

www.shepway.gov.uk

Follow us on [Twitter](#) and [Facebook](#)

"The contents and any attachments of this e-mail message are confidential and intended only for the named addressees. If you have received it in error, please advise the sender immediately by return email and then delete it from your system. Any unauthorised distribution, or copying of this transmission, or mis-use or wrongful disclosure of information contained in it, is strictly prohibited. Shepway District Council cannot accept liability for any statements made which are clearly the sender's own and not expressly made on behalf of the council."

From: Paul Whatley [mailto:paul.whatley@lloydbore.co.uk]
Sent: 13 December 2016 14:50
To: Shore, Dave
Cc: Jarrett, Andy; Chris Beech
Subject: Princes Parade: Martello Tower No.8 Photo...

REFERENCE EML-OUT/3609/20161213-144023-064

David,

Thank you drafting this letter to try to gain access to Martello Tower No. 8.

My colleague Chris Beech has confirmed his availability to take a photo (weather permitting), on the following days:

- Monday 19th Dec.
- Tuesday 20th Dec
- Monday 9th Jan
- Tuesday 10th Jan
- Friday 13th Jan.

Due to the aspect of the view, generally facing west, the best time to take the photo would probably be during the morning – although this is completely dependent on weather and lighting on the day.

We would offer the residents to provide their preferred time for us to come on the chosen day between 9am-1pm (as a starting point). However, it would be our intention to come at the earliest possible time so they are not waiting around for us.

Our aim is for Chris to access the top floor of the tower in order to take a photos as quickly as possible. I think he would only need 5-10mins (max).

Could the above be added to the letter if possible please and posted to them on Shepway Head Note Paper?

I wonder if the best way is to offer them the opportunity to phone or email you to confirm their preferred date/time.

All being well they would reply soon and we can get the photo taken at one of the earlier dates above.

Many thanks,

Paul

Paul Whatley BA (Hons) CMLI
Associate Director / Landscape Architect



Lloyd Bore Ltd. 20 YEARS 1996 – 2016.
33 St. George's Place, Canterbury, Kent CT1 1UT | T: 01227 484 340
59 Lambeth Walk, London, SE11 6DX | T: 02075 822 383
www.lloydbore.co.uk | E: paul.whatley@lloydbore.co.uk | M: 07471 036 660

We are fully committed to improving the quality of the work and services we provide. We welcome your feedback, and would be grateful if you could complete our [Customer Feedback Questionnaire](#).

[Follow Us on Twitter](#)



From: Dave.Shore@shepway.gov.uk [<mailto:Dave.Shore@shepway.gov.uk>]
Sent: 13 December 2016 10:47
To: Paul Whatley <paul.whatley@lloydbore.co.uk>

Cc: Andy.Jarrett@shepway.gov.uk

Subject: FW: Princes Parade

Paul

Further to your e-mail yesterday see below an e-mail I sent to our transport consultants MLM regarding the local footpath/bridleway network. Is this sufficient or would you like me to do some further investigation?

I also attach a draft letter for Martello No.8. Grateful for your thoughts.

Dave

David Shore

Strategic Development Projects Manager

t: 01303 853459

m: 07976 958486

f: 01303 853502

Shepway District Council, Civic Centre,

Castle Hill Avenue, Folkestone, Kent, CT20 2QY.

E: dave.shore@shepway.gov.uk

www.shepway.gov.uk

Follow us on [Twitter](#) and [Facebook](#)

"The contents and any attachments of this e-mail message are confidential and intended only for the named addressees. If you have received it in error, please advise the sender immediately by return email and then delete it from your system. Any unauthorised distribution, or copying of this transmission, or mis-use or wrongful disclosure of information contained in it, is strictly prohibited. Shepway District Council cannot accept liability for any statements made which are clearly the sender's own and not expressly made on behalf of the council."

From: Shore, Dave [<mailto:Dave.Shore@shepway.gov.uk>]

Sent: 04 August 2016 15:42

To: Jonathan Rodger

Cc: les.brown@mlm.uk.com; Jarrett, Andy; McGowan, Brendan; sue.rowlands@tibbalds.co.uk;

claire.perrott@tibbalds.co.uk; adriana.bonilla@tibbalds.co.uk

Subject: Princes Parade

Jonathan

At the recent design team meeting it was said that you were trying to track down the definitive footpath map from KCC. Have you managed to get hold of this? The extract below I have taken from our own GIS which might be of use. The route shown in blue to the north of the Canal is denoted as public footpath HB56. The green route to the north of the canal is public bridleway

HB65. The green route to the south of the canal is public bridleway HB83. The bridges crossing the canal/site are shown as part of the road network. The western one is College Bridge (U15302) and the eastern one (U15303).

Dave

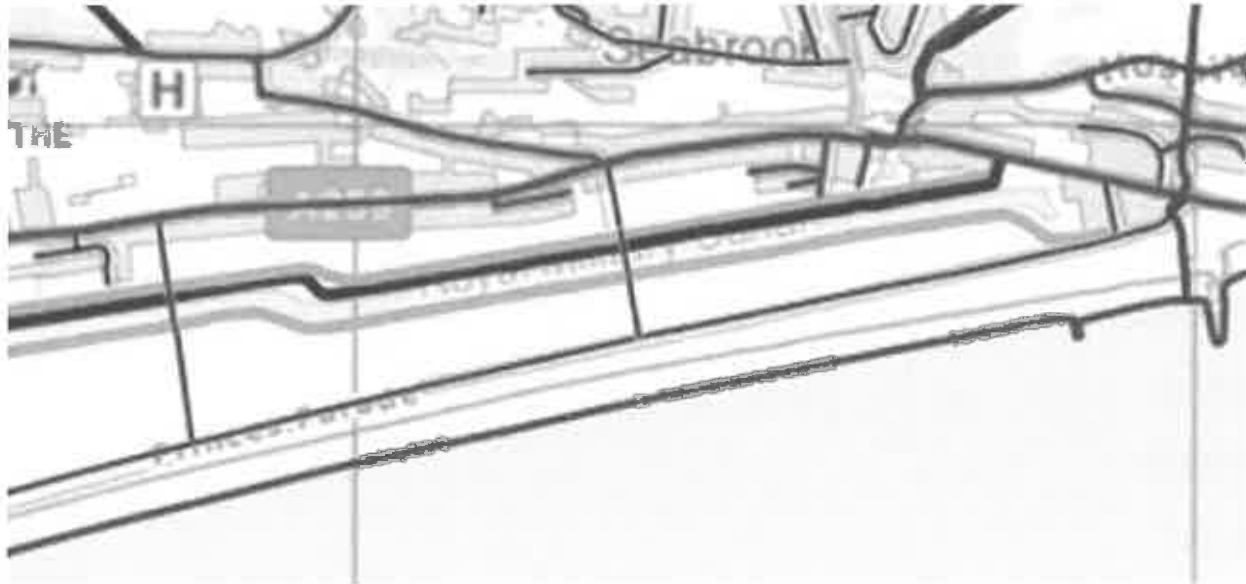

David Shore

Strategic Development Projects Manager

t: 01303 853459

m: 07976 958486

f: 01303 853502

Shepway District Council, Civic Centre,

Castle Hill Avenue, Folkestone, Kent, CT20 2QY.

E: dave.shore@shepway.gov.uk

www.shepway.gov.uk

Follow us on [Twitter](#) and [Facebook](#)

"The contents and any attachments of this e-mail message are confidential and intended only for the named addressees. If you have received it in error, please advise the sender immediately by return email and then delete it from your system. Any unauthorised distribution, or copying of this transmission, or mis-use or wrongful disclosure of information contained in it, is strictly prohibited.

Shepway District Council cannot accept liability for any statements made which are clearly the sender's own and not expressly made on behalf of the council."



The contents and any attachments of this e-mail message are confidential and intended only for the named addressees. If you have received it in error, please advise the sender immediately by return email and then delete it from your system. Any unauthorised distribution or copying of this transmission, or misuse or wrongful disclosure of information contained in it, is strictly prohibited. Shepway District Council cannot accept liability for any statements made which are clearly the sender's own and not expressly made on behalf of the council. All email to and from the council may be monitored in accordance with the council's policies.

Wignall, Peter

From: Paul Whatley [paul.whatley@lloydbore.co.uk]
Sent: 15 December 2016 11:38
To: dave.shore@shepway.gov.uk
Subject: RE: Princes Parade: Martello Tower No.8 Photo...
Attachments: Martello 8 letter.docx

Thank you David,

I think this approach gives us and the residents maximum flexibility.

Paul

Get [Outlook for Android](#)

On Thu, Dec 15, 2016 at 9:38 AM +0000, "Dave.Shore@shepway.gov.uk"
<Dave.Shore@shepway.gov.uk> wrote:

Paul

The attached has now been sent. I will let you know of any response.

Dave

David Shore
Strategic Development Projects Manager
t: 01303 853459
m: 07976 958486
f: 01303 853502
Shepway District Council, Civic Centre,
Castle Hill Avenue, Folkestone, Kent, CT20 2QY.
E: dave.shore@shepway.gov.uk
www.shepway.gov.uk
Follow us on [Twitter](#) and [Facebook](#)

"The contents and any attachments of this e-mail message are confidential and intended only for the named addressees. If you have received it in error, please advise the sender immediately by return email and then delete it from your system. Any unauthorised distribution, or copying of this transmission, or mis-use or wrongful disclosure of information contained in it, is strictly prohibited. Shepway District Council cannot accept liability for any statements made which are clearly the sender's own and not expressly made on behalf of the council."

From: Paul Whatley [mailto:paul.whatley@lloydbore.co.uk]
Sent: 13 December 2016 14:50
To: Shore, Dave
Cc: Jarrett, Andy; Chris Beech
Subject: Princes Parade: Martello Tower No.8 Photo...

David,

Thank you drafting this letter to try to gain access to Martello Tower No. 8.

My colleague Chris Beech has confirmed his availability to take a photo (weather permitting), on the following days:

- Monday 19th Dec.
- Tuesday 20th Dec
- Monday 9th Jan
- Tuesday 10th Jan
- Friday 13th Jan.

Due to the aspect of the view, generally facing west, the best time to take the photo would probably be during the morning – although this is completely dependent on weather and lighting on the day.

We would offer the residents to provide their preferred time for us to come on the chosen day between 9am-1pm (as a starting point). However, it would be our intention to come at the earliest possible time so they are not waiting around for us.

Our aim is for Chris to access the top floor of the tower in order to take a photos as quickly as possible. I think he would only need 5-10mins (max).

Could the above be added to the letter if possible please and posted to them on Shepway Head Note Paper?

I wonder if the best way is to offer them the opportunity to phone or email you to confirm their preferred date/time.

All being well they would reply soon and we can get the photo taken at one of the earlier dates above.

Many thanks,

Paul

Paul Whatley BA (Hons) CMLI
Associate Director / Landscape Architect



Lloyd Bore Ltd. 20 YEARS 1996 – 2016.

33 St. George's Place, Canterbury, Kent CT1 1UT | T: 01227 464 340

59 Lambeth Walk, London, SE11 6DX | T: 02075 822 363

www.lloydbore.co.uk | E: paul.whatley@lloydbore.co.uk | M: 07471 036 660

We are fully committed to improving the quality of the work and services we provide. We welcome your feedback, and would be grateful if you could complete our [Customer Feedback Questionnaire](#).

[Follow Us on Twitter!](#)



From: Dave.Shore@shepway.gov.uk [<mailto:Dave.Shore@shepway.gov.uk>]

Sent: 13 December 2016 10:47

To: Paul Whatley <paul.whatley@lloydbore.co.uk>

Cc: Andy.Jarrett@shepway.gov.uk

Subject: FW: Princes Parade

Paul

Further to your e-mail yesterday see below an e-mail I sent to our transport consultants MLM regarding the local footpath/bridleway network. Is this sufficient or would you like me to do some further investigation?

I also attach a draft letter for Martello No.8. Grateful for your thoughts.

Dave

David Shore

Strategic Development Projects Manager

t: 01303 853459

m: 07976 958486

f: 01303 853502

Shepway District Council, Civic Centre,

Castle Hill Avenue, Folkestone, Kent, CT20 2QY.

E: dave.shore@shepway.gov.uk

www.shepway.gov.uk

Follow us on [Twitter](#) and [Facebook](#)

"The contents and any attachments of this e-mail message are confidential and intended only for the named addressees. If you have received it in error, please advise the sender immediately by return email and then delete it from your system. Any unauthorised distribution, or copying of this transmission, or mis-use or wrongful disclosure of information contained in it, is strictly prohibited. Shepway District Council cannot accept liability for any statements made which are clearly the sender's own and not expressly made on behalf of the council."

From: Shore, Dave [<mailto:Dave.Shore@shepway.gov.uk>]

Sent: 04 August 2016 15:42

To: Jonathan Rodger

Cc: les.brown@mlm.uk.com; Jarrett, Andy; McGowan, Brendan; sue.rowlands@tibbonalds.co.uk;

claire.perrott@tibbonalds.co.uk; adriana.bonilla@tibbonalds.co.uk

Subject: Princes Parade

Jonathan

At the recent design team meeting it was said that you were trying to track down the definitive footpath map from KCC. Have you managed to get hold of this? The extract below I have taken from our own GIS which might be of use. The route shown in blue to the north of the Canal is denoted as public footpath HB56. The green route to the north of the canal is public bridleway HB65. The green route to the south of the canal is public bridleway HB83. The bridges crossing the canal/site are shown as part of the road network. The western one is College Bridge (U15302) and the eastern one (U15303).

Dave

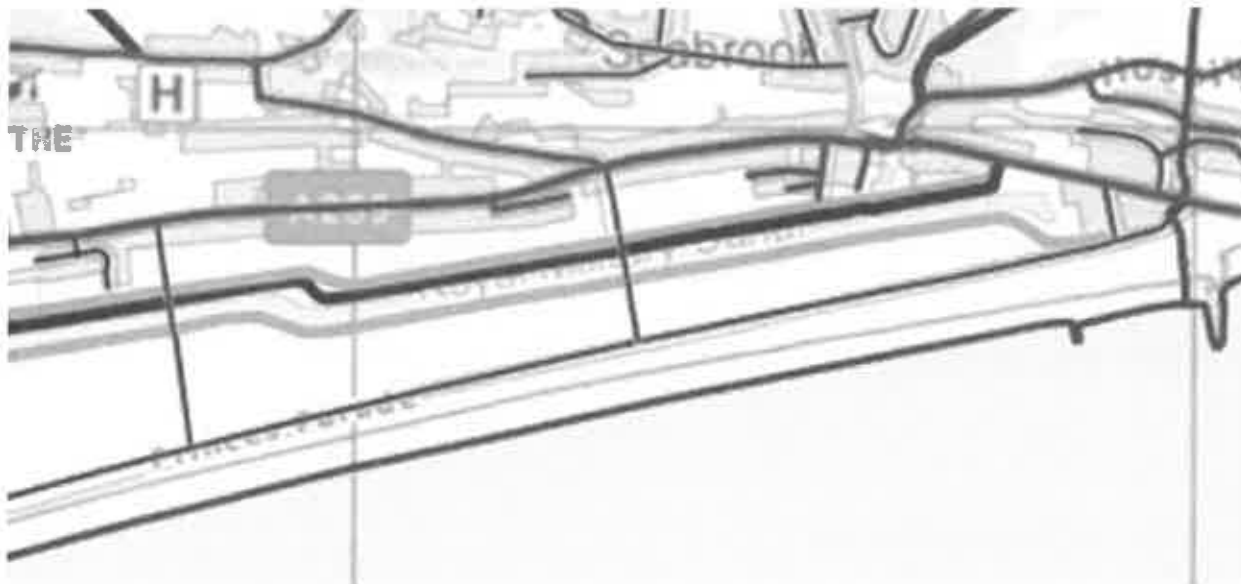

David Shore
Strategic Development Projects Manager
t: 01303 853459
m: 07976 958486
f: 01303 853502
Shepway District Council, Civic Centre,
Castle Hill Avenue, Folkestone, Kent, CT20 2QY.
E: dave.shore@shepway.gov.uk
www.shepway.gov.uk
Follow us on [Twitter](#) and [Facebook](#)

"The contents and any attachments of this e-mail message are confidential and intended only for the named addressees. If you have received it in error, please advise the sender immediately by return email and then delete it from your system. Any unauthorised distribution, or copying of this transmission, or mis-use or wrongful disclosure of information contained in it, is strictly prohibited. Shepway District Council cannot accept liability for any statements made which are clearly the sender's own and not expressly made on behalf of the council."



The contents and any attachments of this e-mail message are confidential and intended only for the named addressees. If you have received it in error, please advise the sender immediately by return email and then delete it from your system. Any unauthorised distribution or copying of this transmission, or misuse or wrongful disclosure of information contained in it, is strictly prohibited. Shepway District Council cannot accept liability for any statements made which are clearly the sender's own and not expressly made on behalf of the council. All email to and from the council may be monitored in accordance with the council's policies.



The contents and any attachments of this e-mail message are confidential and intended only for the named addressees. If you have received it in error, please advise the sender immediately by return email and then delete it from your system. Any unauthorised distribution or copying of this transmission, or misuse or wrongful disclosure of information contained in it, is strictly prohibited. Shepway District Council cannot accept liability for any statements made which are clearly the sender's own and not expressly made on behalf of the council.

All email to and from the council may be monitored in accordance with the council's policies.

Paul

The attached has now been sent. I will let you know of any response.

Dave

David Shore

Strategic Development Projects Manager

t: 01303 853459

m: 07976 958486

f: 01303 853502

Shepway District Council, Civic Centre,
Castle Hill Avenue, Folkestone, Kent, CT20 2QY.

E: dave.shore@shepway.gov.uk

www.shepway.gov.uk

Follow us on [Twitter](#) and [Facebook](#)

"The contents and any attachments of this e-mail message are confidential and intended only for the named addressees. If you have received it in error, please advise the sender immediately by return email and then delete it from your system. Any unauthorised distribution, or copying of this transmission, or mis-use or wrongful disclosure of information contained in it, is strictly prohibited. Shepway District Council cannot accept liability for any statements made which are clearly the sender's own and not expressly made on behalf of the council."

From: Paul Whatley [<mailto:paul.whatley@lloydbore.co.uk>]

Sent: 13 December 2016 14:50

To: Shore, Dave

Cc: Jarrett, Andy; Chris Beech

Subject: Princes Parade: Martello Tower No.8 Photo...

REFERENCE EML-OUT/3609/20161213-144023-064

David,

Thank you drafting this letter to try to gain access to Martello Tower No. 8.

My colleague Chris Beech has confirmed his availability to take a photo (weather permitting), on the following days:

- Monday 19th Dec.
- Tuesday 20th Dec
- Monday 9th Jan
- Tuesday 10th Jan
- Friday 13th Jan.

Due to the aspect of the view, generally facing west, the best time to take the photo would probably be during the morning – although this is completely dependent on weather and lighting on the day.

We would offer the residents to provide their preferred time for us to come on the chosen day between 9am-1pm (as a starting point). However, it would be our intention to come at the earliest possible time so they are not \ waiting around for us.

Our aim is for Chris to access the top floor of the tower in order to take a photos as quickly as possible. I think he would only need 5-10mins (max).

Could the above be added to the letter if possible please and posted to them on Shepway Head Note Paper?

I wonder if the best way is to offer them the opportunity to phone or email you to confirm their preferred date/time.

All being well they would reply soon and we can get the photo taken at one of the earlier dates above.

Many thanks,

Paul

Paul Whatley BA (Hons) CMLI
Associate Director / Landscape Architect



Lloyd Bore Ltd. 20 YEARS 1996 – 2016.

33 St. George's Place, Canterbury, Kent CT1 1UT | T: 01227 484 340

59 Lambeth Walk, London, SE11 6DX | T: 02075 822 363

www.lloydbore.co.uk | E: paul.whatley@lloydbore.co.uk | M: 07471 036 660

We are fully committed to improving the quality of the work and services we provide. We welcome your feedback, and would be grateful if you could complete our [Customer Feedback Questionnaire](#).

[Follow Us on Twitter!](#)



From: Dave.Shore@shepway.gov.uk [<mailto:Dave.Shore@shepway.gov.uk>]

Sent: 13 December 2016 10:47

To: Paul Whatley <paul.whatley@lloydbore.co.uk>

Cc: Andy.Jarrett@shepway.gov.uk

Subject: FW: Princes Parade

Paul

Further to your e-mail yesterday see below an e-mail I sent to our transport consultants MLM regarding the local footpath/bridleway network. Is this sufficient or would you like me to do some further investigation?

I also attach a draft letter for Martello No.8. Grateful for your thoughts.

Dave

David Shore

Strategic Development Projects Manager

t: 01303 853459

m: 07976 958486

f: 01303 853502

Shepway District Council, Civic Centre,
Castle Hill Avenue, Folkestone, Kent, CT20 2QY.

E: dave.shore@shepway.gov.uk

www.shepway.gov.uk

Follow us on [Twitter](#) and [Facebook](#)

"The contents and any attachments of this e-mail message are confidential and intended only for the named addressees. If you have received it in error, please advise the sender immediately by return email and then delete it from your system. Any unauthorised distribution, or copying of this transmission, or mis-use or wrongful disclosure of information contained in it, is strictly prohibited. Shepway District Council cannot accept liability for any statements made which are clearly the sender's own and not expressly made on behalf of the council."

From: Shore, Dave [<mailto:Dave.Shore@shepway.gov.uk>]

Sent: 04 August 2016 15:42

To: Jonathan Rodger

Cc: les.brown@mlm.uk.com; Jarrett, Andy; McGowan, Brendan; sue.rowlands@tibbalds.co.uk;

claire.perrott@tibbalds.co.uk; adriana.bonilla@tibbalds.co.uk

Subject: Princes Parade

Jonathan

At the recent design team meeting it was said that you were trying to track down the definitive footpath map from KCC. Have you managed to get hold of this? The extract below I have taken from our own GIS which might be of use. The route shown in blue to the north of the Canal is denoted as public footpath HB56. The green route to the north of the canal is public bridleway HB65. The green route to the south of the canal is public bridleway HB83. The bridges crossing the canal/site are shown as part of the road network. The western one is College Bridge (U15302) and the eastern one (U15303).

Dave

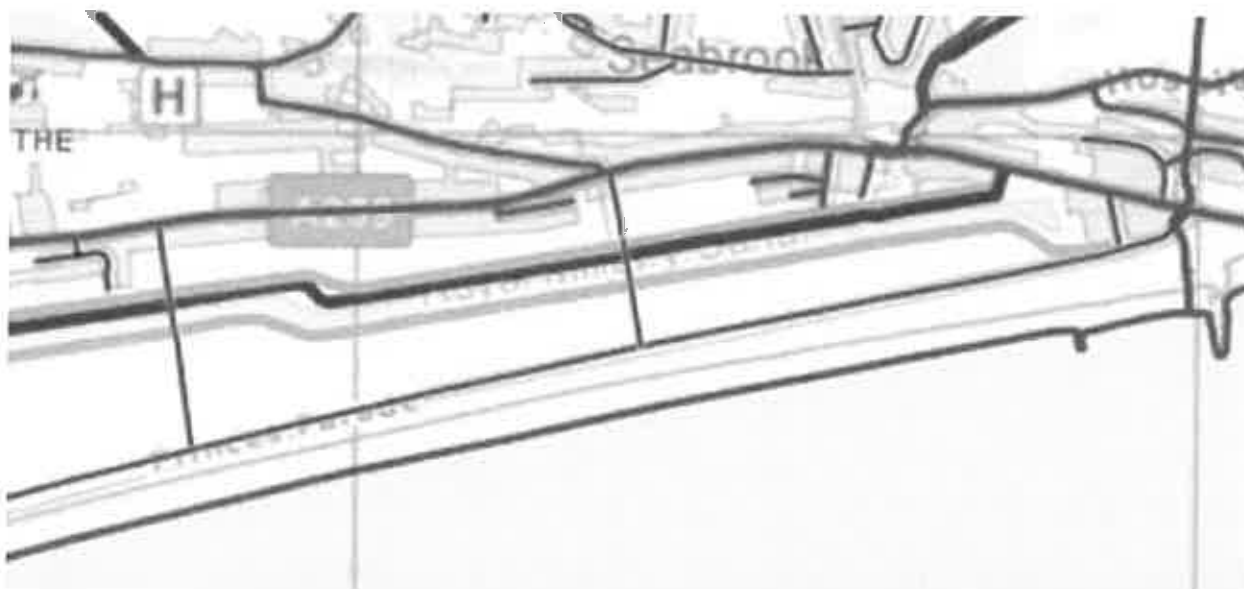

David Shore
Strategic Development Projects Manager
t: 01303 853459
m: 07976 958486
f: 01303 853502
Shepway District Council, Civic Centre,
Castle Hill Avenue, Folkestone, Kent, CT20 2QY.
E: dave.shore@shepway.gov.uk
www.shepway.gov.uk
Follow us on [Twitter](#) and [Facebook](#)

"The contents and any attachments of this e-mail message are confidential and intended only for the named addressees. If you have received it in error, please advise the sender immediately by return email and then delete it from your system. Any unauthorised distribution, or copying of this transmission, or mis-use or wrongful disclosure of information contained in it, is strictly prohibited. Shepway District Council cannot accept liability for any statements made which are clearly the sender's own and not expressly made on behalf of the council."



The contents and any attachments of this e-mail message are confidential and intended only for the named addressees. If you have received it in error, please advise the sender immediately by return email and then delete it from your system. Any unauthorised distribution or copying of this transmission, or misuse or wrongful disclosure of information contained in it, is strictly prohibited. Shepway District Council cannot accept liability for any statements made which are clearly the sender's own and not expressly made on behalf of the council.
All email to and from the council may be monitored in accordance with the council's policies.



The contents and any attachments of this e-mail message are confidential and intended only for the named addressees. If you have received it in error, please advise the sender immediately by return email and then delete it from your system. Any unauthorised distribution or copying of this transmission, or misuse or wrongful disclosure of information contained in it, is strictly prohibited. Shepway District Council cannot accept liability for any statements made which are clearly the sender's own and not expressly made on behalf of the council.
All email to and from the council may be monitored in accordance with the council's policies.

Wignall, Peter

From: Paul Whatley [paul.whatley@lloydbore.co.uk]
Sent: 16 December 2016 10:43
To: ctsiasioti@gt3architects.com; martin@mjmckay.wanadoo.co.uk; firbank@callnetuk.com; andy.jarrett@shepway.gov.uk; Dave.Shore@shepway.gov.uk; sue.rowlands@tibbalds.co.uk; matt.shillito@tibbalds.co.uk; claire.perrott@tibbalds.co.uk
Cc: Chris Beech
Subject: Princes Parade, Hythe: LVIA & HE Views uploaded...

REFERENCE EML-OUT/3609/DI/20161216-104020-409

Dear All,

Please note we have just uploaded the LVIA and HE Views to Box.com

The remaining view HE3 from residential Martello Tower No. 8 will be taken as soon as possible.

Do contact me or my colleague Chris Beech if you have any queries.

Best wishes,

Paul

--

Paul Whatley BA (Hons) CMLI
Associate Director / Landscape Architect



Lloyd Bore Ltd. 20 YEARS 1996 – 2016.
33 St. George's Place, Canterbury, Kent CT1 1UT | T: 01227 464 340
59 Lambeth Walk, London, SE11 8DX | T: 02075 822 363
www.lloydbore.co.uk | E: paul.whatley@lloydbore.co.uk | M: 07471 036 660

We are fully committed to improving the quality of the work and services we provide. We welcome your feedback, and would be grateful if you could complete our [Customer Feedback Questionnaire](#).

[Follow Us on Twitter](#)



Wignall, Peter

From: Samuel Durham [samuel.durham@lloydbore.co.uk]
Sent: 19 December 2016 15:44
To: firbank@callnetuk.com; matt.shillito@tibbonalds.co.uk; sue.rowlands@tibbonalds.co.uk
Cc: Dave.Shore@shepway.gov.uk; Andy.Jarrett@shepway.gov.uk; rglavin@merebrook.co.uk; Paul Whatley; martin@mjmckay.wanadoo.co.uk; simon.mb@herringtonconsulting.co.uk; ndellow@merebrook.co.uk; jonathan.rodger@mlm.uk.com
Subject: RE: Princes Parade EIA Guidance

REFERENCE EML-OUT/3609/Con/20161219-153800-662

Hi Peter,

Just a quick email to check that the EIA Guidance that you sent across on 20th September (see below email and its original attachments) is still current?

I will be starting the ecology chapter tomorrow so it would be good to have confirmation on this point today/tomorrow.

Matt/Sue,

Do we now have a final scheme?

Once we have a final scheme, I will be able to complete the ecology chapter.

Kind regards,

--

Samuel Durham BSc (Hons) ACIEEM
Senior Ecologist



Lloyd Bore Ltd. 20 YEARS 1996 – 2016.

33 St. George's Place, Canterbury, Kent CT1 1UT | T: 01227 464 340

59 Lambeth Walk, London, SE11 6DX | T: 02075 822 363

www.lloydbore.co.uk | E: samuel.durham@lloydbore.co.uk | M: 07471 036 663

We are fully committed to improving the quality of the work and services we provide. We welcome your feedback, and would be grateful if you could complete our [Customer Feedback Questionnaire](#).

[Follow Us on Twitter!](#)



From: firbank@callnetuk.com

Sent: 20/09/2016 17:36:53

To: martin@mjmckay.wanadoo.co.uk; samuel.durham@lloydbore.co.uk;
simon.mb@herringtonconsulting.co.uk; ndellow@merebrook.co.uk; julian.bore@lloydbore.co.uk;
jonathan.rodger@mlm.uk.com

Cc: matt.shillito@tibbonalds.co.uk; sue.rowlands@tibbonalds.co.uk; Dave.Shore@shepway.gov.uk;
Andy.Jarrett@shepway.gov.uk; rglavin@merebrook.co.uk
Subject: Princes Parade EIA Guidance

Dear All,

Please find attached a note providing guidance on ES structure and chapter format, together with a sample chapter. This should be self-explanatory, but don't hesitate to get back to me if you have any queries. Note that I have intentionally only circulated this to what I believe to be the EIA team, but feel free to pass it on to colleagues as necessary.

Regards,

Peter

Peter Radmall Associates
environmental planning and assessment
Firbank, Ashdown Road
Forest Row
East Sussex RH18 5BW
Tel: 01342 822278
E-mail: firbank@callnetuk.com

Wignall, Peter

From: Samuel Durham [samuel.durham@lloydbore.co.uk]
Sent: 19 December 2016 15:44
To: firbank@callnetuk.com; matt.shillito@tibbonalds.co.uk; sue.rowlands@tibbonalds.co.uk
Cc: Dave.Shore@shepway.gov.uk; Andy.Jarrett@shepway.gov.uk; rglavin@merebrook.co.uk; Paul Whatley; martin@mjmckay.wanadoo.co.uk; simon.mb@herringtonconsulting.co.uk; ndellow@merebrook.co.uk; jonathan.rodger@mlm.uk.com
Subject: RE: Princes Parade EIA Guidance

REFERENCE EML-OUT/3609/Con/20161219-153800-662

Hi Peter,

Just a quick email to check that the EIA Guidance that you sent across on 20th September (see below email and its original attachments) is still current?

I will be starting the ecology chapter tomorrow so it would be good to have confirmation on this point today/tomorrow.

Matt/Sue,

Do we now have a final scheme?

Once we have a final scheme, I will be able to complete the ecology chapter.

Kind regards,

Samuel Durham BSc (Hons) ACIEEM

Senior Ecologist



Lloyd Bore Ltd. 20 YEARS 1996 – 2016.

33 St. George's Place, Canterbury, Kent CT1 1UT | T: 01227 464 340

59 Lambeth Walk, London, SE11 6DX | T: 02075 822 363

www.lloydbore.co.uk | E: samuel.durham@lloydbore.co.uk | M: 07471 036 663

We are fully committed to improving the quality of the work and services we provide. We welcome your feedback, and would be grateful if you could complete our [Customer Feedback Questionnaire](#).

[Follow Us on Twitter](#)



From: firbank@callnetuk.com

Sent: 20/09/2016 17:36:53

To: martin@mjmckay.wanadoo.co.uk; samuel.durham@lloydbore.co.uk;
simon.mb@herringtonconsulting.co.uk; ndellow@merebrook.co.uk; julian.bore@lloydbore.co.uk;
jonathan.rodger@mlm.uk.com

Cc: matt.shillito@tibbalds.co.uk; sue.rowlands@tibbalds.co.uk; Dave.Shore@shepway.gov.uk;
Andy.Jarrett@shepway.gov.uk; rglavin@merebrook.co.uk
Subject: Princes Parade EIA Guidance

Dear All,

Please find attached a note providing guidance on ES structure and chapter format, together with a sample chapter. This should be self-explanatory, but don't hesitate to get back to me if you have any queries. Note that I have intentionally only circulated this to what I believe to be the EIA team, but feel free to pass it on to colleagues as necessary.

Regards,

Peter

Peter Radmall Associates
environmental planning and assessment
Firbank, Ashdown Road
Forest Row
East Sussex RH18 5BW
Tel: 01342 822278
E-mail: firbank@callinetuk.com

Wignall, Peter

From: Pam Beckett [pam.beckett@lloydbore.co.uk]
Sent: 20 December 2016 08:58
To: Dave.Shore@shepway.gov.uk
Cc: invoices@shepway.gov.uk
Subject: INVOICE 8793 - Princes Parade, Hythe
Attachments: 3609_INV_8793.pdf

Importance: High

REFERENCE EML-OUT/3609/20161220-85551-900

Good morning Dave

Please find attached interim invoice for landscape services provided in relation to Princes Parade, Hythe, ie 8 no. CGI's, as per our fee proposal dated 8th July 2016.

Thank you.

Season's Greetings from all at Lloyd Bore.

Pam Beckett

Finance Manager



Lloyd Bore Ltd. 20 YEARS 1996 – 2016.

33 St. George's Place, Canterbury, Kent CT1 1UT | T: 01227 464 340

59 Lambeth Walk, London, SE11 6DX | T: 02075 822 363

www.lloydbore.co.uk | E: pam.beckett@lloydbore.co.uk | M: n/a

We are fully committed to improving the quality of the work and services we provide. We welcome your feedback, and would be grateful if you could complete our [Customer Feedback Questionnaire](#).

[Follow Us on Twitter](#)



Shepway District Council
Civic Centre
Castle Hill Avenue
Folkestone
Kent
CT20 2QY

lloyd bore

33 ST GEORGE'S PLACE
CANTERBURY
KENT CT1 1UT

t: 01227 464 340
e: mail@lloyd bore.co.uk
w: www.lloyd bore.co.uk

Our ref: 3609/CB/pb
Your ref: Purchase Order no. SD00143

20th December 2016

INVOICE NO. 8793

INTERIM INVOICE

PROJECT NAME: PRINCES PARADE, HYTHE

To: Landscape services as per our Schedule of Services & Fees (doc.
ref. 3609/FP004A) dated 8th July 2016.

Landscape Services:

4. Photography for CGIs – 8 no. viewpoints @ £120/each £ 960.00

Sub Total: £ 960.00

VAT @ 20%: £ 192.00

AMOUNT DUE: £1,152.00

Payment should be made within 30 days of invoice date. Any queries must be raised within 10 days of invoice date.
Cheques should be made payable to LLOYD BORE Ltd. Quoting our invoice number on the reverse.
BACS Payments to: Royal Bank of Scotland, Sort Code: 16-15-20. A/c No: 101 071 34. Quoting our Invoice Number.

Lloyd Bore Limited. Registered Office: 30 St Georges Place, Canterbury. CT1 1UT, England. Reg No:5393155 VAT Reg No. 682 0145 66.
director: Julian bore BA (Hons) M Phil CMLI | associate director: paul whatley BA (Hons) CMLI | head of ecology, canterbury: David Smith BSc (Hons) PhD MCIEEM
head of ecology, cumbria: lucy monahamius gibson MSc MIEEM | office 4, maudlands, maude street, kendal, cumbria, LA9 4GD | t: 01639 738411 | e: lucy@lloyd bore.co.uk

Wignall, Peter

From: Shore, Dave [Dave.Shore@shepway.gov.uk]
Sent: 20 December 2016 14:25
To: Sue Rowlands; 'Matt Shillito'; claire.perrott@tibbalds.co.uk; Adriana Bonilla; 'Mark Gowdridge'; 'ctsiastoti@gt3architects.com'; 'Dunstan, Simon'; 'Robert Glavin'; 'Nathan Dellow'; Samuel Durham; 'Jonathan Rodger'; Peter Radmall; 'Simon Maiden-Brooks'; 'David Ellis'; 'Paul Whatley'; Pinkham, Laura; Lauren Elliott; 'ben.lancaster@curtins.com'; Jarrett, Andy; McGowan, Brendan; Smith, Sarah
Subject: FW: 2016-12-20 - MJG-DS/AJ - 1600128 - Princes Parade, Hythe (Quote)

See below an update on the topographic survey from JC White. Should be with us in advance of the Queen's speech.

Have a good Christmas!

Dave

David Shore

Strategic Development Projects Manager

t: 01303 853459

m: 07976 958486

f: 01303 853502

Shepway District Council, Civic Centre,

Castle Hill Avenue, Folkestone, Kent, CT20 2QY.

E: dave.shore@shepway.gov.uk

www.shepway.gov.uk

Follow us on [Twitter](#) and [Facebook](#)

"The contents and any attachments of this e-mail message are confidential and intended only for the named addressees. If you have received it in error, please advise the sender immediately by return email and then delete it from your system. Any unauthorised distribution, or copying of this transmission, or mis-use or wrongful disclosure of information contained in it, is strictly prohibited. Shepway District Council cannot accept liability for any statements made which are clearly the sender's own and not expressly made on behalf of the council."

From: Mike Guntripp - J C White [mailto:Mike@jcwhite.co.uk]
Sent: 20 December 2016 14:00
To: Shore, Dave
Subject: 2016-12-20 - MJG-DS/AJ - 1600128 - Princes Parade, Hythe (Quote)

Afternoon Dave,

The survey is complete and awaiting final checking before issue.

All things being considered the survey should be issued on or before this Friday, when we break for Christmas.

Kind Regards

Mike

Mike Guntripp
Survey Director

J C White Geomatics Limited
Shrine Barn, Sandling Road, Postling, Nr. Hythe, Kent CT21 4HE

Tel: (01303) 261212 | Fax: (01303) 264040 | email: mike@jcwhite.co.uk | web: www.jcwhite.co.uk

From: Dave.Shore@shepway.gov.uk [<mailto:Dave.Shore@shepway.gov.uk>]

Sent: 20 December 2016 12:41

To: Mike Guntripp - J C White <Mike@jcwhite.co.uk>

Subject: RE: 2016-11-23 - MJG-DS/AJ - 1600128 - Princes Parade, Hythe (Quote)

Mike

Are you able to provide an update on when the Princes Parade topographic survey is likely to be completed?

Thanks

Dave

David Shore

Strategic Development Projects Manager

t: 01303 853459

m: 07976 958486

f: 01303 853502

Shepway District Council, Civic Centre,

Castle Hill Avenue, Folkestone, Kent, CT20 2QY.

E: dave.shore@shepway.gov.uk

www.shepway.gov.uk

Follow us on [Twitter](#) and [Facebook](#)

"The contents and any attachments of this e-mail message are confidential and intended only for the named addressees. If you have received it in error, please advise the sender immediately by return email and then delete it from your system. Any unauthorised distribution, or copying of this transmission, or mis-use or wrongful disclosure of information contained in it, is strictly prohibited. Shepway District Council cannot accept liability for any statements made which are clearly the sender's own and not expressly made on behalf of the council."