

KINGMOOR ERF

APPENDIX 6

Landscape Masterplan

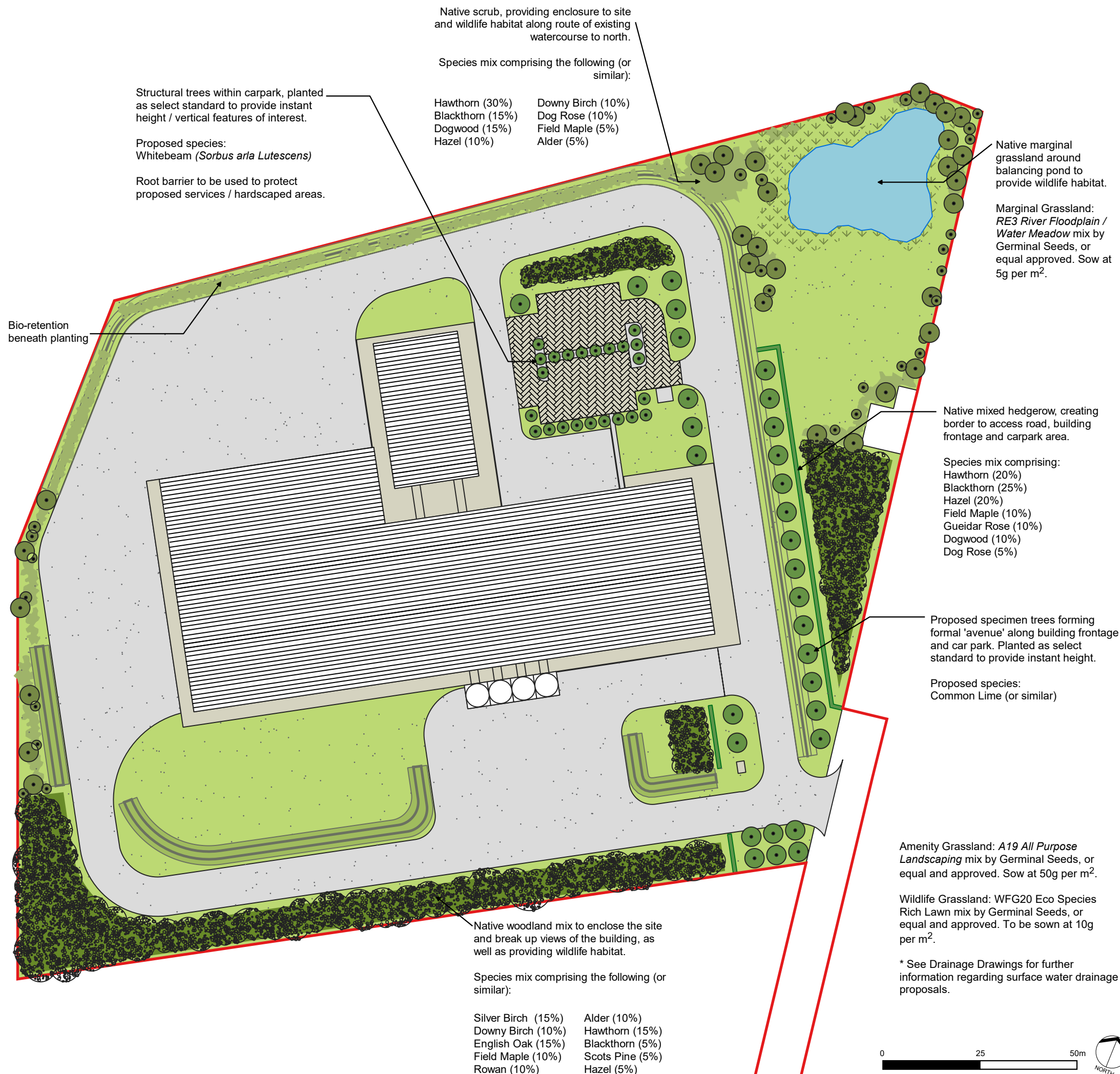

KEY

- Site Boundary
- Native Woodland
- Native Scrub
- Specimen Tree
- Native Mixed Hedgerow
- Amenity Grassland (Mown Grass)
- Marginal Grassland
- Swale
- Proposed Hardstanding/Roadway
- Gravel
- Permeable Paving with Sub Gravel

NOTES

All shrubs and trees will be planted at the first available opportunity, in accordance with seasonal restrictions as follows:

- Bare root plants (native woodland, native scrub, native mixed hedgerow): plant between October and March (inclusive);
- Seeding of Amenity Grassland: from April to October (inclusive);
- Seeding of Wildlife Grassland: from April to October (excluding the months of July and August).

The Native Woodland mix and Native Scrub mix shall be planted at 2m centres, arranged in random groups of 4 - 7no of the same species.

The Native Mixed Hedgerow shall be planted in a double-staggered row (6no per linear metre). Immediately after planting, hedgerow plants shall be pruned back by approximately 1/3 to encourage a dense bushy hedge. Within the first 3 years, the hedge shall be pruned twice per year (firstly in June-July, then in Sept-Oct). Thereafter, the hedge shall be cut once per year in October to Feb to maintain a height of approximately 1.5m. No trimming shall take place during bird nesting season of mid March - mid July. The hedge shall be cut to a trapezium profile, broader at the base than at the top to ensure a bare base does not develop.

For areas of Amenity Grassland; the mowing regime shall maintain a sward height of 30-70mm. Wildlife and marginal grassland shall be cut twice yearly, in spring (April) to a height of 50-70mm, and in autumn (September/ October) to a height of 50mm, with arisings removed.

Projected Coordinate System: British National Grid

DATE	BY	PAPER	SCALE	QA	REV
FEB 2021	MP	A3	1:1000	PT	-