



**ENVIRONMENTAL CONSULTANTS LTD**

---

**Report No: AR/09/3388 (update 02)**

**Page 1 of 11**

**CRAGSIDE PRIMARY SCHOOL,  
WEST LOCK ROAD,  
CRAMLINGTON, NE23 6LW  
MANAGEMENT ASBESTOS SURVEY**



**UPDATED ASBESTOS REGISTER FROM VEGA REPORT  
AR/09/3388**

**UPDATED BY ASBESTOS MANAGER – RON BROWN**

**Issue Date: 09 July 2015**

---

## Contents

	<i>Page No</i>
Introduction -----	3
Asbestos Register -----	4
Report Summary -----	5-11
Appendices	
Appendix A – Survey Report Data Record Sheets	
Appendix B – Material Algorithm	
Appendix C – Bulk analysis and sample locations	
Appendix D - Insurance Information	
Appendix E – Asbestos Management Plan	



**Church Buildings  
Station Road  
Seaton Delaval  
Whitley Bay  
TYNE & WEAR  
NE25 0PT**

**Tel: (0191) 298 0198  
Fax: (0191) 298 0199**

**OCCUPATIONAL HYGIENE CONSULTANTS**

*Asbestos Surveys, Analysis and Monitoring  
COSHH Audits, Assessments and Surveys  
Indoor Air Quality, Environmental Testing*

**CLEANROOM TESTING CONSULTANTS**

*DOP/PSL Testing of HEPA/ULPA Filters  
HLF, VLF, MSC and Fume Cupboard Testing  
Validating/Testing of Pharmaceutical Process Isolators*

**CONFIDENTIAL**

**ASBESTOS SURVEY REPORT**

**Page 3 of 11**

**INTRODUCTION**

**Report No:** AR/09/3388 (update 02)

**Date of Issue:** 09/07/2015

**Client:** John Warwick  
Northumberland County Council  
Property Services Section (Asbestos)  
Resources Department  
Performance Group  
County Hall  
Morpeth  
Northumberland NE61 2EF

**Clients Order No**

**Date(s) of Survey:** 07/10/09

**Establishment Surveyed:** Cragside  
Primary School, Cramlington.

**Area(s) Surveyed:** See Report Summary for details of the scope, limitations and areas surveyed.

**Type of Survey:** Type 2 - Standard Sampling, Identification and Assessment, (see Additional Information section for definition)

**Purpose, Aims and Objectives**

This survey was undertaken to establish the presence and nature of asbestos based materials in the area(s) surveyed. Surveying, sampling and assessment of asbestos-containing materials was carried out in accordance with MDHS 100: July 2001.

Representative bulk and - if applicable - air samples were taken from the locations detailed in the following pages of this report. The bulk samples were subject to a careful cleaning procedure involving disintegration of the sample, acid washing, solvent washing, filtration etc., in order to expose fibres in a form suitable for microscopic analysis. Analysis was carried out in accordance with HSG 248 – ‘Asbestos: The analysts’ guide for sampling, analysis and clearance procedures.’ by documented in-house procedures.

Vega Environmental Consultants Ltd cannot accept responsibility for any errors or misinterpretations introduced into a survey, or any resulting conclusions, as a result of a reduced sampling frequency specified by a client.



This survey attempts to identify all asbestos materials within the agreed scope of work. However, as asbestos materials can be completely hidden/buried within a structure, VEGA cannot accept responsibility for additional materials that may be identified at a later date.



This report must not be reproduced except in full, without written approval of Vega Environmental Consultants Ltd

**Checked by: Mr. R. Brown**  
*Asbestos Manager*

**Report No:** AR/09/3388 (update 02)

For the materials identified in the summary we would recommend the following actions as determined solely by the initial risk assessment score:

	Level of ID (P/SP/ID)		Clean up of debris	Repair of damaged material	Encapsulation	Enclosure	Removal	Immediate restriction of access to/isolation of ACMs	Leave Undisturbed and Monitor Situation regularly.
Area / Component / Sample Identifier									
Kitchen Staff Room & Toilet / Toilet cistern / BS/01	ID							<b>REMOVED AUG 2014</b>	
External Buildings, Boiler Room / Residual debris to roof joists/ As BS/02	SP							<b>REMOVED FEB 2010</b>	
External Buildings, Tank Room / Residual debris to roof joists/ As BS/02	SP							<b>REMOVED FEB 2010</b>	
External Buildings, Tank Room / Debris to floor / BS/02	ID							<b>REMOVED FEB 2010</b>	
External Buildings, Gas Cupboard / Pipe flange gaskets / BS/03	ID								
Exterior / Damp proof course / BS/04	ID								

CODE	ACTION
	Remove ASAP
	Repair/Encapsulate ASAP
	Leave Undisturbed and Monitor Situation Regularly

**REPORT SUMMARY**

**Report No:** AR/09/3388 (update 02)

**Survey Specification:**

**Type 2 Survey:**

**Definition: Type 2 Survey (Standard Sampling, Identification and Assessment):**  
The analyst will do a general walk around the whole area and look at all readily accessible areas. From his experience the analyst will attempt to identify any asbestos and/or asbestos products without the need for sampling. The areas will be assessed and where appropriate will be **presumed** to contain asbestos. Where it appears highly likely that materials will contain asbestos, there should be a **strong presumption** that it does. All materials, which are presumed to contain asbestos, must be assessed using the Material Assessment Algorithm. Where practicable representative samples will be taken from all materials in accordance with full sampling frequency recommendations and analysed. Sample points will be made safe but redecoration will not be carried out (see Appendix A).

**Area(s) Surveyed / Excluded:**

The details of the scope, limitations and areas surveyed during the course of this survey are outlined below:

On 7 October 2009, a type 2 survey was carried out at Cragside Primary School, Cramlington. The premises surveyed were erected in the 1970's, a single storey building with brick walls and flat felt roof. The Void Above Hall was omitted from this survey as it was inaccessible due to height.

The purpose of the survey was to identify and report on the presence and condition of asbestos based materials.

**Cragside Primary School**



Kitchen Staff Room & Toilet - toilet cistern is an asbestos containing material (ACM sample BS/01). It is in good condition and recommended it be left undisturbed and monitored.

**REMOVED AUGUST 2014**

Level of ID	Sample ID	Extent (m/m <sup>2</sup> /m <sup>3</sup> )	Product Type (1,2,3)	Condition (0,1,2,3)	Surface Treatment (0,1,2,3)	Asbestos Type (1,2,3)	Score	Access (IA,OA,EA)	Action (A1,A2,A3)
ID	BS/01	<0.5m <sup>2</sup>	1	0	0	2	3	EA	A3

**ADDITIONAL INFORMATION: Report No: AR/09/3388 (update 02)****External Building**

Boiler Room - residual debris to roof joists is an ACM (as BS/02). It is recommended that the roof joists are cleaned and decontaminated by a licenced asbestos removal contractor.

**REMOVED FEB 2010**

Level of ID	Sample ID	Extent (m/m <sup>2</sup> /m <sup>3</sup> )	Product Type (1,2,3)	Condition (0,1,2,3)	Surface Treatment (0,1,2,3)	Asbestos Type (1,2,3)	Score	Access (IA,OA,EA)	Action (A1,A2,A3)
SP	As BS/02	49m <sup>2</sup>	2	3	2	2	9	IA	REMOVED FEB 2010



Tank Room - residual debris to roof joists is an ACM (as BS/02). It is recommended that the roof joists are cleaned and decontaminated by a licenced asbestos removal contractor.

**REMOVED FEB 2010**

Level of ID	Sample ID	Extent (m/m <sup>2</sup> /m <sup>3</sup> )	Product Type (1,2,3)	Condition (0,1,2,3)	Surface Treatment (0,1,2,3)	Asbestos Type (1,2,3)	Score	Access (IA,OA,EA)	Action (A1,A2,A3)
SP	As BS/02	14m <sup>2</sup>	2	3	2	2	9	IA	REMOVED FEB 2010

**ADDITIONAL INFORMATION: Report No: AR/09/3388 (update 02)**



Tank Room - floor debris is an ACM (sample BS/02). It is recommended that the floor space is cleaned and decontaminated by a licenced asbestos removal contractor.

**REMOVED FEB 2010**

Level of ID	Sample ID	Extent (m/m <sup>2</sup> /m <sup>3</sup> )	Product Type (1,2,3)	Condition (0,1,2,3)	Surface Treatment (0,1,2,3)	Asbestos Type (1,2,3)	Score	Access (IA,OA,EA)	Action (A1,A2,A3)
ID	BS/02	14m <sup>2</sup>	2	3	2	2	9	EA	REMOVED FEB 2010



Gas Cupboard - pipe flange gaskets are an ACM (sample BS/03). They are in good condition and recommended they be left undisturbed and monitored.

Level of ID	Sample ID	Extent (m/m <sup>2</sup> /m <sup>3</sup> )	Product Type (1,2,3)	Condition (0,1,2,3)	Surface Treatment (0,1,2,3)	Asbestos Type (1,2,3)	Score	Access (IA,OA,EA)	Action (A1,A2,A3)
ID	BS/03	<0.5m <sup>2</sup>	1	0	0	1	2	EA	A3



**ADDITIONAL INFORMATION: Report No: AR/09/3388 (update 02)****Exterior**

Exterior - damp proof course is an ACM (BS/04). It is in good condition and recommended it be left undisturbed and monitored.

Level of ID	Sample ID	Extent (m/m <sup>2</sup> /m <sup>3</sup> )	Product Type (1,2,3)	Condition (0,1,2,3)	Surface Treatment (0,1,2,3)	Asbestos Type (1,2,3)	Score	Access (IA,OA,EA)	Action (A1,A2,A3)
ID	BS/04	210m	1	0	0	1	2	OA	A3

Note: Vega Environmental Consultants Ltd recommends all work with asbestos based materials be undertaken by a licensed asbestos removal company, with relevant air sampling carried out by a laboratory accredited by UKAS for both sampling and airborne fibre counting. Any waste produced from removal activities should be disposed of in accordance with the Hazardous Waste Regulations 2005.



**Report No:** AR/09/3388 (update 02)

**DRAWING TO DEPICT ASBESTOS CONTAINING MATERIALS  
AND ASBESTOS SAMPLE POINT LOCATIONS**

**Cragside Primary School**

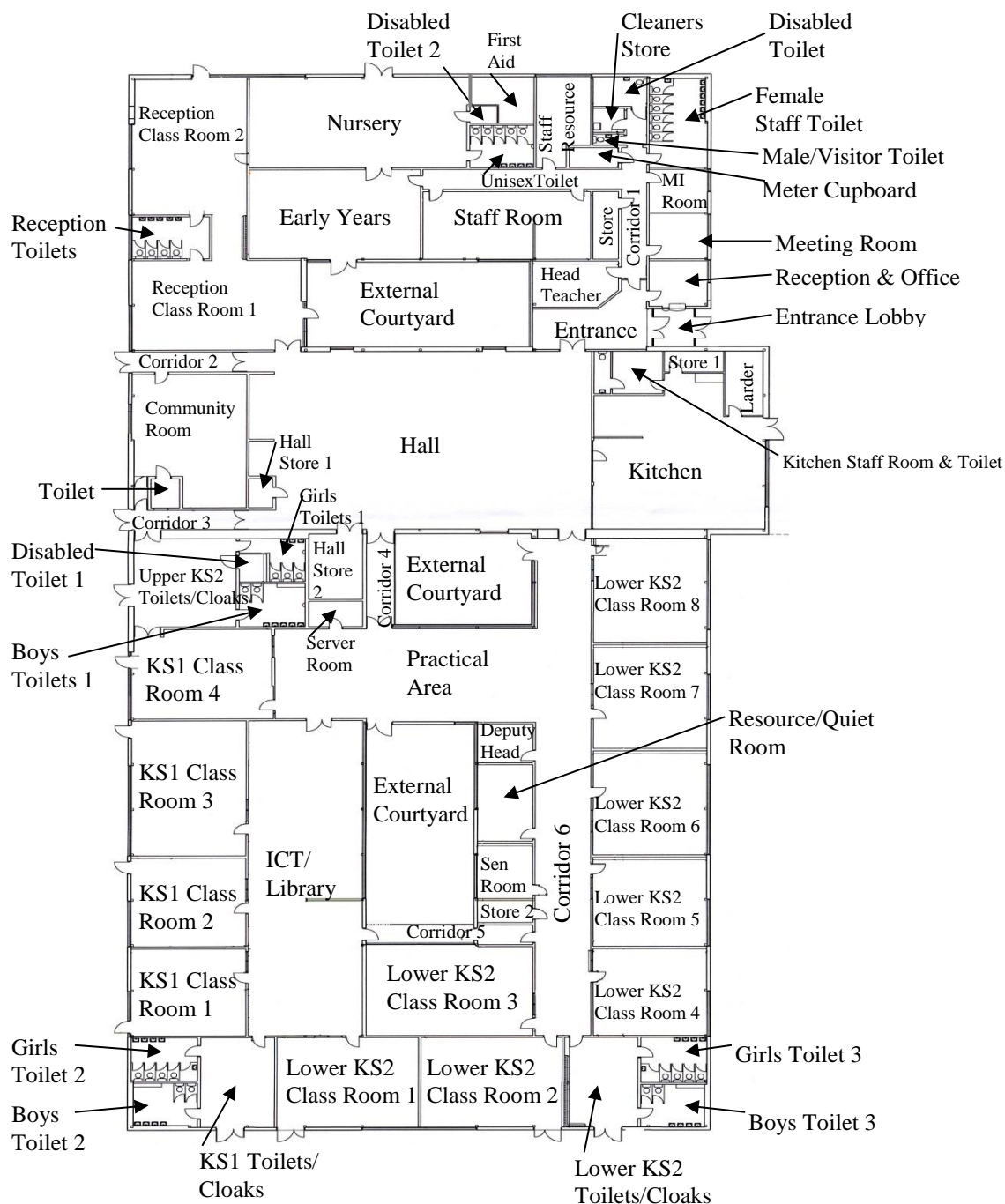

**Report No:** AR/09/3388 (update 02)

**DRAWING TO DEPICT ASBESTOS CONTAINING MATERIALS  
AND ASBESTOS SAMPLE POINT LOCATIONS**

**External Buildings**

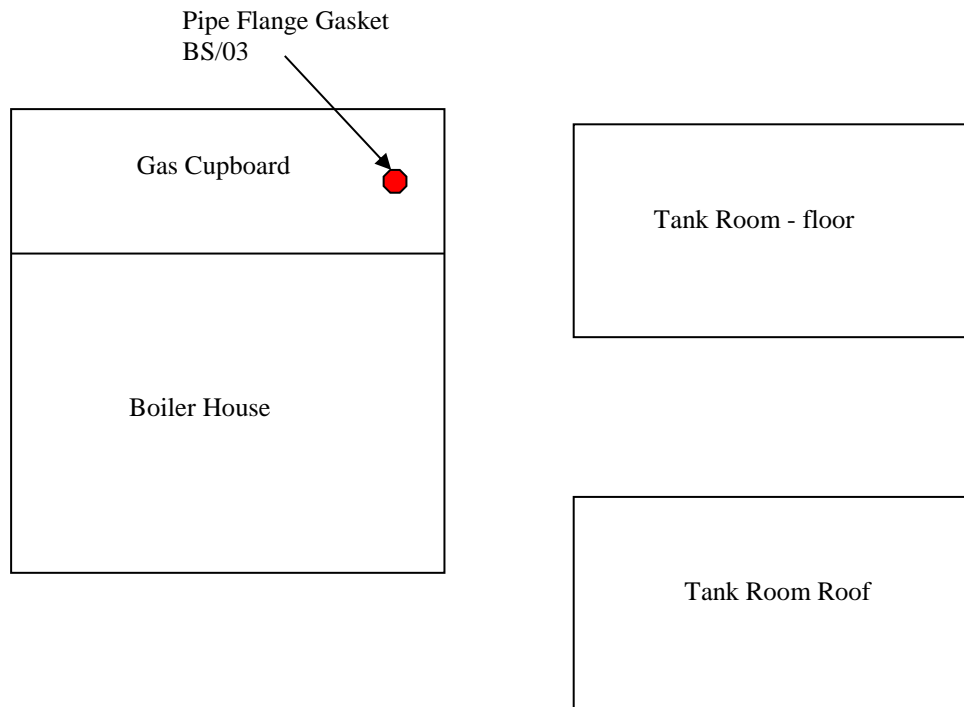

**Report No:** AR/09/3388 (update 02)

**DRAWING TO DEPICT ASBESTOS CONTAINING MATERIALS  
AND ASBESTOS SAMPLE POINT LOCATIONS**

**Exterior**

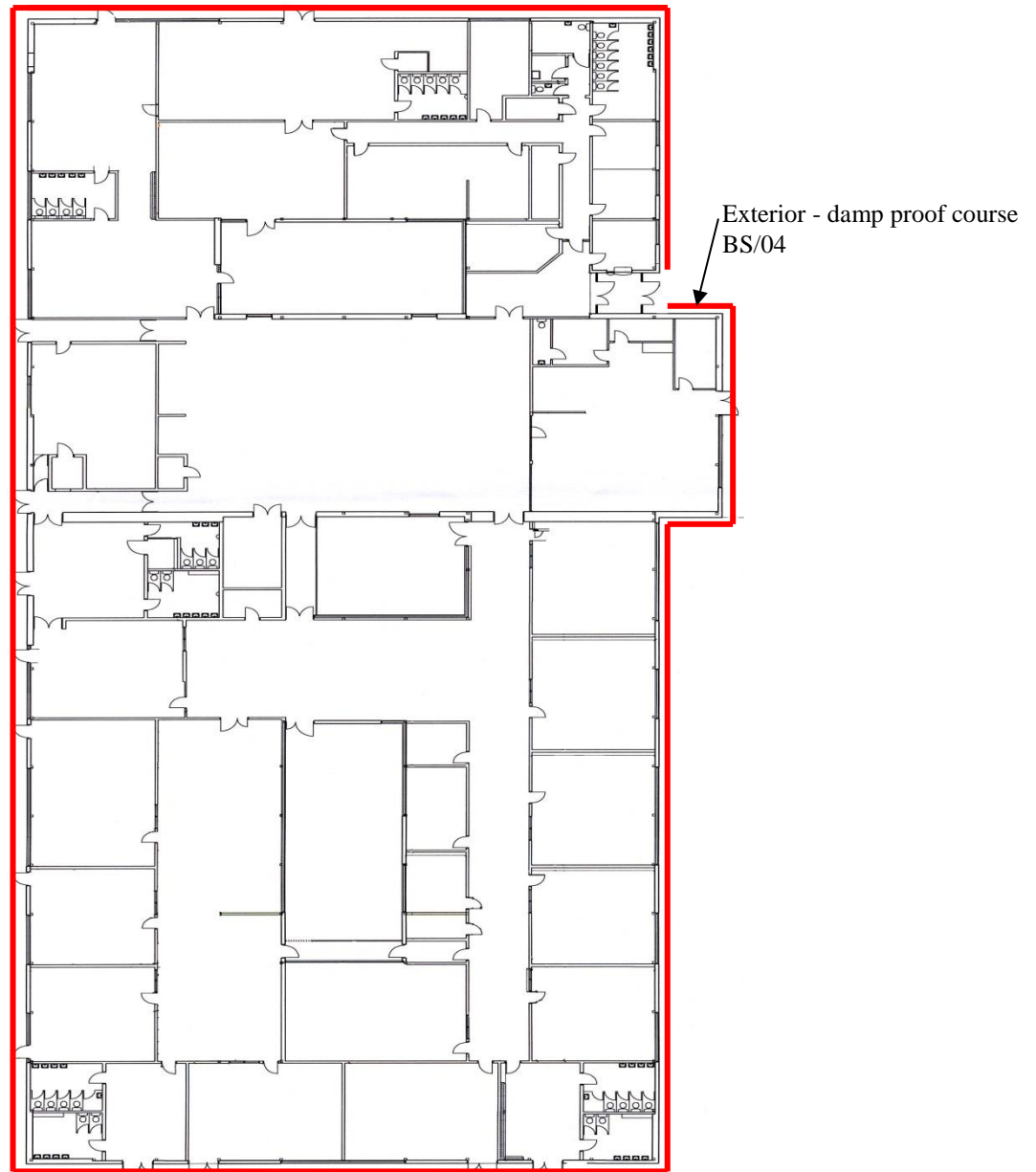

**Report No:** AR/09/3388 (update 02) **Contact:** John Warwick**Date of survey:** 07/10/09

**Client:** Northumberland County Council  
 Property Services Section (Asbestos)  
 Resources Department  
 Performance Group  
 County Hall  
 Morpeth  
 Northumberland NE61 2EF

**Survey Type:** 2**Surveyor:** J Craig and M Steadman**Site Location:** Cragside Primary School, Cramlington.

Area ID	Surveyed Yes/No	Location of sample point / Description of suspect material	Level of ID (P/SP/ID)	Sample ID	Extent (m/m <sup>2</sup> /m <sup>3</sup> )	Product Type (1,2,3)	Condition (0,1,2,3)	Surface Treatment (0,1,2,3)	Asbestos Type (1,2,3)	Score	Access (IA,OA,EA)	Action (A1,A2,A3)
<b>CRAGSIDE PRIMARY SCHOOL</b>												
Entrance Lobby	Yes	Ceiling - wood Walls - brick Floor - carpet over concrete	- - -	- - -	- - -	- - -	- - -	- - -	NA NA NA	- - -	- - -	- - -
Entrance	Yes	Ceiling - MMMF tiles Walls - plasterboard and brick Corner boxing - wood Floor - modern vinyl covering over concrete	- - - -	- - - -	- - - -	- - - -	- - - -	- - - -	NA NA NA NA	- - - -	- - - -	- - - -
Void Above	Yes	Roof - strawboard Pipe insulation - foil covered MMMF	- - -	- - -	- - -	- - -	- - -	- - -	NA NA	- -	- -	- -

**Level of ID:** P – Presumed, SP – Strongly Presumed, ID – Identified. **Access:** IA – Inaccessible, OA – Occasionally Accessed, EA – Easily/Regularly Accessed**Asbestos Type:** NA – Non-Asbestos **Action:** A1 – Remove ASAP, A2 – Repair/Encapsulate ASAP, A3 – Leave Undisturbed and Monitor Situation

**Checked by: Mr. R. Brown**  
*Asbestos Manager*

**VEGA ENVIRONMENTAL CONSULTANTS LTD**

**APPENDIX A**

**ASBESTOS SURVEY - DATA RECORD SHEET - continued**

**Page 2 of 34**

**Report No:** AR/09/3388 (update 02)

**Date of survey:** 07/10/09

Area ID	Surveyed Yes/No	Location of sample point / Description of suspect material	Level of ID (P/SP/ID)	Sample ID	Extent (m/m <sup>2</sup> /m <sup>3</sup> )	Product Type (1,2,3)	Condition (0,1,2,3)	Surface Treatment (0,1,2,3)	Asbestos Type (1,2,3)	Score	Access (IA,OA,EA)	Action (A1,A2,A3)
<b>CRAGSIDE PRIMARY SCHOOL (continued)</b>												
Void Behind Boxing	Yes	No suspect material identified	-	-	-	-	-	-	NA	-	-	-
Reception and Office	Yes	Ceiling - MMMF tiles	-	-	-	-	-	-	NA	-	-	-
		Walls - plasterboard	-	-	-	-	-	-	NA	-	-	-
		Panels to windows - wood	-	-	-	-	-	-	NA	-	-	-
		Floor - carpet over concrete	-	-	-	-	-	-	NA	-	-	-
Void Above	Yes	Roof - strawboard	-	-	-	-	-	-	NA	-	-	-
		Pipe insulation - foil covered MMMF	-	-	-	-	-	-	NA	-	-	-
Corridor 1	Yes	Ceiling - MMMF tiles	-	-	-	-	-	-	NA	-	-	-
		Walls - plasterboard and brick	-	-	-	-	-	-	NA	-	-	-
		Corner boxing - wood	-	-	-	-	-	-	NA	-	-	-
		Floor - modern vinyl covering over concrete	-	-	-	-	-	-	NA	-	-	-
Void Above	Yes	Roof - strawboard	-	-	-	-	-	-	NA	-	-	-
		Pipe insulation - foil covered MMMF	-	-	-	-	-	-	NA	-	-	-

**Level of ID:** P – Presumed, SP – Strongly Presumed, ID – Identified. **Access:** IA – Inaccessible, OA – Occasionally Accessed, EA – Easily/Regularly Accessed

**Asbestos Type:** NA – Non-Asbestos **Action:** A1 – Remove ASAP, A2 – Repair/Encapsulate ASAP, A3 – Leave Undisturbed and Monitor Situation

**Checked by: Mr. R. Brown**

*Asbestos Manager*

**VEGA ENVIRONMENTAL CONSULTANTS LTD**

**APPENDIX A**

**ASBESTOS SURVEY - DATA RECORD SHEET - continued**

**Page 3 of 34**

**Report No:** AR/09/3388 (update 02)

**Date of survey:** 07/10/09

Area ID	Surveyed Yes/No	Location of sample point / Description of suspect material	Level of ID (P/SP/ID)	Sample ID	Extent (m/m <sup>2</sup> /m <sup>3</sup> )	Product Type (1,2,3)	Condition (0,1,2,3)	Surface Treatment (0,1,2,3)	Asbestos Type (1,2,3)	Score	Access (IA,OA,EA)	Action (A1,A2,A3)
<b>CRAGSIDE PRIMARY SCHOOL (continued)</b>												
Meeting Room	Yes	Ceiling - MMMF tiles	-	-	-	-	-	-	NA	-	-	-
		Walls - plasterboard	-	-	-	-	-	-	NA	-	-	-
		Panels to windows - wood	-	-	-	-	-	-	NA	-	-	-
		Floor - carpet over concrete	-	-	-	-	-	-	NA	-	-	-
Void Above	Yes	Roof - strawboard	-	-	-	-	-	-	NA	-	-	-
		Pipe insulation - foil covered MMMF	-	-	-	-	-	-	NA	-	-	-
M1	Yes	Ceiling - MMMF tiles	-	-	-	-	-	-	NA	-	-	-
		Walls - plasterboard	-	-	-	-	-	-	NA	-	-	-
		Panels to windows - wood	-	-	-	-	-	-	NA	-	-	-
		Floor - carpet over concrete	-	-	-	-	-	-	NA	-	-	-
Void Above	Yes	Roof - strawboard	-	-	-	-	-	-	NA	-	-	-
		Pipe insulation - foil covered MMMF	-	-	-	-	-	-	NA	-	-	-
Female Staff Toilet	Yes	Ceiling - MMMF tiles	-	-	-	-	-	-	NA	-	-	-
		Walls - plasterboard	-	-	-	-	-	-	NA	-	-	-
		Boxing - wood	-	-	-	-	-	-	NA	-	-	-
		Panels to windows - wood	-	-	-	-	-	-	NA	-	-	-

**Level of ID:** P – Presumed, SP – Strongly Presumed, ID – Identified. **Access:** IA – Inaccessible, OA – Occasionally Accessed, EA – Easily/Regularly Accessed

**Asbestos Type:** NA – Non-Asbestos **Action:** A1 – Remove ASAP, A2 – Repair/Encapsulate ASAP, A3 – Leave Undisturbed and Monitor Situation

**Checked by: Mr. R. Brown**

*Asbestos Manager*

**VEGA ENVIRONMENTAL CONSULTANTS LTD**

**APPENDIX A**

**ASBESTOS SURVEY - DATA RECORD SHEET - continued**

**Page 4 of 34**

**Report No:** AR/09/3388 (update 02)

**Date of survey:** 07/10/09

Area ID	Surveyed Yes/No	Location of sample point / Description of suspect material	Level of ID (P/SP/ID)	Sample ID	Extent (m/m <sup>2</sup> /m <sup>3</sup> )	Product Type (1,2,3)	Condition (0,1,2,3)	Surface Treatment (0,1,2,3)	Asbestos Type (1,2,3)	Score	Access (IA,OA,EA)	Action (A1,A2,A3)
<b>CRAGSIDE PRIMARY SCHOOL (continued)</b>												
Female Staff Toilet (cont)	Yes	Toilet cistern - plastic and ceramic	-	-	-	-	-	-	NA	-	-	-
		Floor - modern vinyl covering over concrete	-	-	-	-	-	-	NA	-	-	-
Void Above	Yes	Roof - strawboard	-	-	-	-	-	-	NA	-	-	-
		Pipe insulation - foil covered MMMFF	-	-	-	-	-	-	NA	-	-	-
Void Behind Boxing	Yes	No suspect material identified	-	-	-	-	-	-	NA	-	-	-
Disabled Staff Toilet	Yes	Ceiling - MMMF tiles	-	-	-	-	-	-	NA	-	-	-
		Walls - plasterboard	-	-	-	-	-	-	NA	-	-	-
		Boxing - wood	-	-	-	-	-	-	NA	-	-	-
		Panels to windows - wood	-	-	-	-	-	-	NA	-	-	-
		Toilet cistern - ceramic	-	-	-	-	-	-	NA	-	-	-
		Floor - modern vinyl covering over concrete	-	-	-	-	-	-	NA	-	-	-
Void Above	Yes	Roof - strawboard	-	-	-	-	-	-	NA	-	-	-
		Pipe insulation - foil covered MMMFF	-	-	-	-	-	-	NA	-	-	-

**Level of ID:** P – Presumed, SP – Strongly Presumed, ID – Identified. **Access:** IA – Inaccessible, OA – Occasionally Accessed, EA – Easily/Regularly Accessed  
**Asbestos Type:** NA – Non-Asbestos **Action:** A1 – Remove ASAP, A2 – Repair/Encapsulate ASAP, A3 – Leave Undisturbed and Monitor Situation

**Checked by: Mr. R. Brown**  
*Asbestos Manager*



**VEGA ENVIRONMENTAL CONSULTANTS LTD**

**APPENDIX A**

**ASBESTOS SURVEY - DATA RECORD SHEET - continued**

**Page 5 of 34**

**Report No:** AR/09/3388 (update 02)

**Date of survey:** 07/10/09

Area ID	Surveyed Yes/No	Location of sample point / Description of suspect material	Level of ID (P/SP/ID)	Sample ID	Extent (m/m <sup>2</sup> /m <sup>3</sup> )	Product Type (1,2,3)	Condition (0,1,2,3)	Surface Treatment (0,1,2,3)	Asbestos Type (1,2,3)	Score	Access (IA,OA,EA)	Action (A1,A2,A3)
<b>CRAGSIDE PRIMARY SCHOOL (continued)</b>												
Void Behind Boxing	Yes	No suspect material identified	-	-	-	-	-	-	NA	-	-	-
Cleaners Store	Yes	Ceiling - MMMF tiles	-	-	-	-	-	-	NA	-	-	-
		Walls - plasterboard and brick	-	-	-	-	-	-	NA	-	-	-
		Floor - modern vinyl covering over concrete	-	-	-	-	-	-	NA	-	-	-
Void Above	Yes	Roof - strawboard	-	-	-	-	-	-	NA	-	-	-
		Pipe insulation - foil covered MMMF	-	-	-	-	-	-	NA	-	-	-
Male/Visitor Toilet	Yes	Ceiling - MMMF tiles	-	-	-	-	-	-	NA	-	-	-
		Walls - plasterboard	-	-	-	-	-	-	NA	-	-	-
		Toilet cistern - ceramic	-	-	-	-	-	-	NA	-	-	-
		Floor - modern vinyl covering over concrete	-	-	-	-	-	-	NA	-	-	-
Void Above	Yes	Roof - strawboard	-	-	-	-	-	-	NA	-	-	-
		Pipe insulation - foil covered MMMF	-	-	-	-	-	-	NA	-	-	-

**Level of ID:** P – Presumed, SP – Strongly Presumed, ID – Identified. **Access:** IA – Inaccessible, OA – Occasionally Accessed, EA – Easily/Regularly Accessed

**Asbestos Type:** NA – Non-Asbestos **Action:** A1 – Remove ASAP, A2 – Repair/Encapsulate ASAP, A3 – Leave Undisturbed and Monitor Situation

**Checked by: Mr. R. Brown**  
*Asbestos Manager*

**VEGA ENVIRONMENTAL CONSULTANTS LTD**

**APPENDIX A**

**ASBESTOS SURVEY - DATA RECORD SHEET - continued**

**Page 6 of 34**

**Report No:** AR/09/3388 (update 02)

**Date of survey:** 07/10/09

Area ID	Surveyed Yes/No	Location of sample point / Description of suspect material	Level of ID (P/SP/ID)	Sample ID	Extent (m/m <sup>2</sup> /m <sup>3</sup> )	Product Type (1,2,3)	Condition (0,1,2,3)	Surface Treatment (0,1,2,3)	Asbestos Type (1,2,3)	Score	Access (IA,OA,EA)	Action (A1,A2,A3)
<b>CRAGSIDE PRIMARY SCHOOL (continued)</b>												
Meter Cupboard	Yes	Ceiling - MMMF tiles Walls - plasterboard and wood Electric equipment - modern Floor - modern vinyl covering over concrete	- - - -	- - - -	- - - -	- - - -	- - - -	- - - -	NA NA NA NA	- - - -	- - - -	- - - -
Void Above	Yes	No suspect material identified	-	-	-	-	-	-	NA	-	-	-
Store	Yes	Ceiling - MMMF tiles Walls - plasterboard and brick Floor - modern vinyl covering over concrete	- - -	- - -	- - -	- - -	- - -	- - -	NA NA NA	- - -	- - -	- - -
Void Above	Yes	Roof - strawboard Pipe insulation - foil covered MMMF	- -	- -	- -	- -	- -	- -	NA NA	- -	- -	- -
Head Teacher	Yes	Ceiling - MMMF tiles Walls - plasterboard and brick Corner boxing - wood Floor - carpet over concrete	- - - -	- - - -	- - - -	- - - -	- - - -	- - - -	NA NA NA NA	- - - -	- - - -	- - - -

**Level of ID:** P – Presumed, SP – Strongly Presumed, ID – Identified. **Access:** IA – Inaccessible, OA – Occasionally Accessed, EA – Easily/Regularly Accessed

**Asbestos Type:** NA – Non-Asbestos **Action:** A1 – Remove ASAP, A2 – Repair/Encapsulate ASAP, A3 – Leave Undisturbed and Monitor Situation

**Checked by: Mr. R. Brown**  
*Asbestos Manager*

**VEGA ENVIRONMENTAL CONSULTANTS LTD**

**APPENDIX A**

**ASBESTOS SURVEY - DATA RECORD SHEET - continued**

**Page 7 of 34**

**Report No:** AR/09/3388 (update 02)

**Date of survey:** 07/10/09

Area ID	Surveyed Yes/No	Location of sample point / Description of suspect material	Level of ID (P/SP/ID)	Sample ID	Extent (m/m <sup>2</sup> /m <sup>3</sup> )	Product Type (1,2,3)	Condition (0,1,2,3)	Surface Treatment (0,1,2,3)	Asbestos Type (1,2,3)	Score	Access (IA,OA,EA)	Action (A1,A2,A3)
<b>CRAGSIDE PRIMARY SCHOOL (continued)</b>												
Void Above	Yes	Roof - strawboard	-	-	-	-	-	-	NA	-	-	-
		Pipe insulation - foil covered MMMF	-	-	-	-	-	-	NA	-	-	-
Staff Resource	Yes	Ceiling - MMMF tiles	-	-	-	-	-	-	NA	-	-	-
		Walls - plasterboard and brick	-	-	-	-	-	-	NA	-	-	-
		Corner boxing - wood	-	-	-	-	-	-	NA	-	-	-
		Floor - carpet over concrete	-	-	-	-	-	-	NA	-	-	-
Void Above	Yes	Roof - strawboard	-	-	-	-	-	-	NA	-	-	-
		Pipe insulation - foil covered MMMF	-	-	-	-	-	-	NA	-	-	-
Staff Room	Yes	Ceiling - MMMF tiles	-	-	-	-	-	-	NA	-	-	-
		Skylight upstands - wood and fibreglass	-	-	-	-	-	-	NA	-	-	-
		Walls - plasterboard	-	-	-	-	-	-	NA	-	-	-
		Sink unit - modern	-	-	-	-	-	-	NA	-	-	-
		Panel adjacent window - wood	-	-	-	-	-	-	NA	-	-	-
		Floor - modern vinyl covering over carpet over concrete and carpet over concrete	-	-	-	-	-	-	NA	-	-	-

**Level of ID:** P – Presumed, SP – Strongly Presumed, ID – Identified. **Access:** IA – Inaccessible, OA – Occasionally Accessed, EA – Easily/Regularly Accessed

**Asbestos Type:** NA – Non-Asbestos **Action:** A1 – Remove ASAP, A2 – Repair/Encapsulate ASAP, A3 – Leave Undisturbed and Monitor Situation

**Checked by: Mr. R. Brown**  
*Asbestos Manager*

**VEGA ENVIRONMENTAL CONSULTANTS LTD**

**APPENDIX A**

**ASBESTOS SURVEY - DATA RECORD SHEET - continued**

**Page 8 of 34**

**Report No:** AR/09/3388 (update 02)

**Date of survey:** 07/10/09

Area ID	Surveyed Yes/No	Location of sample point / Description of suspect material	Level of ID (P/SP/ID)	Sample ID	Extent (m/m <sup>2</sup> /m <sup>3</sup> )	Product Type (1,2,3)	Condition (0,1,2,3)	Surface Treatment (0,1,2,3)	Asbestos Type (1,2,3)	Score	Access (IA,OA,EA)	Action (A1,A2,A3)
<b>CRAGSIDE PRIMARY SCHOOL (continued)</b>												
Void Above	Yes	Roof - strawboard	-	-	-	-	-	-	NA	-	-	-
		Pipe insulation - foil covered MMMF	-	-	-	-	-	-	NA	-	-	-
Early Years	Yes	Ceiling - MMMF tiles	-	-	-	-	-	-	NA	-	-	-
		Walls - plasterboard	-	-	-	-	-	-	NA	-	-	-
		Sink unit - modern	-	-	-	-	-	-	NA	-	-	-
		Panels to window - wood	-	-	-	-	-	-	NA	-	-	-
		Floor - modern vinyl covering over concrete and carpet over concrete	-	-	-	-	-	-	NA	-	-	-
Void Above	Yes	Roof - strawboard	-	-	-	-	-	-	NA	-	-	-
		Pipe insulation - foil covered MMMF	-	-	-	-	-	-	NA	-	-	-
Nursery	Yes	Ceiling - MMMF tiles	-	-	-	-	-	-	NA	-	-	-
		Walls - plasterboard	-	-	-	-	-	-	NA	-	-	-
		Sink unit - modern	-	-	-	-	-	-	NA	-	-	-
		Panels to window - wood	-	-	-	-	-	-	NA	-	-	-
		Floor - modern vinyl covering over concrete and carpet over concrete	-	-	-	-	-	-	NA	-	-	-

**Level of ID:** P – Presumed, SP – Strongly Presumed, ID – Identified. **Access:** IA – Inaccessible, OA – Occasionally Accessed, EA – Easily/Regularly Accessed

**Asbestos Type:** NA – Non-Asbestos **Action:** A1 – Remove ASAP, A2 – Repair/Encapsulate ASAP, A3 – Leave Undisturbed and Monitor Situation

**Checked by: Mr. R. Brown**

*Asbestos Manager*

**VEGA ENVIRONMENTAL CONSULTANTS LTD**

**APPENDIX A**

**ASBESTOS SURVEY - DATA RECORD SHEET - continued**

**Page 9 of 34**

**Report No:** AR/09/3388 (update 02)

**Date of survey:** 07/10/09

Area ID	Surveyed Yes/No	Location of sample point / Description of suspect material	Level of ID (P/SP/ID)	Sample ID	Extent (m/m <sup>2</sup> /m <sup>3</sup> )	Product Type (1,2,3)	Condition (0,1,2,3)	Surface Treatment (0,1,2,3)	Asbestos Type (1,2,3)	Score	Access (IA,OA,EA)	Action (A1,A2,A3)
<b>CRAGSIDE PRIMARY SCHOOL (continued)</b>												
Void Above	Yes	Roof - strawboard	-	-	-	-	-	-	NA	-	-	-
		Pipe insulation - foil covered MMMF	-	-	-	-	-	-	NA	-	-	-
First Aid	Yes	Ceiling - MMMF tiles	-	-	-	-	-	-	NA	-	-	-
		Walls - plasterboard	-	-	-	-	-	-	NA	-	-	-
		Sink unit - modern	-	-	-	-	-	-	NA	-	-	-
		Panels to window - wood	-	-	-	-	-	-	NA	-	-	-
		Floor - modern vinyl covering over concrete and carpet over concrete	-	-	-	-	-	-	NA	-	-	-
Void Above	Yes	Roof - strawboard	-	-	-	-	-	-	NA	-	-	-
		Pipe insulation - foil covered MMMF	-	-	-	-	-	-	NA	-	-	-
Disabled Staff Toilet 2	Yes	Ceiling - MMMF tiles	-	-	-	-	-	-	NA	-	-	-
		Walls - plasterboard	-	-	-	-	-	-	NA	-	-	-
		Boxing - wood	-	-	-	-	-	-	NA	-	-	-
		Toilet cistern - ceramic	-	-	-	-	-	-	NA	-	-	-
		Floor - modern vinyl covering over concrete	-	-	-	-	-	-	NA	-	-	-

**Level of ID:** P – Presumed, SP – Strongly Presumed, ID – Identified. **Access:** IA – Inaccessible, OA – Occasionally Accessed, EA – Easily/Regularly Accessed

**Asbestos Type:** NA – Non-Asbestos **Action:** A1 – Remove ASAP, A2 – Repair/Encapsulate ASAP, A3 – Leave Undisturbed and Monitor Situation

**Checked by: Mr. R. Brown**  
*Asbestos Manager*

**VEGA ENVIRONMENTAL CONSULTANTS LTD**

**APPENDIX A**

**ASBESTOS SURVEY - DATA RECORD SHEET - continued**

**Page 10 of 34**

**Report No:** AR/09/3388 (update 02)

**Date of survey:** 07/10/09

Area ID	Surveyed Yes/No	Location of sample point / Description of suspect material	Level of ID (P/SP/ID)	Sample ID	Extent (m/m <sup>2</sup> /m <sup>3</sup> )	Product Type (1,2,3)	Condition (0,1,2,3)	Surface Treatment (0,1,2,3)	Asbestos Type (1,2,3)	Score	Access (IA,OA,EA)	Action (A1,A2,A3)
<b>CRAGSIDE PRIMARY SCHOOL (continued)</b>												
Void Above	Yes	Roof - strawboard	-	-	-	-	-	-	NA	-	-	-
		Pipe insulation - foil covered MMMF	-	-	-	-	-	-	NA	-	-	-
Void Behind Boxing	Yes	No suspect material identified	-	-	-	-	-	-	NA	-	-	-
Unisex Toilet	Yes	Ceiling - MMMF tiles	-	-	-	-	-	-	NA	-	-	-
		Walls - plasterboard	-	-	-	-	-	-	NA	-	-	-
		Boxing - wood	-	-	-	-	-	-	NA	-	-	-
		Toilet cistern - ceramic	-	-	-	-	-	-	NA	-	-	-
		Floor - modern vinyl covering over concrete	-	-	-	-	-	-	NA	-	-	-
Void Above	Yes	Roof - strawboard	-	-	-	-	-	-	NA	-	-	-
		Pipe insulation - foil covered MMMF	-	-	-	-	-	-	NA	-	-	-
Void Behind Boxing	Yes	No suspect material identified	-	-	-	-	-	-	NA	-	-	-

**Level of ID:** P – Presumed, SP – Strongly Presumed, ID – Identified. **Access:** IA – Inaccessible, OA – Occasionally Accessed, EA – Easily/Regularly Accessed

**Asbestos Type:** NA – Non-Asbestos **Action:** A1 – Remove ASAP, A2 – Repair/Encapsulate ASAP, A3 – Leave Undisturbed and Monitor Situation

**Checked by: Mr. R. Brown**

*Asbestos Manager*

**VEGA ENVIRONMENTAL CONSULTANTS LTD**

**APPENDIX A**

**ASBESTOS SURVEY - DATA RECORD SHEET - continued**

**Page 11 of 34**

**Report No:** AR/09/3388 (update 02)

**Date of survey:** 07/10/09

Area ID	Surveyed Yes/No	Location of sample point / Description of suspect material	Level of ID (P/SP/ID)	Sample ID	Extent (m/m <sup>2</sup> /m <sup>3</sup> )	Product Type (1,2,3)	Condition (0,1,2,3)	Surface Treatment (0,1,2,3)	Asbestos Type (1,2,3)	Score	Access (IA,OA,EA)	Action (A1,A2,A3)
<b>CRAGSIDE PRIMARY SCHOOL (continued)</b>												
Reception Class Room 1	Yes	Ceiling - MMMF tiles Walls - plasterboard Sink unit - modern Panels to window - wood Floor - modern vinyl covering over concrete and carpet over concrete	- - - - -	- - - - -	- - - - -	- - - - -	- - - - -	- - - - -	NA NA NA NA NA	- - - - -	- - - - -	- - - - -
Void Above	Yes	Roof - strawboard Pipe insulation - foil covered MMMF	- -	- -	- -	- -	- -	- -	NA NA	- -	- -	- -
Reception Class Room 2	Yes	Ceiling - MMMF tiles Walls - plasterboard Sink unit - modern Panels to window - wood Floor - modern vinyl covering over concrete and carpet over concrete	- - - - -	- - - - -	- - - - -	- - - - -	- - - - -	- - - - -	NA NA NA NA NA	- - - - -	- - - - -	- - - - -
Void Above	Yes	Roof - strawboard Pipe insulation - foil covered MMMF	- -	- -	- -	- -	- -	- -	NA NA	- -	- -	- -

**Level of ID:** P – Presumed, SP – Strongly Presumed, ID – Identified. **Access:** IA – Inaccessible, OA – Occasionally Accessed, EA – Easily/Regularly Accessed

**Asbestos Type:** NA – Non-Asbestos **Action:** A1 – Remove ASAP, A2 – Repair/Encapsulate ASAP, A3 – Leave Undisturbed and Monitor Situation

**Checked by: Mr. R. Brown**  
*Asbestos Manager*



**VEGA ENVIRONMENTAL CONSULTANTS LTD**

**APPENDIX A**

**ASBESTOS SURVEY - DATA RECORD SHEET - continued**

**Page 12 of 34**

**Report No:** AR/09/3388 (update 02)

**Date of survey:** 07/10/09

Area ID	Surveyed Yes/No	Location of sample point / Description of suspect material	Level of ID (P/SP/ID)	Sample ID	Extent (m/m <sup>2</sup> /m <sup>3</sup> )	Product Type (1,2,3)	Condition (0,1,2,3)	Surface Treatment (0,1,2,3)	Asbestos Type (1,2,3)	Score	Access (IA,OA,EA)	Action (A1,A2,A3)
<b>CRAGSIDE PRIMARY SCHOOL (continued)</b>												
Reception Toilet	Yes	Ceiling - MMMF tiles	-	-	-	-	-	-	NA	-	-	-
		Walls - plasterboard	-	-	-	-	-	-	NA	-	-	-
		Boxing - wood	-	-	-	-	-	-	NA	-	-	-
		Panels to windows - wood	-	-	-	-	-	-	NA	-	-	-
		Toilet cistern - plastic and ceramic	-	-	-	-	-	-	NA	-	-	-
		Floor - modern vinyl covering over concrete	-	-	-	-	-	-	NA	-	-	-
Void Above	Yes	Roof - strawboard	-	-	-	-	-	-	NA	-	-	-
		Pipe insulation - foil covered MMMF	-	-	-	-	-	-	NA	-	-	-
Void Behind Boxing	Yes	No suspect material identified	-	-	-	-	-	-	NA	-	-	-
Hall	Yes	Ceiling - MMMF tiles	-	-	-	-	-	-	NA	-	-	-
		Panels adjacent windows - wood	-	-	-	-	-	-	NA	-	-	-
		Walls - wood panelling	-	-	-	-	-	-	NA	-	-	-
		Walls - plasterboard	-	-	-	-	-	-	NA	-	-	-
		Floor - wood	-	-	-	-	-	-	NA	-	-	-
Void Above	No	Inaccessible - due to height										

**Level of ID:** P – Presumed, SP – Strongly Presumed, ID – Identified. **Access:** IA – Inaccessible, OA – Occasionally Accessed, EA – Easily/Regularly Accessed  
**Asbestos Type:** NA – Non-Asbestos **Action:** A1 – Remove ASAP, A2 – Repair/Encapsulate ASAP, A3 – Leave Undisturbed and Monitor Situation

**Checked by: Mr. R. Brown**  
*Asbestos Manager*

**VEGA ENVIRONMENTAL CONSULTANTS LTD**

**APPENDIX A**

**ASBESTOS SURVEY - DATA RECORD SHEET - continued**

**Page 13 of 34**

**Report No:** AR/09/3388 (update 02)

**Date of survey:** 07/10/09

Area ID	Surveyed Yes/No	Location of sample point / Description of suspect material	Level of ID (P/SP/ID)	Sample ID	Extent (m/m <sup>2</sup> /m <sup>3</sup> )	Product Type (1,2,3)	Condition (0,1,2,3)	Surface Treatment (0,1,2,3)	Asbestos Type (1,2,3)	Score	Access (IA,OA,EA)	Action (A1,A2,A3)
<b>CRAGSIDE PRIMARY SCHOOL (continued)</b>												
Hall Store 1	Yes	Ceiling - wood	-	-	-	-	-	-	NA	-	-	-
		Walls - plasterboard	-	-	-	-	-	-	NA	-	-	-
		Floor - wood	-	-	-	-	-	-	NA	-	-	-
Hall Store 2	Yes	Ceiling - MMMF tiles	-	-	-	-	-	-	NA	-	-	-
		Walls - brick and wood and plasterboard	-	-	-	-	-	-	NA	-	-	-
		Floor - modern vinyl covering over concrete	-	-	-	-	-	-	NA	-	-	-
Void Above	Yes	Roof - wood	-	-	-	-	-	-	NA	-	-	-
		Pipe insulation - foil covered MMMF	-	-	-	-	-	-	NA	-	-	-
		Walls - brick	-	-	-	-	-	-	NA	-	-	-
Corridor 2	Yes	Ceiling - MMMF tiles	-	-	-	-	-	-	NA	-	-	-
		Walls - plasterboard and brick	-	-	-	-	-	-	NA	-	-	-
		Corner boxing - wood	-	-	-	-	-	-	NA	-	-	-
		Floor - modern vinyl covering over concrete	-	-	-	-	-	-	NA	-	-	-
Void Above	Yes	Roof - strawboard	-	-	-	-	-	-	NA	-	-	-

**Level of ID:** P – Presumed, SP – Strongly Presumed, ID – Identified. **Access:** IA – Inaccessible, OA – Occasionally Accessed, EA – Easily/Regularly Accessed

**Asbestos Type:** NA – Non-Asbestos **Action:** A1 – Remove ASAP, A2 – Repair/Encapsulate ASAP, A3 – Leave Undisturbed and Monitor Situation

**Checked by: Mr. R. Brown**

*Asbestos Manager*

**VEGA ENVIRONMENTAL CONSULTANTS LTD**

**APPENDIX A**

**ASBESTOS SURVEY - DATA RECORD SHEET - continued**

**Page 14 of 34**

**Report No:** AR/09/3388 (update 02)

**Date of survey:** 07/10/09

Area ID	Surveyed Yes/No	Location of sample point / Description of suspect material	Level of ID (P/SP/ID)	Sample ID	Extent (m/m <sup>2</sup> /m <sup>3</sup> )	Product Type (1,2,3)	Condition (0,1,2,3)	Surface Treatment (0,1,2,3)	Asbestos Type (1,2,3)	Score	Access (IA,OA,EA)	Action (A1,A2,A3)
<b>CRAGSIDE PRIMARY SCHOOL (continued)</b>												
Void Above (cont)	Yes	Pipe insulation - foil covered MMMF	-	-	-	-	-	-	NA	-	-	-
Community Room	Yes	Ceiling - MMMF tiles	-	-	-	-	-	-	NA	-	-	-
		Skylight upstands - wood and fibreglass	-	-	-	-	-	-	NA	-	-	-
		Walls - plasterboard	-	-	-	-	-	-	NA	-	-	-
		Sink unit - modern	-	-	-	-	-	-	NA	-	-	-
		Panel adjacent window - wood	-	-	-	-	-	-	NA	-	-	-
		Floor - modern vinyl covering over carpet over concrete and carpet over concrete	-	-	-	-	-	-	NA	-	-	-
Void Above	Yes	Roof - strawboard	-	-	-	-	-	-	NA	-	-	-
		Pipe insulation - foil covered MMMF	-	-	-	-	-	-	NA	-	-	-
Toilet	Yes	Ceiling - MMMF tiles	-	-	-	-	-	-	NA	-	-	-
		Walls - plasterboard	-	-	-	-	-	-	NA	-	-	-
		Boxing - wood	-	-	-	-	-	-	NA	-	-	-
		Toilet cistern - ceramic	-	-	-	-	-	-	NA	-	-	-
		Floor - modern vinyl covering over concrete	-	-	-	-	-	-	NA	-	-	-

**Level of ID:** P – Presumed, SP – Strongly Presumed, ID – Identified. **Access:** IA – Inaccessible, OA – Occasionally Accessed, EA – Easily/Regularly Accessed

**Asbestos Type:** NA – Non-Asbestos **Action:** A1 – Remove ASAP, A2 – Repair/Encapsulate ASAP, A3 – Leave Undisturbed and Monitor Situation

**Checked by: Mr. R. Brown**

*Asbestos Manager*

**VEGA ENVIRONMENTAL CONSULTANTS LTD**

**APPENDIX A**

**ASBESTOS SURVEY - DATA RECORD SHEET - continued**

**Page 15 of 34**

**Report No:** AR/09/3388 (update 02)

**Date of survey:** 07/10/09

Area ID	Surveyed Yes/No	Location of sample point / Description of suspect material	Level of ID (P/SP/ID)	Sample ID	Extent (m/m <sup>2</sup> /m <sup>3</sup> )	Product Type (1,2,3)	Condition (0,1,2,3)	Surface Treatment (0,1,2,3)	Asbestos Type (1,2,3)	Score	Access (IA,OA,EA)	Action (A1,A2,A3)
<b>CRAGSIDE PRIMARY SCHOOL (continued)</b>												
Void Above	Yes	Roof - strawboard	-	-	-	-	-	-	NA	-	-	-
		Pipe insulation - foil covered MMMF	-	-	-	-	-	-	NA	-	-	-
Corridor 3	Yes	Ceiling - MMMF tiles	-	-	-	-	-	-	NA	-	-	-
		Walls - plasterboard and brick	-	-	-	-	-	-	NA	-	-	-
		Corner boxing - wood	-	-	-	-	-	-	NA	-	-	-
		Floor - modern vinyl covering over concrete	-	-	-	-	-	-	NA	-	-	-
Void Above	Yes	Roof - strawboard	-	-	-	-	-	-	NA	-	-	-
		Pipe insulation - foil covered MMMF	-	-	-	-	-	-	NA	-	-	-
Upper KS2 Toilets/Cloaks	Yes	Ceiling - MMMF tiles	-	-	-	-	-	-	NA	-	-	-
		Walls - plasterboard	-	-	-	-	-	-	NA	-	-	-
		Skylight - fibreglass	-	-	-	-	-	-	NA	-	-	-
		Panels to walls - wood	-	-	-	-	-	-	NA	-	-	-
		Floor - carpet over concrete and modern vinyl covering over concrete	-	-	-	-	-	-	NA	-	-	-

**Level of ID:** P – Presumed, SP – Strongly Presumed, ID – Identified. **Access:** IA – Inaccessible, OA – Occasionally Accessed, EA – Easily/Regularly Accessed

**Asbestos Type:** NA – Non-Asbestos **Action:** A1 – Remove ASAP, A2 – Repair/Encapsulate ASAP, A3 – Leave Undisturbed and Monitor Situation

**Checked by: Mr. R. Brown**  
*Asbestos Manager*

**VEGA ENVIRONMENTAL CONSULTANTS LTD**

**APPENDIX A**

**ASBESTOS SURVEY - DATA RECORD SHEET - continued**

**Page 16 of 34**

**Report No:** AR/09/3388 (update 02)

**Date of survey:** 07/10/09

Area ID	Surveyed Yes/No	Location of sample point / Description of suspect material	Level of ID (P/SP/ID)	Sample ID	Extent (m/m <sup>2</sup> /m <sup>3</sup> )	Product Type (1,2,3)	Condition (0,1,2,3)	Surface Treatment (0,1,2,3)	Asbestos Type (1,2,3)	Score	Access (IA,OA,EA)	Action (A1,A2,A3)
<b>CRAGSIDE PRIMARY SCHOOL (continued)</b>												
Boys Toilet 1	Yes	Ceiling - MMMF tiles Walls - plasterboard Boxing - wood Toilet cistern - plastic and ceramic Floor - modern vinyl covering over concrete	- - - - -	- - - - -	- - - - -	- - - - -	- - - - -	- - - - -	NA NA NA NA NA	- - - - -	- - - - -	- - - - -
Void Above	Yes	Roof - strawboard Pipe insulation - foil covered MMMF	- -	- -	- -	- -	- -	- -	NA NA	- -	- -	- -
Void Behind Boxing	Yes	No suspect material identified	-	-	-	-	-	-	NA	-	-	-
Girls Toilet 1	Yes	Ceiling - MMMF tiles Walls - plasterboard Boxing - wood Toilet cistern - ceramic Floor - modern vinyl covering over concrete	- - - - -	- - - - -	- - - - -	- - - - -	- - - - -	- - - - -	NA NA NA NA NA	- - - - -	- - - - -	- - - - -
Void Above	Yes	Roof - strawboard	-	-	-	-	-	-	NA	-	-	-

**Level of ID:** P – Presumed, SP – Strongly Presumed, ID – Identified. **Access:** IA – Inaccessible, OA – Occasionally Accessed, EA – Easily/Regularly Accessed  
**Asbestos Type:** NA – Non-Asbestos **Action:** A1 – Remove ASAP, A2 – Repair/Encapsulate ASAP, A3 – Leave Undisturbed and Monitor Situation

**Checked by: Mr. R. Brown**  
*Asbestos Manager*

**VEGA ENVIRONMENTAL CONSULTANTS LTD**

**APPENDIX A**

**ASBESTOS SURVEY - DATA RECORD SHEET - continued**

**Page 17 of 34**

**Report No:** AR/09/3388 (update 02)

**Date of survey:** 07/10/09

Area ID	Surveyed Yes/No	Location of sample point / Description of suspect material	Level of ID (P/SP/ID)	Sample ID	Extent (m/m <sup>2</sup> /m <sup>3</sup> )	Product Type (1,2,3)	Condition (0,1,2,3)	Surface Treatment (0,1,2,3)	Asbestos Type (1,2,3)	Score	Access (IA,OA,EA)	Action (A1,A2,A3)
<b>CRAGSIDE PRIMARY SCHOOL (continued)</b>												
Void Above (cont)	Yes	Pipe insulation - foil covered MMMF	-	-	-	-	-	-	NA	-	-	-
Void Behind Boxing	Yes	No suspect material identified	-	-	-	-	-	-	NA	-	-	-
Disabled Toilet 1	Yes	Ceiling - MMMF tiles	-	-	-	-	-	-	NA	-	-	-
		Walls - plasterboard	-	-	-	-	-	-	NA	-	-	-
		Boxing - wood	-	-	-	-	-	-	NA	-	-	-
		Toilet cistern - ceramic	-	-	-	-	-	-	NA	-	-	-
		Floor - modern vinyl covering over concrete	-	-	-	-	-	-	NA	-	-	-
Void Above	Yes	Roof - strawboard	-	-	-	-	-	-	NA	-	-	-
		Pipe insulation - foil covered MMMF	-	-	-	-	-	-	NA	-	-	-
Void Behind Boxing	Yes	No suspect material identified	-	-	-	-	-	-	NA	-	-	-
Corridor 4	Yes	Roof - plastic	-	-	-	-	-	-	NA	-	-	-
		Walls - plasterboard and wood	-	-	-	-	-	-	NA	-	-	-

**Level of ID:** P – Presumed, SP – Strongly Presumed, ID – Identified. **Access:** IA – Inaccessible, OA – Occasionally Accessed, EA – Easily/Regularly Accessed

**Asbestos Type:** NA – Non-Asbestos **Action:** A1 – Remove ASAP, A2 – Repair/Encapsulate ASAP, A3 – Leave Undisturbed and Monitor Situation

**Checked by: Mr. R. Brown**  
*Asbestos Manager*

**VEGA ENVIRONMENTAL CONSULTANTS LTD**

**APPENDIX A**

**ASBESTOS SURVEY - DATA RECORD SHEET - continued**

**Page 18 of 34**

**Report No:** AR/09/3388 (update 02)

**Date of survey:** 07/10/09

Area ID	Surveyed Yes/No	Location of sample point / Description of suspect material	Level of ID (P/SP/ID)	Sample ID	Extent (m/m <sup>2</sup> /m <sup>3</sup> )	Product Type (1,2,3)	Condition (0,1,2,3)	Surface Treatment (0,1,2,3)	Asbestos Type (1,2,3)	Score	Access (IA,OA,EA)	Action (A1,A2,A3)
<b>CRAGSIDE PRIMARY SCHOOL (continued)</b>												
Corridor 4 (cont)	Yes	Floor - modern vinyl covering over concrete	-	-	-	-	-	-	NA	-	-	-
Practical Area	Yes	Ceiling - MMMF tiles	-	-	-	-	-	-	NA	-	-	-
		Skylights - modern	-	-	-	-	-	-	NA	-	-	-
		Walls - wood and plasterboard	-	-	-	-	-	-	NA	-	-	-
		Columns - metal	-	-	-	-	-	-	NA	-	-	-
		Floor - modern vinyl covering over concrete	-	-	-	-	-	-	NA	-	-	-
Void Above	Yes	Roof - strawboard	-	-	-	-	-	-	NA	-	-	-
		Pipe insulation - foil covered MMMF	-	-	-	-	-	-	NA	-	-	-
Server Room	Yes	Ceiling - MMMF tiles	-	-	-	-	-	-	NA	-	-	-
		Walls - plasterboard and brick	-	-	-	-	-	-	NA	-	-	-
		Electric equipment - modern	-	-	-	-	-	-	NA	-	-	-
		Panels to wall - wood	-	-	-	-	-	-	NA	-	-	-
		Floor - modern vinyl covering over concrete	-	-	-	-	-	-	NA	-	-	-
Void Above	Yes	Roof - wood	-	-	-	-	-	-	NA	-	-	-
		Walls - brick	-	-	-	-	-	-	NA	-	-	-

**Level of ID:** P – Presumed, SP – Strongly Presumed, ID – Identified. **Access:** IA – Inaccessible, OA – Occasionally Accessed, EA – Easily/Regularly Accessed

**Asbestos Type:** NA – Non-Asbestos **Action:** A1 – Remove ASAP, A2 – Repair/Encapsulate ASAP, A3 – Leave Undisturbed and Monitor Situation

**Checked by: Mr. R. Brown**

*Asbestos Manager*



**VEGA ENVIRONMENTAL CONSULTANTS LTD**

**APPENDIX A**

**ASBESTOS SURVEY - DATA RECORD SHEET - continued**

**Page 19 of 34**

**Report No:** AR/09/3388 (update 02)

**Date of survey:** 07/10/09

Area ID	Surveyed Yes/No	Location of sample point / Description of suspect material	Level of ID (P/SP/ID)	Sample ID	Extent (m/m <sup>2</sup> /m <sup>3</sup> )	Product Type (1,2,3)	Condition (0,1,2,3)	Surface Treatment (0,1,2,3)	Asbestos Type (1,2,3)	Score	Access (IA,OA,EA)	Action (A1,A2,A3)
<b>CRAGSIDE PRIMARY SCHOOL (continued)</b>												
KS1 Class Room 4	Yes	Ceiling - MMMF tiles	-	-	-	-	-	-	NA	-	-	-
		Walls - plasterboard	-	-	-	-	-	-	NA	-	-	-
		Sink unit - modern	-	-	-	-	-	-	NA	-	-	-
		Panels to windows - wood	-	-	-	-	-	-	NA	-	-	-
		Floor - modern vinyl covering over concrete and carpet over concrete	-	-	-	-	-	-	NA	-	-	-
Void Above	Yes	Roof - strawboard	-	-	-	-	-	-	NA	-	-	-
		Pipe insulation - foil covered MMMF	-	-	-	-	-	-	NA	-	-	-
ICT/Library	Yes	Ceiling - MMMF tiles	-	-	-	-	-	-	NA	-	-	-
		Walls - plasterboard and brick	-	-	-	-	-	-	NA	-	-	-
		Corner boxing - wood	-	-	-	-	-	-	NA	-	-	-
		Floor - carpet over concrete	-	-	-	-	-	-	NA	-	-	-
Void Above	Yes	Roof - strawboard	-	-	-	-	-	-	NA	-	-	-
		Pipe insulation - foil covered MMMF	-	-	-	-	-	-	NA	-	-	-
Void Above Boxing	Yes	No suspect material identified	-	-	-	-	-	-	NA	-	-	-

**Level of ID:** P – Presumed, SP – Strongly Presumed, ID – Identified. **Access:** IA – Inaccessible, OA – Occasionally Accessed, EA – Easily/Regularly Accessed  
**Asbestos Type:** NA – Non-Asbestos **Action:** A1 – Remove ASAP, A2 – Repair/Encapsulate ASAP, A3 – Leave Undisturbed and Monitor Situation

**Checked by: Mr. R. Brown**  
*Asbestos Manager*

**VEGA ENVIRONMENTAL CONSULTANTS LTD**

**APPENDIX A**

**ASBESTOS SURVEY - DATA RECORD SHEET - continued**

**Page 20 of 34**

**Report No:** AR/09/3388 (update 02)

**Date of survey:** 07/10/09

Area ID	Surveyed Yes/No	Location of sample point / Description of suspect material	Level of ID (P/SP/ID)	Sample ID	Extent (m/m <sup>2</sup> /m <sup>3</sup> )	Product Type (1,2,3)	Condition (0,1,2,3)	Surface Treatment (0,1,2,3)	Asbestos Type (1,2,3)	Score	Access (IA,OA,EA)	Action (A1,A2,A3)
<b>CRAGSIDE PRIMARY SCHOOL (continued)</b>												
KSI Class Room 3	Yes	Ceiling - MMMF tiles Walls - plasterboard Sink unit - modern Panels to windows - wood Floor - modern vinyl covering over concrete and carpet over concrete	- - - - -	- - - - -	- - - - -	- - - - -	- - - - -	- - - - -	NA NA NA NA NA	- - - - -	- - - - -	- - - - -
Void Above	Yes	Roof - strawboard Pipe insulation - foil covered MMMF	- -	- -	- -	- -	- -	- -	NA NA	- -	- -	- -
KSI Class Room 2	Yes	Ceiling - MMMF tiles Walls - plasterboard Sink unit - modern Panels to windows - wood Floor - modern vinyl covering over concrete and carpet over concrete	- - - - -	- - - - -	- - - - -	- - - - -	- - - - -	- - - - -	NA NA NA NA NA	- - - - -	- - - - -	- - - - -
Void Above	Yes	Roof - strawboard Pipe insulation - foil covered MMMF	- -	- -	- -	- -	- -	- -	NA NA	- -	- -	- -

**Level of ID:** P – Presumed, SP – Strongly Presumed, ID – Identified. **Access:** IA – Inaccessible, OA – Occasionally Accessed, EA – Easily/Regularly Accessed

**Asbestos Type:** NA – Non-Asbestos **Action:** A1 – Remove ASAP, A2 – Repair/Encapsulate ASAP, A3 – Leave Undisturbed and Monitor Situation

**Checked by: Mr. R. Brown**  
*Asbestos Manager*

**VEGA ENVIRONMENTAL CONSULTANTS LTD**

**APPENDIX A**

**ASBESTOS SURVEY - DATA RECORD SHEET - continued**

**Page 21 of 34**

**Report No:** AR/09/3388 (update 02)

**Date of survey:** 07/10/09

Area ID	Surveyed Yes/No	Location of sample point / Description of suspect material	Level of ID (P/SP/ID)	Sample ID	Extent (m/m <sup>2</sup> /m <sup>3</sup> )	Product Type (1,2,3)	Condition (0,1,2,3)	Surface Treatment (0,1,2,3)	Asbestos Type (1,2,3)	Score	Access (IA,OA,EA)	Action (A1,A2,A3)
<b>CRAGSIDE PRIMARY SCHOOL (continued)</b>												
KSI Class Room 1	Yes	Ceiling - MMMF tiles Walls - plasterboard Sink unit - modern Panels to windows - wood Floor - modern vinyl covering over concrete and carpet over concrete	- - - - -	- - - - -	- - - - -	- - - - -	- - - - -	- - - - -	NA NA NA NA NA	- - - - -	- - - - -	- - - - -
Void Above	Yes	Roof - strawboard Pipe insulation - foil covered MMMF	- -	- -	- -	- -	- -	- -	NA NA	- -	- -	- -
KS1 Toilets/Cloaks	Yes	Ceiling - MMMF tiles Walls - plasterboard Skylight - fibreglass Panels to walls - wood Floor - carpet over concrete and modern vinyl covering over concrete	- - - - -	- - - - -	- - - - -	- - - - -	- - - - -	- - - - -	NA NA NA NA NA	- - - - -	- - - - -	- - - - -
Girls Toilet 2	Yes	Ceiling - MMMF tiles Walls - plasterboard Boxing - wood	- - -	- - -	- - -	- - -	- - -	- - -	NA NA NA	- - -	- - -	- - -

**Level of ID:** P – Presumed, SP – Strongly Presumed, ID – Identified. **Access:** IA – Inaccessible, OA – Occasionally Accessed, EA – Easily/Regularly Accessed

**Asbestos Type:** NA – Non-Asbestos **Action:** A1 – Remove ASAP, A2 – Repair/Encapsulate ASAP, A3 – Leave Undisturbed and Monitor Situation

**Checked by: Mr. R. Brown**  
*Asbestos Manager*

**VEGA ENVIRONMENTAL CONSULTANTS LTD**

**APPENDIX A**

**ASBESTOS SURVEY - DATA RECORD SHEET - continued**

**Page 22 of 34**

**Report No:** AR/09/3388 (update 02)

**Date of survey:** 07/10/09

Area ID	Surveyed Yes/No	Location of sample point / Description of suspect material	Level of ID (P/SP/ID)	Sample ID	Extent (m/m <sup>2</sup> /m <sup>3</sup> )	Product Type (1,2,3)	Condition (0,1,2,3)	Surface Treatment (0,1,2,3)	Asbestos Type (1,2,3)	Score	Access (IA,OA,EA)	Action (A1,A2,A3)
<b>CRAGSIDE PRIMARY SCHOOL (continued)</b>												
Girls Toilet 2 (cont)	Yes	Toilet cistern - ceramic Floor - modern vinyl covering over concrete	-	-	-	-	-	-	NA	-	-	-
			-	-	-	-	-	-	NA	-	-	-
Void Above	Yes	Roof - strawboard	-	-	-	-	-	-	NA	-	-	-
Void Behind Boxing	Yes	No suspect material identified	-	-	-	-	-	-	NA	-	-	-
Boys Toilet 2	Yes	Ceiling - MMMF tiles	-	-	-	-	-	-	NA	-	-	-
		Walls - plasterboard	-	-	-	-	-	-	NA	-	-	-
		Boxing - wood	-	-	-	-	-	-	NA	-	-	-
		Toilet cistern - plastic and ceramic	-	-	-	-	-	-	NA	-	-	-
		Floor - modern vinyl covering over concrete	-	-	-	-	-	-	NA	-	-	-
Void Above	Yes	Roof - strawboard	-	-	-	-	-	-	NA	-	-	-
		Pipe insulation - foil covered MMMF	-	-	-	-	-	-	NA	-	-	-

**Level of ID:** P – Presumed, SP – Strongly Presumed, ID – Identified. **Access:** IA – Inaccessible, OA – Occasionally Accessed, EA – Easily/Regularly Accessed

**Asbestos Type:** NA – Non-Asbestos **Action:** A1 – Remove ASAP, A2 – Repair/Encapsulate ASAP, A3 – Leave Undisturbed and Monitor Situation

**Checked by: Mr. R. Brown**

*Asbestos Manager*

**VEGA ENVIRONMENTAL CONSULTANTS LTD**

**APPENDIX A**

**ASBESTOS SURVEY - DATA RECORD SHEET - continued**

**Page 23 of 34**

**Report No:** AR/09/3388 (update 02)

**Date of survey:** 07/10/09

Area ID	Surveyed Yes/No	Location of sample point / Description of suspect material	Level of ID (P/SP/ID)	Sample ID	Extent (m/m <sup>2</sup> /m <sup>3</sup> )	Product Type (1,2,3)	Condition (0,1,2,3)	Surface Treatment (0,1,2,3)	Asbestos Type (1,2,3)	Score	Access (IA,OA,EA)	Action (A1,A2,A3)
<b>CRAGSIDE PRIMARY SCHOOL (continued)</b>												
Void Behind Boxing	Yes	No suspect material identified	-	-	-	-	-	-	NA	-	-	-
Lower KS2 Class Room 1	Yes	Ceiling - MMMF tiles	-	-	-	-	-	-	NA	-	-	-
		Walls - plasterboard	-	-	-	-	-	-	NA	-	-	-
		Sink unit - modern	-	-	-	-	-	-	NA	-	-	-
		Panels to windows - wood	-	-	-	-	-	-	NA	-	-	-
		Floor - modern vinyl covering over concrete and carpet over concrete	-	-	-	-	-	-	NA	-	-	-
Void Above	Yes	Roof - strawboard	-	-	-	-	-	-	NA	-	-	-
		Pipe insulation - foil covered MMMF	-	-	-	-	-	-	NA	-	-	-
Corridor 5	Yes	Roof - plastic	-	-	-	-	-	-	NA	-	-	-
		Walls - plasterboard and wood	-	-	-	-	-	-	NA	-	-	-
		Floor - modern vinyl covering over concrete	-	-	-	-	-	-	NA	-	-	-
Corridor 6	Yes	Ceiling - MMMF tiles	-	-	-	-	-	-	NA	-	-	-
		Walls - plasterboard and brick	-	-	-	-	-	-	NA	-	-	-

**Level of ID:** P – Presumed, SP – Strongly Presumed, ID – Identified. **Access:** IA – Inaccessible, OA – Occasionally Accessed, EA – Easily/Regularly Accessed

**Asbestos Type:** NA – Non-Asbestos **Action:** A1 – Remove ASAP, A2 – Repair/Encapsulate ASAP, A3 – Leave Undisturbed and Monitor Situation

**Checked by: Mr. R. Brown**

*Asbestos Manager*

**VEGA ENVIRONMENTAL CONSULTANTS LTD**

**APPENDIX A**

**ASBESTOS SURVEY - DATA RECORD SHEET - continued**

**Page 24 of 34**

**Report No:** AR/09/3388 (update 02)

**Date of survey:** 07/10/09

Area ID	Surveyed Yes/No	Location of sample point / Description of suspect material	Level of ID (P/SP/ID)	Sample ID	Extent (m/m <sup>2</sup> /m <sup>3</sup> )	Product Type (1,2,3)	Condition (0,1,2,3)	Surface Treatment (0,1,2,3)	Asbestos Type (1,2,3)	Score	Access (IA,OA,EA)	Action (A1,A2,A3)
<b>CRAGSIDE PRIMARY SCHOOL (continued)</b>												
Corridor 6 (cont)	Yes	Corner boxing - wood Floor - modern vinyl covering over concrete	- -	- -	- -	- -	- -	- -	NA NA	- -	- -	- -
Void Above	Yes	Roof - strawboard Pipe insulation - foil covered MMMF	- -	- -	- -	- -	- -	- -	NA NA	- -	- -	- -
Lower KS2 Class Room 3	Yes	Ceiling - MMMF tiles Walls - plasterboard Sink unit - modern Panels to windows - wood Floor - modern vinyl covering over concrete and carpet over concrete	- - - - -	- - - - -	- - - - -	- - - - -	- - - - -	- - - - -	NA NA NA NA NA	- - - - -	- - - - -	- - - - -
Void Above	Yes	Roof - strawboard Pipe insulation - foil covered MMMF	- -	- -	- -	- -	- -	- -	NA NA	- -	- -	- -
Lower KS2 Class Room 2	Yes	Ceiling - MMMF tiles Walls - plasterboard Sink unit - modern	- - -	- - -	- - -	- - -	- - -	- - -	NA NA NA	- - -	- - -	- - -

**Level of ID:** P – Presumed, SP – Strongly Presumed, ID – Identified. **Access:** IA – Inaccessible, OA – Occasionally Accessed, EA – Easily/Regularly Accessed  
**Asbestos Type:** NA – Non-Asbestos **Action:** A1 – Remove ASAP, A2 – Repair/Encapsulate ASAP, A3 – Leave Undisturbed and Monitor Situation

**Checked by: Mr. R. Brown**  
*Asbestos Manager*

**VEGA ENVIRONMENTAL CONSULTANTS LTD**

**APPENDIX A**

**ASBESTOS SURVEY - DATA RECORD SHEET - continued**

**Page 25 of 34**

**Report No:** AR/09/3388 (update 02)

**Date of survey:** 07/10/09

Area ID	Surveyed Yes/No	Location of sample point / Description of suspect material	Level of ID (P/SP/ID)	Sample ID	Extent (m/m <sup>2</sup> /m <sup>3</sup> )	Product Type (1,2,3)	Condition (0,1,2,3)	Surface Treatment (0,1,2,3)	Asbestos Type (1,2,3)	Score	Access (IA,OA,EA)	Action (A1,A2,A3)
<b>CRAGSIDE PRIMARY SCHOOL (continued)</b>												
Lower KS2 Class Room 2 (cont)	Yes	Panels to windows - wood	-	-	-	-	-	-	NA	-	-	-
		Floor - modern vinyl covering over concrete and carpet over concrete	-	-	-	-	-	-	NA	-	-	-
Void Above	Yes	Roof - strawboard	-	-	-	-	-	-	NA	-	-	-
		Pipe insulation - foil covered MMMF	-	-	-	-	-	-	NA	-	-	-
Lower KS2 Cloaks/Toilets	Yes	Ceiling - MMMF tiles	-	-	-	-	-	-	NA	-	-	-
		Walls - plasterboard	-	-	-	-	-	-	NA	-	-	-
		Skylight - fibreglass	-	-	-	-	-	-	NA	-	-	-
		Panels to walls - wood	-	-	-	-	-	-	NA	-	-	-
		Floor - carpet over concrete and modern vinyl covering over concrete	-	-	-	-	-	-	NA	-	-	-
Girls Toilet 3	Yes	Ceiling - MMMF tiles	-	-	-	-	-	-	NA	-	-	-
		Walls - plasterboard	-	-	-	-	-	-	NA	-	-	-
		Boxing - wood	-	-	-	-	-	-	NA	-	-	-
		Toilet cistern - ceramic	-	-	-	-	-	-	NA	-	-	-
		Floor - modern vinyl covering over concrete	-	-	-	-	-	-	NA	-	-	-

**Level of ID:** P – Presumed, SP – Strongly Presumed, ID – Identified. **Access:** IA – Inaccessible, OA – Occasionally Accessed, EA – Easily/Regularly Accessed

**Asbestos Type:** NA – Non-Asbestos **Action:** A1 – Remove ASAP, A2 – Repair/Encapsulate ASAP, A3 – Leave Undisturbed and Monitor Situation

**Checked by: Mr. R. Brown**

*Asbestos Manager*



**VEGA ENVIRONMENTAL CONSULTANTS LTD**

**APPENDIX A**

**ASBESTOS SURVEY - DATA RECORD SHEET - continued**

**Page 26 of 34**

**Report No:** AR/09/3388 (update 02)

**Date of survey:** 07/10/09

Area ID	Surveyed Yes/No	Location of sample point / Description of suspect material	Level of ID (P/SP/ID)	Sample ID	Extent (m/m <sup>2</sup> /m <sup>3</sup> )	Product Type (1,2,3)	Condition (0,1,2,3)	Surface Treatment (0,1,2,3)	Asbestos Type (1,2,3)	Score	Access (IA,OA,EA)	Action (A1,A2,A3)
<b>CRAGSIDE PRIMARY SCHOOL (continued)</b>												
Void Above	Yes	Roof - strawboard	-	-	-	-	-	-	NA	-	-	-
		Pipe insulation - foil covered MMMF	-	-	-	-	-	-	NA	-	-	-
Void Behind Boxing	Yes	No suspect material identified	-	-	-	-	-	-	NA	-	-	-
Boys Toilet 3	Yes	Ceiling - MMMF tiles	-	-	-	-	-	-	NA	-	-	-
		Walls - plasterboard	-	-	-	-	-	-	NA	-	-	-
		Boxing - wood	-	-	-	-	-	-	NA	-	-	-
		Toilet cistern - plastic and ceramic	-	-	-	-	-	-	NA	-	-	-
		Floor - modern vinyl covering over concrete	-	-	-	-	-	-	NA	-	-	-
Void Above	Yes	Roof - strawboard	-	-	-	-	-	-	NA	-	-	-
		Pipe insulation - foil covered MMMF	-	-	-	-	-	-	NA	-	-	-
Void Behind Boxing	Yes	No suspect material identified	-	-	-	-	-	-	NA	-	-	-

**Level of ID:** P – Presumed, SP – Strongly Presumed, ID – Identified. **Access:** IA – Inaccessible, OA – Occasionally Accessed, EA – Easily/Regularly Accessed

**Asbestos Type:** NA – Non-Asbestos **Action:** A1 – Remove ASAP, A2 – Repair/Encapsulate ASAP, A3 – Leave Undisturbed and Monitor Situation

**Checked by: Mr. R. Brown**

*Asbestos Manager*

**VEGA ENVIRONMENTAL CONSULTANTS LTD**

**APPENDIX A**

**ASBESTOS SURVEY - DATA RECORD SHEET - continued**

**Page 27 of 34**

**Report No:** AR/09/3388 (update 02)

**Date of survey:** 07/10/09

Area ID	Surveyed Yes/No	Location of sample point / Description of suspect material	Level of ID (P/SP/ID)	Sample ID	Extent (m/m <sup>2</sup> /m <sup>3</sup> )	Product Type (1,2,3)	Condition (0,1,2,3)	Surface Treatment (0,1,2,3)	Asbestos Type (1,2,3)	Score	Access (IA,OA,EA)	Action (A1,A2,A3)
<b>CRAGSIDE PRIMARY SCHOOL (continued)</b>												
Lower KS2 Class Room 4	Yes	Ceiling - MMMF tiles Walls - plasterboard Sink unit - modern Panels to windows - wood Floor - modern vinyl covering over concrete and carpet over concrete	- - - - -	- - - - -	- - - - -	- - - - -	- - - - -	- - - - -	NA NA NA NA NA	- - - - -	- - - - -	- - - - -
Void Above	Yes	Roof - strawboard Pipe insulation - foil covered MMMF	- -	- -	- -	- -	- -	- -	NA NA	- -	- -	- -
Store 2	Yes	Ceiling - MMMF tiles Walls - plasterboard Panels to window - wood and plasterboard Floor - carpet over concrete	- - - -	- - - -	- - - -	- - - -	- - - -	- - - -	NA NA NA NA	- - - -	- - - -	- - - -
Void Above	Yes	No suspect material identified	-	-	-	-	-	-	NA	-	-	-
Sen Room	Yes	Ceiling - MMMF tiles Walls - plasterboard	- -	- -	- -	- -	- -	- -	NA NA	- -	- -	- -

**Level of ID:** P – Presumed, SP – Strongly Presumed, ID – Identified. **Access:** IA – Inaccessible, OA – Occasionally Accessed, EA – Easily/Regularly Accessed

**Asbestos Type:** NA – Non-Asbestos **Action:** A1 – Remove ASAP, A2 – Repair/Encapsulate ASAP, A3 – Leave Undisturbed and Monitor Situation

**Checked by: Mr. R. Brown**

*Asbestos Manager*

**VEGA ENVIRONMENTAL CONSULTANTS LTD**

**APPENDIX A**

**ASBESTOS SURVEY - DATA RECORD SHEET - continued**

**Page 28 of 34**

**Report No:** AR/09/3388 (update 02)

**Date of survey:** 07/10/09

Area ID	Surveyed Yes/No	Location of sample point / Description of suspect material	Level of ID (P/SP/ID)	Sample ID	Extent (m/m <sup>2</sup> /m <sup>3</sup> )	Product Type (1,2,3)	Condition (0,1,2,3)	Surface Treatment (0,1,2,3)	Asbestos Type (1,2,3)	Score	Access (IA,OA,EA)	Action (A1,A2,A3)
<b>CRAGSIDE PRIMARY SCHOOL (continued)</b>												
Sen Room (cont)	Yes	Panels to window - wood and plasterboard	-	-	-	-	-	-	NA	-	-	-
		Floor - carpet over concrete	-	-	-	-	-	-	NA	-	-	-
Void Above	Yes	No suspect material identified	-	-	-	-	-	-	NA	-	-	-
Upper KS2 Class Room 5	Yes	Ceiling - MMMF tiles	-	-	-	-	-	-	NA	-	-	-
		Walls - plasterboard	-	-	-	-	-	-	NA	-	-	-
		Sink unit - modern	-	-	-	-	-	-	NA	-	-	-
		Panels to windows - wood	-	-	-	-	-	-	NA	-	-	-
		Floor - modern vinyl covering over concrete and carpet over concrete	-	-	-	-	-	-	NA	-	-	-
Void Above	Yes	Roof - strawboard	-	-	-	-	-	-	NA	-	-	-
		Pipe insulation - foil covered MMMF	-	-	-	-	-	-	NA	-	-	-
Resource/Quiet Room	Yes	Ceiling - MMMF tiles	-	-	-	-	-	-	NA	-	-	-
		Walls - plasterboard	-	-	-	-	-	-	NA	-	-	-
		Panels to window - wood and plasterboard	-	-	-	-	-	-	NA	-	-	-
		Floor - carpet over concrete	-	-	-	-	-	-	NA	-	-	-

**Level of ID:** P – Presumed, SP – Strongly Presumed, ID – Identified. **Access:** IA – Inaccessible, OA – Occasionally Accessed, EA – Easily/Regularly Accessed

**Asbestos Type:** NA – Non-Asbestos **Action:** A1 – Remove ASAP, A2 – Repair/Encapsulate ASAP, A3 – Leave Undisturbed and Monitor Situation

**Checked by: Mr. R. Brown**

*Asbestos Manager*

**VEGA ENVIRONMENTAL CONSULTANTS LTD**

**APPENDIX A**

**ASBESTOS SURVEY - DATA RECORD SHEET - continued**

**Page 29 of 34**

**Report No:** AR/09/3388 (update 02)

**Date of survey:** 07/10/09

Area ID	Surveyed Yes/No	Location of sample point / Description of suspect material	Level of ID (P/SP/ID)	Sample ID	Extent (m/m <sup>2</sup> /m <sup>3</sup> )	Product Type (1,2,3)	Condition (0,1,2,3)	Surface Treatment (0,1,2,3)	Asbestos Type (1,2,3)	Score	Access (IA,OA,EA)	Action (A1,A2,A3)
<b>CRAGSIDE PRIMARY SCHOOL (continued)</b>												
Void Above	Yes	No suspect material identified	-	-	-	-	-	-	NA	-	-	-
Upper KS2 Class Room 6	Yes	Ceiling - MMMF tiles	-	-	-	-	-	-	NA	-	-	-
		Walls - plasterboard	-	-	-	-	-	-	NA	-	-	-
		Sink unit - modern	-	-	-	-	-	-	NA	-	-	-
		Panels to windows - wood	-	-	-	-	-	-	NA	-	-	-
		Floor - modern vinyl covering over concrete and carpet over concrete	-	-	-	-	-	-	NA	-	-	-
Void Above	Yes	Roof - strawboard	-	-	-	-	-	-	NA	-	-	-
		Pipe insulation - foil covered MMMF	-	-	-	-	-	-	NA	-	-	-
Deputy Head	Yes	Ceiling - MMMF tiles	-	-	-	-	-	-	NA	-	-	-
		Walls - plasterboard	-	-	-	-	-	-	NA	-	-	-
		Panels to window - wood and plasterboard	-	-	-	-	-	-	NA	-	-	-
		Floor - carpet over concrete	-	-	-	-	-	-	NA	-	-	-
Void Above	Yes	No suspect material identified	-	-	-	-	-	-	NA	-	-	-

**Level of ID:** P – Presumed, SP – Strongly Presumed, ID – Identified. **Access:** IA – Inaccessible, OA – Occasionally Accessed, EA – Easily/Regularly Accessed

**Asbestos Type:** NA – Non-Asbestos **Action:** A1 – Remove ASAP, A2 – Repair/Encapsulate ASAP, A3 – Leave Undisturbed and Monitor Situation

**Checked by: Mr. R. Brown**  
*Asbestos Manager*

**VEGA ENVIRONMENTAL CONSULTANTS LTD**

**APPENDIX A**

**ASBESTOS SURVEY - DATA RECORD SHEET - continued**

**Page 30 of 34**

**Report No:** AR/09/3388 (update 02)

**Date of survey:** 07/10/09

Area ID	Surveyed Yes/No	Location of sample point / Description of suspect material	Level of ID (P/SP/ID)	Sample ID	Extent (m/m <sup>2</sup> /m <sup>3</sup> )	Product Type (1,2,3)	Condition (0,1,2,3)	Surface Treatment (0,1,2,3)	Asbestos Type (1,2,3)	Score	Access (IA,OA,EA)	Action (A1,A2,A3)
<b>CRAGSIDE PRIMARY SCHOOL (continued)</b>												
Upper KS2 Class Room 7	Yes	Ceiling - MMMF tiles Walls - plasterboard Sink unit - modern Panels to windows - wood Floor - modern vinyl covering over concrete and carpet over concrete	- - - - -	- - - - -	- - - - -	- - - - -	- - - - -	- - - - -	NA NA NA NA NA	- - - - -	- - - - -	- - - - -
Void Above	Yes	Roof - strawboard Pipe insulation - foil covered MMMF	- -	- -	- -	- -	- -	- -	NA NA	- -	- -	- -
Upper KS2 Class Room 8	Yes	Ceiling - MMMF tiles Walls - plasterboard Sink unit - modern Panels to windows - wood Floor - modern vinyl covering over concrete and carpet over concrete	- - - - -	- - - - -	- - - - -	- - - - -	- - - - -	- - - - -	NA NA NA NA NA	- - - - -	- - - - -	- - - - -
Void Above	Yes	Roof - strawboard Pipe insulation - foil covered MMMF	- -	- -	- -	- -	- -	- -	NA NA	- -	- -	- -

**Level of ID:** P – Presumed, SP – Strongly Presumed, ID – Identified. **Access:** IA – Inaccessible, OA – Occasionally Accessed, EA – Easily/Regularly Accessed

**Asbestos Type:** NA – Non-Asbestos **Action:** A1 – Remove ASAP, A2 – Repair/Encapsulate ASAP, A3 – Leave Undisturbed and Monitor Situation

**Checked by: Mr. R. Brown**  
*Asbestos Manager*

**VEGA ENVIRONMENTAL CONSULTANTS LTD**

**APPENDIX A**

**ASBESTOS SURVEY - DATA RECORD SHEET - continued**

**Page 31 of 34**

**Report No:** AR/09/3388 (update 02)

**Date of survey:** 07/10/09

Area ID	Surveyed Yes/No	Location of sample point / Description of suspect material	Level of ID (P/SP/ID)	Sample ID	Extent (m/m <sup>2</sup> /m <sup>3</sup> )	Product Type (1,2,3)	Condition (0,1,2,3)	Surface Treatment (0,1,2,3)	Asbestos Type (1,2,3)	Score	Access (IA,OA,EA)	Action (A1,A2,A3)
<b>CRAGSIDE PRIMARY SCHOOL (continued)</b>												
Kitchen	Yes	Ceiling - MMMF tiles Walls - plaster over brick and plasterboard Skylight upstands - fibreglass and wood Panels to window - PVC Coating to sink bottoms - modern Roller shutter - modern Floor - modern vinyl covering over concrete	- - - - - - -	- - - - - - -	- - - - - - -	- - - - - - -	- - - - - - -	- - - - - - -	NA NA NA NA NA NA NA	- - - - - - -	- - - - - - -	- - - - - - -
Void Above	Yes	Roof - Strawboard Pipe insulation - foil covered MMMF	- -	- -	- -	- -	- -	- -	NA NA	- -	- -	- -
Larder	Yes	Ceiling - MMMF tiles Walls - plasterboard Panels and windows - PVC Floor - modern vinyl covering over concrete	- - - -	- - - -	- - - -	- - - -	- - - -	- - - -	NA NA NA NA	- - - -	- - - -	- - - -
Void Above	Yes	Roof - Strawboard	-	-	-	-	-	-	NA	-	-	-

**Level of ID:** P – Presumed, SP – Strongly Presumed, ID – Identified. **Access:** IA – Inaccessible, OA – Occasionally Accessed, EA – Easily/Regularly Accessed

**Asbestos Type:** NA – Non-Asbestos **Action:** A1 – Remove ASAP, A2 – Repair/Encapsulate ASAP, A3 – Leave Undisturbed and Monitor Situation

**Checked by: Mr. R. Brown**  
*Asbestos Manager*

**VEGA ENVIRONMENTAL CONSULTANTS LTD**

**APPENDIX A**

**ASBESTOS SURVEY - DATA RECORD SHEET - continued**

**Page 32 of 34**

**Report No:** AR/09/3388 (update 02)

**Date of survey:** 07/10/09

Area ID	Surveyed Yes/No	Location of sample point / Description of suspect material	Level of ID (P/SP/ID)	Sample ID	Extent (m/m <sup>2</sup> /m <sup>3</sup> )	Product Type (1,2,3)	Condition (0,1,2,3)	Surface Treatment (0,1,2,3)	Asbestos Type (1,2,3)	Score	Access (IA,OA,EA)	Action (A1,A2,A3)
<b>CRAGSIDE PRIMARY SCHOOL (continued)</b>												
Void Above (cont)	Yes	Pipe insulation - foil covered MMMF	-	-	-	-	-	-	NA	-	-	-
Store 1	Yes	Ceiling - MMMF tiles	-	-	-	-	-	-	NA	-	-	-
		Walls - plasterboard	-	-	-	-	-	-	NA	-	-	-
		Panels and windows - PVC	-	-	-	-	-	-	NA	-	-	-
		Floor - modern vinyl covering over concrete	-	-	-	-	-	-	NA	-	-	-
Void Above	Yes	Roof - Strawboard	-	-	-	-	-	-	NA	-	-	-
		Pipe insulation - foil covered MMMF	-	-	-	-	-	-	NA	-	-	-
Kitchen Staff Room & Toilet	Yes	Ceiling - MMMF tiles	-	-	-	-	-	-	NA	-	-	-
		Skylight upstands - fibreglass and wood	-	-	-	-	-	-	NA	-	-	-
		Walls - plasterboard	-	-	-	-	-	-	NA	-	-	-
		Toilet cistern - ceramic	-	-	-	-	-	-	NA	-	-	-
		Floor - modern vinyl floor tiles over concrete	-	-	-	-	-	-	NA	-	-	-
Void Above	Yes	Roof - Strawboard	-	-	-	-	-	-	NA	-	-	-

**Level of ID:** P – Presumed, SP – Strongly Presumed, ID – Identified. **Access:** IA – Inaccessible, OA – Occasionally Accessed, EA – Easily/Regularly Accessed

**Asbestos Type:** NA – Non-Asbestos **Action:** A1 – Remove ASAP, A2 – Repair/Encapsulate ASAP, A3 – Leave Undisturbed and Monitor Situation

**Checked by: Mr. R. Brown**

*Asbestos Manager*

**VEGA ENVIRONMENTAL CONSULTANTS LTD**

**APPENDIX A**

**ASBESTOS SURVEY - DATA RECORD SHEET - continued**

**Page 33 of 34**

**Report No:** AR/09/3388 (update 02)

**Date of survey:** 07/10/09

Area ID	Surveyed Yes/No	Location of sample point / Description of suspect material	Level of ID (P/SP/ID)	Sample ID	Extent (m/m <sup>2</sup> /m <sup>3</sup> )	Product Type (1,2,3)	Condition (0,1,2,3)	Surface Treatment (0,1,2,3)	Asbestos Type (1,2,3)	Score	Access (IA,OA,EA)	Action (A1,A2,A3)
<b>CRAGSIDE PRIMARY SCHOOL (continued)</b>												
Void Above (cont)	Yes	Pipe insulation - foil covered MMMF	-	-	-	-	-	-	NA	-	-	-
<b>EXTERNAL BUILDINGS</b>												
Boiler Room	Yes	Ceiling - strawboard	-	-	-	-	-	-	NA	-	-	-
		<i>Residual debris to roof joists</i>	<i>SP</i>	<i>As BS/02</i>	<i>49m<sup>2</sup></i>	<i>2</i>	<i>3</i>	<i>2</i>	<i>2</i>	<i>9</i>	<b>REMOVED FEB 2010</b>	
		Pipe insulation - foil covered MMMF	-	-	-	-	-	-	NA	-	-	-
		Flange gaskets - modern	-	-	-	-	-	-	NA	-	-	-
		Boiler and flue - modern	-	-	-	-	-	-	NA	-	-	-
		Calorifier tank - modern	-	-	-	-	-	-	NA	-	-	-
		Walls - brick	-	-	-	-	-	-	NA	-	-	-
		Floor - concrete	-	-	-	-	-	-	NA	-	-	-
Tank Room	Yes	Roof - strawboard	-	-	-	-	-	-	NA	-	-	-
		<i>Residual debris to roof joists</i>	<i>SP</i>	<i>As BS/02</i>	<i>14m<sup>2</sup></i>	<i>2</i>	<i>3</i>	<i>2</i>	<i>2</i>	<i>9</i>	<b>REMOVED FEB 2010</b>	
		Walls - brick	-	-	-	-	-	-	NA	-	-	-
		Pipe and tank - metal	-	-	-	-	-	-	NA	-	-	-
		Flange gaskets	-	-	-	-	-	-	NA	-	-	-
		<i>Debris to floor - AIB</i>	<i>ID</i>	<i>BS/02</i>	<i>14m<sup>2</sup></i>	<i>2</i>	<i>3</i>	<i>2</i>	<i>2</i>	<i>9</i>	<b>REMOVED FEB 2010</b>	
		Floor - concrete	-	-	-	-	-	-	NA	-	-	-

**Level of ID:** P – Presumed, SP – Strongly Presumed, ID – Identified. **Access:** IA – Inaccessible, OA – Occasionally Accessed, EA – Easily/Regularly Accessed

**Asbestos Type:** NA – Non-Asbestos **Action:** A1 – Remove ASAP, A2 – Repair/Encapsulate ASAP, A3 – Leave Undisturbed and Monitor Situation

**Checked by: Mr. R. Brown**

*Asbestos Manager*



**VEGA ENVIRONMENTAL CONSULTANTS LTD**

**APPENDIX A**

**ASBESTOS SURVEY - DATA RECORD SHEET - continued**

**Page 34 of 34**

**Report No:** AR/09/3388 (update 02)

**Date of survey:** 07/10/09

Area ID	Surveyed Yes/No	Location of sample point / Description of suspect material	Level of ID (P/SP/ID)	Sample ID	Extent (m/m <sup>2</sup> /m <sup>3</sup> )	Product Type (1,2,3)	Condition (0,1,2,3)	Surface Treatment (0,1,2,3)	Asbestos Type (1,2,3)	Score	Access (IA,OA,EA)	Action (A1,A2,A3)
EXTERNAL BUILDINGS (continued)												
Gas Cupboard	Yes	Ceiling - concrete	-	-	-	-	-	-	NA	-	-	-
		Pipe work - metal	-	-	-	-	-	-	NA	-	-	-
		<i>Pipe flange gasket (various locations)</i>	<i>ID</i>	<i>BS/03</i>	<i>&lt;0.5m<sup>2</sup></i>	<i>1</i>	<i>0</i>	<i>0</i>	<i>1</i>	<i>2</i>	<i>EA</i>	<i>A3</i>
		Walls - brick	-	-	-	-	-	-	NA	-	-	-
		Floor - concrete	-	-	-	-	-	-	NA	-	-	-
EXTERIOR												
Exterior	Yes	Roof - felt (modern)	-	-	-	-	-	-	NA	-	-	-
		Fascias - wood	-	-	-	-	-	-	NA	-	-	-
		Panels to kitchen canopy - wood	-	-	-	-	-	-	NA	-	-	-
		Walls - brick	-	-	-	-	-	-	NA	-	-	-
		<i>Damp proof course</i>	<i>ID</i>	<i>BS/04</i>	<i>210m</i>	<i>1</i>	<i>0</i>	<i>0</i>	<i>1</i>	<i>2</i>	<i>OA</i>	<i>A3</i>

**Level of ID:** P – Presumed, SP – Strongly Presumed, ID – Identified. **Access:** IA – Inaccessible, OA – Occasionally Accessed, EA – Easily/Regularly Accessed

**Asbestos Type:** NA – Non-Asbestos **Action:** A1 – Remove ASAP, A2 – Repair/Encapsulate ASAP, A3 – Leave Undisturbed and Monitor Situation

**Checked by: Mr. R. Brown**

*Asbestos Manager*

## APPENDIX B

### VEGA ENVIRONMENTAL CONSULTANTS LTD

<b>MATERIAL ASSESSMENT ALGORITHM – FOR TYPE 1/TYPE 2 SURVEY</b>		
<b>Sample Variable</b>	<b>Score</b>	<b>Main Examples</b>
Product Type	1	Asbestos reinforced composites (plastic, resins, mastics, roofing felts, vinyl floor tiles, semi-rigid paints or decorative finishes, asbestos cement etc.)
	2	Asbestos insulating board, mill boards, other low-density insulation boards, asbestos textiles, gaskets, ropes and woven textiles, asbestos paper and felt.
	3	Thermal insulation (e.g. pipe and boiler lagging), sprayed asbestos, loose asbestos, asbestos mattresses and packing.
Condition	0	Good condition: no visible damage
	1	Low damage: a few scratches or surface marks; broken edges on boards, tiles etc.
	2	Medium damage: significant breakage of materials or several small areas where material has been damaged revealing loose asbestos fibres.
	3	High damage or delamination of materials, sprays and thermal insulation. Visible asbestos debris.
Surface Treatment	0	Composite materials containing asbestos: reinforced plastics, resins, vinyl tiles, painted or asbestos cement (with exposed face painted or encapsulated)
	1	Enclosed sprays and lagging, AIB (with exposed face painted or encapsulated), asbestos cement sheets etc.
	2	Unsealed AIB, or encapsulated lagging and sprays.
	3	Unsealed lagging and sprays.
Asbestos Type	1	Chrysotile.
	2	Amphibole asbestos excluding crocidolite.
	3	Crocidolite.

<b>INITIAL ACTION PLAN</b>			
<b>MATERIAL ASSESSMENT SCORE</b>	<b>ACCESS</b>		
	Inaccessible	Occasionally Accessed	Easily/Regularly Accessed
Very Low Risk: < 5	A3	A3	A3
Low Risk: 5-6	A3	A3	A2
Medium Risk: 7-9	A3	A2	A1
High Risk: 10-12	A2	A1	A1



**Church Buildings  
Station Road  
Seaton Delaval  
Whitley Bay  
TYNE & WEAR  
NE25 0PT**

**Tel: (0191) 298 0198  
Fax: (0191) 298 0199**

*OCCUPATIONAL HYGIENE CONSULTANTS  
Asbestos Surveys, Analysis and Monitoring  
COSHH Audits, Assessments and Surveys  
Indoor Air Quality, Environmental Testing*

*CLEANROOM TESTING CONSULTANTS  
DOP/PSL Testing of HEPA/ULPA Filters  
HLF, VLF, MSC and Fume Cupboard Testing  
Validating/Testing of Pharmaceutical Process Isolators*

**CONFIDENTIAL**

**APPENDIX C**

**ASBESTOS ANALYSIS REPORT**

**Page 1 of 2**

**Report No:** AR/09/3388 (update 02)

**Date of Issue:** 09/07/15

**Client:** John Warwick  
Northumberland County Council  
Property Services Section (Asbestos)  
Resources Department  
Performance Group  
County Hall  
Morpeth  
Northumberland  
NE61 2EF

**Date Sample  
Received:** 07/10/09

**Date Analysed:** 08/10/09

**Laboratory:** Permanent

**Order/Contract No.**

**Origin of bulk sample:** Cragside Primary School, Cramlington.

**Samples taken by:** J Craig

**Company:** Vega Ltd

**Samples analysed by** E Brown

Sample ID	Location of Sample Point	Analysis
BS/01	Kitchen Staff Room & Toilet, Toilet cistern	<b><u>Amosite</u></b> - (brown asbestos)
BS/02	Tank Room, Floor - debris	Amosite <b>REMOVED FEB 2010</b>
BS/03	Gas Cupboard - pipe flange gasket	<b><u>Chrysotile</u></b> - (white asbestos)

*Analysis was carried out in accordance with HSG248: February 2005 – ‘Asbestos: The analysts’ guide for sampling, analysis and clearance procedures’ by documented in-house procedure Number ASB/3. VEGA cannot accept responsibility for the information on, or condition of, bulk samples taken/supplied by non-Vega personnel or the effect such information or condition may have on the analysis of fibrous content.*

**CONFIDENTIAL**

**APPENDIX C**

**ASBESTOS ANALYSIS REPORT - CONTINUED**

**Page 2 of 2**

**Report No. AR/09/3388 (update 02)**

<b>Sample ID</b>	<b>Location of Sample Point</b>	<b>Analysis</b>
BS/04	Exterior - damp proof course	Chrysotile

*Analysis was carried out in accordance with HSG248: February 2005 – ‘Asbestos: The analysts’ guide for sampling, analysis and clearance procedures’ by documented in-house procedure Number ASB/3. VEGA cannot accept responsibility for the information on, or condition of, bulk samples taken/supplied by non-Vega personnel or the effect such information or condition may have on the analysis of fibrous content.*

## **APPENDIX D**

## **INSURANCE INFORMATION**

Issue No: 2	Form No: 098	Issue Date: 23/01/07
<b>Insurance Information</b>		Page No: 1 of 1
		Issued By: Marie Thompson

Report No: AR/09/3388 (update 01)

Appendix D

Vega Environmental Consultants Ltd hold Professional Indemnity Insurance. This policy is provided by Miles Smith (Policy No. S31050027). The certificate of Insurance contains the following Caveat:

**Every effort has been made to identify all asbestos materials as far as was reasonably practical to do so within the scope of the survey and the attached report. Methods used to carry out the survey were agreed with the client prior to any works being commenced.**

Survey techniques used involve trained and experienced surveyors using the combined approach with regard to visual examination and necessary bulk sampling. It is always possible after a survey that asbestos based materials of one sort or another may remain in the property or area covered by that survey, this could be due to various reasons:

- Asbestos materials existing within areas not specifically covered by this report are therefore outside the scope of the survey.
- Materials may be hidden or obscured by other items or cover finishes, e.g. paint, over boarding, disguising etc. Where this is the case then its detection will be impaired.
- Asbestos may well be hidden as part of the structure to a building and not visible until the structure is dismantled at a later date.
- Debris from previous asbestos removal projects may well be present in some areas; general asbestos debris does not form part of this survey however all good intentions are made for its discovery.
- Where an area has been previously stripped of asbestos (e.g. plant rooms, ducts etc) and new coverings added, it must be pointed out that asbestos removal techniques have improved steadily over the years since its introduction. Most notably would be the Control of Asbestos at Work Regulations 2002 or other similar subsequent Regulations laying down certain enforceable guidelines. Asbestos removal prior to this regulation would not be of today's standard and therefore debris may be present below new coverings.
- This survey will detail all areas accessed and all samples taken: where an area is not covered by this survey it will be due to no access for one reason or another, e.g. working operatives, sensitive location or just simply no access. It may have been necessary for the limits of the surveyor's authority to be confirmed prior to the survey.
- Access for the survey may be restricted for many reasons beyond our control such as height, inconvenience to others, immovable obstacles or confined space. Where electrical equipment is present and presumed in the way of the survey no access will be attempted until proof of its safe state is given. Our operatives have a duty of care under the Health & Safety at Work etc Act 1974 for both themselves and others.
- In the building where asbestos has been located and it is clear that not all areas have been investigated, any material that is found to be suspicious and not detailed as part of the survey should be treated with caution and sampled accordingly.
- Certain materials contain asbestos to varying degrees and some may be less densely contaminated at certain locations (e.g. Artex). Where this is the case the sample taken may not be representative of the whole product throughout.
- Where a survey is carried out under the guidance of the owner of the property, or his representative, then the survey will be as per his instructions and guidance at the that time.
- Vega Environmental Consultants Ltd cannot accept any liability for loss, injury, damage or penalty issues due to errors or omissions within this report.
- Vega Environmental Consultants Ltd cannot be held responsible for any damage caused as part of this survey carried out on your behalf. Due to the nature and necessity of sampling for asbestos some damage is unavoidable and will be limited to just that necessary for the taking of the sample.

### References

1. Miles Smith Certificate of Insurance ref: MSPI0505.