



ENVIRONMENTAL CONSULTANTS LTD

**NEW HARTLEY COUNTY FIRST SCHOOL,
MELTON DRIVE, NEW HARTLEY, WHITLEY BAY**



Survey to identify asbestos based materials
carried out on behalf of Northumberland County Council

Update 01

Issue Date: 24 December 2003

**Registered Office: Church Buildings, Station Road, Seaton Delaval,
Whitley Bay, TYNE & WEAR, NE25 0PT
Tel: (0191) 298 0198 Fax: (0191) 298 0199**

Visit our Web-site at: <http://www.vegaec.co.uk>

CONFIDENTIAL

ASBESTOS SURVEY REPORT

Page 1 of 31

Report No: AR/03/1570 (update 01)

Date of Issue: 09/06/09

Client: Mr R Brown
Northumberland County Council
County Hall
Morpeth
Northumberland
NE61 2EF

Clients Order No: C360022I

Date(s) of Survey: 03/12/03

Establishment Surveyed:
New Hartley County First School, Melton
Drive, New Hartley, Whitley Bay

Area(s) Surveyed: all accessible areas

Type of Survey: Type 2 - Standard Sampling, Identification and Assessment (see Additional Information section for definition)

Purpose, Aims and Objectives

This survey was undertaken to establish the presence and nature of asbestos based materials in the area(s) surveyed. Surveying, sampling and assessment of asbestos-containing materials was carried out in accordance with MDHS 100: July 2001.

Representative bulk and - if applicable - air samples were taken from the locations detailed in the following pages of this report. The bulk samples were subject to a careful cleaning procedure involving disintegration of the sample, acid washing, solvent washing, filtration etc., in order to expose fibres in a form suitable for microscopic analysis. Analysis was carried out in accordance with MDHS 77: June 1994 by documented in-house procedures.

Where applicable, all airborne fibre concentrations were measured according to the provisions of the Health and Safety Executive documents MDHS 39 and Guidance Note EH10 (current editions).

Vega Environmental Consultants Ltd cannot accept responsibility for any errors or misinterpretations introduced into a survey, or any resulting conclusions, as a result of a reduced sampling frequency specified by a client.

This survey attempts to identify all asbestos materials within the agreed scope of work. However, as asbestos materials can be completely hidden/buried within a structure, VEGA cannot accept responsibility for additional materials that may be identified at a later date.

Checked by: Mr. R. Brown,
Asbestos Manager.

CONFIDENTIAL

ASBESTOS ANALYSIS REPORT

Page 2 of 31

Report No: AR/03/1570 (update 01) **Date of Issue:** 09/06/09

Client: Mr R Brown
Northumberland County Council **Date Sample Received:** 03/12/03

Date Analysed: 23/12/03

Laboratory: Permanent

Order/Contract No. -

Origin of bulk sample: New Hartley County First School, Melton Drive, New Hartley, Whitley Bay

Samples taken by: A Hepburn **Company:** Vega Ltd

Samples analysed by P Dean

Sample ID	Location of Sample Point	Analysis
BS/01	Void above Male Toilet - felt	No asbestos detected
BS/02	Cleaner's Cupboard – vinyl floor tiles	No asbestos detected
BS/03	Reception Classroom – vibration pad under sink	No asbestos detected

Analysis was carried out in accordance with MDHS 77: June 1994 by documented in-house procedure Number ASB/3.

VEGA cannot accept responsibility for the information on, or condition of, bulk samples taken/supplied by non-Vega personnel or the effect such information or condition may have on the analysis of fibrous content.

Checked by: Mr. R. Brown,
Asbestos Manager.

CONFIDENTIAL

ASBESTOS ANALYSIS REPORT - CONTINUED

Page 3 of 31

Report No. AR/03/1570 (update 01)

Sample ID	Location of Sample Point	Analysis
BS/04	Main Hall, Store 1 – panels to ceiling	No asbestos detected
BS/05	Cloakroom 2, Store 1 – vinyl floor tiles	No asbestos detected
BS/06	Cloakroom 2, Store 2 – vinyl floor tiles	No asbestos detected
BS/07	Boiler Room – gaskets to flanges	<u>Chrysotile</u> – (white asbestos)
BS/08	Exterior – verge board strip - cement	Chrysotile
MOBILE DEMOLISHED AND REMOVED AUG 2008		
BS/09	Portacabin – panel below heater	<u>Amosite</u> – (brown asbestos)
BS/10	Mobile Unit, External – roof felt	No asbestos detected
BS/11	Mobile Unit, External – textured coating	No asbestos detected

Analysis was carried out in accordance with MDHS 77: June 1994 by documented in-house procedure Number ASB/3.

VEGA cannot accept responsibility for the information on, or condition of, bulk samples taken/supplied by non-Vega personnel or the effect such information or condition may have on the analysis of fibrous content.

Checked by: Mr. R. Brown,
Asbestos Manager.

VEGA ENVIRONMENTAL CONSULTANTS LTD

ASBESTOS SURVEY - DATA RECORD SHEET

Page 4 of 31

Report No: AR/03/1570 (update 01) **Contact:** Mr R Brown

Date of survey: 03/12/03

Client:
Northumberland County Council

Analyst: E Brown / A Hepburn

Site Location: New Hartley County First School, Melton Drive,
New Hartley, Whitley Bay

Area ID	Surveyed Yes/No	Location of sample point / Description of suspect material	Level of ID (P/SP/ID)	Sample ID	Extent (m/m ² /m ³)	Product Type (1,2,3)	Condition (0,1,2,3)	Surface Treatment (0,1,2,3)	Asbestos Type (1,2,3)	Score	Access (IA,OA,EA)	Action (A1,A2,A3)
GROUND FLOOR												
Corridor 1	Yes	Ceiling - plaster	SP	-	-	-	-	-	NA	-	-	-
		Ceiling – wood beams	SP	-	-	-	-	-	NA	-	-	-
		Walls – plaster and breeze block	SP	-	-	-	-	-	NA	-	-	-
		Facias to entry door - wood	SP	-	-	-	-	-	NA	-	-	-
		Pipe insulation - MMMF	SP	-	-	-	-	-	NA	-	-	-
		Floor – carpet over concrete	SP	-	-	-	-	-	NA	-	-	-
Male Toilet 1	Yes	Ceiling - plaster	SP	-	-	-	-	-	NA	-	-	-
		Walls – ceramic tiles	SP	-	-	-	-	-	NA	-	-	-

Level of ID: P – Presumed, SP – Strongly Presumed, ID – Identified. **Access:** IA – Inaccessible, OA – Occasionally Accessed, EA – Easily/Regularly Accessed

Asbestos Type: NA – Non-Asbestos **Action:** A1 – Remove ASAP, A2 – Repair/Encapsulate ASAP, A3 – Leave Undisturbed and Monitor Situation

Checked by: Mr. R. Brown,
Asbestos Manager.

VEGA ENVIRONMENTAL CONSULTANTS LTD

ASBESTOS SURVEY - DATA RECORD SHEET - continued

Page 5 of 31

Report No: AR/03/1570 (update 01)

Date of survey: 03/12/03

Area ID	Surveyed Yes/No	Location of sample point / Description of suspect material	Level of ID (P/SP/ID)	Sample ID	Extent (m/m ² /m ³)	Product Type (1,2,3)	Condition (0,1,2,3)	Surface Treatment (0,1,2,3)	Asbestos Type (1,2,3)	Score	Access (IA,OA,EA)	Action (A1,A2,A3)
GROUND FLOOR (cont)												
Male Toilet 1 (cont)	Yes	Toilet cistern - plastic	SP	-	-	-	-	-	NA	-	-	-
		Floor – ceramic tiles	SP	-	-	-	-	-	NA	-	-	-
Void above Male Toilet	Yes	Under tile felt	ID	BS/01	-	-	-	-	NA	-	-	-
		Loft insulation - MMMF	SP	-	-	-	-	-	NA	-	-	-
		Pipe insulation - MMMF	SP	-	-	-	-	-	NA	-	-	-
Female Toilet 1	Yes	Ceiling – plaster	SP	-	-	-	-	-	NA	-	-	-
		Walls – ceramic tiles	SP	-	-	-	-	-	NA	-	-	-
		Toilet cistern - plastic	SP	-	-	-	-	-	NA	-	-	-
		Floor – ceramic tiles	SP	-	-	-	-	-	NA	-	-	-

Level of ID: P – Presumed, SP – Strongly Presumed, ID – Identified. **Access:** IA – Inaccessible, OA – Occasionally Accessed, EA – Easily/Regularly Accessed

Asbestos Type: NA – Non-Asbestos **Action:** A1 – Remove ASAP, A2 – Repair/Encapsulate ASAP, A3 – Leave Undisturbed and Monitor Situation

Checked by: Mr. R. Brown,
Asbestos Manager.

VEGA ENVIRONMENTAL CONSULTANTS LTD

ASBESTOS SURVEY - DATA RECORD SHEET - continued

Page 6 of 31

Report No: AR/03/1570 (update 01)

Date of survey: 03/12/03

Area ID	Surveyed Yes/No	Location of sample point / Description of suspect material	Level of ID (P/SP/ID)	Sample ID	Extent (m/m ² /m ³)	Product Type (1,2,3)	Condition (0,1,2,3)	Surface Treatment (0,1,2,3)	Asbestos Type (1,2,3)	Score	Access (IA,OA,EA)	Action (A1,A2,A3)
GROUND FLOOR (cont)												
Staff Room	Yes	Ceiling - plaster	SP	-	-	-	-	-	NA	-	-	-
		Walls - plaster	SP	-	-	-	-	-	NA	-	-	-
		Notice board - fibreboard	SP	-	-	-	-	-	NA	-	-	-
		Floor – carpet over concrete	SP	-	-	-	-	-	NA	-	-	-
Office 1	Yes	Ceiling - plaster	SP	-	-	-	-	-	NA	-	-	-
		Walls - plaster	SP	-	-	-	-	-	NA	-	-	-
		Panels to windows - wood	SP	-	-	-	-	-	NA	-	-	-
		Floor – carpet over concrete	SP	-	-	-	-	-	NA	-	-	-
Head Teacher's Office	Yes	Ceiling - plaster	SP	-	-	-	-	-	NA	-	-	-

Level of ID: P – Presumed, SP – Strongly Presumed, ID – Identified. **Access:** IA – Inaccessible, OA – Occasionally Accessed, EA – Easily/Regularly Accessed

Asbestos Type: NA – Non-Asbestos **Action:** A1 – Remove ASAP, A2 – Repair/Encapsulate ASAP, A3 – Leave Undisturbed and Monitor Situation

Checked by: Mr. R. Brown,
Asbestos Manager.

VEGA ENVIRONMENTAL CONSULTANTS LTD

ASBESTOS SURVEY - DATA RECORD SHEET - continued

Page 7 of 31

Report No: AR/03/1570 (update 01)

Date of survey: 03/12/03

Area ID	Surveyed Yes/No	Location of sample point / Description of suspect material	Level of ID (P/SP/ID)	Sample ID	Extent (m/m ² /m ³)	Product Type (1,2,3)	Condition (0,1,2,3)	Surface Treatment (0,1,2,3)	Asbestos Type (1,2,3)	Score	Access (IA,OA,EA)	Action (A1,A2,A3)
GROUND FLOOR (cont)												
Head Teacher's Office (cont)	Yes	Walls - plaster	SP	-	-	-	-	-	NA	-	-	-
		Panels to windows - wood	SP	-	-	-	-	-	NA	-	-	-
		Floor – carpet over concrete	SP	-	-	-	-	-	NA	-	-	-
Cleaner's Cupboard	Yes	Ceiling - plaster	SP	-	-	-	-	-	NA	-	-	-
		Walls – breeze block	SP	-	-	-	-	-	NA	-	-	-
		Floor – vinyl tiles over concrete (red)	ID	BS/02	-	-	-	-	NA	-	-	-
Void above Cleaner's Cupboard	Yes	Under tile felt	SP	As BS/01	-	-	-	-	NA	-	-	-

Level of ID: P – Presumed, SP – Strongly Presumed, ID – Identified. **Access:** IA – Inaccessible, OA – Occasionally Accessed, EA – Easily/Regularly Accessed

Asbestos Type: NA – Non-Asbestos **Action:** A1 – Remove ASAP, A2 – Repair/Encapsulate ASAP, A3 – Leave Undisturbed and Monitor Situation

Checked by: Mr. R. Brown,
Asbestos Manager.

VEGA ENVIRONMENTAL CONSULTANTS LTD

ASBESTOS SURVEY - DATA RECORD SHEET - continued

Page 8 of 31

Report No: AR/03/1570 (update 01)

Date of survey: 03/12/03

Area ID	Surveyed Yes/No	Location of sample point / Description of suspect material	Level of ID (P/SP/ID)	Sample ID	Extent (m/m ² /m ³)	Product Type (1,2,3)	Condition (0,1,2,3)	Surface Treatment (0,1,2,3)	Asbestos Type (1,2,3)	Score	Access (IA,OA,EA)	Action (A1,A2,A3)
GROUND FLOOR (cont)												
Void above Cleaner's Cupboard (cont)	Yes	Loft insulation - MMMF	SP	-	-	-	-	-	NA	-	-	-
		Pipe insulation - MMMF	SP	-	-	-	-	-	NA	-	-	-
Store 1	Yes	Ceiling - plaster	SP	-	-	-	-	-	NA	-	-	-
		Walls – breeze block	SP	-	-	-	-	-	NA	-	-	-
		Floor – vinyl tiles over concrete	SP	As BS/02	-	-	-	-	NA	-	-	-
Classroom 1 New Class	Yes	Ceiling - plaster	SP	-	-	-	-	-	NA	-	-	-
		Walls – plaster and breeze block	SP	-	-	-	-	-	NA	-	-	-

Level of ID: P – Presumed, SP – Strongly Presumed, ID – Identified. **Access:** IA – Inaccessible, OA – Occasionally Accessed, EA – Easily/Regularly Accessed

Asbestos Type: NA – Non-Asbestos **Action:** A1 – Remove ASAP, A2 – Repair/Encapsulate ASAP, A3 – Leave Undisturbed and Monitor Situation

Checked by: Mr. R. Brown,
Asbestos Manager.

VEGA ENVIRONMENTAL CONSULTANTS LTD

ASBESTOS SURVEY - DATA RECORD SHEET - continued

Page 9 of 31

Report No: AR/03/1570 (update 01)

Date of survey: 03/12/03

Area ID	Surveyed Yes/No	Location of sample point / Description of suspect material	Level of ID (P/SP/ID)	Sample ID	Extent (m/m ² /m ³)	Product Type (1,2,3)	Condition (0,1,2,3)	Surface Treatment (0,1,2,3)	Asbestos Type (1,2,3)	Score	Access (IA,OA,EA)	Action (A1,A2,A3)
GROUND FLOOR (cont)												
Classroom 1 New Class (cont)	Yes	Sink unit - vibration pad	SP	As BS/03	-	-	-	-	NA	-	-	-
		Floor – carpet and vinyl over concrete	SP	-	-	-	-	-	NA	-	-	-
Void above Classroom 1 New Class	Yes	Under tile felt	SP	As BS/01	-	-	-	-	NA	-	-	-
		Loft insulation - MMMF	SP	-	-	-	-	-	NA	-	-	-
Main Kitchen Area	Yes	Ceiling – plaster and servery - wood	SP	-	-	-	-	-	NA	-	-	-
		Walls – ceramic tiles	SP	-	-	-	-	-	NA	-	-	-

Level of ID: P – Presumed, SP – Strongly Presumed, ID – Identified. **Access:** IA – Inaccessible, OA – Occasionally Accessed, EA – Easily/Regularly Accessed
Asbestos Type: NA – Non-Asbestos **Action:** A1 – Remove ASAP, A2 – Repair/Encapsulate ASAP, A3 – Leave Undisturbed and Monitor Situation

Checked by: Mr. R. Brown,
Asbestos Manager.

VEGA ENVIRONMENTAL CONSULTANTS LTD

ASBESTOS SURVEY - DATA RECORD SHEET - continued

Page 10 of 31

Report No: AR/03/1570 (update 01)

Date of survey: 03/12/03

Area ID	Surveyed Yes/No	Location of sample point / Description of suspect material	Level of ID (P/SP/ID)	Sample ID	Extent (m/m ² /m ³)	Product Type (1,2,3)	Condition (0,1,2,3)	Surface Treatment (0,1,2,3)	Asbestos Type (1,2,3)	Score	Access (IA,OA,EA)	Action (A1,A2,A3)
GROUND FLOOR (cont)												
<i>Main Kitchen Area (cont)</i>	<i>Yes</i>	<i>High level wall heaters x 2 – no access</i>	<i>P</i>	-	-	-	-	-	-	-	<i>IA</i>	<i>A3</i>
		Floor – ceramic tiles over concrete	SP	-	-	-	-	-	NA	-	-	-
Larder	Yes	Ceiling - plaster	SP	-	-	-	-	-	NA	-	-	-
		Walls – ceramic tiles	SP	-	-	-	-	-	NA	-	-	-
		Floor – ceramic tiles over concrete	SP	-	-	-	-	-	NA	-	-	-
Vegetable Store	Yes	Ceiling - plaster	SP	-	-	-	-	-	NA	-	-	-
		Walls – ceramic tiles	SP	-	-	-	-	-	NA	-	-	-
		Floor – ceramic tiles over concrete	SP	-	-	-	-	-	NA	-	-	-

Level of ID: P – Presumed, SP – Strongly Presumed, ID – Identified. **Access:** IA – Inaccessible, OA – Occasionally Accessed, EA – Easily/Regularly Accessed

Asbestos Type: NA – Non-Asbestos **Action:** A1 – Remove ASAP, A2 – Repair/Encapsulate ASAP, A3 – Leave Undisturbed and Monitor Situation

Checked by: Mr. R. Brown,
Asbestos Manager.

VEGA ENVIRONMENTAL CONSULTANTS LTD

ASBESTOS SURVEY - DATA RECORD SHEET - continued

Page 11 of 31

Report No: AR/03/1570 (update 01)

Date of survey: 03/12/03

Area ID	Surveyed Yes/No	Location of sample point / Description of suspect material	Level of ID (P/SP/ID)	Sample ID	Extent (m/m ² /m ³)	Product Type (1,2,3)	Condition (0,1,2,3)	Surface Treatment (0,1,2,3)	Asbestos Type (1,2,3)	Score	Access (IA,OA,EA)	Action (A1,A2,A3)
GROUND FLOOR (cont)												
Kitchen Office	Yes	Ceiling - plaster	SP	-	-	-	-	-	NA	-	-	-
		Walls – ceramic tiles	SP	-	-	-	-	-	NA	-	-	-
		High level boxing - wood	SP	-	-	-	-	-	NA	-	-	-
		Floor – ceramic tiles over concrete	SP	-	-	-	-	-	NA	-	-	-
Void above all Kitchen areas	Yes	Under tile felt	SP	As BS/01	-	-	-	-	NA	-	-	-
		Pipe insulation - MMMF	SP	-	-	-	-	-	NA	-	-	-
		Loft insulation - MMMF	SP	-	-	-	-	-	NA	-	-	-
		Wood panels	SP	-	-	-	-	-	NA	-	-	-
		Water tank - metal	SP	-	-	-	-	-	NA	-	-	-

Level of ID: P – Presumed, SP – Strongly Presumed, ID – Identified. **Access:** IA – Inaccessible, OA – Occasionally Accessed, EA – Easily/Regularly Accessed

Asbestos Type: NA – Non-Asbestos **Action:** A1 – Remove ASAP, A2 – Repair/Encapsulate ASAP, A3 – Leave Undisturbed and Monitor Situation

Checked by: Mr. R. Brown,
Asbestos Manager.

VEGA ENVIRONMENTAL CONSULTANTS LTD

ASBESTOS SURVEY - DATA RECORD SHEET - continued

Page 12 of 31

Report No: AR/03/1570 (update 01)

Date of survey: 03/12/03

Area ID	Surveyed Yes/No	Location of sample point / Description of suspect material	Level of ID (P/SP/ID)	Sample ID	Extent (m/m ² /m ³)	Product Type (1,2,3)	Condition (0,1,2,3)	Surface Treatment (0,1,2,3)	Asbestos Type (1,2,3)	Score	Access (IA,OA,EA)	Action (A1,A2,A3)
GROUND FLOOR (cont)												
Cloakroom 1	Yes	Ceiling - plaster	SP	-	-	-	-	-	NA	-	-	-
		Walls – ceramic tiles and plaster	SP	-	-	-	-	-	NA	-	-	-
		Floor – ceramic tiles over concrete	SP	-	-	-	-	-	NA	-	-	-
Reception Classroom	Yes	Ceiling - plaster	SP	-	-	-	-	-	NA	-	-	-
		Walls – breeze block	SP	-	-	-	-	-	NA	-	-	-
		Notice boards - fibreboard	SP	-	-	-	-	-	NA	-	-	-
		Floor – carpet over concrete	SP	-	-	-	-	-	NA	-	-	-
		Floor – vinyl tiles over concrete	SP	As BS/02	-	-	-	-	NA	-	-	-

Level of ID: P – Presumed, SP – Strongly Presumed, ID – Identified. **Access:** IA – Inaccessible, OA – Occasionally Accessed, EA – Easily/Regularly Accessed

Asbestos Type: NA – Non-Asbestos **Action:** A1 – Remove ASAP, A2 – Repair/Encapsulate ASAP, A3 – Leave Undisturbed and Monitor Situation

Checked by: Mr. R. Brown,
Asbestos Manager.

VEGA ENVIRONMENTAL CONSULTANTS LTD

ASBESTOS SURVEY - DATA RECORD SHEET - continued

Page 13 of 31

Report No: AR/03/1570 (update 01)

Date of survey: 03/12/03

Area ID	Surveyed Yes/No	Location of sample point / Description of suspect material	Level of ID (P/SP/ID)	Sample ID	Extent (m/m ² /m ³)	Product Type (1,2,3)	Condition (0,1,2,3)	Surface Treatment (0,1,2,3)	Asbestos Type (1,2,3)	Score	Access (IA,OA,EA)	Action (A1,A2,A3)
GROUND FLOOR (cont)												
Reception Kitchen	Yes	Ceiling - plaster	SP	-	-	-	-	-	NA	-	-	-
		Walls - plaster	SP	-	-	-	-	-	NA	-	-	-
		Sink - vibration pad	ID	BS/03	-	-	-	-	NA	-	-	-
		Floor – vinyl tiles over concrete	SP	As BS/01	-	-	-	-	NA	-	-	-
Reception Toilets	Yes	Ceiling - plaster	SP	-	-	-	-	-	NA	-	-	-
		Walls – ceramic tiles	SP	-	-	-	-	-	NA	-	-	-
		Floor – ceramic tiles over concrete	SP	-	-	-	-	-	NA	-	-	-
Reception Store Room	Yes	Ceiling - plaster	SP	-	-	-	-	-	NA	-	-	-

Level of ID: P – Presumed, SP – Strongly Presumed, ID – Identified. **Access:** IA – Inaccessible, OA – Occasionally Accessed, EA – Easily/Regularly Accessed

Asbestos Type: NA – Non-Asbestos **Action:** A1 – Remove ASAP, A2 – Repair/Encapsulate ASAP, A3 – Leave Undisturbed and Monitor Situation

Checked by: Mr. R. Brown,
Asbestos Manager.

VEGA ENVIRONMENTAL CONSULTANTS LTD

ASBESTOS SURVEY - DATA RECORD SHEET - continued

Page 14 of 31

Report No: AR/03/1570 (update 01)

Date of survey: 03/12/03

Area ID	Surveyed Yes/No	Location of sample point / Description of suspect material	Level of ID (P/SP/ID)	Sample ID	Extent (m/m ² /m ³)	Product Type (1,2,3)	Condition (0,1,2,3)	Surface Treatment (0,1,2,3)	Asbestos Type (1,2,3)	Score	Access (IA,OA,EA)	Action (A1,A2,A3)
GROUND FLOOR (cont)												
Reception Store Room (cont)	Yes	Walls – ceramic tiles	SP	-	-	-	-	-	NA	-	-	-
		Floor – ceramic tiles over concrete	SP	-	-	-	-	-	NA	-	-	-
Hall Area	Yes	Ceiling - wood	SP	-	-	-	-	-	NA	-	-	-
		Walls – breeze block	SP	-	-	-	-	-	NA	-	-	-
		Notice boards - fibreboard	SP	-	-	-	-	-	NA	-	-	-
		Floor – wood tiles	SP	-	-	-	-	-	NA	-	-	-
Hall Area Store 1	Yes	Ceiling - panels	ID	BS/04	-	-	-	-	NA	-	-	-
		Walls – breeze block	SP	-	-	-	-	-	NA	-	-	-

Level of ID: P – Presumed, SP – Strongly Presumed, ID – Identified. **Access:** IA – Inaccessible, OA – Occasionally Accessed, EA – Easily/Regularly Accessed

Asbestos Type: NA – Non-Asbestos **Action:** A1 – Remove ASAP, A2 – Repair/Encapsulate ASAP, A3 – Leave Undisturbed and Monitor Situation

Checked by: Mr. R. Brown,
Asbestos Manager.

VEGA ENVIRONMENTAL CONSULTANTS LTD

ASBESTOS SURVEY - DATA RECORD SHEET - continued

Page 15 of 31

Report No: AR/03/1570 (update 01)

Date of survey: 03/12/03

Area ID	Surveyed Yes/No	Location of sample point / Description of suspect material	Level of ID (P/SP/ID)	Sample ID	Extent (m/m ² /m ³)	Product Type (1,2,3)	Condition (0,1,2,3)	Surface Treatment (0,1,2,3)	Asbestos Type (1,2,3)	Score	Access (IA,OA,EA)	Action (A1,A2,A3)
GROUND FLOOR (cont)												
Hall Area Store 1 (cont)	Yes	Floor – vinyl tiles over concrete	SP	As BS/02	-	-	-	-	NA	-	-	-
Hall Area Store 2	Yes	Ceiling - plaster	SP	-	-	-	-	-	NA	-	-	-
		Walls – breeze block	SP	-	-	-	-	-	NA	-	-	-
		Floor – vinyl tiles over concrete	SP	As BS/02	-	-	-	-	NA	-	-	-
Void above Hall Store 2	Yes	Ceiling - concrete	SP	-	-	-	-	-	NA	-	-	-
		Walls – breeze block	SP	-	-	-	-	-	NA	-	-	-
		Pipe insulation - MMMF	SP	-	-	-	-	-	NA	-	-	-
		Water tanks x 2 - metal	SP	-	-	-	-	-	NA	-	-	-

Level of ID: P – Presumed, SP – Strongly Presumed, ID – Identified. **Access:** IA – Inaccessible, OA – Occasionally Accessed, EA – Easily/Regularly Accessed

Asbestos Type: NA – Non-Asbestos **Action:** A1 – Remove ASAP, A2 – Repair/Encapsulate ASAP, A3 – Leave Undisturbed and Monitor Situation

Checked by: Mr. R. Brown,
Asbestos Manager.

VEGA ENVIRONMENTAL CONSULTANTS LTD

ASBESTOS SURVEY - DATA RECORD SHEET - continued

Page 16 of 31

Report No: AR/03/1570 (update 01)

Date of survey: 03/12/03

Area ID	Surveyed Yes/No	Location of sample point / Description of suspect material	Level of ID (P/SP/ID)	Sample ID	Extent (m/m ² /m ³)	Product Type (1,2,3)	Condition (0,1,2,3)	Surface Treatment (0,1,2,3)	Asbestos Type (1,2,3)	Score	Access (IA,OA,EA)	Action (A1,A2,A3)
GROUND FLOOR (cont)												
Cloakroom 2 Area	Yes	Ceiling - tiles	SP	-	-	-	-	-	NA	-	-	-
		Skylight - wood	SP	-	-	-	-	-	NA	-	-	-
		Walls – ceramic tiles	SP	-	-	-	-	-	NA	-	-	-
		Floor – ceramic tiles over concrete	SP	-	-	-	-	-	NA	-	-	-
		Panels above doors to Stores 1 and 2	SP	As BS/04	-	-	-	-	NA	-	-	-
Void above Cloakroom 2	Yes	Ceiling - wood	SP	-	-	-	-	-	NA	-	-	-
		Loft insulation - MMMF	SP	-	-	-	-	-	NA	-	-	-

Level of ID: P – Presumed, SP – Strongly Presumed, ID – Identified. **Access:** IA – Inaccessible, OA – Occasionally Accessed, EA – Easily/Regularly Accessed

Asbestos Type: NA – Non-Asbestos **Action:** A1 – Remove ASAP, A2 – Repair/Encapsulate ASAP, A3 – Leave Undisturbed and Monitor Situation

Checked by: Mr. R. Brown,
Asbestos Manager.

VEGA ENVIRONMENTAL CONSULTANTS LTD

ASBESTOS SURVEY - DATA RECORD SHEET - continued

Page 17 of 31

Report No: AR/03/1570 (update 01)

Date of survey: 03/12/03

Area ID	Surveyed Yes/No	Location of sample point / Description of suspect material	Level of ID (P/SP/ID)	Sample ID	Extent (m/m ² /m ³)	Product Type (1,2,3)	Condition (0,1,2,3)	Surface Treatment (0,1,2,3)	Asbestos Type (1,2,3)	Score	Access (IA,OA,EA)	Action (A1,A2,A3)
GROUND FLOOR (cont)												
Store 1 off Cloakroom 2	Yes	Ceiling - tiles	SP	-	-	-	-	-	NA	-	-	-
		Walls – breeze block	SP	-	-	-	-	-	NA	-	-	-
		Floor – vinyl tiles over concrete (green)	ID	BS/05	-	-	-	-	NA	-	-	-
Void above Store 1	Yes	Ceiling - wood	SP	-	-	-	-	-	NA	-	-	-
		Loft insulation - MMMF	SP	-	-	-	-	-	NA	-	-	-
Store 2 off Cloakroom 2	Yes	Ceiling - tiles	SP	-	-	-	-	-	NA	-	-	-
		Walls – breeze block	SP	-	-	-	-	-	NA	-	-	-
		Floor – vinyl tiles over concrete (orange)	ID	BS/06	-	-	-	-	NA	-	-	-

Level of ID: P – Presumed, SP – Strongly Presumed, ID – Identified. **Access:** IA – Inaccessible, OA – Occasionally Accessed, EA – Easily/Regularly Accessed

Asbestos Type: NA – Non-Asbestos **Action:** A1 – Remove ASAP, A2 – Repair/Encapsulate ASAP, A3 – Leave Undisturbed and Monitor Situation

Checked by: Mr. R. Brown,
Asbestos Manager.

VEGA ENVIRONMENTAL CONSULTANTS LTD

ASBESTOS SURVEY - DATA RECORD SHEET - continued

Page 18 of 31

Report No: AR/03/1570 (update 01)

Date of survey: 03/12/03

Area ID	Surveyed Yes/No	Location of sample point / Description of suspect material	Level of ID (P/SP/ID)	Sample ID	Extent (m/m ² /m ³)	Product Type (1,2,3)	Condition (0,1,2,3)	Surface Treatment (0,1,2,3)	Asbestos Type (1,2,3)	Score	Access (IA,OA,EA)	Action (A1,A2,A3)
GROUND FLOOR (cont)												
Void above Store 2	Yes	Ceiling - wood	SP	-	-	-	-	-	NA	-	-	-
		Loft insulation - MMMF	SP	-	-	-	-	-	NA	-	-	-
Boys' Toilet	Yes	Ceiling - tiles	SP	-	-	-	-	-	NA	-	-	-
		Walls – ceramic tiles	SP	-	-	-	-	-	NA	-	-	-
		Floor – ceramic tiles over concrete	SP	-	-	-	-	-	NA	-	-	-
Void above Boys' Toilet	Yes	Ceiling - wood	SP	-	-	-	-	-	NA	-	-	-
		Loft insulation - MMMF	SP	-	-	-	-	-	NA	-	-	-
Girls' Toilet	Yes	Ceiling - tiles	SP	-	-	-	-	-	NA	-	-	-

Level of ID: P – Presumed, SP – Strongly Presumed, ID – Identified. **Access:** IA – Inaccessible, OA – Occasionally Accessed, EA – Easily/Regularly Accessed

Asbestos Type: NA – Non-Asbestos **Action:** A1 – Remove ASAP, A2 – Repair/Encapsulate ASAP, A3 – Leave Undisturbed and Monitor Situation

Checked by: Mr. R. Brown,
Asbestos Manager.

VEGA ENVIRONMENTAL CONSULTANTS LTD

ASBESTOS SURVEY - DATA RECORD SHEET - continued

Page 19 of 31

Report No: AR/03/1570 (update 01)

Date of survey: 03/12/03

Area ID	Surveyed Yes/No	Location of sample point / Description of suspect material	Level of ID (P/SP/ID)	Sample ID	Extent (m/m ² /m ³)	Product Type (1,2,3)	Condition (0,1,2,3)	Surface Treatment (0,1,2,3)	Asbestos Type (1,2,3)	Score	Access (IA,OA,EA)	Action (A1,A2,A3)
GROUND FLOOR (cont)												
Girls' Toilet (cont)	Yes	Walls – ceramic tiles	SP	-	-	-	-	-	NA	-	-	-
		Panel running up toilet wall	SP	As BS/04	-	-	-	-	NA	-	-	-
		Floor – ceramic tiles over concrete	SP	-	-	-	-	-	NA	-	-	-
Void above Girls' Toilet	Yes	Ceiling - wood	SP	-	-	-	-	-	NA	-	-	-
		Loft insulation - MMMF	SP	-	-	-	-	-	NA	-	-	-
Wet Area 1	Yes	Ceiling - plaster	SP	-	-	-	-	-	NA	-	-	-
		Walls - plaster	SP	-	-	-	-	-	NA	-	-	-
		Floor – vinyl tiles	SP	As BS/05	-	-	-	-	NA	-	-	-

Level of ID: P – Presumed, SP – Strongly Presumed, ID – Identified. **Access:** IA – Inaccessible, OA – Occasionally Accessed, EA – Easily/Regularly Accessed

Asbestos Type: NA – Non-Asbestos **Action:** A1 – Remove ASAP, A2 – Repair/Encapsulate ASAP, A3 – Leave Undisturbed and Monitor Situation

Checked by: Mr. R. Brown,
Asbestos Manager.

VEGA ENVIRONMENTAL CONSULTANTS LTD

ASBESTOS SURVEY - DATA RECORD SHEET - continued

Page 20 of 31

Report No: AR/03/1570 (update 01)

Date of survey: 03/12/03

Area ID	Surveyed Yes/No	Location of sample point / Description of suspect material	Level of ID (P/SP/ID)	Sample ID	Extent (m/m ² /m ³)	Product Type (1,2,3)	Condition (0,1,2,3)	Surface Treatment (0,1,2,3)	Asbestos Type (1,2,3)	Score	Access (IA,OA,EA)	Action (A1,A2,A3)
GROUND FLOOR (cont)												
Year 4 Classroom	Yes	Ceiling - plaster	SP	-	-	-	-	-	NA	-	-	-
		Walls – plaster and breeze block	SP	-	-	-	-	-	NA	-	-	-
		Floor – carpet over concrete	SP	-	-	-	-	-	NA	-	-	-
Year 2 Classroom	Yes	Ceiling - plaster	SP	-	-	-	-	-	NA	-	-	-
		Walls – plaster and breeze block	SP	-	-	-	-	-	NA	-	-	-
		Floor – carpet over concrete	SP	-	-	-	-	-	NA	-	-	-
Quiet Area 1	Yes	Ceiling - plaster	SP	-	-	-	-	-	NA	-	-	-
		Walls – plaster and breeze block	SP	-	-	-	-	-	NA	-	-	-
		Floor – carpet over concrete	SP	-	-	-	-	-	NA	-	-	-

Level of ID: P – Presumed, SP – Strongly Presumed, ID – Identified. **Access:** IA – Inaccessible, OA – Occasionally Accessed, EA – Easily/Regularly Accessed

Asbestos Type: NA – Non-Asbestos **Action:** A1 – Remove ASAP, A2 – Repair/Encapsulate ASAP, A3 – Leave Undisturbed and Monitor Situation

Checked by: Mr. R. Brown,
Asbestos Manager.

VEGA ENVIRONMENTAL CONSULTANTS LTD

ASBESTOS SURVEY - DATA RECORD SHEET - continued

Page 21 of 31

Report No: AR/03/1570 (update 01)

Date of survey: 03/12/03

Area ID	Surveyed Yes/No	Location of sample point / Description of suspect material	Level of ID (P/SP/ID)	Sample ID	Extent (m/m ² /m ³)	Product Type (1,2,3)	Condition (0,1,2,3)	Surface Treatment (0,1,2,3)	Asbestos Type (1,2,3)	Score	Access (IA,OA,EA)	Action (A1,A2,A3)
GROUND FLOOR (cont)												
Wet Area 2	Yes	Ceiling – plaster	SP	-	-	-	-	-	NA	-	-	-
		Walls – plaster and breeze block	SP	-	-	-	-	-	NA	-	-	-
		Floor – vinyl tiles over concrete	SP	As BS/06	-	-	-	-	NA	-	-	-
Year 1 Classroom	Yes	Ceiling - plaster	SP	-	-	-	-	-	NA	-	-	-
		Walls – plaster and breeze block	SP	-	-	-	-	-	NA	-	-	-
		Floor – carpet over concrete	SP	-	-	-	-	-	NA	-	-	-
Year 3 Classroom	Yes	Ceiling - plaster	SP	-	-	-	-	-	NA	-	-	-
		Walls – plaster and breeze block	SP	-	-	-	-	-	NA	-	-	-
		Floor – carpet over concrete	SP	-	-	-	-	-	NA	-	-	-

Level of ID: P – Presumed, SP – Strongly Presumed, ID – Identified. **Access:** IA – Inaccessible, OA – Occasionally Accessed, EA – Easily/Regularly Accessed

Asbestos Type: NA – Non-Asbestos **Action:** A1 – Remove ASAP, A2 – Repair/Encapsulate ASAP, A3 – Leave Undisturbed and Monitor Situation

Checked by: Mr. R. Brown,
Asbestos Manager.

VEGA ENVIRONMENTAL CONSULTANTS LTD

ASBESTOS SURVEY - DATA RECORD SHEET - continued

Page 22 of 31

Report No: AR/03/1570 (update 01)

Date of survey: 03/12/03

Area ID	Surveyed Yes/No	Location of sample point / Description of suspect material	Level of ID (P/SP/ID)	Sample ID	Extent (m/m ² /m ³)	Product Type (1,2,3)	Condition (0,1,2,3)	Surface Treatment (0,1,2,3)	Asbestos Type (1,2,3)	Score	Access (IA,OA,EA)	Action (A1,A2,A3)
GROUND FLOOR (cont)												
Quiet Area 2	Yes	Ceiling - plaster	SP	-	-	-	-	-	NA	-	-	-
		Walls – plaster and breeze block	SP	-	-	-	-	-	NA	-	-	-
		Floor – carpet over concrete	SP	-	-	-	-	-	NA	-	-	-
BOILER ROOM												
Boiler Room	Yes	Ceiling - panels	SP	As BS/04	-	-	-	-	NA	-	-	-
		Walls – breeze blocks	SP	-	-	-	-	-	NA	-	-	-
		Pipe insulation - MMMF	SP	-	-	-	-	-	NA	-	-	-
		Flue pipes x 3 - metal	SP	-	-	-	-	-	NA	-	-	-
		Boilers x 3 – no access	P	-	-	-	-	-	-	-	IA	A3

Level of ID: P – Presumed, SP – Strongly Presumed, ID – Identified. **Access:** IA – Inaccessible, OA – Occasionally Accessed, EA – Easily/Regularly Accessed

Asbestos Type: NA – Non-Asbestos **Action:** A1 – Remove ASAP, A2 – Repair/Encapsulate ASAP, A3 – Leave Undisturbed and Monitor Situation

Checked by: Mr. R. Brown,
Asbestos Manager.

VEGA ENVIRONMENTAL CONSULTANTS LTD

ASBESTOS SURVEY - DATA RECORD SHEET - continued

Page 23 of 31

Report No: AR/03/1570 (update 01)

Date of survey: 03/12/03

Area ID	Surveyed Yes/No	Location of sample point / Description of suspect material	Level of ID (P/SP/ID)	Sample ID	Extent (m/m ² /m ³)	Product Type (1,2,3)	Condition (0,1,2,3)	Surface Treatment (0,1,2,3)	Asbestos Type (1,2,3)	Score	Access (IA,OA,EA)	Action (A1,A2,A3)
BOILER ROOM (cont)												
<i>Boiler Room (cont)</i>	<i>Yes</i>	<i>Gaskets to flanges x 12</i>	<i>ID</i>	<i>BS/07</i>	<i><0.25m²</i>	<i>1</i>	<i>0</i>	<i>0</i>	<i>1</i>	<i>2</i>	<i>OA</i>	<i>A3</i>
		Floor - concrete	SP	-	-	-	-	-	NA	-	-	-
EXTERNAL												
Externals	Yes	Cowls x 3 - aluminium	SP	-	-	-	-	-	NA	-	-	-
		Roof - tiles	SP	-	-	-	-	-	NA	-	-	-
		<i>Under tile strip - cement</i>	<i>ID</i>	<i>BS/08</i>	<i>150m</i>	<i>1</i>	<i>0</i>	<i>0</i>	<i>1</i>	<i>2</i>	<i>OA</i>	<i>A3</i>
		Facias and soffits - wood	SP	-	-	-	-	-	NA	-	-	-
		Gutters and down pipes - plastic	SP	-	-	-	-	-	NA	-	-	-
		Walls - brick	SP	-	-	-	-	-	NA	-	-	-

Level of ID: P – Presumed, SP – Strongly Presumed, ID – Identified. **Access:** IA – Inaccessible, OA – Occasionally Accessed, EA – Easily/Regularly Accessed

Asbestos Type: NA – Non-Asbestos **Action:** A1 – Remove ASAP, A2 – Repair/Encapsulate ASAP, A3 – Leave Undisturbed and Monitor Situation

Checked by: Mr. R. Brown,
Asbestos Manager.

VEGA ENVIRONMENTAL CONSULTANTS LTD

ASBESTOS SURVEY - DATA RECORD SHEET - continued

Page 24 of 31

Report No: AR/03/1570 (update 01)

Date of survey: 03/12/03

Area ID	Surveyed Yes/No	Location of sample point / Description of suspect material	Level of ID (P/SP/ID)	Sample ID	Extent (m/m ² /m ³)	Product Type (1,2,3)	Condition (0,1,2,3)	Surface Treatment (0,1,2,3)	Asbestos Type (1,2,3)	Score	Access (IA,OA,EA)	Action (A1,A2,A3)
EXTERNAL (cont)												
Externals (cont)	Yes	Roof - felt	SP	As BS/10	-	-	-	-	NA	-	-	-
MOBILE UNIT		MOBILE DEMOLISHED AND REMOVED AUG 2008										
Entrance Room	Yes	Ceiling - plaster	SP	-	-	-	-	-	NA	-	-	-
		Walls - plaster	SP	-	-	-	-	-	NA	-	-	-
		Floor – carpet over wood	SP	-	-	-	-	-	NA	-	-	-
Classroom Area	Yes	Ceiling and walls - plaster	SP	-	-	-	-	-	NA	-	-	-
		<i>Wall heater – no access</i>	<i>P</i>	-	-	-	-	-	-	-	<i>IA</i>	<i>A3</i>
		<i>Floor - panel below heater</i>	<i>ID</i>	<i>BS/09</i>	<i><2m²</i>	<i>2</i>	<i>0</i>	<i>1</i>	<i>2</i>	<i>5</i>	<i>OA</i>	<i>A3</i>
		Panel behind and side of heater	SP	As BS/04	-	-	-	-	NA	-	-	-

Level of ID: P – Presumed, SP – Strongly Presumed, ID – Identified. **Access:** IA – Inaccessible, OA – Occasionally Accessed, EA – Easily/Regularly Accessed

Asbestos Type: NA – Non-Asbestos **Action:** A1 – Remove ASAP, A2 – Repair/Encapsulate ASAP, A3 – Leave Undisturbed and Monitor Situation

Checked by: Mr. R. Brown,
Asbestos Manager.

VEGA ENVIRONMENTAL CONSULTANTS LTD

ASBESTOS SURVEY - DATA RECORD SHEET - continued

Page 25 of 31

Report No: AR/03/1570 (update 01)

Date of survey: 03/12/03

Area ID	Surveyed Yes/No	Location of sample point / Description of suspect material	Level of ID (P/SP/ID)	Sample ID	Extent (m/m ² /m ³)	Product Type (1,2,3)	Condition (0,1,2,3)	Surface Treatment (0,1,2,3)	Asbestos Type (1,2,3)	Score	Access (IA,OA,EA)	Action (A1,A2,A3)
MOBILE UNIT (cont)		MOBILE DEMOLISHED AND REMOVED AUG 2008										
Classroom Area (cont)	Yes	Floor – carpet over wood	SP	-	-	-	-	-	NA	-	-	-
Store Cupboard	Yes	Ceiling and walls - plaster	SP	-	-	-	-	-	NA	-	-	-
		Floor – vinyl over wood	SP	-	-	-	-	-	NA	-	-	-
Externals	Yes	Roof - felt	ID	BS/10	-	-	-	-	NA	-	-	-
		Soffits - wood	SP	-	-	-	-	-	NA	-	-	-
		Gutters and down pipes - plastic	SP	-	-	-	-	-	NA	-	-	-
		Panels - wood	SP	-	-	-	-	-	NA	-	-	-
		Walls – textured coating	ID	BS/11	-	-	-	-	NA	-	-	-
		Low level panels - wood	SP	-	-	-	-	-	NA	-	-	-

Level of ID: P – Presumed, SP – Strongly Presumed, ID – Identified. **Access:** IA – Inaccessible, OA – Occasionally Accessed, EA – Easily/Regularly Accessed

Asbestos Type: NA – Non-Asbestos **Action:** A1 – Remove ASAP, A2 – Repair/Encapsulate ASAP, A3 – Leave Undisturbed and Monitor Situation

Checked by: Mr. R. Brown,
Asbestos Manager.

VEGA ENVIRONMENTAL CONSULTANTS LTD

ASBESTOS SURVEY - DATA RECORD SHEET - continued

Page 26 of 31

Report No: AR/03/1570 (update 01)

Date of survey: 03/12/03

Area ID	Surveyed Yes/No	Location of sample point / Description of suspect material	Level of ID (P/SP/ID)	Sample ID	Extent (m/m ² /m ³)	Product Type (1,2,3)	Condition (0,1,2,3)	Surface Treatment (0,1,2,3)	Asbestos Type (1,2,3)	Score	Access (IA,OA,EA)	Action (A1,A2,A3)
MOBILE UNIT (cont)		MOBILE DEMOLISHED AND REMOVED AUG 2008										
Gas Store	Yes	Ceiling, walls, floor and door - panels	SP	As BS/04	-	-	-	-	NA	-	-	-

Level of ID: P – Presumed, SP – Strongly Presumed, ID – Identified. **Access:** IA – Inaccessible, OA – Occasionally Accessed, EA – Easily/Regularly Accessed

Asbestos Type: NA – Non-Asbestos **Action:** A1 – Remove ASAP, A2 – Repair/Encapsulate ASAP, A3 – Leave Undisturbed and Monitor Situation

Checked by: Mr. R. Brown,
Asbestos Manager.

ADDITIONAL INFORMATION: Report No: AR/03/1570 (update 01)

Survey Specification:

Type 2 Survey:

Definition: **Type 2 Survey (Standard Sampling, Identification and Assessment):** The analyst will do a general walk around the whole area and look at all readily accessible areas. From his experience the analyst will attempt to identify any asbestos and/or asbestos products without the need for sampling. The areas will be assessed and where appropriate will be **presumed** to contain asbestos. Where it appears highly likely that materials will contain asbestos, there should be a **strong presumption** that it does. All materials, which are presumed to contain asbestos, must be assessed using the Material Assessment Algorithm. Where practicable representative samples will be taken from all materials in accordance with full sampling frequency recommendations and analysed. Sample points will be made safe but redecoration will not be carried out. (see Appendix A)

On 03 December 2003, a type 2 survey was carried out at New Hartley County First School, Melton Drive, New Hartley, Whitley Bay to identify and report on the presence and condition of asbestos based materials.

GROUND FLOOR



Main Area – high level wall heaters were inaccessible, therefore we must presume they contain asbestos. It is recommended a closer inspection be carried out prior to any invasive maintenance works.

BOILER ROOM



Boiler Room – boilers were inaccessible, therefore we must presume they contain asbestos. It is recommended a closer inspection be carried out prior to any invasive maintenance works.

ADDITIONAL INFORMATION: Report No: AR/03/1570 (update 01)

BOILER ROOM



Boiler Room – gaskets to flanges are an asbestos containing material (ACM sample BS/07). They are in good condition and sealed. It is recommended they are left undisturbed and monitored.

EXTERIOR



Roof – verge board strip is an ACM (sample BS/08). It is in good condition and it is recommended it be left undisturbed and monitored.

MOBILE UNIT REMOVED



Classroom Area – wall heater was inaccessible, therefore we must presume it contains asbestos. It is recommended a closer inspection be carried out prior to any invasive maintenance works.

**MOBILE DEMOLISHED AND REMOVED
AUG 2008**

ADDITIONAL INFORMATION: Report No: AR/03/1570 (update 01)

MOBILE UNIT REMOVED



Classroom Area – panel below heater is AIB (sample BS/09). It is in good condition and sealed. It is recommended it be left undisturbed and monitored and that drilling fixing and sanding should be prohibited as this will cause the release of asbestos fibre.

**MOBILE DEMOLISHED AND
REMOVED AUG 2008**

ADDITIONAL INFORMATION: Report No: AR/03/1570 (update 01)

GROUND FLOOR

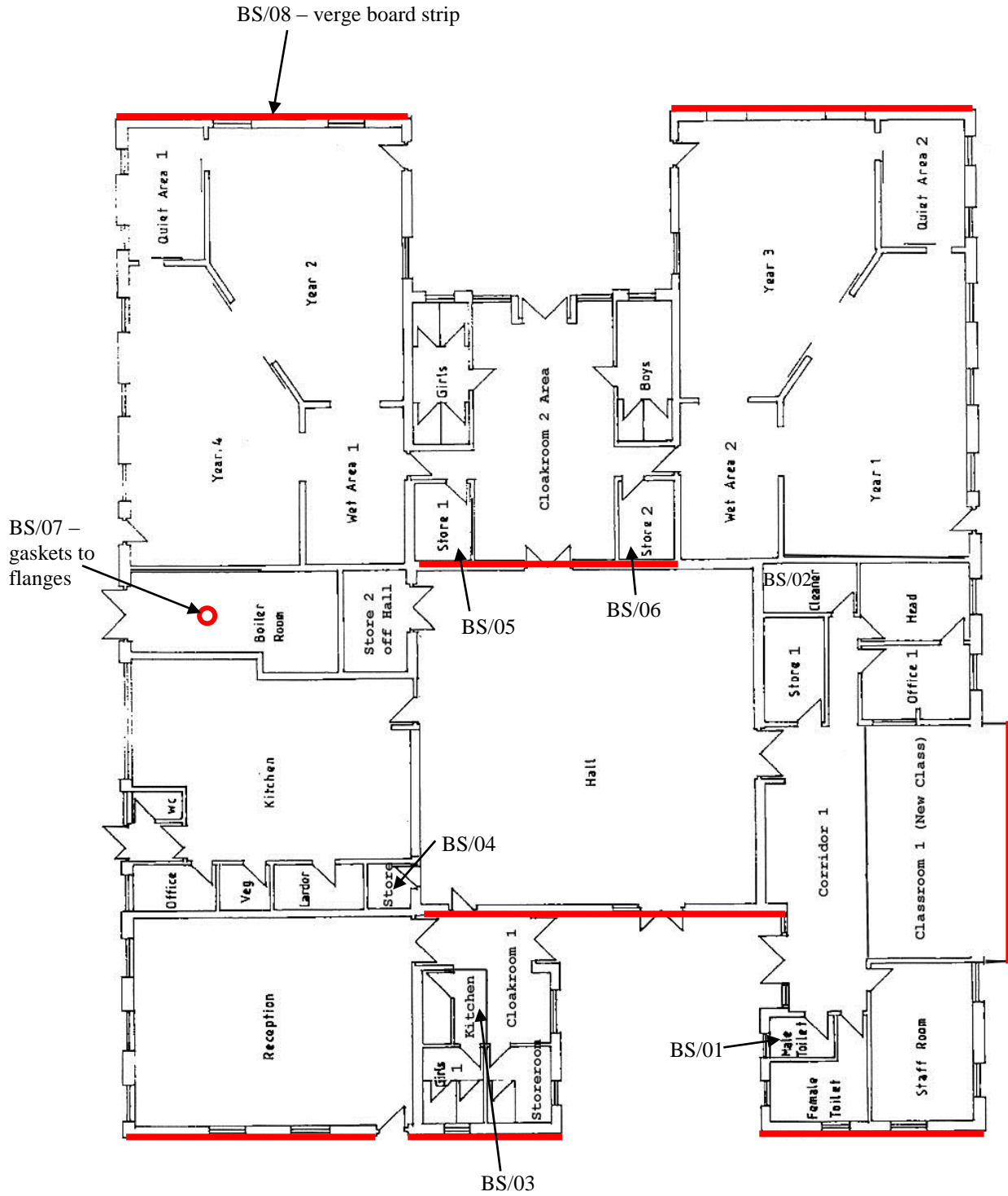

ADDITIONAL INFORMATION: Report No: AR/03/1570 (update 01)

MOBILE UNIT

MOBILE DEMOLISHED AND REMOVED AUG 2008

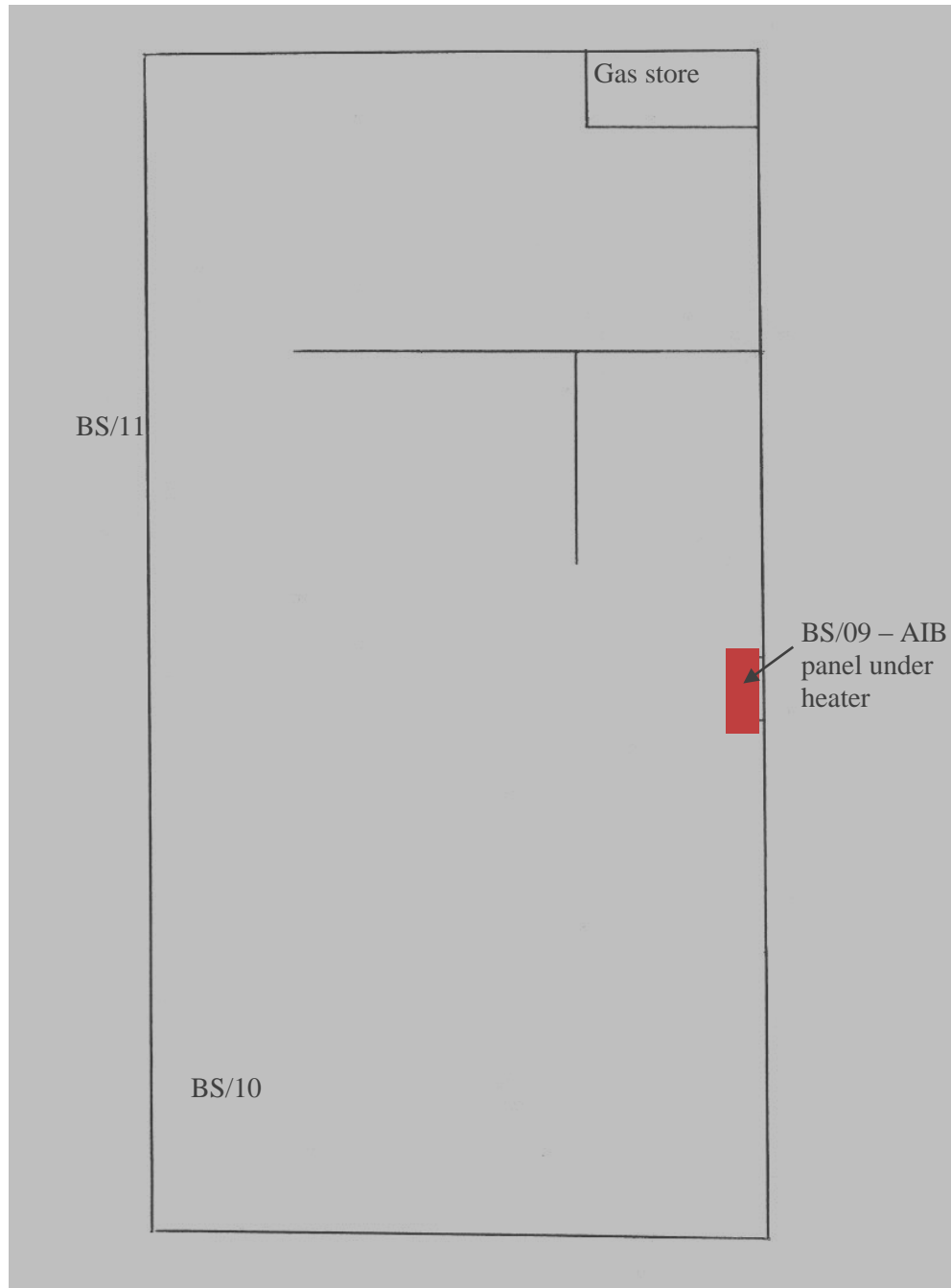

APPENDIX A

VEGA ENVIRONMENTAL CONSULTANTS LTD

MATERIAL ASSESSMENT ALGORITHM – FOR TYPE 1/TYPE 2 SURVEY		
Sample Variable	Score	Main Examples
Product Type	1	Asbestos reinforced composites (plastic, resins, mastics, roofing felts, vinyl floor tiles, semi-rigid paints or decorative finishes, asbestos cement etc.)
	2	Asbestos insulating board, mill boards, other low-density insulation boards, asbestos textiles, gaskets, ropes and woven textiles, asbestos paper and felt.
	3	Thermal insulation (e.g. pipe and boiler lagging), sprayed asbestos, loose asbestos, asbestos mattresses and packing.
Condition	0	Good condition: no visible damage
	1	Low damage: a few scratches or surface marks; broken edges on boards, tiles etc.
	2	Medium damage: significant breakage of materials or several small areas where material has been damaged revealing loose asbestos fibres.
	3	High damage or delamination of materials, sprays and thermal insulation. Visible asbestos debris.
Surface Treatment	0	Composite materials containing asbestos: reinforced plastics, resins, vinyl tiles, painted or asbestos cement (with exposed face painted or encapsulated)
	1	Enclosed sprays and lagging, AIB (with exposed face painted or encapsulated), asbestos cement sheets etc.
	2	Unsealed AIB, or encapsulated lagging and sprays.
	3	Unsealed lagging and sprays.
Asbestos Type	1	Chrysotile.
	2	Amphibole asbestos excluding crocidolite.
	3	Crocidolite.

INITIAL ACTION PLAN			
MATERIAL ASSESSMENT SCORE	ACCESS		
	Inaccessible	Occasionally Accessed	Easily/Regularly Accessed
Very Low Risk: < 5	A3	A3	A3
Low Risk: 5-6	A3	A3	A2
Medium Risk: 7-9	A3	A2	A1
High Risk: 10-12	A2	A1	A1